



RACINE UNIFIED

SCHOOL DISTRICT

FURNITURE STANDARDS

REVISION #1

MARCH 10, 2025

FURNITURE STANDARDS

TABLE OF CONTENTS

- CONTACT INFORMATION 3
- ROOM TYPICALS 4-57
- PRODUCT SPECIFICATIONS 58-128
- UPHOLSTERY SPECIFICATIONS 129-134

CONTACT INFORMATION

FURNITURE STANDARD COORDINATOR

ZIMMERMAN ARCHITECTURAL STUDIOS

Elizabeth Yagel

(414) 918-1438 elizabeth.yagel@zastudios.com

2122 West Mt. Vernon Ave | Milwaukee, WI 53233

<https://zastudios.com/>

FURNITURE DEALERSHIPS

EMMONS BUSINESS INTERIORS

Patti Lemkuil

(847) 302-7671 pattil@ebiweb.com

140 S 1st St. #300 | Milwaukee, WI 53204

<https://ebiweb.com/>

DUET RESOURCE GROUP

Chris McIntyre

(414) 559-9796 chris.mcintyre@duetresourcegroup.com

224 S 1st St | Milwaukee, WI 53204

<https://www.duetresourcegroup.com/>



**RACINE
UNIFIED
SCHOOL DISTRICT**

ROOM TYPICALS

ROOM TYPICALS

KEY

ES: ELEMENTARY SCHOOL

MS: MIDDLE SCHOOL

HS: HIGH SCHOOL

ROOM INDEX

•	<u>STANDARD CLASSROOMS</u>	
•	TYPICAL K4 CLASSROOM	6-7
•	TYPICAL K-1 ST CLASSROOM	8-9
•	TYPICAL 2 ND -4 TH CLASSROOM	10-11
•	TYPICAL 4 TH GRADE CLASSROOM	
•	TYPICAL 5 TH GRADE CLASSROOM	12-13
•	TYPICAL MS/HS CLASSROOM	14-15
•	<u>SPECIALTY CLASSROOMS</u>	
•	TYPICAL SPECIAL EDUCATION CLASSROOM – ES	16-17
•	TYPICAL SPECIAL EDUCATION CLASSROOM – MS/HS	18-19
•	TYPICAL ART CLASSROOM – ES	20-21
•	TYPICAL ART CLASSROOM – MS/HS	22-23
•	TYPICAL SCIENCE CLASSROOM – MS/HS	24-25
•	TYPICAL BAND ROOM – ES/MS/HS	26
•	TYPICAL MUSIC/CHOIR – ES	27
•	TYPICAL MUSIC/CHOIR ROOM – MS/HS	28
•	TYPICAL CULINARY CLASSROOM	29-30
•	TYPICAL FASC ROOM	31-32
•	TYPICAL STEM CLASSROOM	33-34
•	TYPICAL TECH ED CLASSROOM	35-36
•	<u>STUDENT SUPPORT SPACES</u>	
•	TYPICAL PT/OT – ES	37-38
•	TYPICAL CALM/SENSORY ROOM	39
•	TYPICAL LIBRARY – ES	40-41
•	TYPICAL LIBRARY – MS/HS	42-43
•	TYPICAL CAFETERIA – ES/MS/HS	44-45
•	<u>STAFF SUPPORT SPACES</u>	
•	TYPICAL PRIVATE OFFICE - LARGE	46-47
•	TYPICAL PRIVATE OFFICE - STANDARD	48-49
•	TYPICAL CONFERENCE ROOM – SMALL	50
•	TYPICAL CONFERENCE ROOM – LARGE	51
•	TYPICAL RECEPTION	52
•	TYPICAL HEALTH ROOM	53
•	TYPICAL LACTATION/WELLNESS ROOM	54
•	TYPICAL COLLABORATION ROOM	55
•	TYPICAL STAFF LOUNGE	56
•	TYPICAL COMMUNITY CLASSROOM	57



C-2



D-4



L-2



SC-1

INSTALLATION
HEIGHT: 23" AFF



C-7A



T-2A
INSTALLATION
HEIGHT: 23" AFF



C-8A

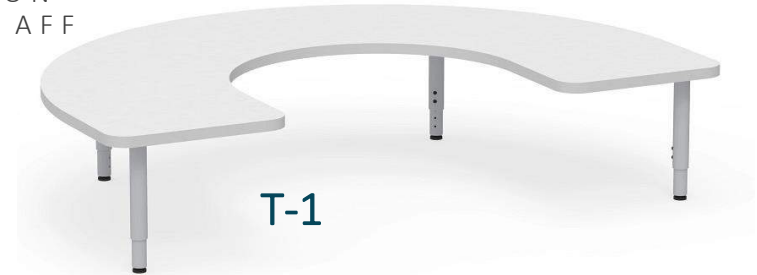

T-1



D-9



C-5B

TYPICAL 4K CLASSROOM



C-2



D-4



L-2



SC-1

INSTALLATION
HEIGHT: 23" AFF



C-7A



D-1

INSTALLATION
HEIGHT: 23" AFF



C-8A

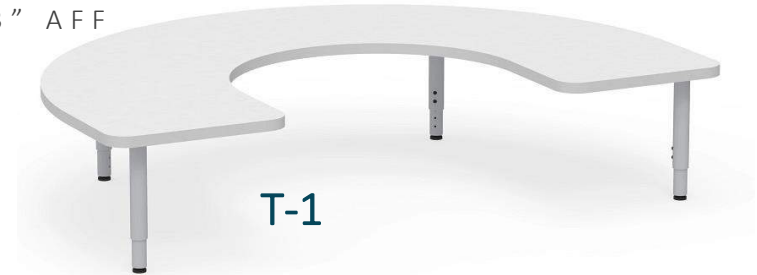

T-1



D-9



C-5B

TYPICAL K-1ST GRADE CLASSROOM

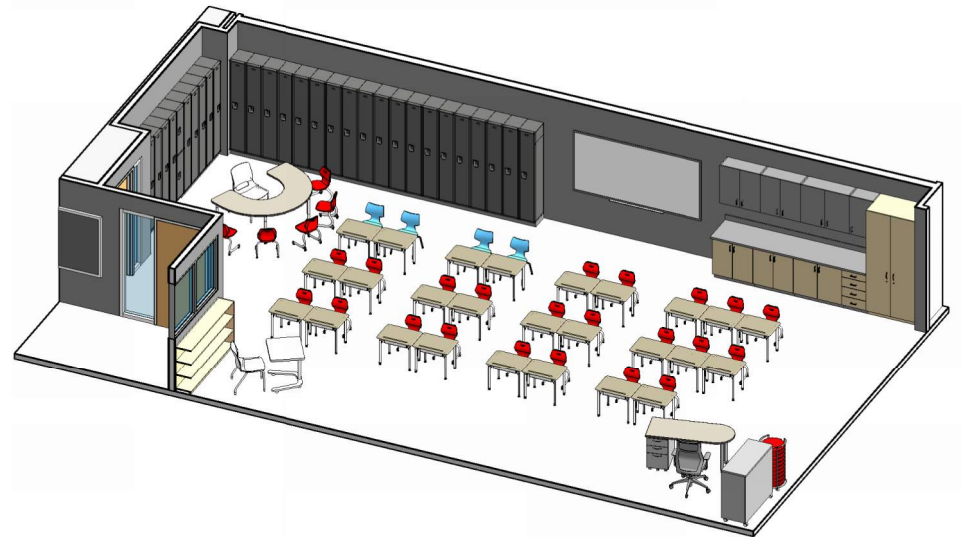
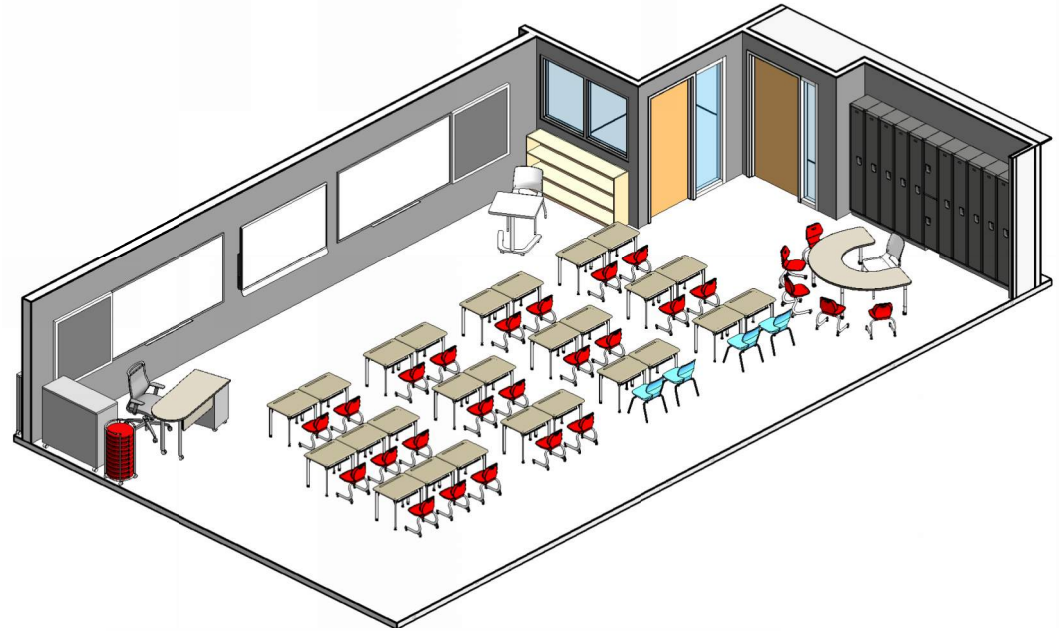
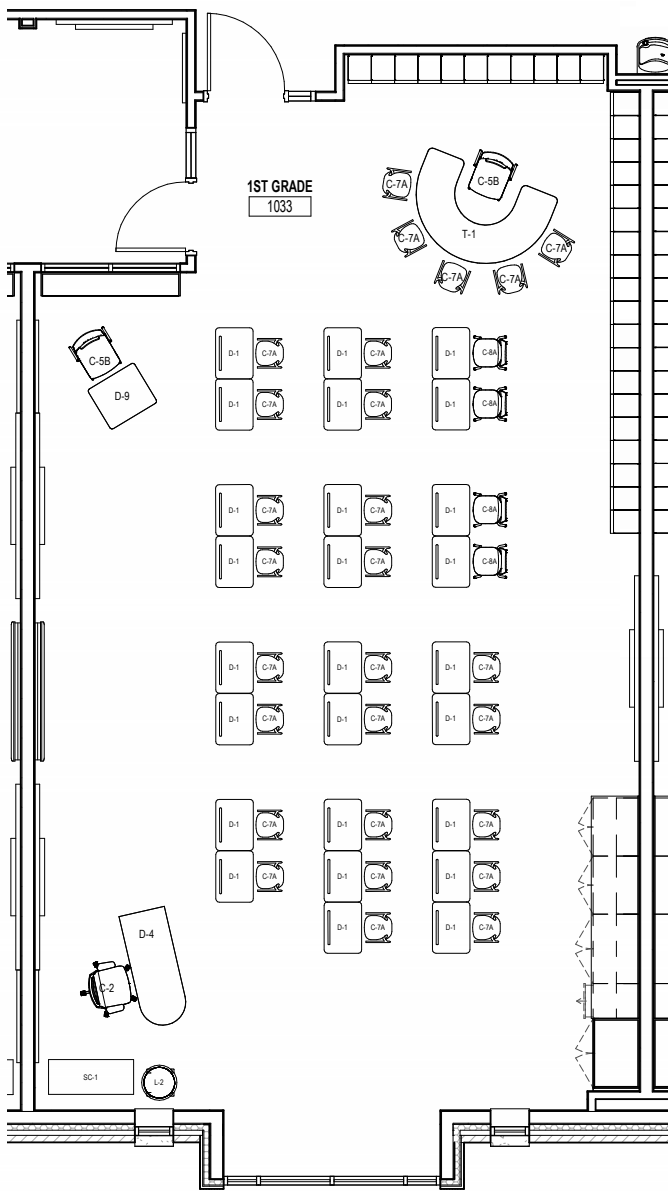

TYPICAL K-1ST GRADE CLASSROOM



C-2



D-4



L-2



SC-1

INSTALLATION
HEIGHT: 26" AFF



C-7B



D-2

INSTALLATION
HEIGHT: 26" AFF



C-8B

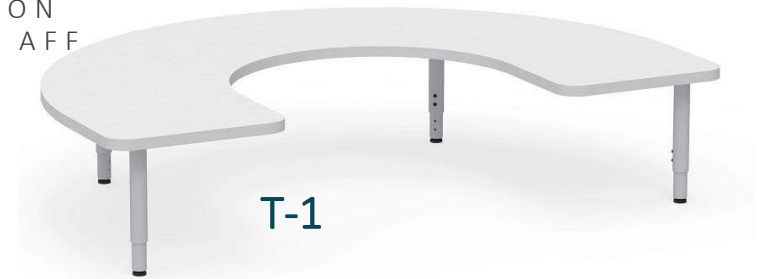

T-1



D-9



C-5B

TYPICAL 2ND-4th GRADE CLASSROOM



C-2



D-4



C-7C



D-2

INSTALLATION
HEIGHT: 30" AFF



C-8C



T-1



ST-1

INSTALLATION
HEIGHT: 19" AFF



C-5B

TYPICAL 5TH GRADE CLASSROOM

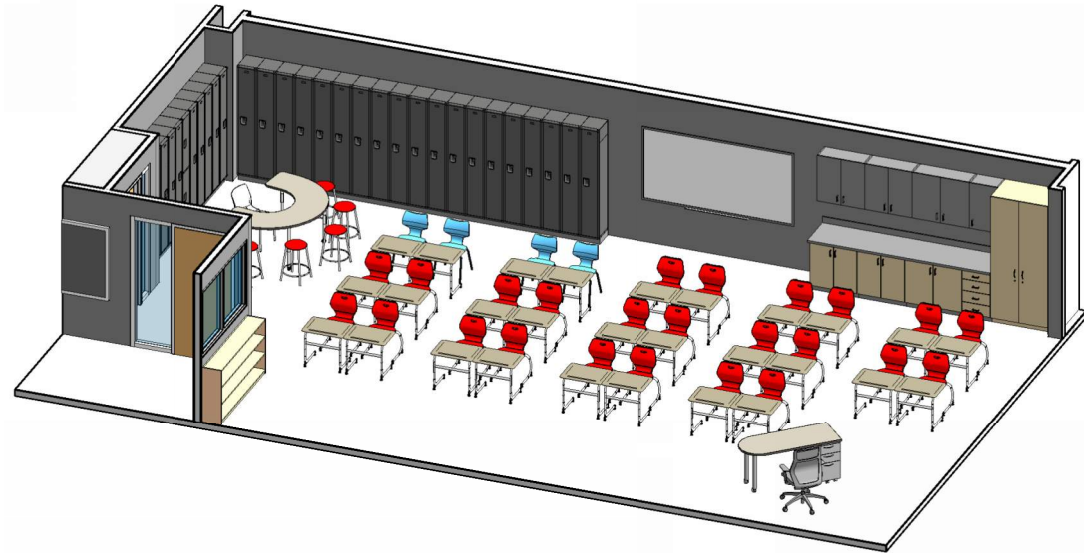
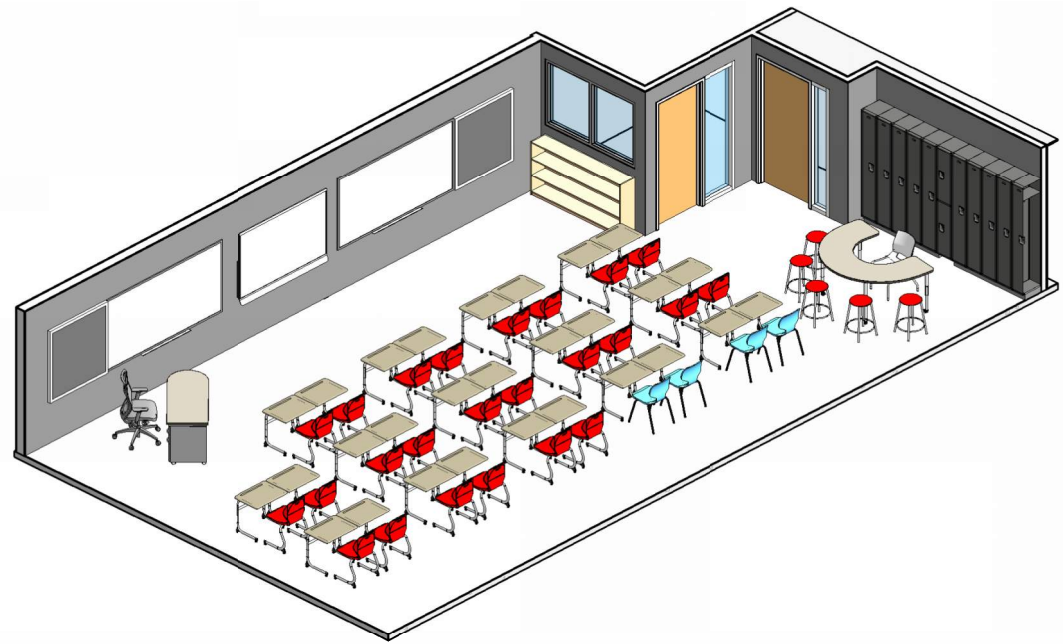
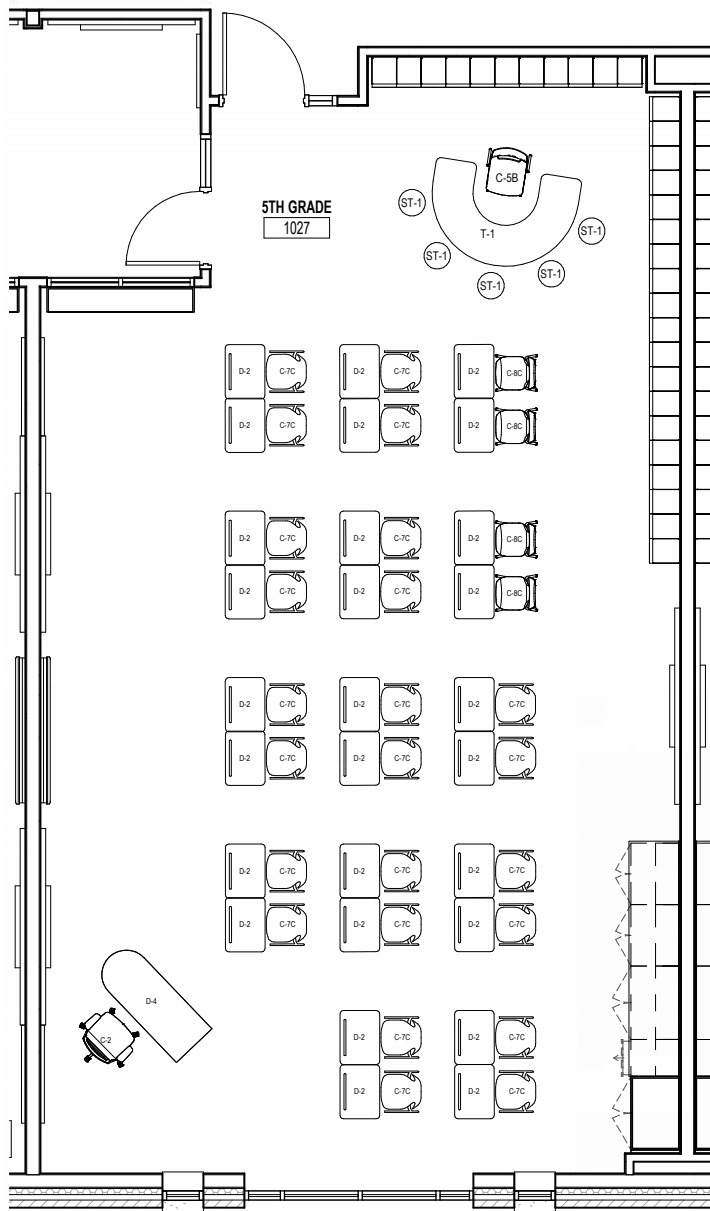

TYPICAL 5TH GRADE CLASSROOM



D-3A/D-3B



C-2



D-5

TYPICAL MIDDLE/HIGH SCHOOL CLASSROOM

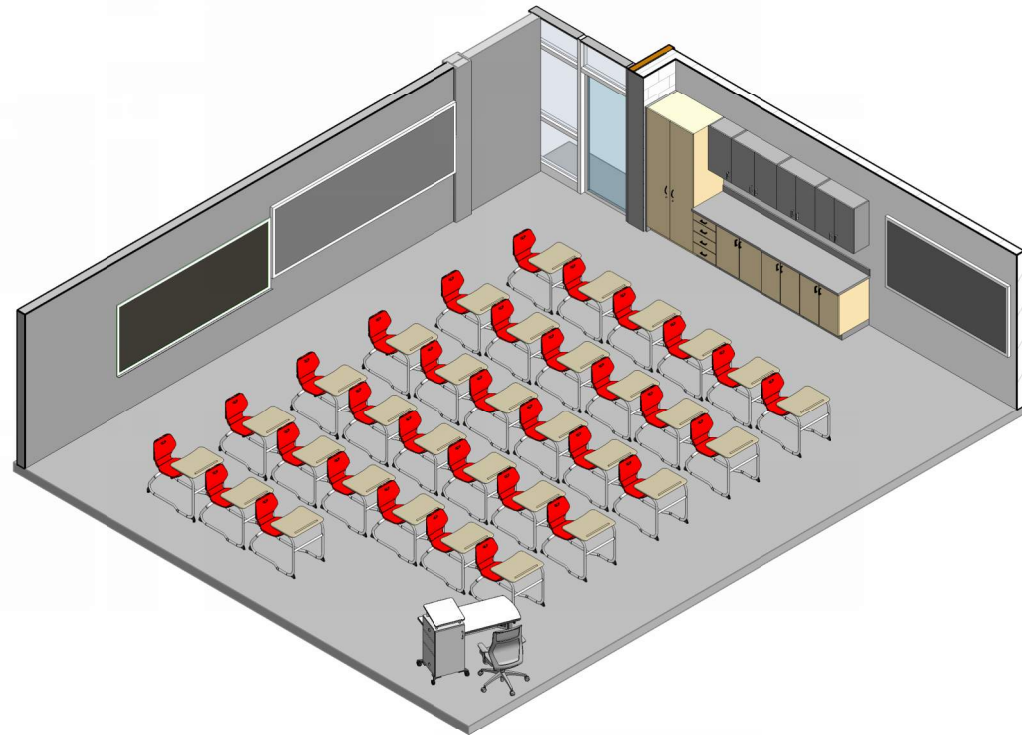
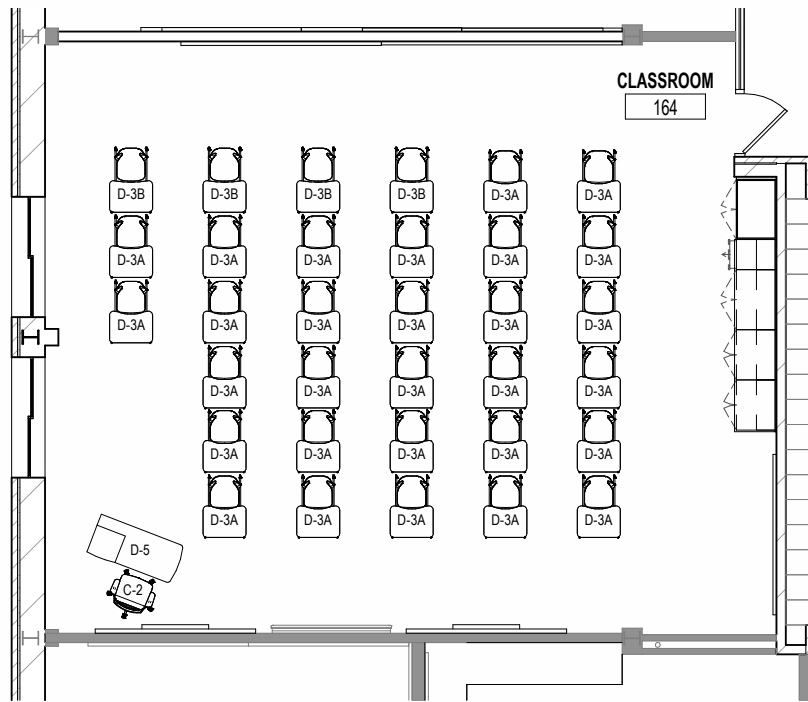

TYPICAL MIDDLE/HIGH SCHOOL CLASSROOM



C-2



D-4



L-2



SC-1

INSTALLATION
HEIGHT: 26" AFF



C-7B



T-2B

INSTALLATION
HEIGHT: 26" AFF



C-8B

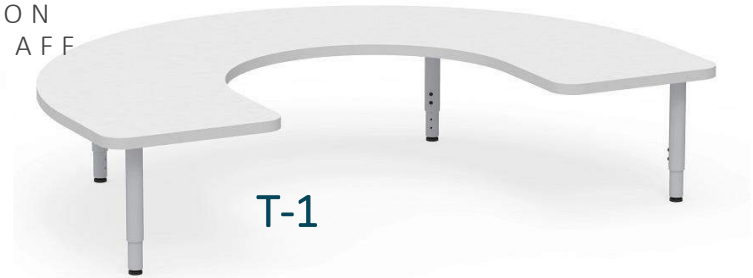

T-1



D-9



C-5B

TYPICAL SPECIAL EDUCATION CLASSROOM - ES

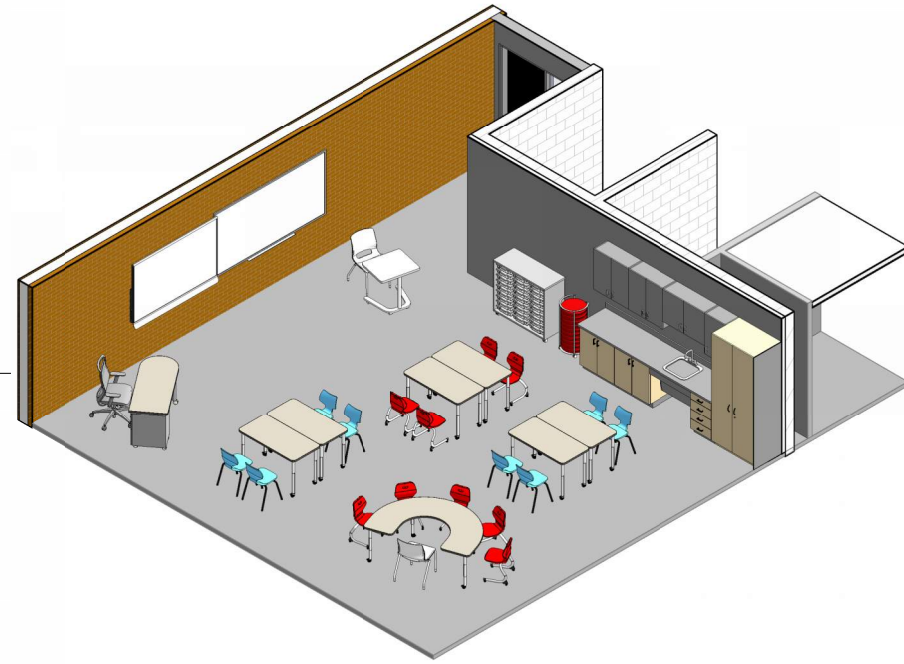
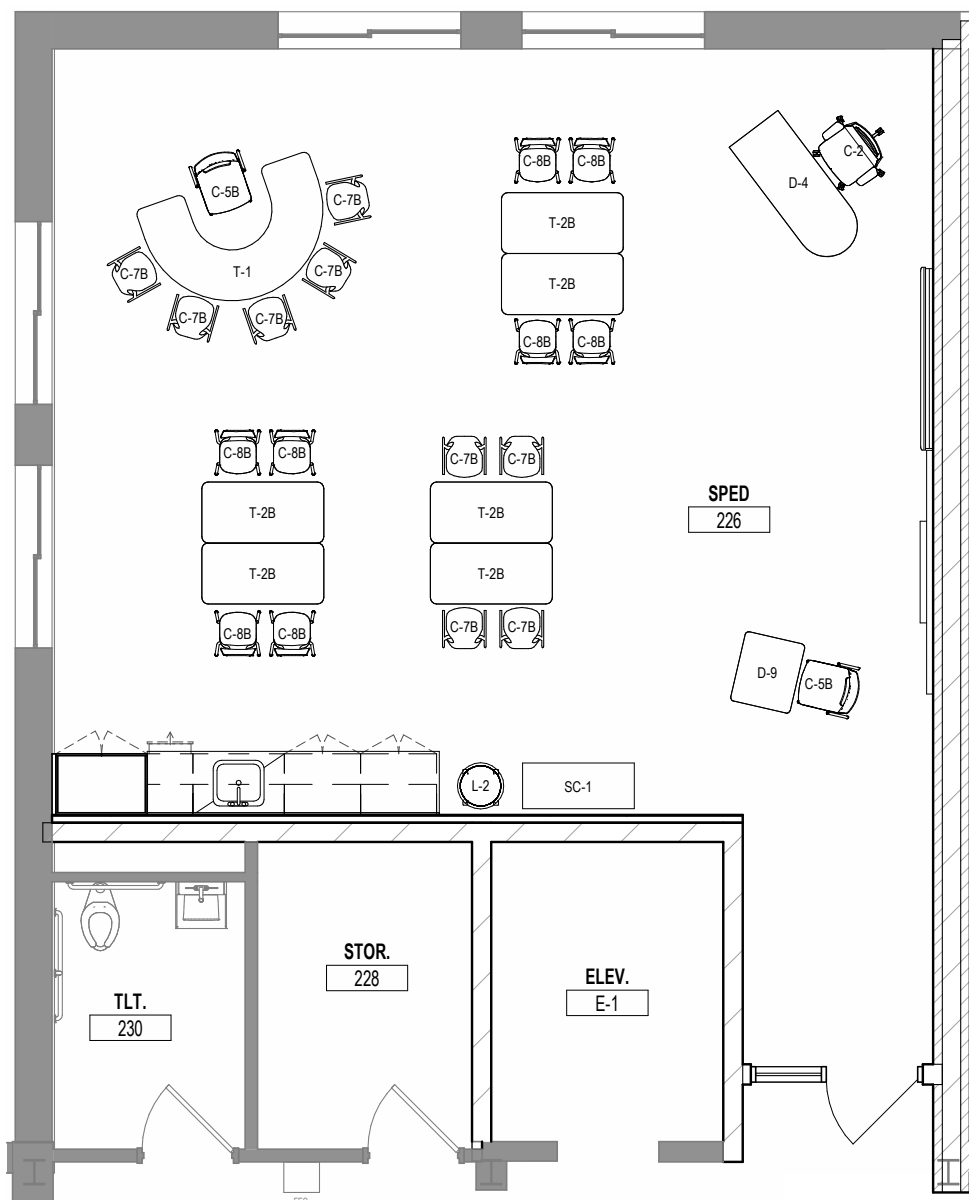

TYPICAL SPECIAL EDUCATION CLASSROOM - ES



C-2



D-4



L-2



SC-1



ST-1

INSTALLATION
HEIGHT: 19" AFF

INSTALLATION
HEIGHT: 30" AFF

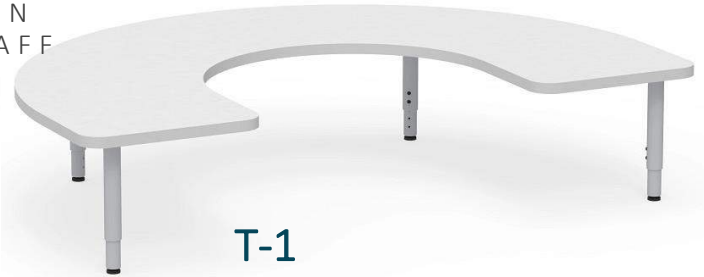

T-1



C-7C



T-2C

INSTALLATION
HEIGHT: 30" AFF



C-8C



D-9



C-5B

TYPICAL SPECIAL EDUCATION CLASSROOM –MS/HS

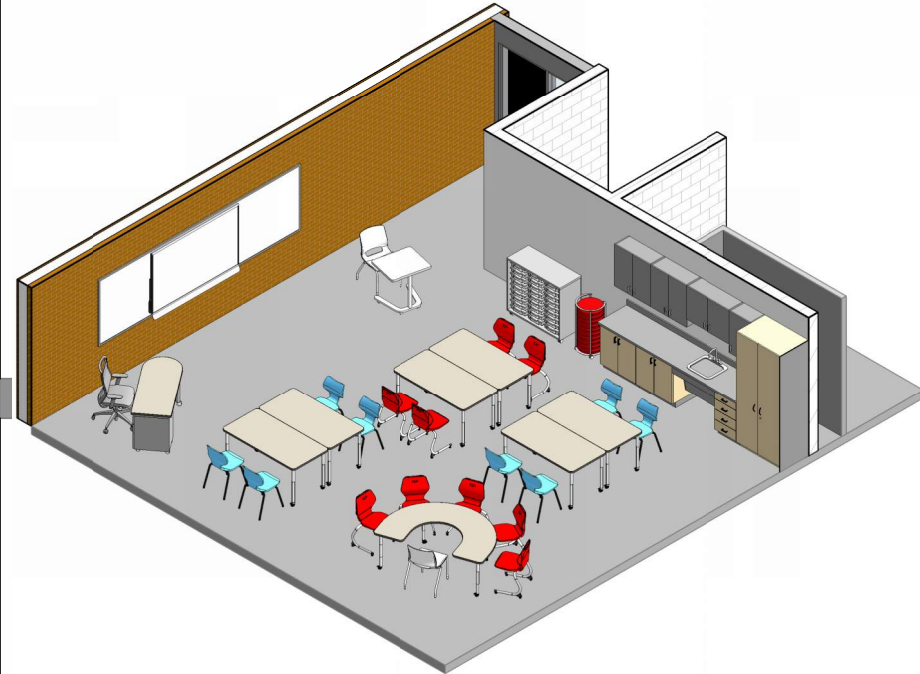
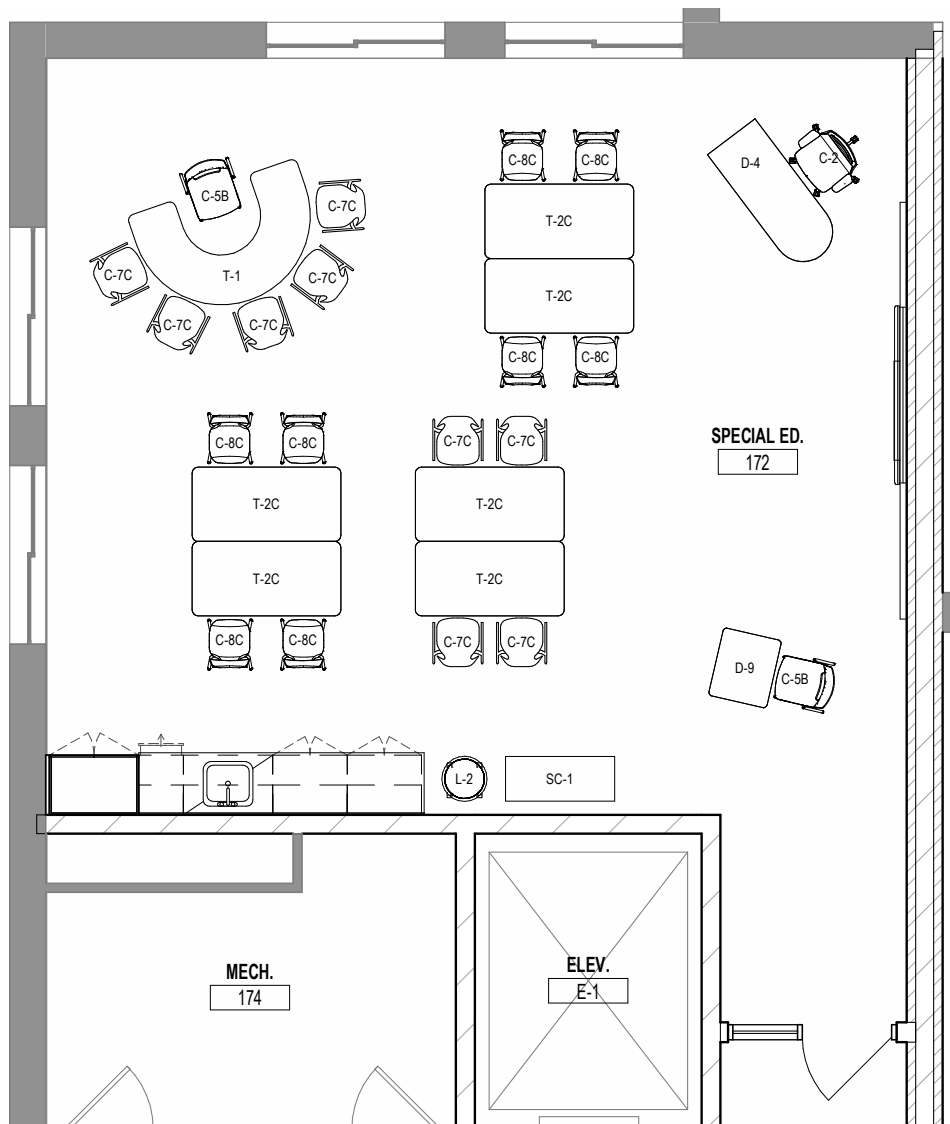

TYPICAL SPECIAL EDUCATION CLASSROOM –MS/HS



C-2



D-4



C-7B



T-3B

INSTALLATION
HEIGHT:

26" AFF

TYPICAL ART CLASSROOM – ES

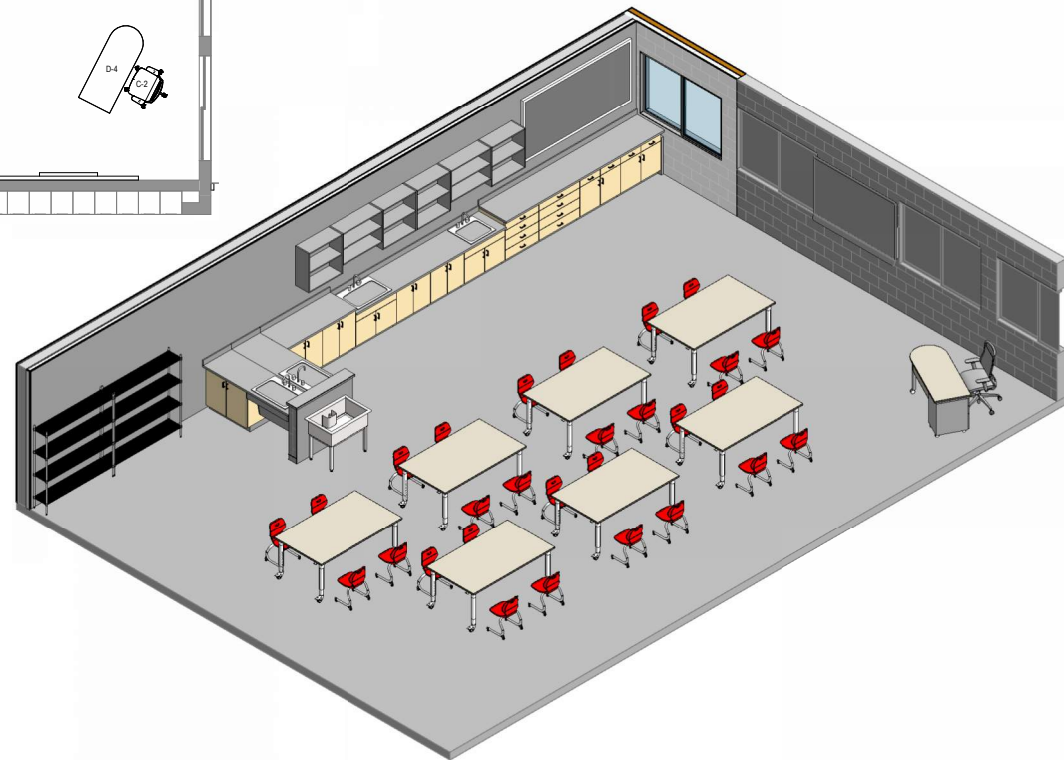
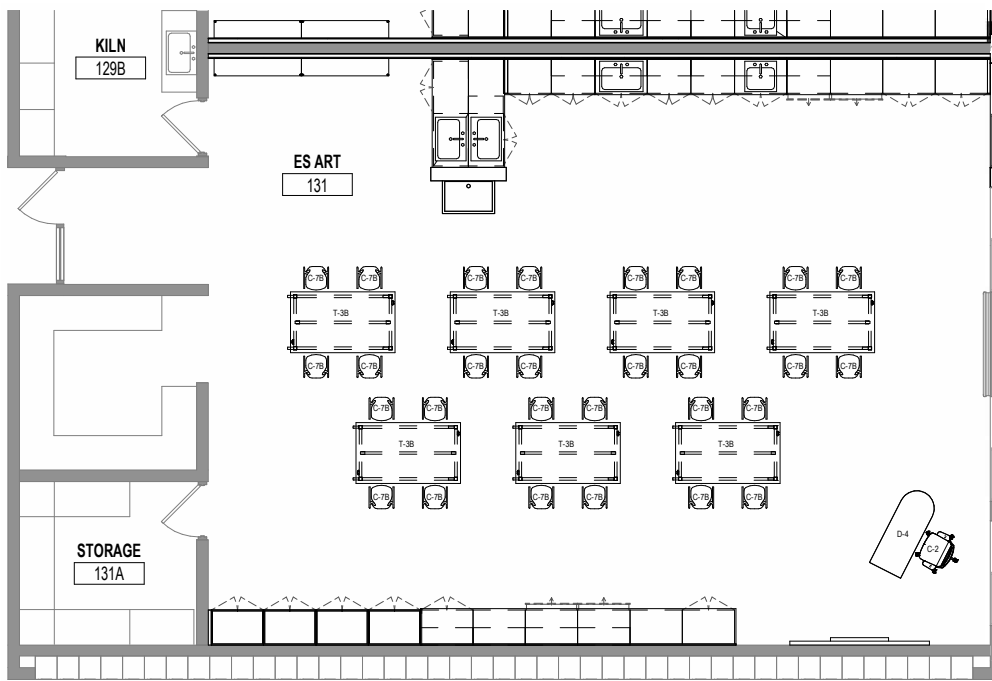

TYPICAL ART CLASSROOM – ES



C-2



D-4

INSTALLATION
HEIGHT:

24" AFF



ST-1



T-3B

INSTALLATION
HEIGHT:

36" AFF

TYPICAL ART CLASSROOM – MS/HS

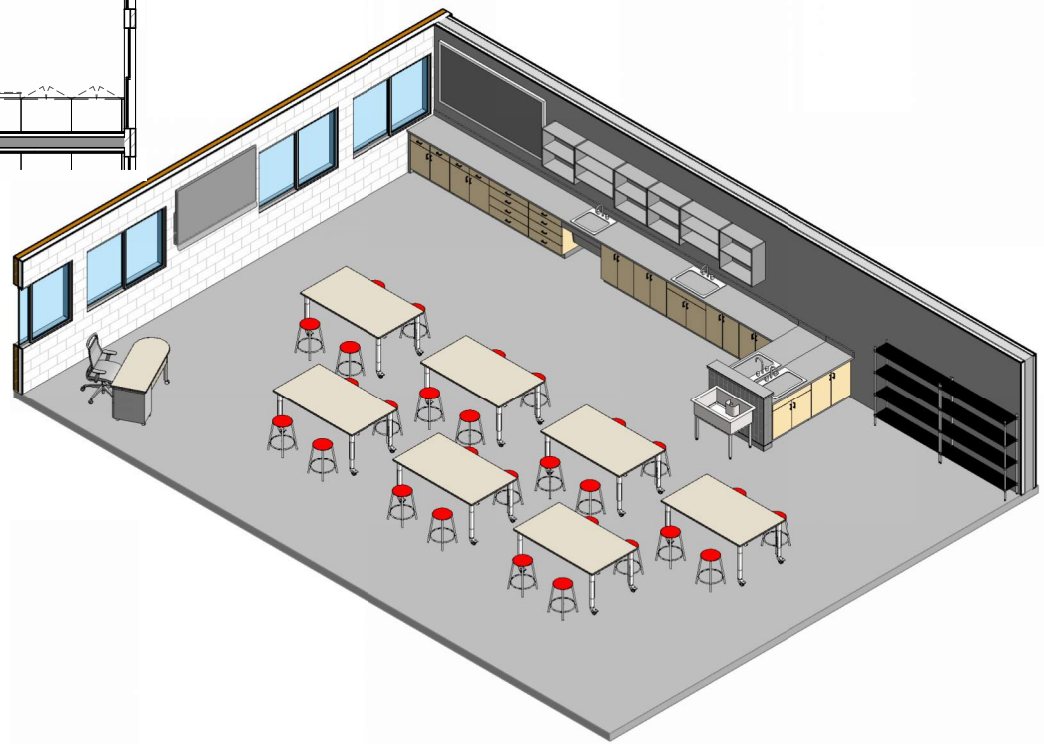
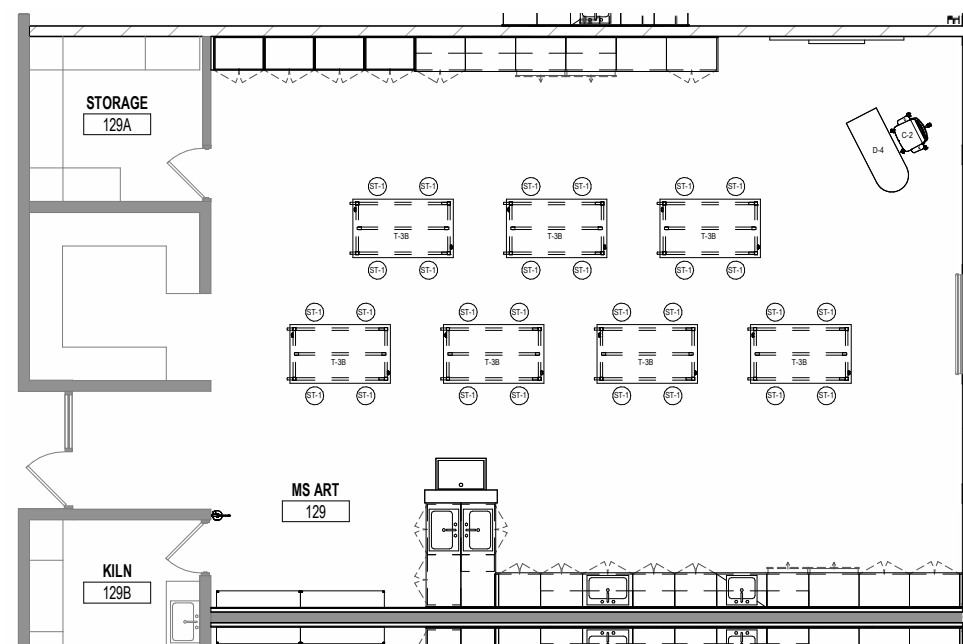

TYPICAL ART CLASSROOM – MS/HS



C-2



D-5

INSTALLATION
HEIGHT:

24" AFF



ST-1



T-3B

INSTALLATION
HEIGHT:

36" AFF

TYPICAL SCIENCE CLASSROOM/LAB – MS/HS

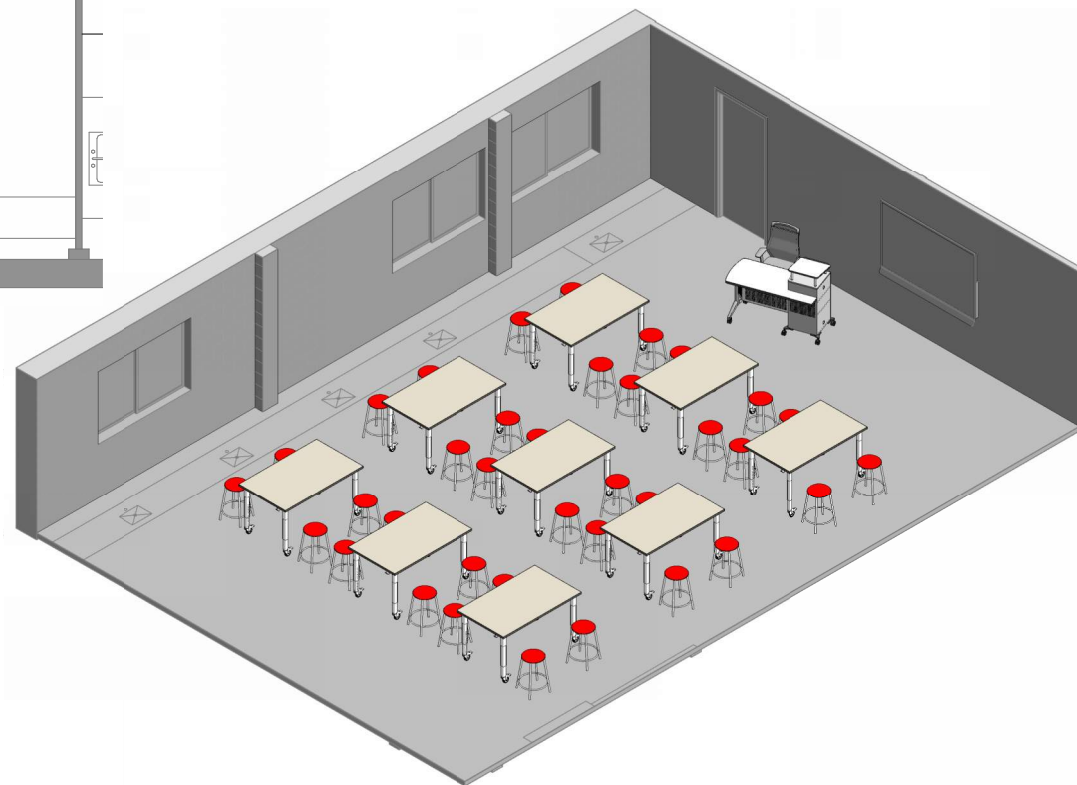
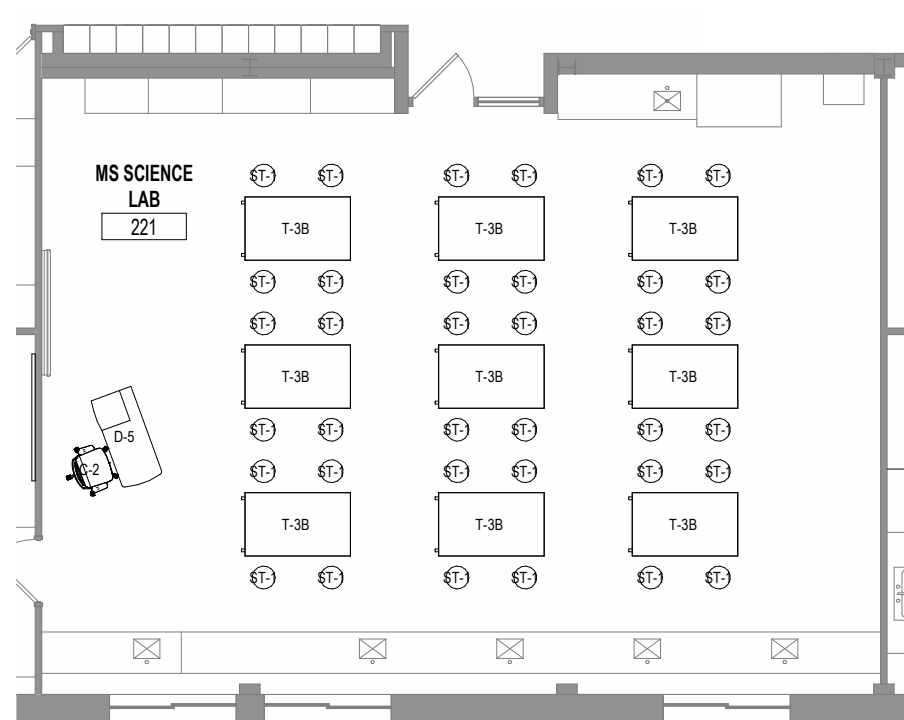

TYPICAL SCIENCE CLASSROOM/LAB – MS/HS



C-9A/
C-9B



MS-1

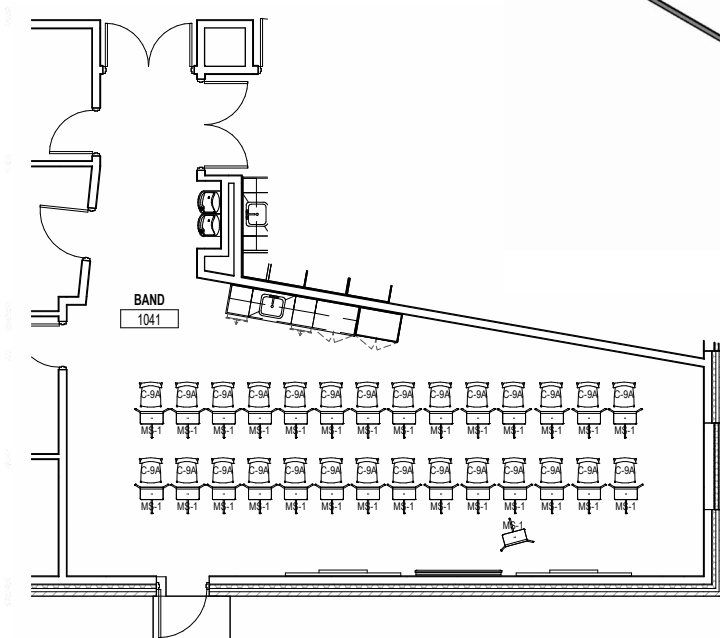
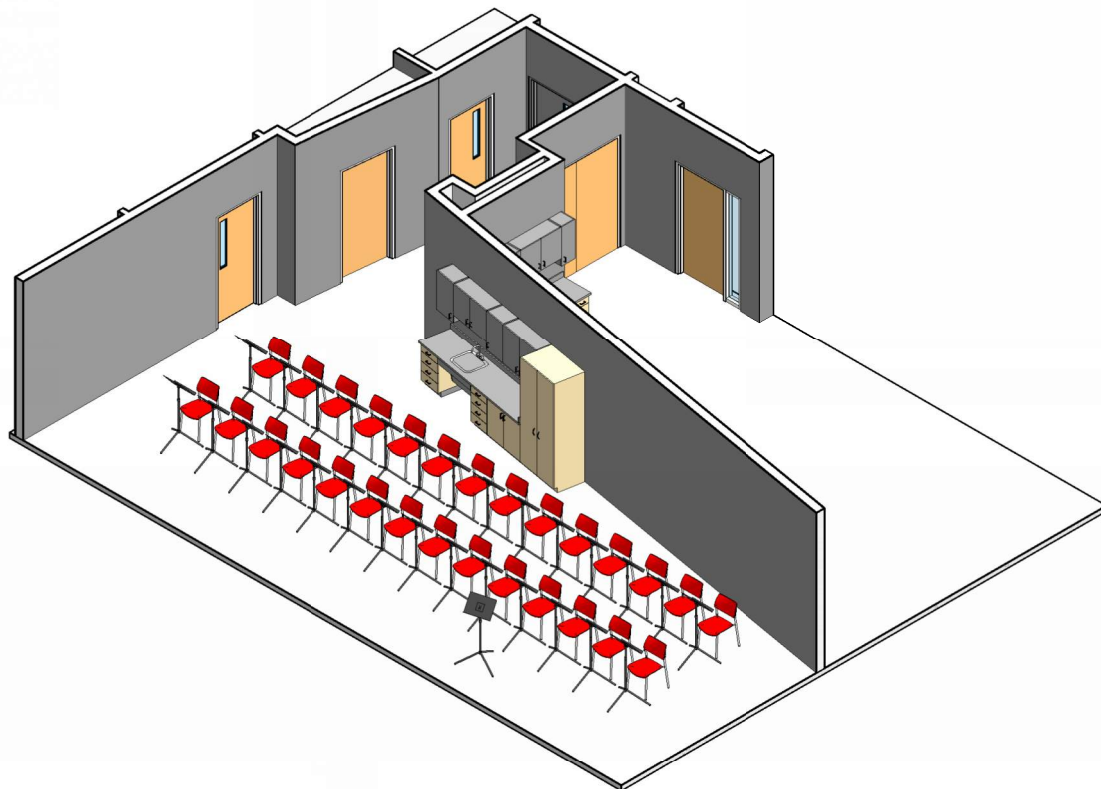

FOR SHEET MUSIC / INSTRUMENT STORAGE, SEE ARCHITECTURAL PLANS

TYPICAL BAND ROOM – ES/MS/HS



C-7B

C-8B

T-2B

C-2

D-4

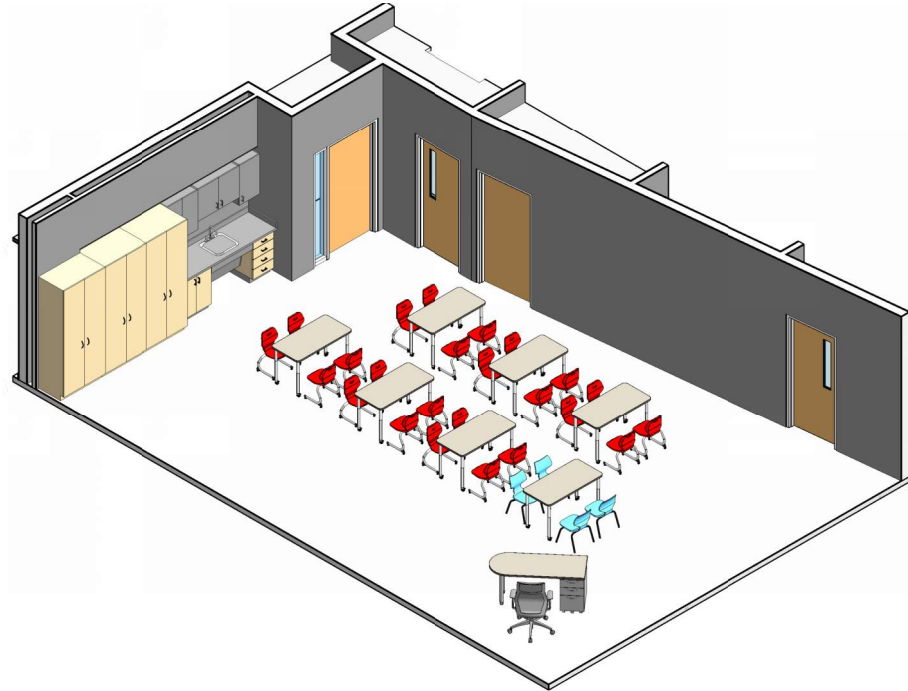
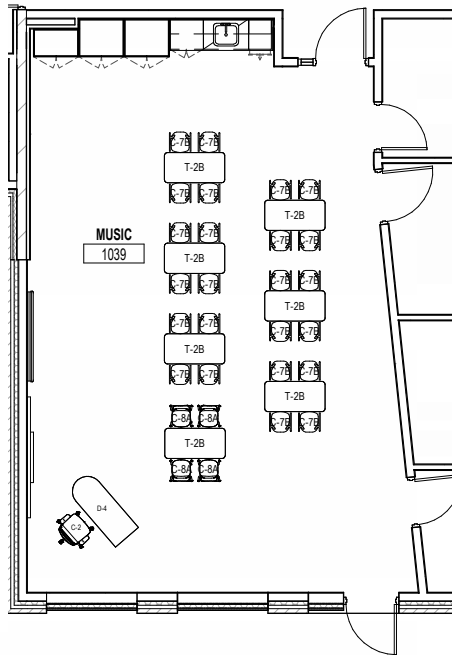

FOR SHEET MUSIC STORAGE, SEE ARCHITECTURAL PLANS

TYPICAL MUSIC/CHOIR ROOM - ES



C-2



D-5



C-5B

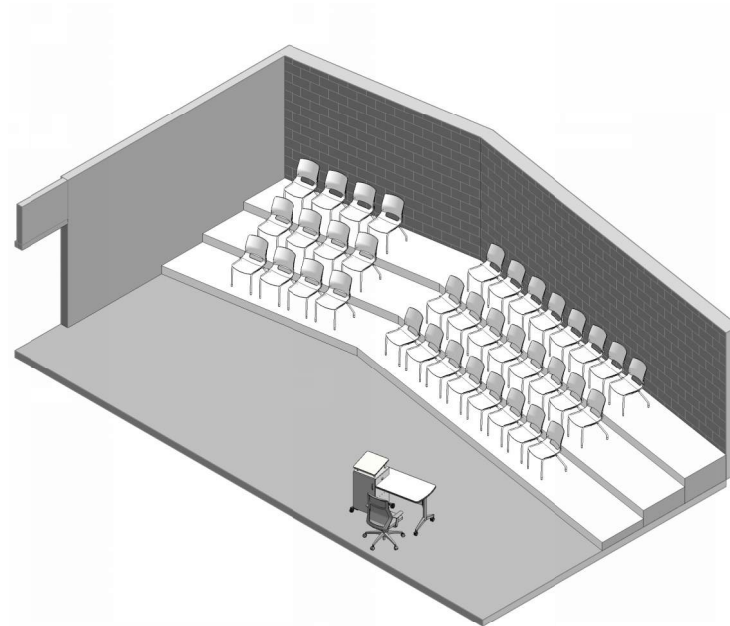
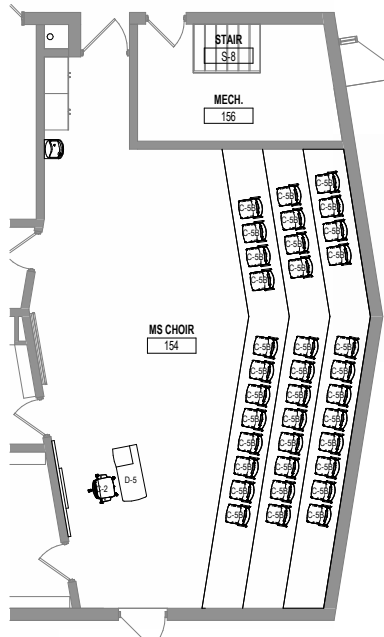

FOR SHEET MUSIC STORAGE, SEE ARCHITECTURAL PLANS

TYPICAL MUSIC/CHOIR ROOM – MS/HS



C-2



D-5

INSTALLATION
HEIGHT:

24" AFF



ST-1



T-3C

INSTALLATION
HEIGHT:

36" AFF

TYPICAL CULINARY CLASSROOM

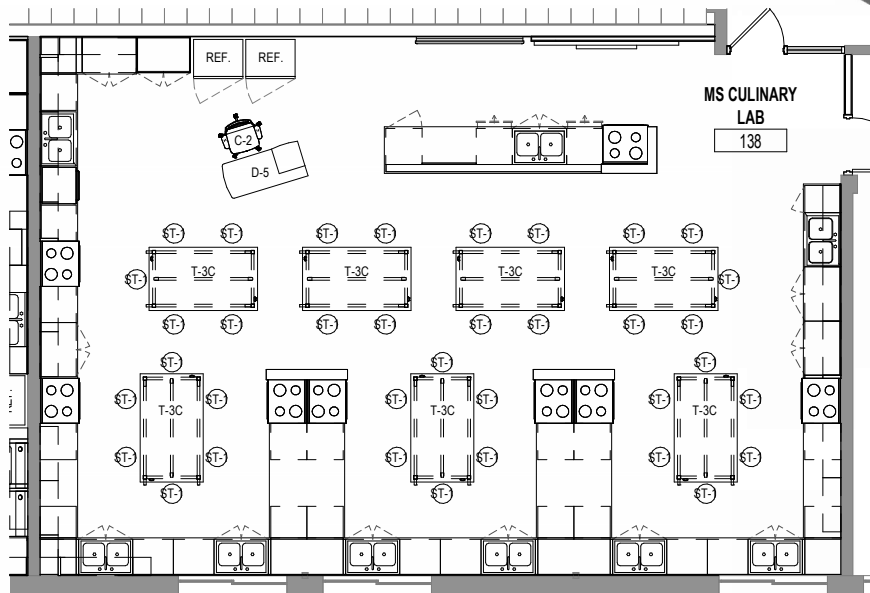

TYPICAL CULINARY CLASSROOM



C-2



D-5

INSTALLATION
HEIGHT:

24" AFF



ST-1



T-3C

INSTALLATION
HEIGHT:

36" AFF

TYPICAL FASC ROOM

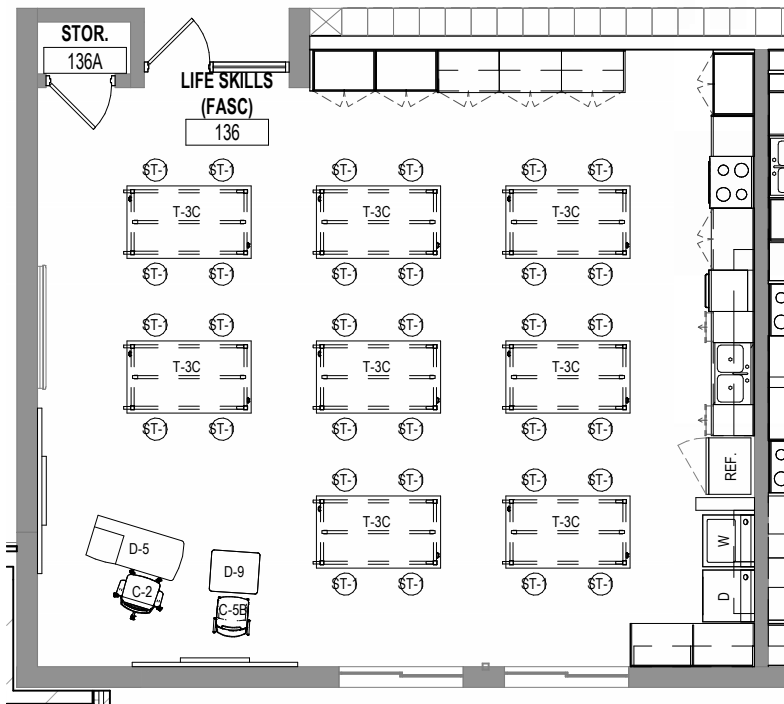

TYPICAL FASC ROOM





C-2



D-5

INSTALLATION
HEIGHT:

24" AFF



ST-1



T-3A

INSTALLATION
HEIGHT:

36" AFF

TYPICAL STEM CLASSROOM

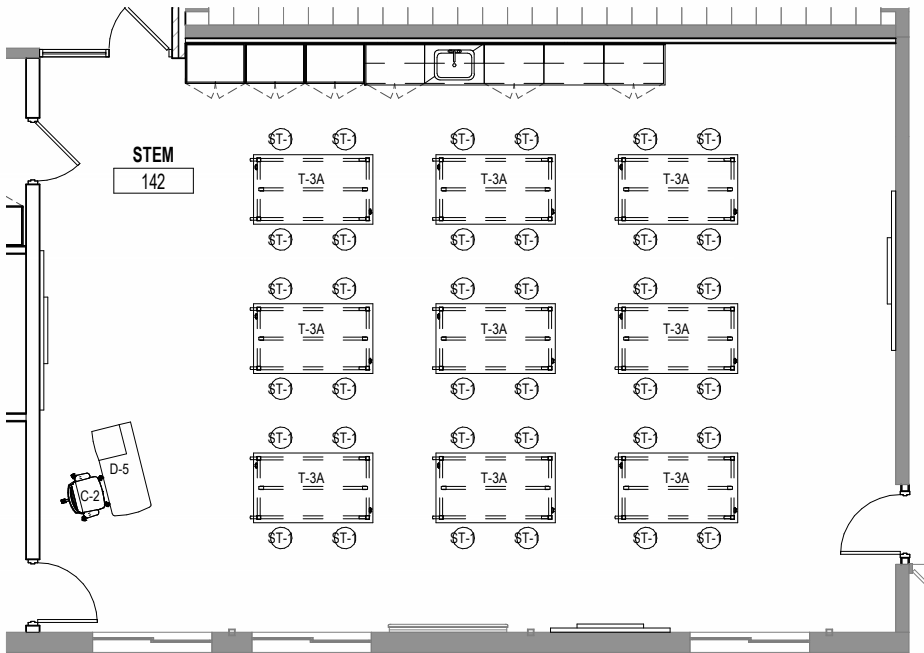

TYPICAL STEM CLASSROOM



C-2



D-5

INSTALLATION
HEIGHT:

24" AFF



ST-1



T-3A

INSTALLATION
HEIGHT:

36" AFF

TYPICAL TECH ED CLASSROOM

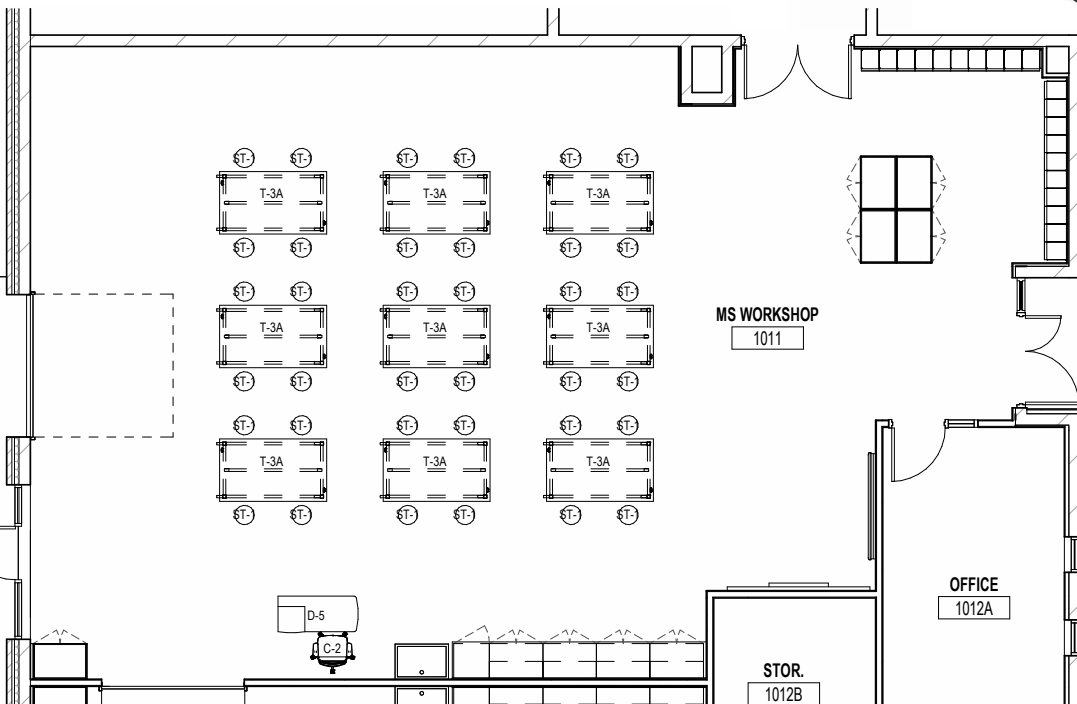
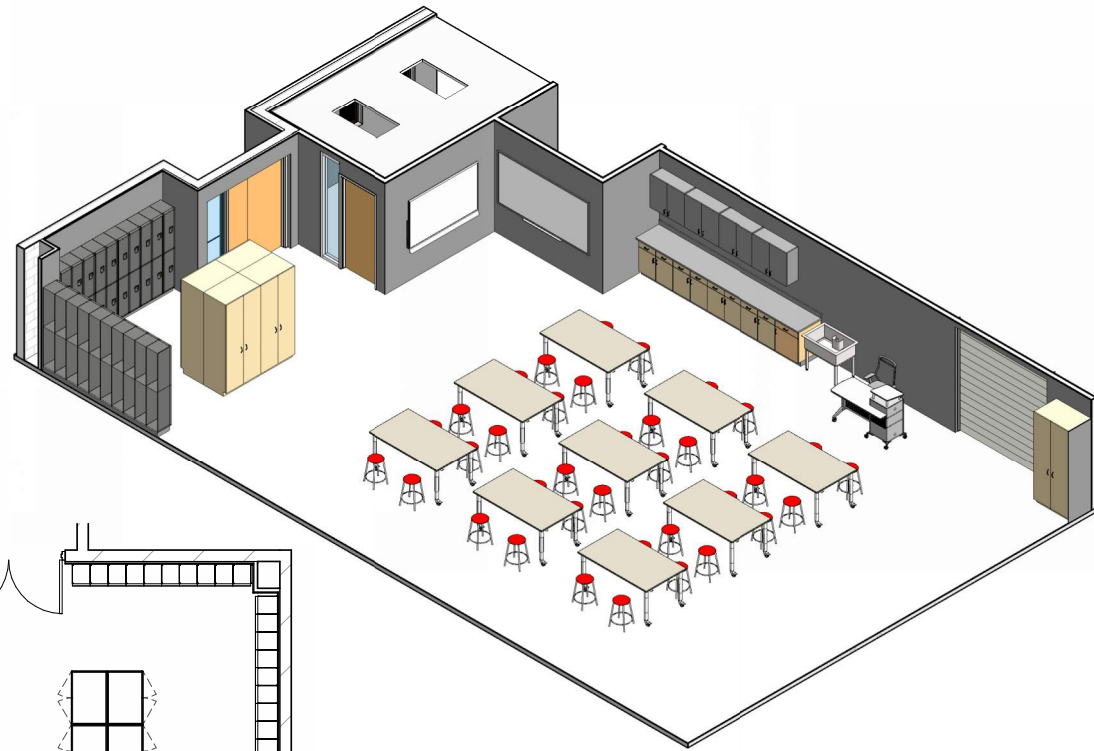

TYPICAL TECH ED CLASSROOM



C-2



D-4



L-2

INSTALLATION
HEIGHT: 26" AFF



C-7B



T-2B

INSTALLATION
HEIGHT: 26" AFF



C-8B

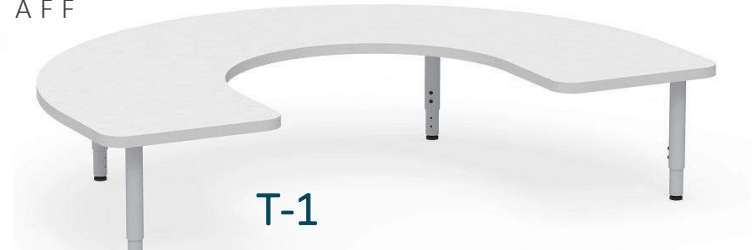

T-1



D-9



C-5B

TYPICAL PT/OT - ES

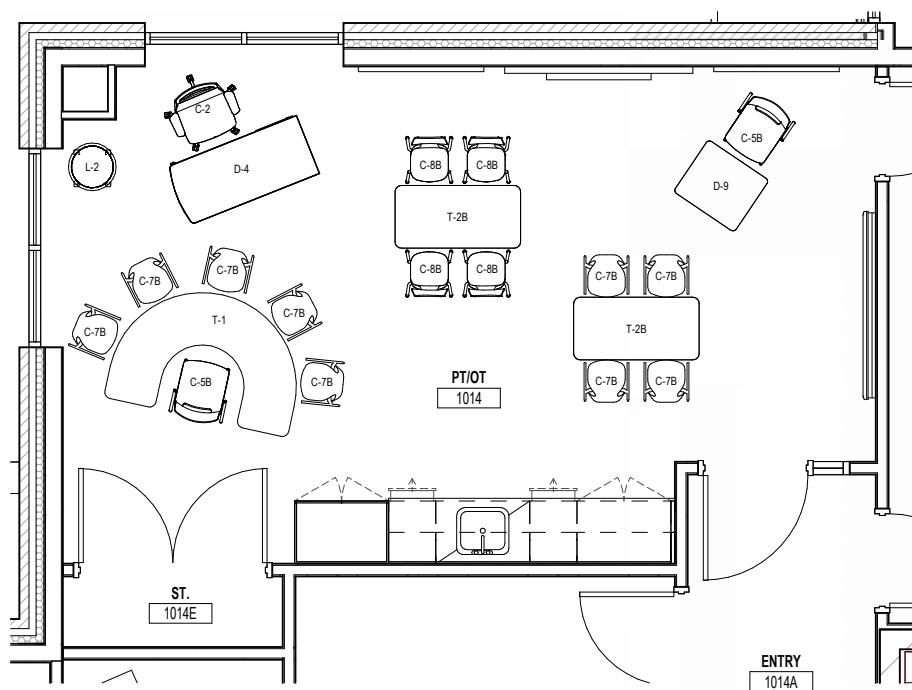

TYPICAL PT/OT

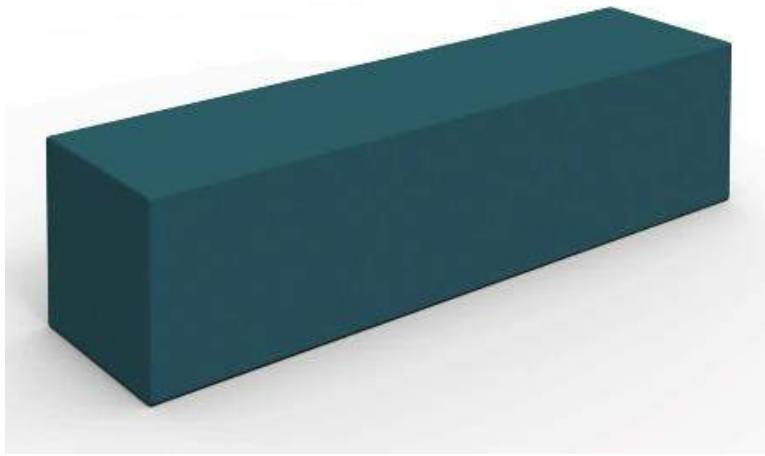

L-1B

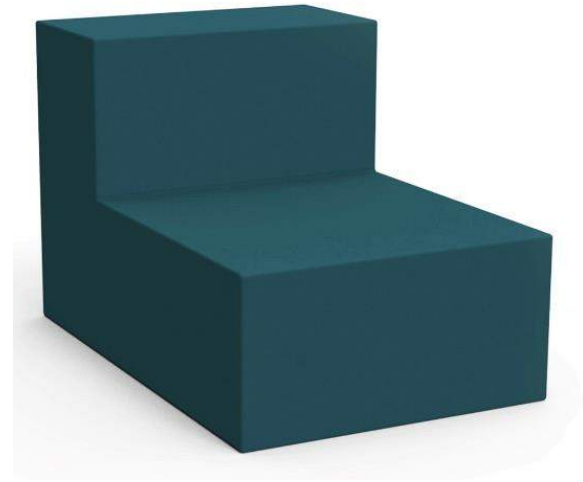

L-1C

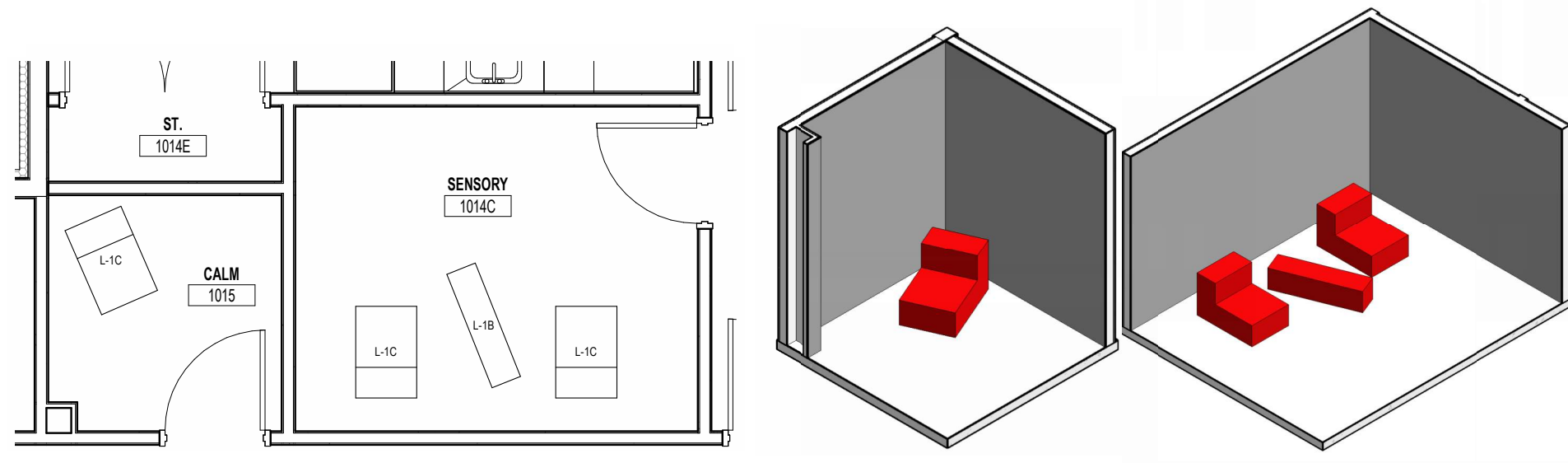

TYPICAL CALM/SENSORY ROOM



C-7B



C-8B



INSTALLATION
HEIGHT: 26" AFF

T-2B



L-3



SH-2



SH-3A



SH-3B

TYPICAL LIBRARY – ES

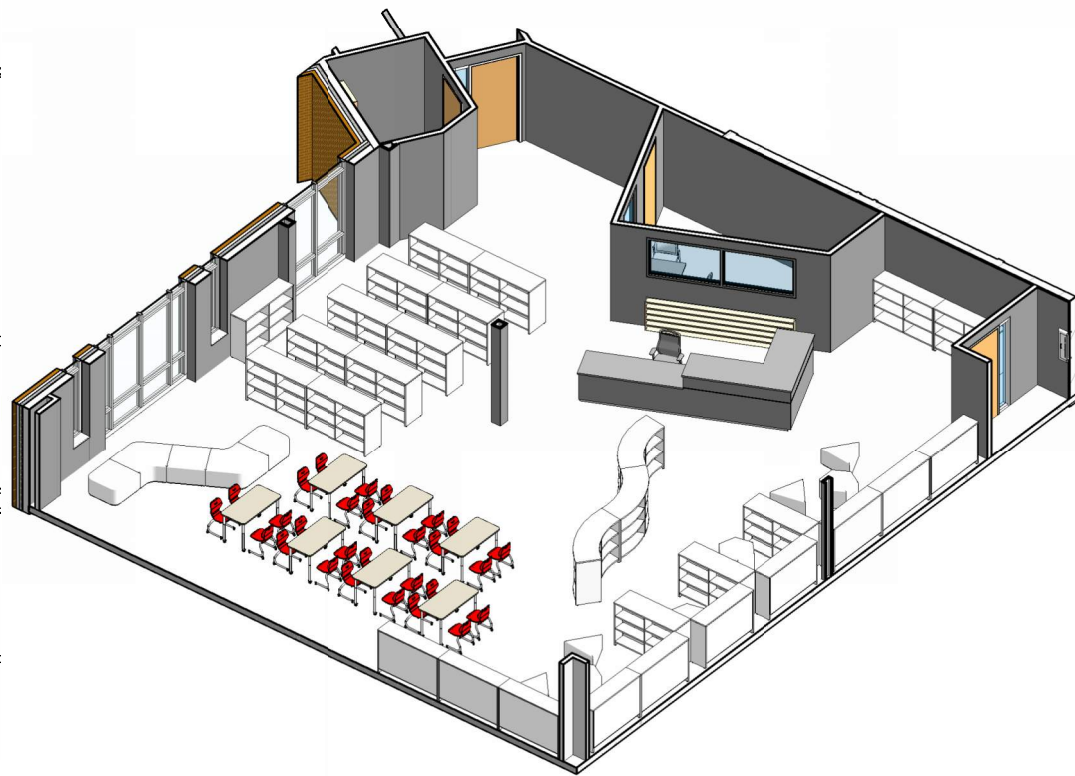
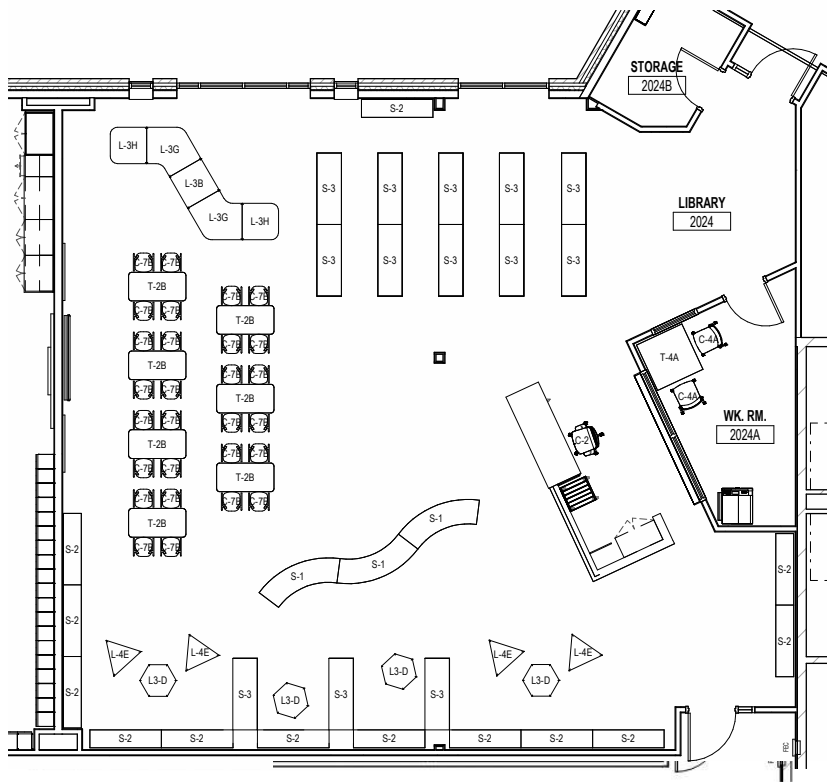

TYPICAL LIBRARY – ES



C-7C



C-8C



INSTALLATION
HEIGHT: 30" AFF

T-2C



L-3



S-4A / S-4B /
S-5A / S-5B

TYPICAL LIBRARY – MS/HS

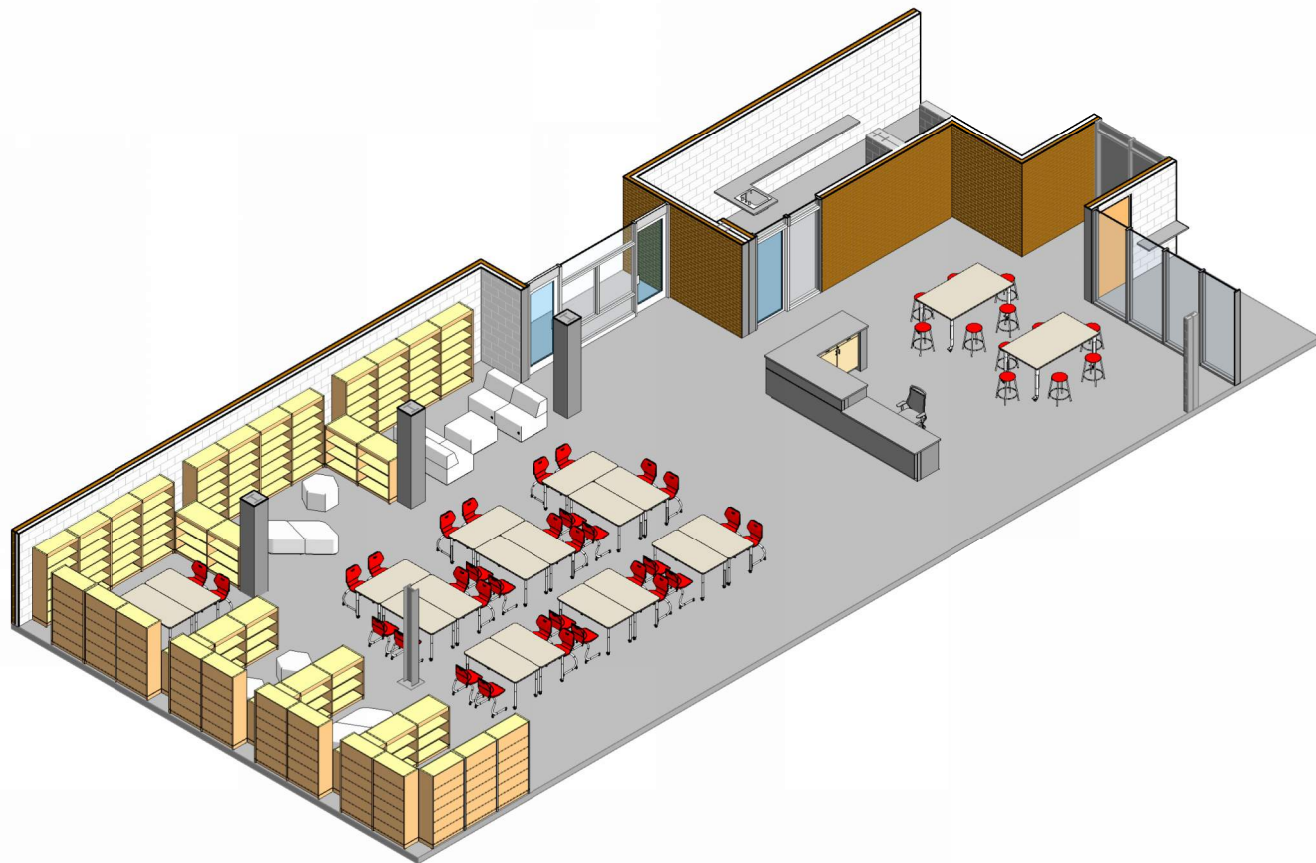
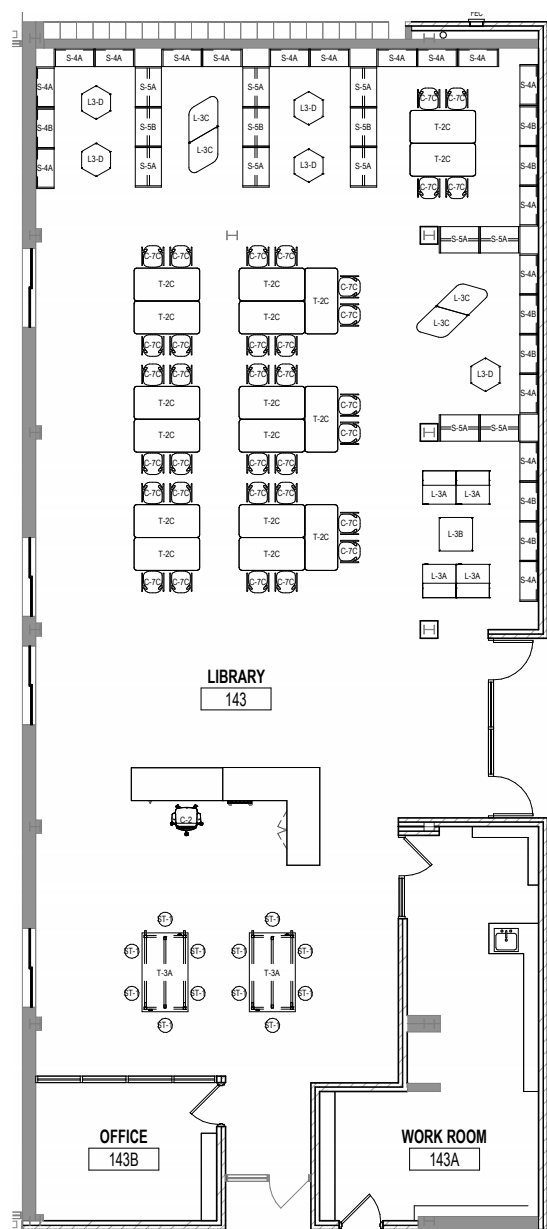

TYPICAL LIBRARY – MS/HS

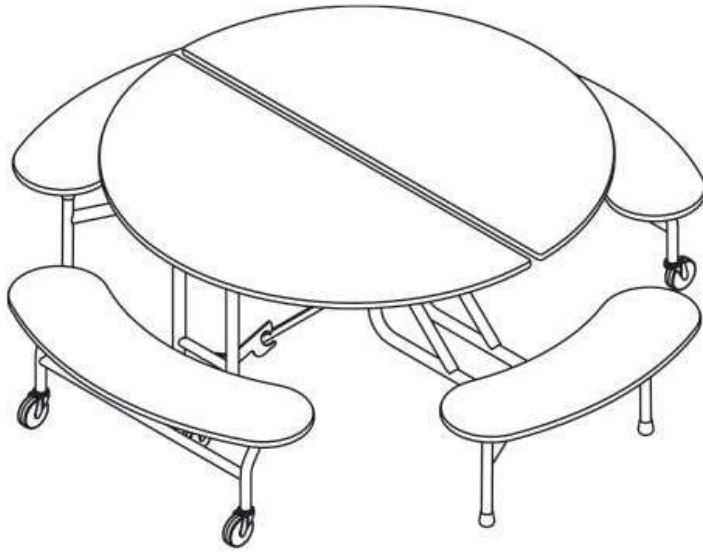

T-7A / T-7B



T-8A / T-8B

TYPICAL CAFETERIA – ES/MS/HS

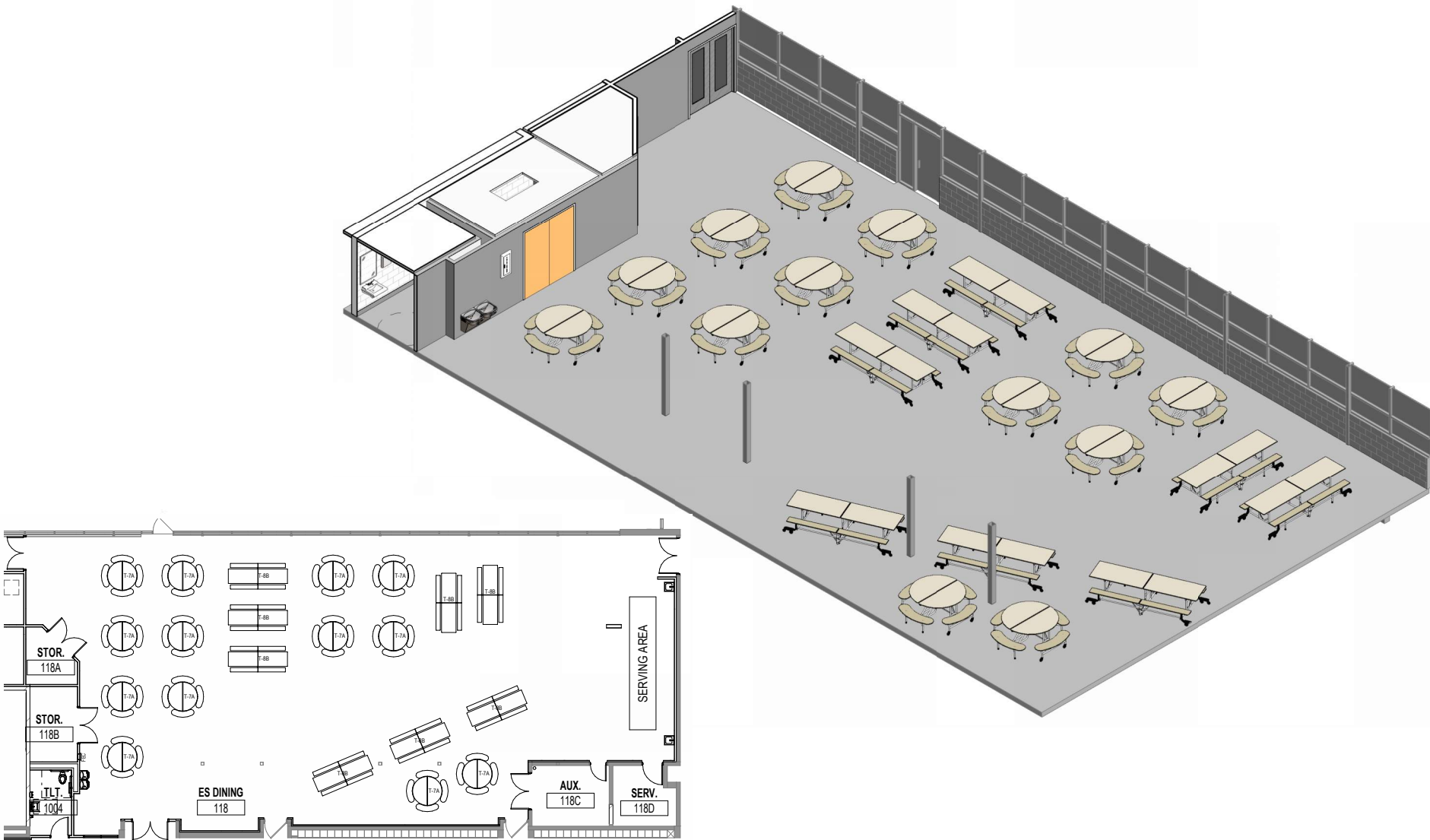

TYPICAL CAFETERIA – ES/MS/HS



C-2

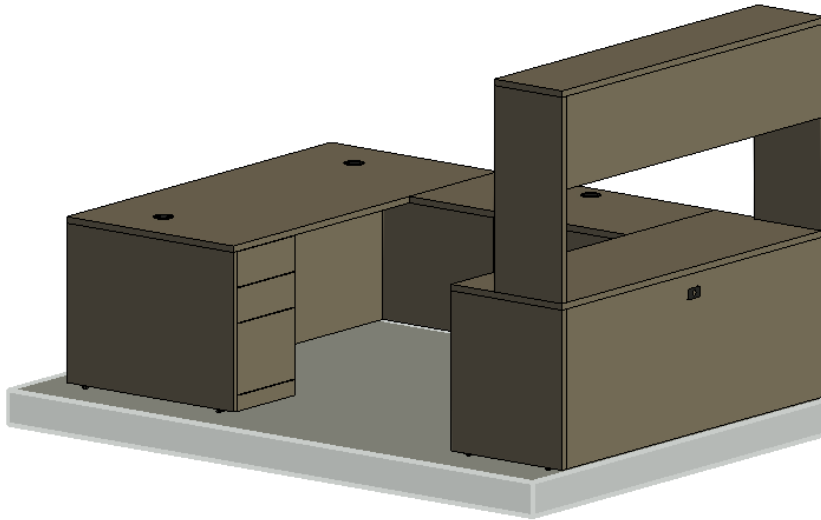

CR-1



T-9A



C-4B

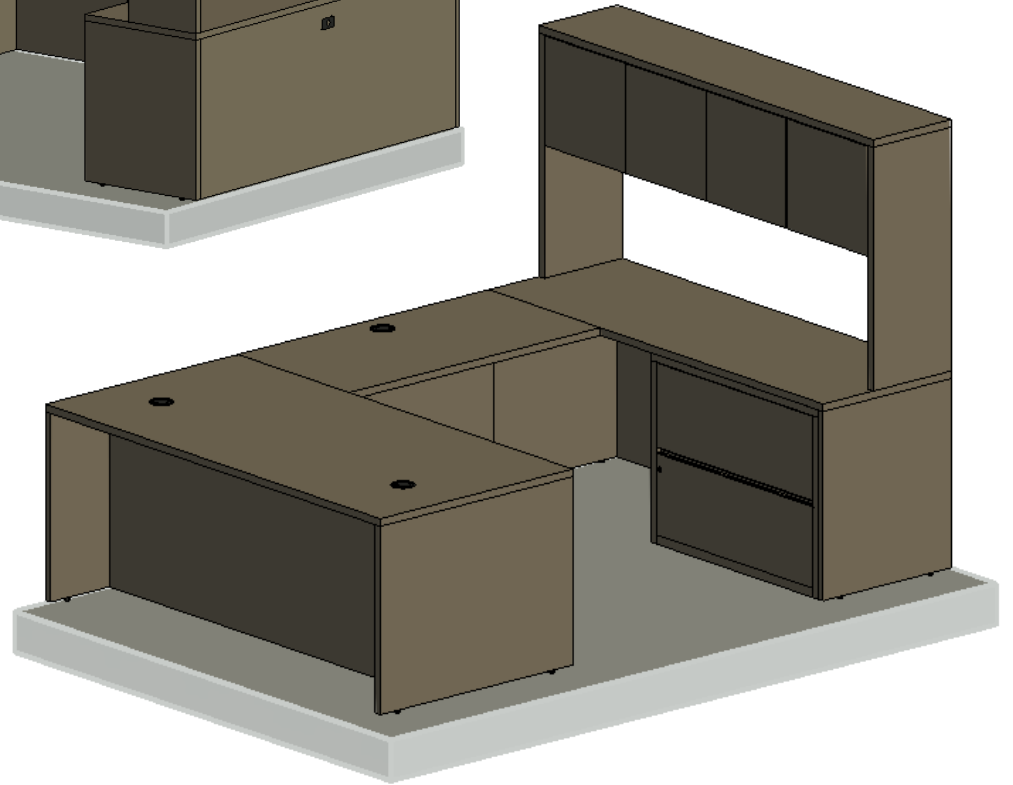

D-8

TYPICAL PRIVATE OFFICE – LARGE

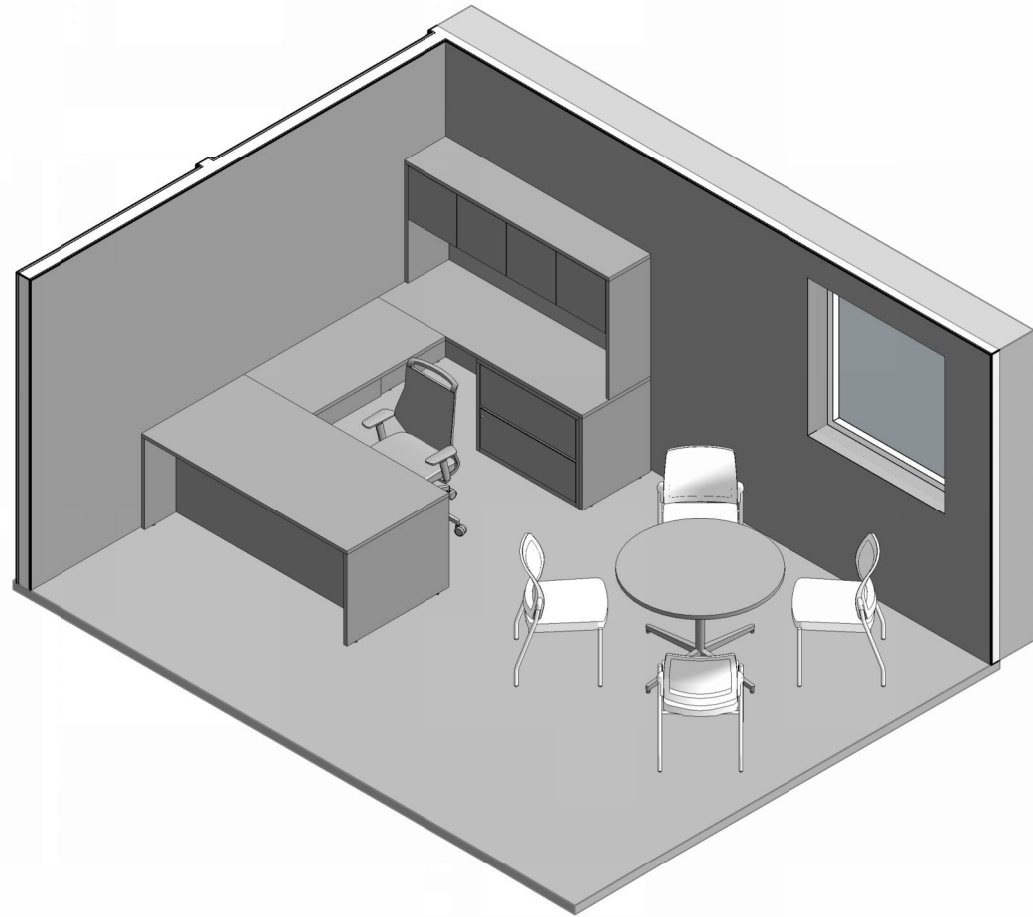
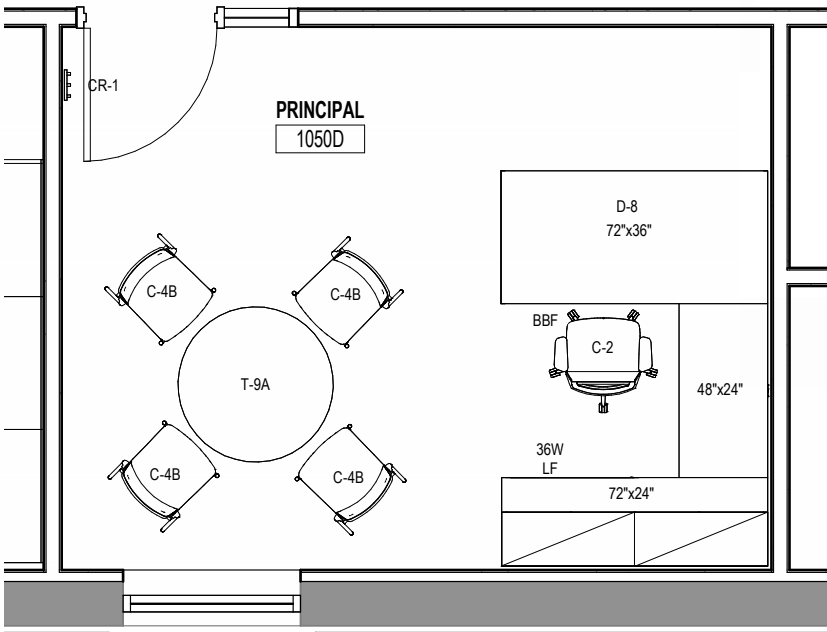

TYPICAL PRIVATE OFFICE – LARGE



C-2



C-4B

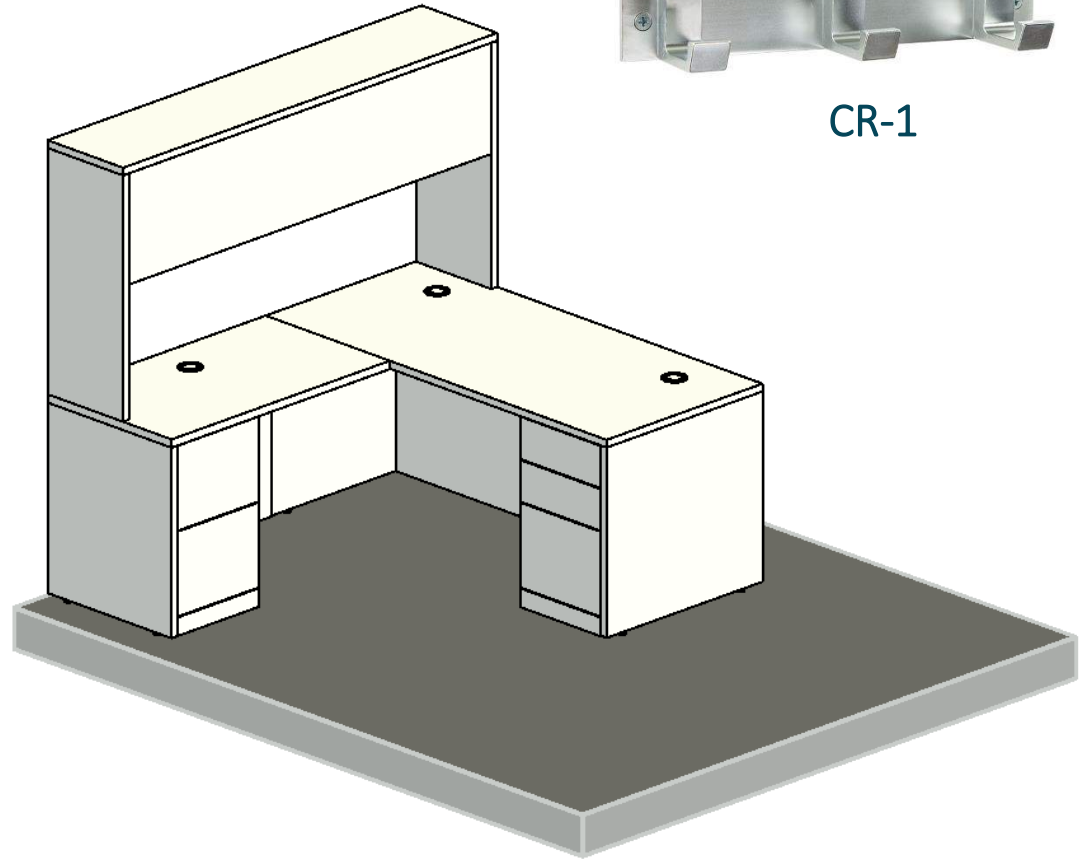

D-7



CR-1

TYPICAL PRIVATE OFFICE – STANDARD

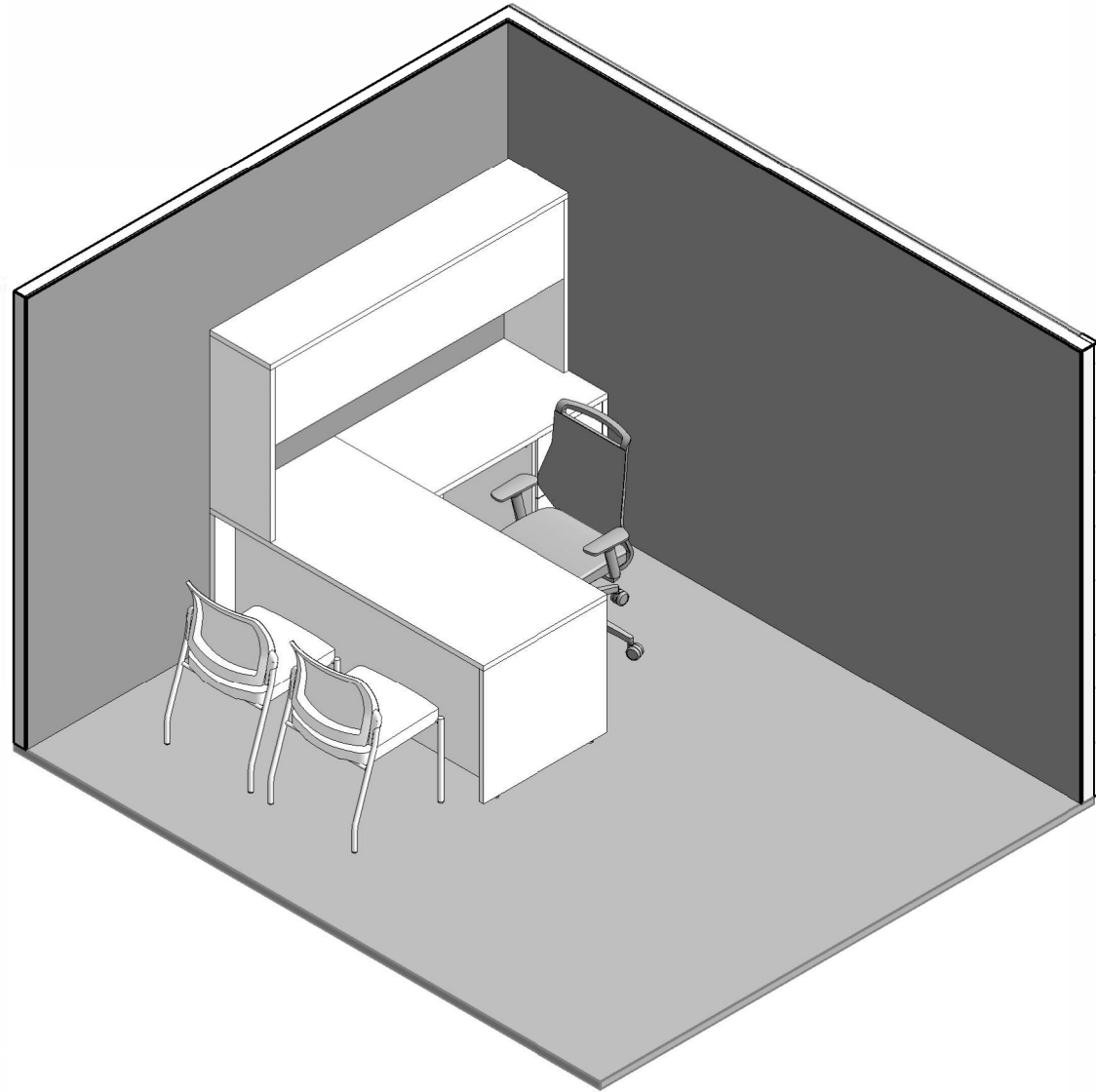
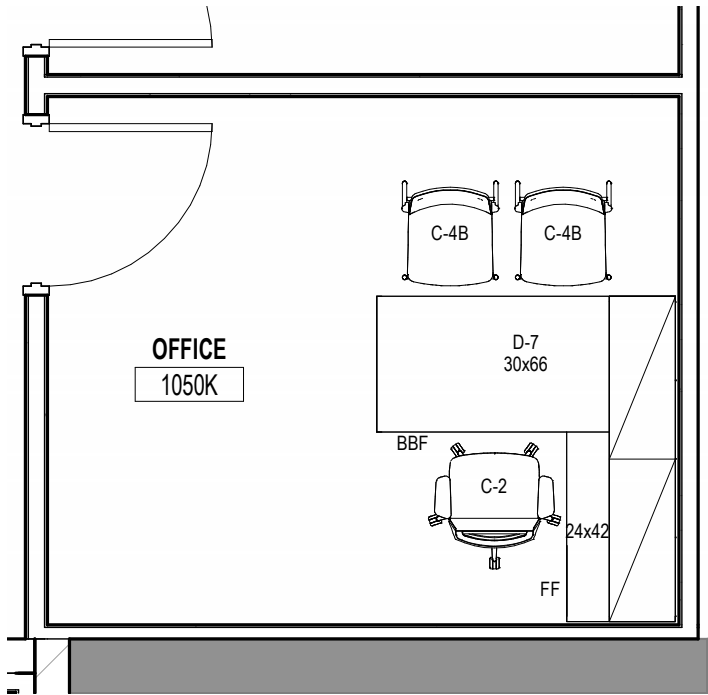

TYPICAL PRIVATE OFFICE – STANDARD



C-4A



T-4A

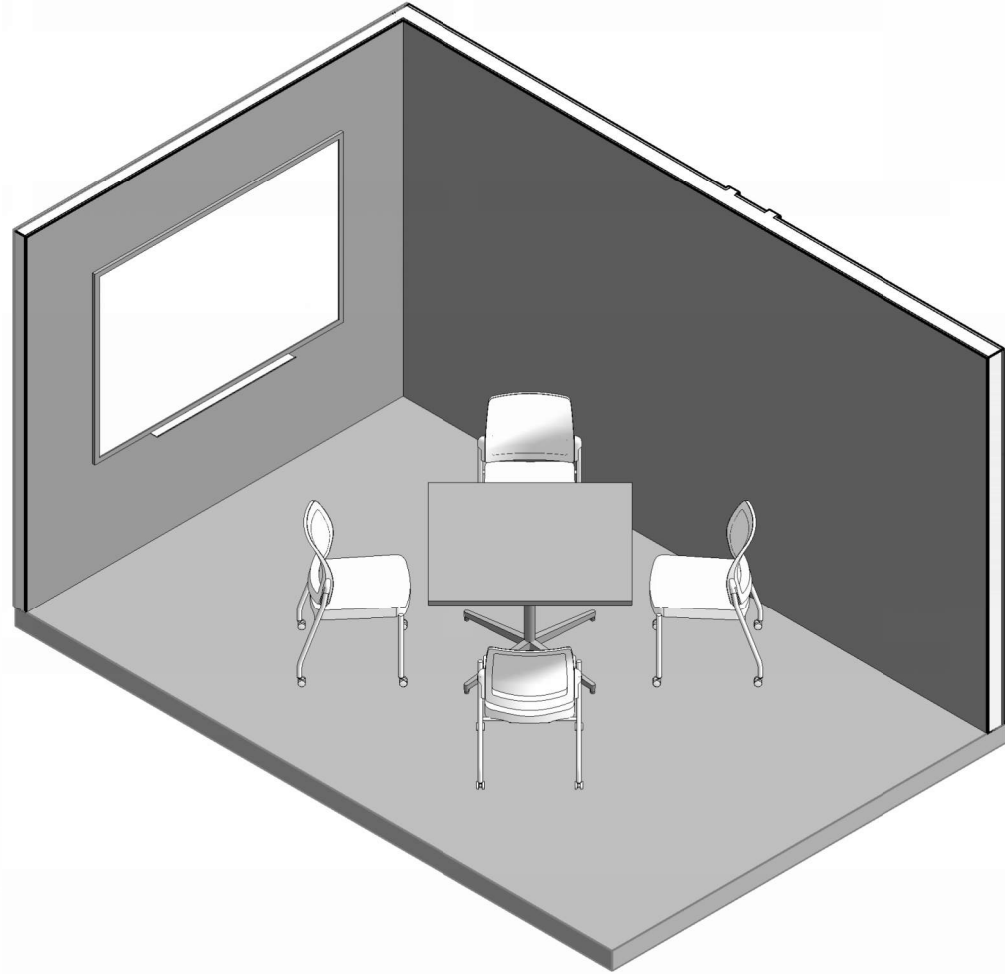
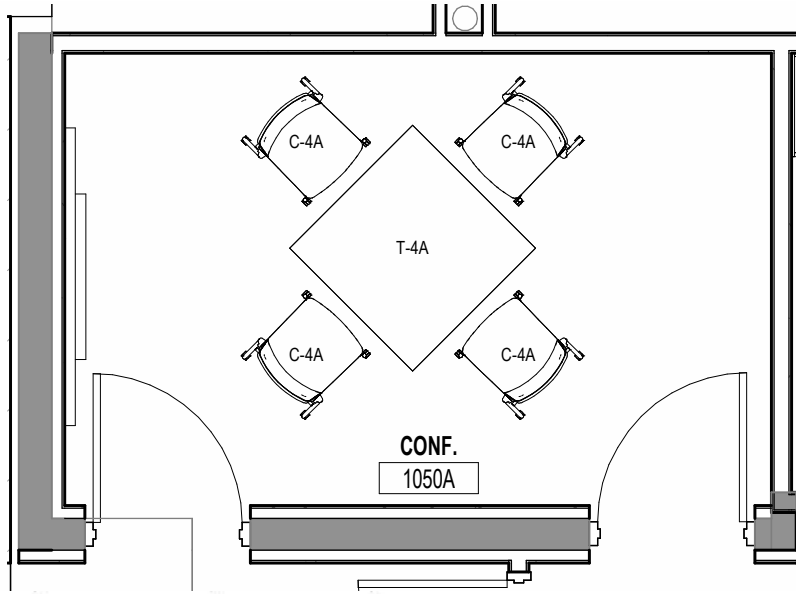

TYPICAL CONFERENCE ROOM - SMALL



C-4A

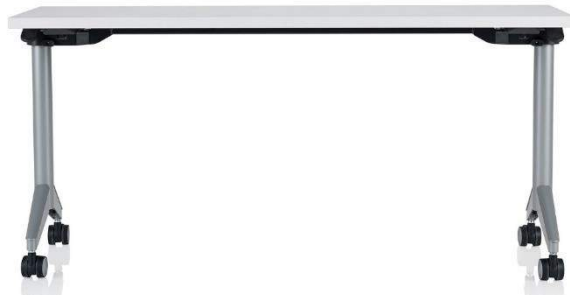

T-5

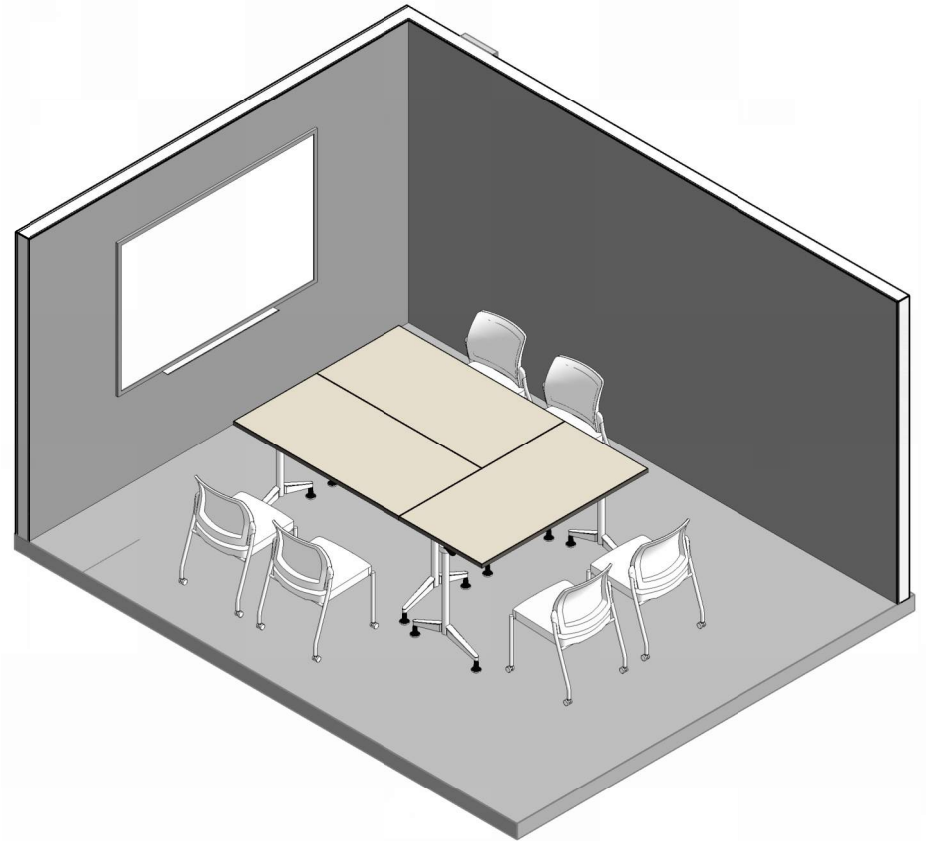
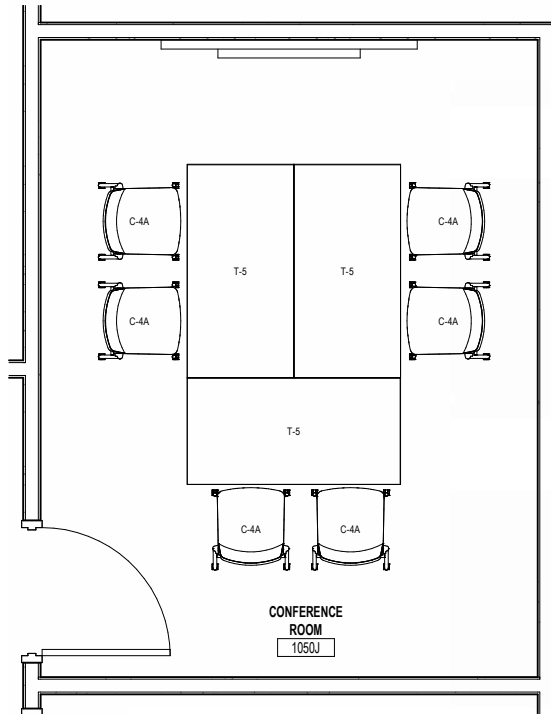

TYPICAL CONFERENCE ROOM - LARGE



C-2



PED-1



PEDESTAL SEAT



C-4B

T-6

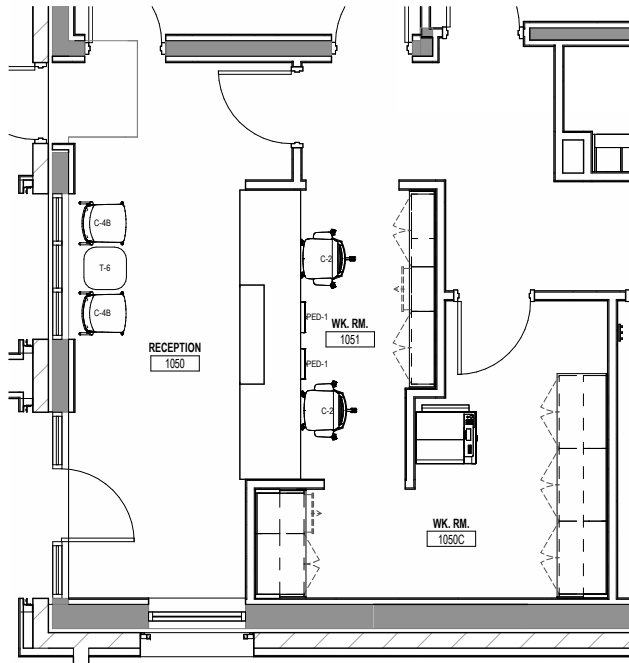

TYPICAL RECEPTION





C-2



PED-1



PEDESTAL
SEAT



C-4B



T-6

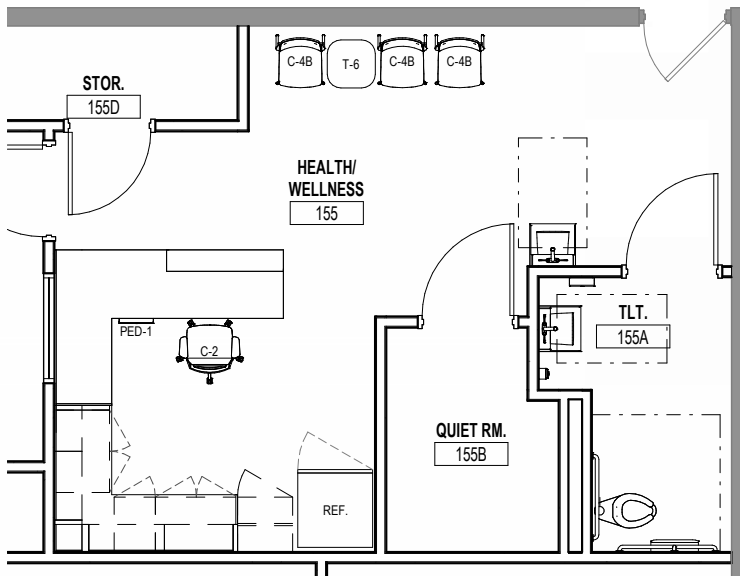

TYPICAL HEALTH ROOM



C-6



T-6

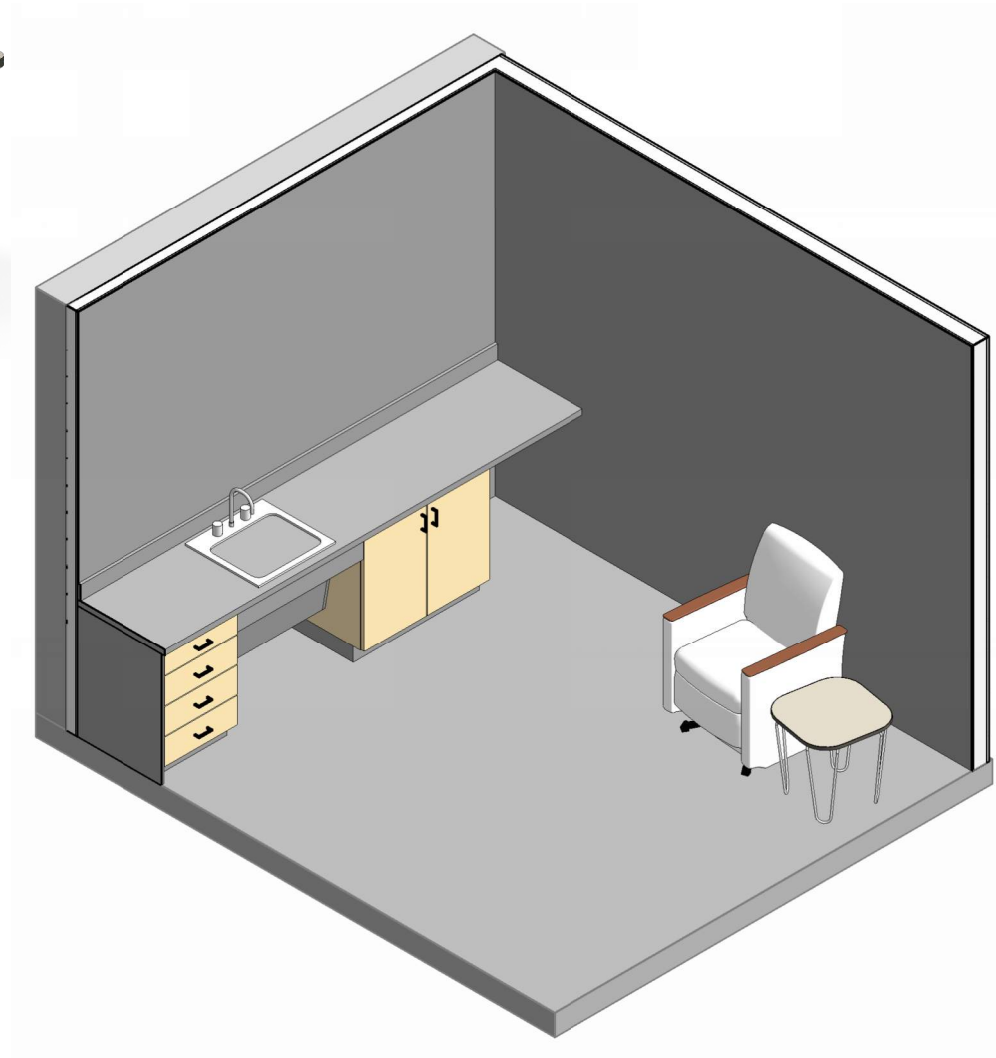
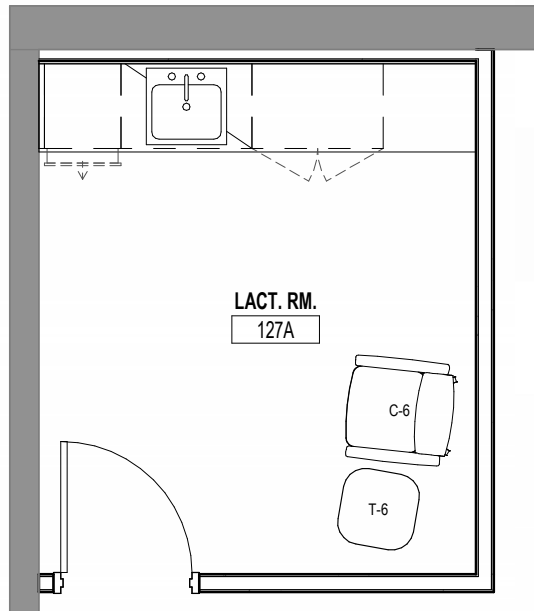

TYPICAL LACTATION/WELLNESS ROOM



C-4A



T-4A

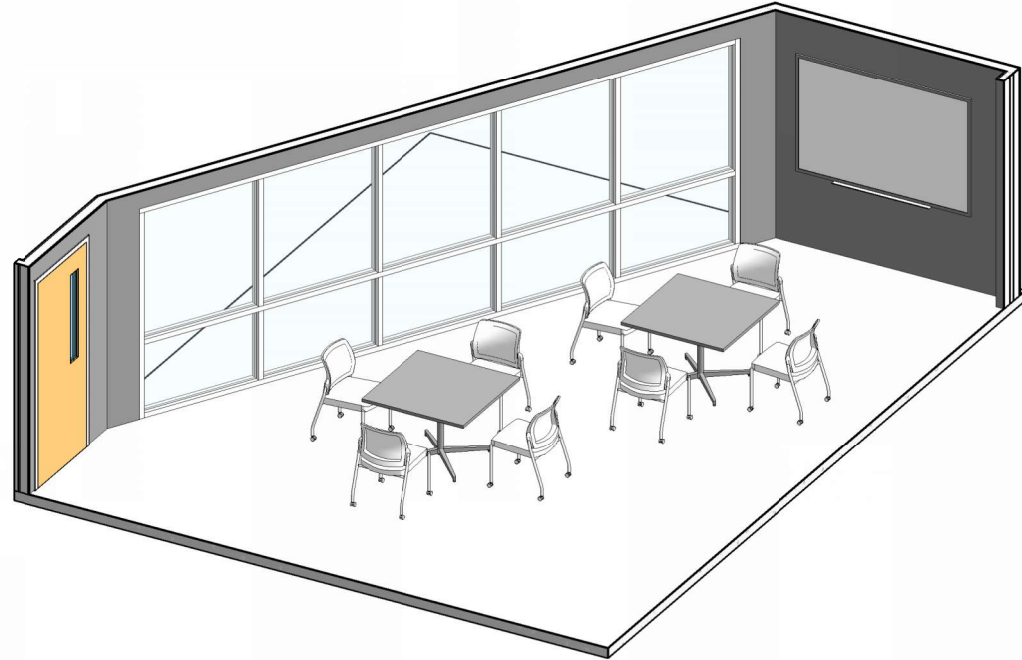
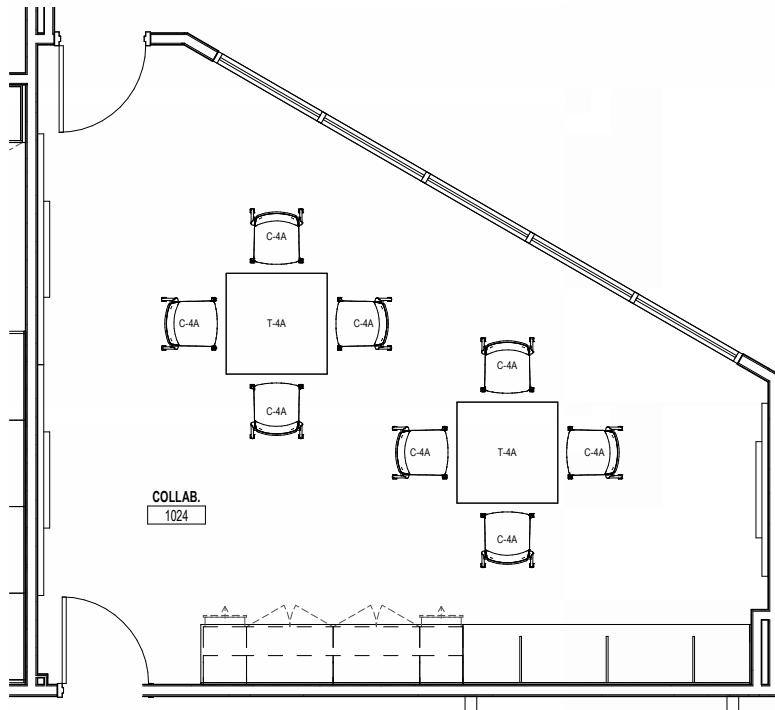

TYPICAL COLLABORATION ROOM



C-5B



T-4A

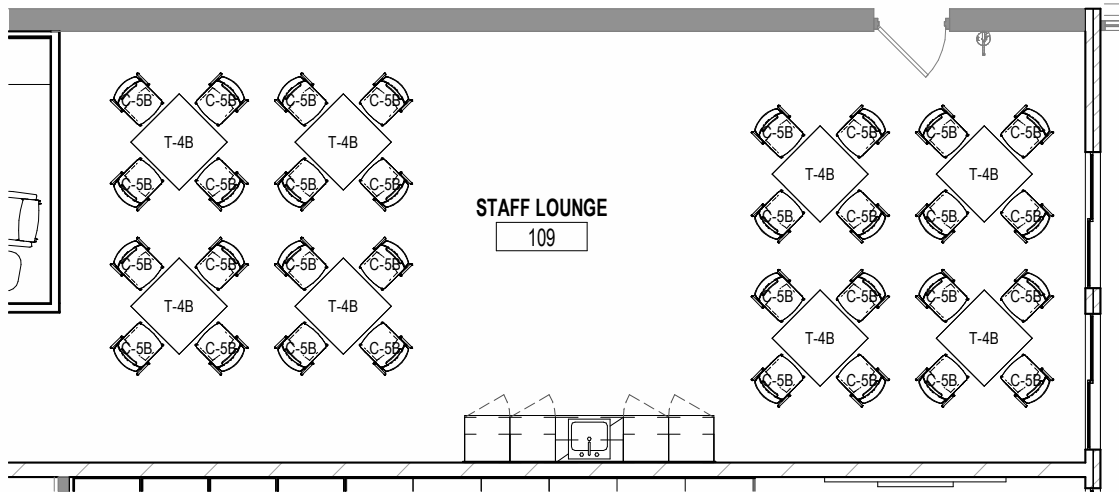
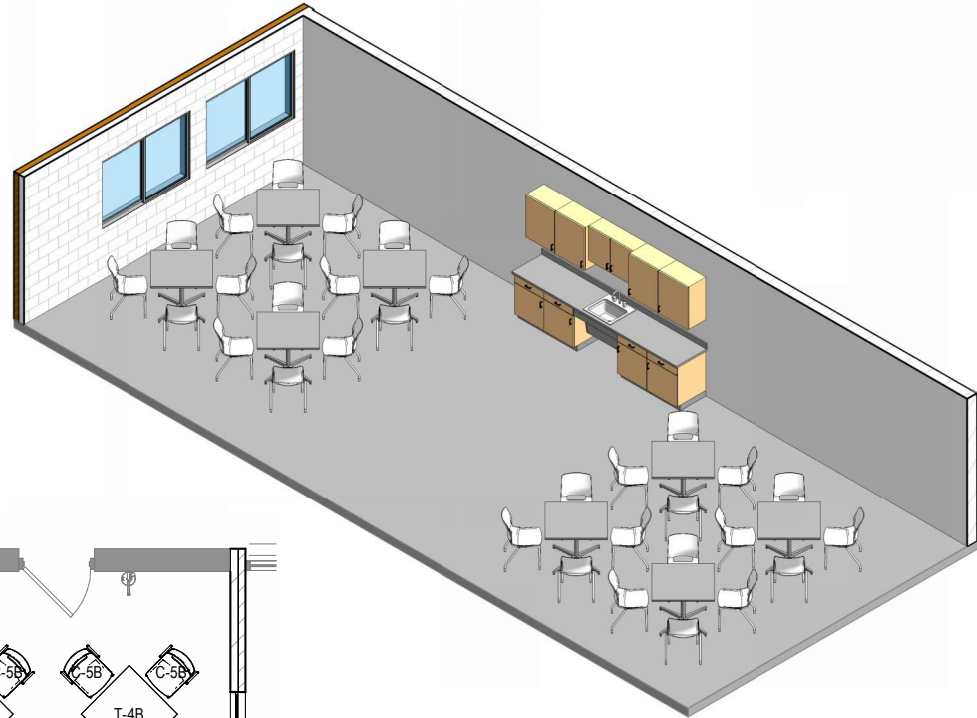

TYPICAL STAFF LOUNGE



C-3

T-5

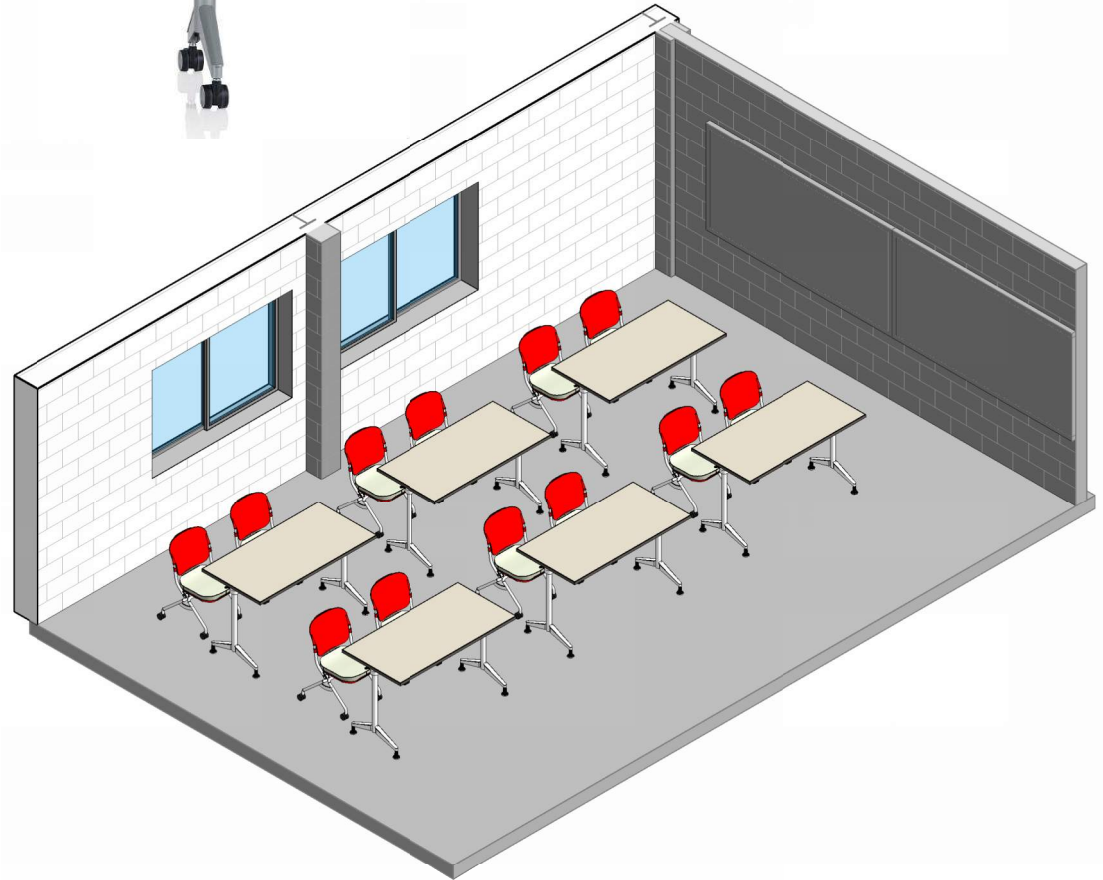
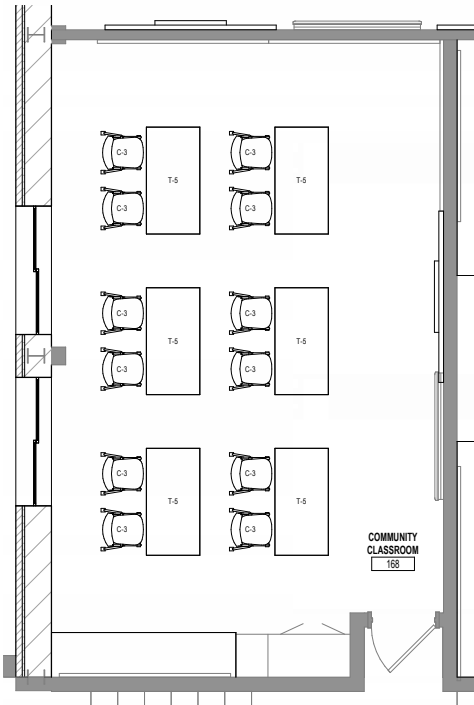

TYPICAL COMMUNITY CLASSROOM



**RACINE
UNIFIED
SCHOOL DISTRICT**

PRODUCT SPECIFICATIONS



MFR.	KI
SERIES	PROMENADE SEATING SYSTEM
PROD. #	--
DESCRIPTION	ARMLESS BENCH WITH THREE PERFORATED STEEL SEATS WITH OUTDOOR COATING EMBEDDED BASE WITH OUTDOOR COATING
WARRANTY	LIFETIME
SIZE	69"W X 26"D X 32"H
SEAT COLOR: FRAME COLOR:	BLACK (BL) BLACK (BL)

B-1 BENCH

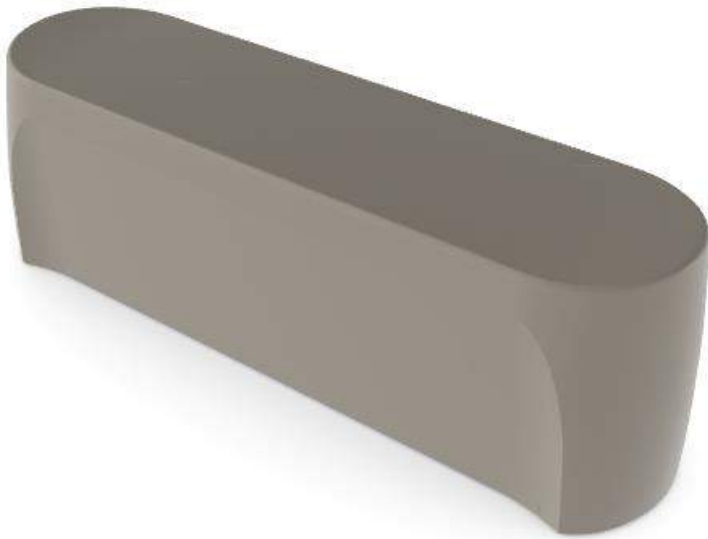

MFR.	PINEAPPLE
SERIES	RYNO BENCH
PROD. #	1RYN-00
DESCRIPTION	WEIGHTED MODEL – 194LBS
WARRANTY	LIFETIME
SIZE	55"W X 15.5"D X 15.5"H
FINISH:	GRANITE

B-2 BENCH



MFR.	SMITH SYSTEM
SERIES	BOOKTRUCK, SIX SLOPING SHELF
PROD. #	21001
DESCRIPTION	4" DIAMETER DUAL WHEEL CASTERS WITH SOFT TREAD WITH SLIDING BOOK SUPPORT/SHELF DIVIDER 400 POUND WEIGHT CAPACITY
WARRANTY	LIFETIME
SIZE	36"W X 18"D X 43"H
FINISH:	SELECT FROM STANDARD FINISHES TO ALIGN WITH SCHOOL BRANDING

BT-1 BOOK TRUCK



MFR.	SMITH SYSTEM
SERIES	BOOKTRUCK, THREE FLAT SHELF
PROD. #	21051
DESCRIPTION	4" DIAMETER DUAL WHEEL CASTERS WITH SOFT TREAD 400 POUND WEIGHT CAPACITY
WARRANTY	LIFETIME
SIZE	36"W X 18"D X 43"H
FINISH:	SELECT FROM STANDARD FINISHES TO ALIGN WITH SCHOOL BRANDING

BT-2 BOOK TRUCK



MFR.	HON
SERIES	IGNITION
PROD. #	HIWMBT
DESCRIPTION	TASK MID-BACK BIG & TALL CHAIR SYNCHRO-TILT (Y4) HEIGHT & WIDTH ADJUSTABLE ARMS (A) BLACK ALL-SURFACE CASTERS (A) 4-WAY MESH BACK (IM) NO LUMBAR (NL) STANDARD BASE (SB)
WARRANTY	LIFETIME WITH EXCEPTIONS
SIZE	30"W X 30"D X 46"H
FINISH – BASE: FINISH – FRAME: FINISH – MESH: FINISH – SEAT TEXTILE:	BLACK BLACK (T) BLACK (IM) CENTURION, COLOR: BLACK

C-1 TASK CHAIR – LARGE SCALE



MFR.	HON
SERIES	IGNITION
PROD. #	HIWMM
DESCRIPTION	MID-BACK TASK CHAIR SYNCHRO-TILT W/ SEAT SIDE (Y1) HEIGHT & WIDTH ADJUSTABLE ARMS (A) BLACK ALL-SURFACE CASTERS (S) 4-WAY MESH BACK (IM) NO LUMBAR (NL) STANDARD BASE (SB)
WARRANTY	LIFETIME WITH EXCEPTIONS
SIZE	27"W X 24"D X 43 ¾ "H
FINISH – BASE: FINISH – FRAME: FINISH – MESH: FINISH – SEAT TEXTILE:	BLACK BLACK (T) BLACK (IM) CENTURION, COLOR: BLACK

C-2 TASK CHAIR – STANDARD SCALE



MFR.	KI
SERIES	TORSION ON THE GO!
PROD. #	TGNAPB
DESCRIPTION	POLY BACK ARMLESS CHAIR FLEX BACK FLIP-UP SEAT CARPET & HARD FLOOR CASTERS
WARRANTY	LIFETIME
SIZE	23.5"W X 24.25"D X 32.25"H
FINISH – FRAME: FINISH – POLY BACK: FINISH – SEAT:	FLANNEL (FN) FLANNEL (PFN) PALLAS, PATTERN: LUMIERE, COLOR: SELECT FROM STANDARD FINISHES TO ALIGN WITH SCHOOL BRANDING

C-3 COMMUNITY & MULTIPURPOSE ROOM CHAIR



MFR.	HON
SERIES	IGNITION
PROD. #	HIGS6
DESCRIPTION	BLACK ALL-SURFACE CASTER (S) 4-WAY STRETCH MESH BACK UPHOLSTERED SEAT ARMLESS
WARRANTY	LIFETIME WITH EXCEPTIONS
SIZE	25"W X 21 ¾"D X 33 ½"H
FINISH – FRAME: FINISH – MESH BACK: FINISH – SEAT UPHOLSTERY:	BLACK BLACK HON, PATTERN: SAXONY, COLOR: SELECT FROM STANDARD FINISHES TO ALIGN WITH SCHOOL BRANDING

C-4A CONFERENCE & COLLABORATION ROOM CHAIR



MFR.	HON
SERIES	IGNITION
PROD. #	HIGS6
DESCRIPTION	GLIDES (E) 4-WAY STRETCH MESH BACK UPHOLSTERED SEAT ARMLESS
WARRANTY	LIFETIME WITH EXCEPTIONS
SIZE	25"W X 21 ¾"D X 33 ½"H
FINISH – FRAME: FINISH – MESH BACK: FINISH – SEAT UPHOLSTERY:	BLACK BLACK HON, PATTERN: SAXONY, COLOR: SELECT FROM STANDARD FINISHES TO ALIGN WITH SCHOOL BRANDING

C-4B THERAPY ROOM, GUEST & WAITING ROOM CHAIR



MFR.	HON
SERIES	MOTIVATE HIGH-DENSITY STACKER
PROD. #	HMS1
DESCRIPTION	PLASTIC SHELL ARMLESS (N) INCLUDE GLIDES FOR MOTIVATE HIGH-DENSITY STACKER (HMSGLD)
WARRANTY	LIFETIME WITH EXCEPTIONS
SIZE	21"W X 23"D X 32 ¼"H
FINISH – PLASTIC SHELL: FINISH – BASE:	SELECT FROM STANDARD FINISHES TO ALIGN WITH SCHOOL BRANDING TEXTURED SILVER (PR8)

C-5A STACKING CHAIR



MFR.	HON
SERIES	MOTIVATE 4-LEG CHAIR
PROD. #	HMG1
DESCRIPTION	PLASTIC SHELL ARMLESS (N) STANDARD NYLON GLIDES €
WARRANTY	LIFETIME WITH EXCEPTIONS
SIZE	21"W X 23"D X 32 ¼"H
FINISH – PLASTIC SHELL: FINISH – BASE:	SELECT FROM STANDARD FINISHES TO ALIGN WITH SCHOOL BRANDING TEXTURED SILVER (PR8)

C-5B STACKING CHAIR

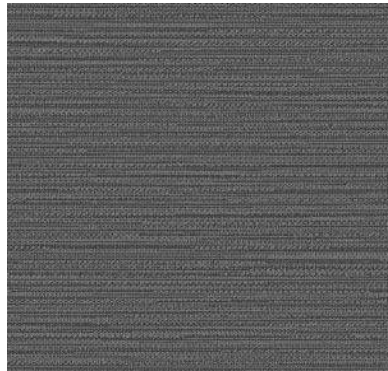

MOMENTUM
PATTERN: SANYA CV
COLOR: SLATE

MFR.	OFS
SERIES	MODERN AMENITY PATIENT GLIDER
PROD. #	1616
DESCRIPTION	WELLNESS ROOM CHAIR POLY ARM CAPS
WARRANTY	5-YEAR
SIZE	26.5"W X 27.25"D X 39.25"H
FINISH – POLY ARM CAP: UPHOLSTERY:	BLACK MOMENTUM, PATTERN: SANYA CV, COLOR: SLATE

C-6 WELLNESS ROOM CHAIR



MFR.	KI
SERIES	INTELLECT WAVE CHAIR
PROD. #	IWC13
DESCRIPTION	SMALL POLYPROPYLENE CHAIR CANTILEVER BASE NYLON GLIDES
WARRANTY	LIFETIME
SIZE	15 3/8"W X 14 1/4"D X 23 7/8"H
FINISH – POLY SHELL: FINISH – FRAME COLOR:	SELECT FROM STANDARD FINISHES TO ALIGN WITH SCHOOL BRANDING WARM GREY (WG)

C-7A STUDENT CHAIR – 4K-1ST



MFR.	KI
SERIES	INTELLECT WAVE CHAIR
PROD. #	IWC15
DESCRIPTION	MEDIUM POLYPROPYLENE CHAIR CANTILEVER BASE NYLON GLIDES
WARRANTY	LIFETIME
SIZE	17 1/8"W X 17"D X 25 5/8"H
FINISH – POLY SHELL: FINISH – FRAME COLOR:	SELECT FROM STANDARD FINISHES TO ALIGN WITH SCHOOL BRANDING WARM GREY (WG)

C-7B STUDENT CHAIR – 2ND-4TH



MFR.	KI
SERIES	INTELLECT WAVE CHAIR
PROD. #	IWC18
DESCRIPTION	LARGE POLYPROPYLENE CHAIR CANTILEVER BASE NYLON GLIDES
WARRANTY	LIFETIME
SIZE	20 3/8"W X 20 1/2"D X 32 1/4"H
FINISH – POLY SHELL: FINISH – FRAME COLOR:	SELECT FROM STANDARD FINISHES TO ALIGN WITH SCHOOL BRANDING WARM GREY (WG)

C-7C STUDENT CHAIR – 5TH - 12TH



MFR.	SMITH SYSTEM
SERIES	FLAVORS NOODLE CHAIR
PROD. #	11853
DESCRIPTION	4 LEG CHAIR 14" NOODLE CHAIR NYLON GLIDE
WARRANTY	FRAME: LIFETIME SHELL: 12 YEARS
SIZE	17.5"W X 17"D X 26"H
FINISH – SHELL: FINISH – FRAME:	SELECT FROM STANDARD FINISHES TO ALIGN WITH SCHOOL BRANDING PLATINUM

C-8A STUDENT WOBBLE CHAIR – K-1ST



MFR.	SMITH SYSTEM
SERIES	FLAVORS NOODLE CHAIR
PROD. #	11852
DESCRIPTION	4 LEG CHAIR 16" NOODLE CHAIR NYLON GLIDE
WARRANTY	FRAME: LIFETIME SHELL: 12 YEARS
SIZE	18"W X 18"D X 29"H
FINISH – SHELL: FINISH – FRAME:	SELECT FROM STANDARD FINISHES TO ALIGN WITH SCHOOL BRANDING PLATINUM

C-8B STUDENT WOBBLE CHAIR – 2ND-4TH



MFR.	SMITH SYSTEM
SERIES	FLAVORS NOODLE CHAIR
PROD. #	11851
DESCRIPTION	4 LEG CHAIR 18" NOODLE CHAIR NYLON GLIDE
WARRANTY	FRAME: LIFETIME SHELL: 12 YEARS
SIZE	19.5"W X 20.5"D X 31"H
FINISH – SHELL: FINISH – FRAME:	SELECT FROM STANDARD FINISHES TO ALIGN WITH SCHOOL BRANDING PLATINUM

C-8C STUDENT WOBBLE CHAIR – 5TH-12TH



MFR.	WENGER
SERIES	STUDENT CHAIR
PROD. #	--
DESCRIPTION	STUDENT MUSIC CHAIR SEAT HEIGHT: 15.5"H
SIZE	19 ¾"W X 21 ¼"D X 31 3/8"H
FINISH – SHELL: FINISH – FRAME:	BLACK BLACK

C-9A STUDENT MUSIC CHAIR – ES



MFR.	WENGER
SERIES	STUDENT CHAIR
PROD. #	--
DESCRIPTION	STUDENT MUSIC CHAIR SEAT HEIGHT: 17.5"H
SIZE	19 7/8"W X 22"D X 33 1/4"H
FINISH – SHELL: FINISH – FRAME:	BLACK BLACK

C-9B STUDENT MUSIC CHAIR – MS/HS



MFR.	PETER PEPPER PRODUCTS
SERIES	COAT RACKS: WALL MOUNTED RACKS
PROD. #	2142
DESCRIPTION	COAT RACK – 3 HOOKS ON FLUSH PLATE
WARRANTY	3 YEAR
SIZE	8 1/4"W X 1 3/4"D X 1 3/8"H
FINISH:	ALUMINUM

CR-1 COAT RACK



MFR.	KI
SERIES	INTELLECT WAVE DESK
PROD. #	IWD4FHA
DESCRIPTION	ADJUSTABLE HEIGHT HARD PLASTIC TOP 4-LEG DESK WITH BOOK BOX (BB) & BOOK BAG HOOK (BH) STRAIGHT FRONT TOP (SFT) NYLON GLIDES (NG)
WARRANTY	LIFETIME
SIZE	25 ¾"W X 18 7/8"D X 22-34"H
FINISH – PLASTIC TOP: FINISH – FRAME: FINISH – BOOK BOX:	WHITE NEBULA WARM GREY (WG) TRANSPARENT

D-1 STUDENT DESK – K-1ST



MFR.	KI
SERIES	INTELLECT WAVE DESK
PROD. #	IWDCH/A
DESCRIPTION	ADJUSTABLE HEIGHT HARD PLASTIC TOP CANTILEVER DESK WITH BOOK BOX (BB) & BOOK BAG HOOK (BH) STRAIGHT FRONT TOP (SFT) NYLON GLIDES (NG)
WARRANTY	LIFETIME
SIZE	25 ¾"W X 18 7/8"D X 24-30"H
FINISH – PLASTIC TOP: FINISH – FRAME: FINISH – BOOK BOX:	WHITE NEBULA WARM GREY (WG) TRANSPARENT

D-2 STUDENT DESK – 2ND-5TH



MFR.	KI
SERIES	INTELLECT WAVE DESK
PROD. #	IWDEH
DESCRIPTION	HARD PLASTIC TOP DOUBLE ENTRY DESK SLED BASE POLYPROPYLENE SEAT WITH BOOK BAG HOOK (BH) WITH BOOK RACK NYLON GLIDES (NG)
WARRANTY	LIFETIME
SIZE	25 ¾"W X 36 ¾"D X 29"H
FINISH – PLASTIC TOP: FINISH – FRAME: FINISH – SHELL COLOR:	WHITE NEBULA WARM GREY (WG) SELECT FROM STANDARD FINISHES TO ALIGN WITH SCHOOL BRANDING

D-3A STUDENT DESK – 6TH-12TH



MFR.	KI
SERIES	INTELLECT WAVE DESK
PROD. #	IWXDH
DESCRIPTION	HARD PLASTIC TOP XL DOUBLE ENTRY DESK SLED BASE POLYPROPYLENE SEAT WITH BOOK BAG HOOK (BH) WITH BOOK RACK NYLON GLIDES (NG)
WARRANTY	LIFETIME
SIZE	25 ¾"W X 38 3/8"D X 30"H
FINISH – PLASTIC TOP: FINISH – FRAME: FINISH – SHELL COLOR:	WHITE NEBULA WARM GREY (WG) SELECT FROM STANDARD FINISHES TO ALIGN WITH SCHOOL BRANDING

D-3B STUDENT DESK – 6TH-12TH



MFR.	KI
SERIES	INSTRUCT MOBILE PEDESTAL DESK
PROD. #	INPDSL2460
DESCRIPTION	D-SHAPE DESKTOP PILLAR POST LEGS STEEL MODESTY PANEL WORKSURFACE LEFT (WSL) OR WORKSURFACE RIGHT (WSR) KEY ALIKE PER GRADE LEVEL (KA) 6 BLACK CASTERS – 4 LOCKING (4CW) METRIC PULL
WARRANTY	LIFETIME
SIZE	60"W X 24"D X 29"H
FINISH – LAMINATE TOP: FINISH – EDGE BAND: FINISH – GROMMET COLOR: FINISH – METAL: LOCK COLOR:	SATIN STAINLESS (LSS), SILICON EVOLV (LSV), OR TITANIUM EVOLV (LTV) FLANNEL (EFN) WARM GREY (TWG) FLANNEL (FN) BLACK (BLL)

D-4 TEACHER DESK - ES



MFR.	KI
SERIES	INSTRUCT ALL TERRAIN MOBILE INSTRUCTOR'S DESK
PROD. #	ATMTDP2460
DESCRIPTION	MOBILE INSTRUCTOR'S DESK 42"W USABLE WORK SURFACE SLOPED LANDING PAD WORKSURFACE LEFT (WSL) OR WORKSURFACE RIGHT (WSR) KEY ALIKE PER GRADE LEVEL (KA) 6 BLACK CASTERS – 4 LOCKING (4CW) METRIC PULL
WARRANTY	LIFETIME
SIZE	61 5/8"W X 26 1/2"D X 40"H
FINISH – LAMINATE TOP: FINISH – EDGE BAND: FINISH – GROMMET COLOR: FINISH – METAL: LOCK COLOR:	SATIN STAINLESS (LSS), SILICON EVOLV (LSV), OR TITANIUM EVOLV (LTV) FLANNEL (EFN) WARM GREY (TWG) FLANNEL (FN) BLACK (BLL)

D-5 TEACHER DESK – MS/HS

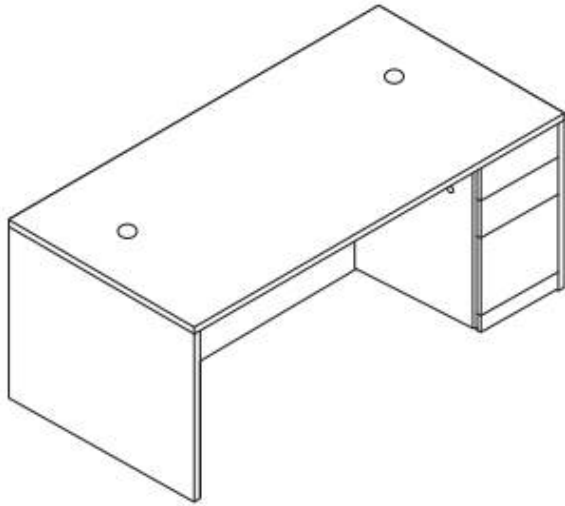

WILSONART
COLOR: STERLING ASH

MFR.	HON
SERIES	10500 SERIES
DESCRIPTION	SINGLE PEDESTAL DESK BOX/BOX/FILE; LOCKING FULL HEIGHT MODESTY PANEL DESK TO HAVE (2) GROMMETS REFER TO FLOOR PLAN FOR CONFIGURATION
SIZE	REFER TO FLOOR PLAN FOR SIZING (STANDARD 30"D X 66"W)
FINISH – PLAM COLOR:	WILSONART, STERLING ASH

D-6 DESK

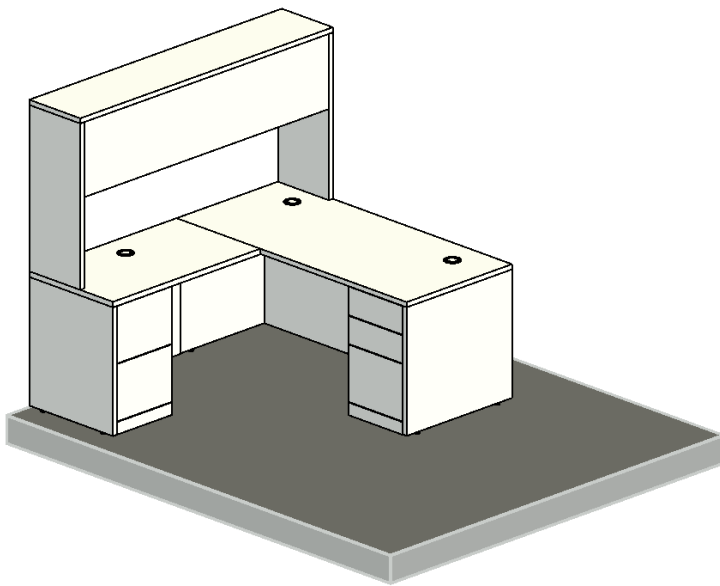

WILSONART
COLOR: STERLING ASH

MFR.	HON
SERIES	10500 SERIES
DESCRIPTION	L-SHAPED DESK UNIT BOX/BOX/FILE AT DESK; LOCKING FILE/FILE AT RETURN; LOCKING OVERHEAD STORAGE HUTCH WITH HINGED DOORS, TACKBOARD, AND TASK LIGHT; LOCKING FULL HEIGHT MODESTY PANELS DESK TO HAVE (2) GROMMETS; RETURN TO HAVE (1) GROMMET DESK UNIT TO BE KEYED ALIKE REFER TO FLOOR PLAN FOR CONFIGURATION
SIZE	REFER TO FLOOR PLAN FOR SIZING (STANDARD 30"D X 66"W WITH 24"D X 42"W RETURN)
FINISH – PLAM COLOR:	WILSONART, STERLING ASH

D-7 DESK – L-SHAPED

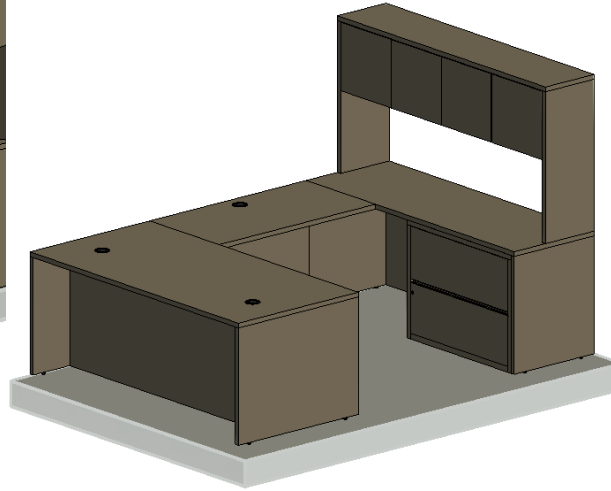
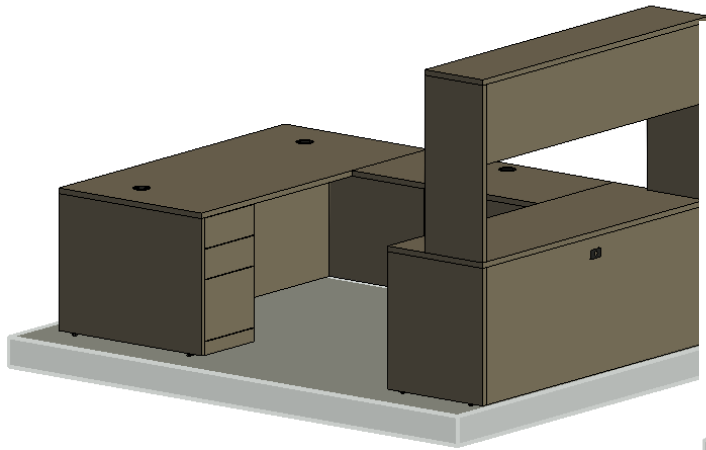

WILSONART
COLOR: STERLING ASH



MFR.	HON
SERIES	10500 SERIES
DESCRIPTION	<p>U-SHAPED DESK UNIT BOX/BOX/FILE AT DESK; LOCKING 36" W LATERAL FILE AT CREDENZA; LOCKING OVERHEAD STORAGE HUTCH WITH HINGED DOORS, TACKBOARD, AND TASK LIGHT; LOCKING FULL HEIGHT MODESTY PANELS AT DESK AND CREDENZA DESK TO HAVE (2) GROMMETS; BRIDGE TO HAVE (1) GROMMET DESK UNIT TO BE KEYED ALIKE REFER TO FLOOR PLAN FOR CONFIGURATION</p>
SIZE	REFER TO FLOOR PLAN FOR SIZING (STANDARD 36"D X 72"W WITH 24"D X 48"W RETURN & 24"W X 72"W CREDENZA)
FINISH – PLAM COLOR:	WILSONART, STERLING ASH

D-8 DESK – U-SHAPED



MFR.	HON
SERIES	ROLL CALL
PROD. #	HETLEC-REC2028
DESCRIPTION	TEACHER LECTERN NO GROMMET
SIZE	28"W X 24"D X 28.5-43.5"H
FINISH – LAMINATE TOP: FINISH – EDGE BAND: FINISH – CYLINDER PAINT: FINISH – BASE PAINT:	SELECT FROM STANDARD FINISHES TO ALIGN WITH SCHOOL FINISHES MATCH LAMINATE TOP SILVER SILVER

D-9 DESK – EA MOBILE DESK

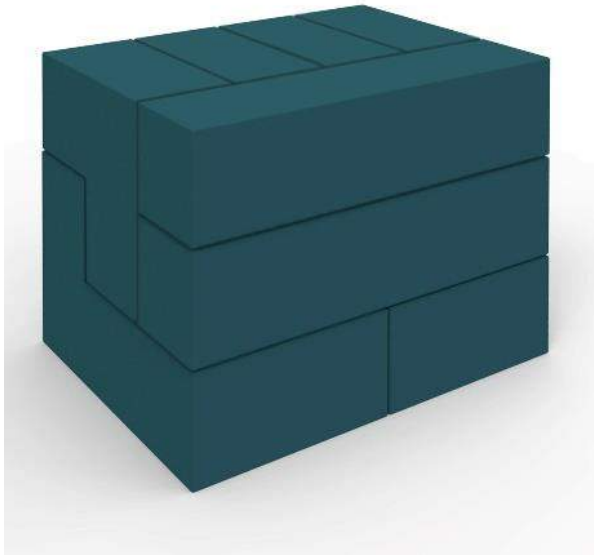

MFR.	KI
SERIES	IMAGINASIUM BLOCKS
PROD. #	MGBKBNDL8
DESCRIPTION	BUNDLE (2 I-BLOCKS, 2 L-BLOCKS, 4 V-BLOCKS)
WARRANTY	LIFETIME
SIZE	OVERALL: 33"W X 44"D X 33"H I-BLOCK: 11"W X 44"D X 11"H L-BLOCK: 22"W X 33"D X 22"H V-BLOCK: 11"W X 22"D X 22"H
UPHOLSTERY:	PALLAS, PATTERN: ORIGIN, COLOR: SELECT FROM STANDARD FINISHES TO ALIGN WITH SCHOOL BRANDING USE NEUTRAL COLORS IN CALM ROOMS, SENSORY ROOMS & OLDER GRADES

L-1A LOUNGE SEATING – ELEMENTARY

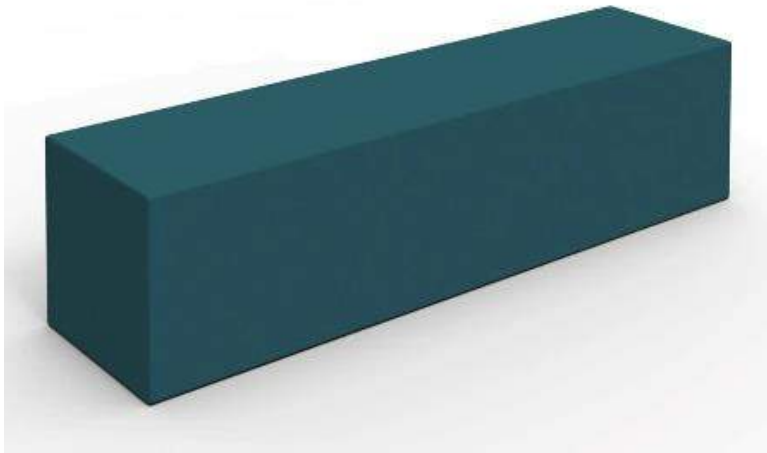

MFR.	KI
SERIES	IMAGINASIUM BLOCKS
PROD. #	MGBK001
DESCRIPTION	I-BLOCK
WARRANTY	LIFETIME
SIZE	11"W X 44"D X 11"H
UPHOLSTERY:	PALLAS, PATTERN: ORIGIN, COLOR: SELECT FROM STANDARD FINISHES TO ALIGN WITH SCHOOL BRANDING USE NEUTRAL COLORS IN CALM ROOMS, SENSORY ROOMS & OLDER GRADES

L-1B LOUNGE SEATING – ELEMENTARY

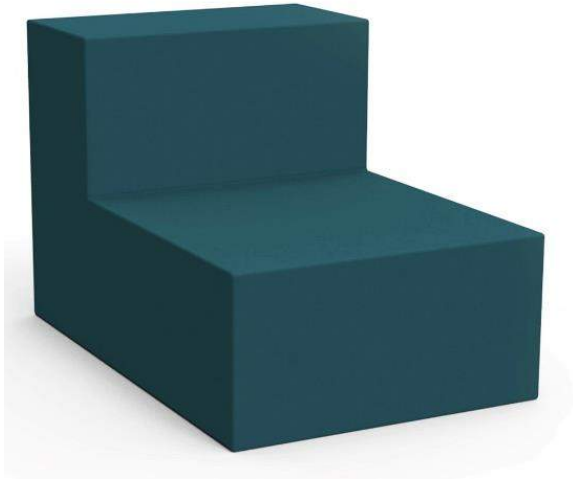

MFR.	KI
SERIES	IMAGINASIUM BLOCKS
PROD. #	MGBK002
DESCRIPTION	L-BLOCK
WARRANTY	LIFETIME
SIZE	22"W X 33"D X 22"H
UPHOLSTERY:	PALLAS, PATTERN: ORIGIN, COLOR: SELECT FROM STANDARD FINISHES TO ALIGN WITH SCHOOL BRANDING USE NEUTRAL COLORS IN CALM ROOMS, SENSORY ROOMS & OLDER GRADES

L-1C LOUNGE SEATING – ELEMENTARY

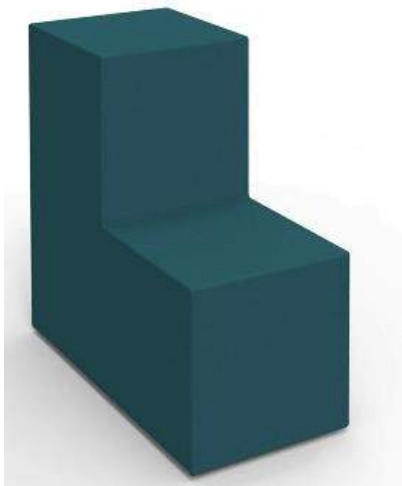

MFR.	KI
SERIES	IMAGINASIUM BLOCKS
PROD. #	MGBK003
DESCRIPTION	V-BLOCKS
WARRANTY	LIFETIME
SIZE	11"W X 22"D X 22"H
UPHOLSTERY:	PALLAS, PATTERN: ORIGIN, COLOR: SELECT FROM STANDARD FINISHES TO ALIGN WITH SCHOOL BRANDING USE NEUTRAL COLORS IN CALM ROOMS, SENSORY ROOMS & OLDER GRADES

L-1D LOUNGE SEATING – ELEMENTARY



MFR.	KI
SERIES	IMAGINASIVM BLIPS
PROD. #	MGBP10PADCAD
DESCRIPTION	MOBILE STORAGE CADDY WITH TEN BLIPS WITH HANDLE (WHL)
WARRANTY	LIFETIME
SIZE	OVERALL: 18 ¼"W X 18 ¼"D X 34 5/8"H INDIVIDUAL BLIP: 16"DIA X 3"H
FINISH – FRAME COLOR: UPHOLSTERY:	WARM GREY (WG) PALLAS, PATTERN: ORIGIN, COLOR: SELECT FROM STANDARD FINISHES TO ALIGN WITH SCHOOL BRANDING USE NEUTRAL COLORS IN CALM ROOMS, SENSORY ROOMS & OLDER GRADES

L-2 LOUNGE SEATING – ELEMENTARY



MFR.	HON
SERIES	TANGRAM
PROD. #	VARIES
DESCRIPTION	USE COMBINATION OF PIECES FROM THIS LINE TO SATISFY EACH SCHOOLS NEED NO MOUNTED COUNTERTOPS
WARRANTY	LIMITED LIFETIME
SIZE	VARIES
UPHOLSTERY:	STINSON, PATTERN: ROUND TRIP STINSON, PATTERN: VECTOR HON, PATTERN: SAXONY USE A COMBINATION OF SAXONY AND ROUND TRIP <u>OR</u> VECTOR ON ALL PIECES. SELECT COLORS FROM STANDARD FINISHES TO ALIGN WITH SCHOOL BRANDING

L-3 LOUNGE SEATING



MFR.	WENGER
SERIES	CLASSIC 50 MUSIC STAND
PROD. #	039E500
DESCRIPTION	STUDENT MUSIC STAND
SIZE	20"W X 25"-49"H
FINISH – FRAME:	BLACK

MS-1 MUSIC STAND



PEDESTAL
SEAT

MFR.	HON
SERIES	FLAGSHIP MOBILE PEDESTAL
PROD. #	H15923
DESCRIPTION	BOX/FILE WITH PEDESTAL SEAT (HPSEAT24ND) BLACK PLASTIC CASTERS INCLUDE PENCIL TRAY LOCKABLE – KEY SEPARATELY – MASTER KEY PROVIDED TO SCHOOL FULL RADIUS PULL
WARRANTY	LIMITED LIFETIME
SIZE	15"W X 22 7/8"D X 22"H
FINISH: UPHOLSTERY:	TITANIUM HON, PATTERN: SAXONY, PREFERRED COLOR: STORM CLOUD SXNY19 <u>OR</u> SELECT FROM STANDARD FINISHES TO ALIGN WITH SCHOOL BRANDING

PED-1 MOBILE PERSONAL STORAGE



PEDESTAL
SEAT

MFR.	KI
SERIES	ALL TERRAIN
PROD. #	ATPE1520PBFHR
DESCRIPTION	PENCIL/BOX/FILE WITH RETRACTABLE HANDLE WITH CASTERS BEVELED PULL (S5) KEY SEPARATELY – PROVIDE MASTER KEY TO SCHOOL
WARRANTY	LIMITED LIFETIME
SIZE	18 1/8"W X 21 11/32"D X 26 3/4"H
FINISH – METAL: FINISH – UPHOLSTERY:	FLANNEL PALLAS, PATTERN: ORIGIN, PREFERRED COLOR: CHARCOAL <u>OR</u> SELECT FROM STANDARD FINISHES TO ALIGN WITH SCHOOL BRANDING

PED-2 MOBILE PERSONAL STORAGE



MFR.	HON
SERIES	BOOKCASE
PROD. #	HFSC183664W
DESCRIPTION	5 SHELF BOOKCASE
WARRANTY	LIMITED LIFETIME
SIZE	36"W X 18"D X 64 ¼"H
FINISH:	TITANIUM

BC-1 BOOK CASE



MFR.	HON
SERIES	FLAGSHIP LATERAL FILE
PROD. #	H9184
DESCRIPTION	PRECONFIGURED LATERAL FILE DRAWER UNITS (LOCKING) KEY SEPARATELY - MASTER KEY PROVIDED TO SCHOOL WIDTH AND DRAWERS INDICATED PER PLAN FULL FACE INTEGRAL DRAWER PULLS
WARRANTY	LIMITED LIFETIME
SIZE	FOUR DRAWER: 36"W X 18"D X 51-1/2"H PROVIDE RAILS FOR FRONT-TO-BACK FILING IN 30" AND 42" WIDE UNITS PROVIDE RAILS FOR SIDE-TO-SIDE FILING IN 36"W UNITS PROVIDE INTEGRAL ADJUSTABLE GLIDES, INTERLOCK SAFETY MECHANISM AND PROPER COUNTER BALANCE WEIGHTS
FINISH :	TITANIUM

LF-1 LATERAL FILE



MFR.	HON
SERIES	FLAGSHIP LATERAL FILE
PROD. #	H9174
DESCRIPTION	PRECONFIGURED LATERAL FILE DRAWER UNITS (LOCKING) KEY SEPARATELY - MASTER KEY PROVIDED TO SCHOOL WIDTH AND DRAWERS INDICATED PER PLAN FULL FACE INTEGRAL DRAWER PULLS
WARRANTY	LIMITED LIFETIME
SIZE	FOUR DRAWER: 30"W X 18"D X 51-1/2"H PROVIDE RAILS FOR FRONT-TO-BACK FILING IN 30" AND 42" WIDE UNITS PROVIDE RAILS FOR SIDE-TO-SIDE FILING IN 36"W UNITS PROVIDE INTEGRAL ADJUSTABLE GLIDES, INTERLOCK SAFETY MECHANISM AND PROPER COUNTER BALANCE WEIGHTS
FINISH :	TITANIUM

LF-2 LATERAL FILE



MFR.	KI
SERIES	RUCKUS SINGLE-FACE TOTE STORAGE
PROD. #	RKT441841DR
DESCRIPTION	WITH CASTERS (2 LOCKING, ALL SWIVEL) ALL 3" HIGH TOTES (RKA3KIT6) WITHOUT DOORS
WARRANTY	LIFETIME
SIZE	44"W X 18"D X 41"H
FINISH – POWDER COAT:	WARM GREY (WG) OR SELECT FROM STANDARD FINISHES TO ALIGN WITH SCHOOL BRANDING
FINISH – CASTERS:	BLACK

SC-1 STORAGE CABINET - CLASSROOM



MFR.	HON
SERIES	FLAGSHIP STORAGE CABINET
PROD. #	HFSC183664
DESCRIPTION	PRECONFIGURED STORAGE CABINETS UNITS (LOCKING) KEY SEPARATELY - MASTER KEY PROVIDED TO SCHOOL FULL RADIUS PULLS
WARRANTY	LIMITED LIFETIME
SIZE	36"W X 18"D X 64 ¼"H
FINISH:	TITANIUM

SC-2 STORAGE CABINET



MFR.	HON
SERIES	STORYLINE
PROD. #	HESWCO42
DESCRIPTION	SINGLE SIDED 3-SHELF CURVED-OUT BOOKCASE HPL SURFACE W/ PVC EDGE BAND WITH CASTERS WITH WHITEBOARD BACK
WARRANTY	LIMITED LIFETIME
SIZE	73.6"W X 20.5"D X 42"H
FINISH – HPL: FINISH – METAL:	SELECT FROM STANDARD FINISHES TO ALIGN WITH SCHOOL FINISHES TITANIUM OR SELECT FROM STANDARD FINISHES TO ALIGN WITH SCHOOL BRANDING

S-1 SHELVING – ES LIBRARY



MFR.	HON
SERIES	STORYLINE
PROD. #	HESWLS42
DESCRIPTION	SINGLE SIDED 3-SHELF LINEAR BOOKCASE HPL SURFACE W/ PVC EDGE BAND WITH GLIDES MOUNT TO WALL
WARRANTY	LIMITED LIFETIME
SIZE	60"W X 15"D X 42"H
FINISH – HPL: FINISH – METAL:	SELECT FROM STANDARD FINISHES TO ALIGN WITH SCHOOL FINISHES TITANIUM OR SELECT FROM STANDARD FINISHES TO ALIGN WITH SCHOOL BRANDING

S-2 SHELVING – ES LIBRARY



MFR.	HON
SERIES	STORYLINE
PROD. #	HESWLD42
DESCRIPTION	DUAL SIDED 3-SHELF LINEAR BOOKCASE HPL SURFACE W/ PVC EDGE BAND WITH GLIDES
WARRANTY	LIMITED LIFETIME
SIZE	60"W X 20.5"D X 42"H
FINISH – HPL: FINISH – METAL:	SELECT FROM STANDARD FINISHES TO ALIGN WITH SCHOOL FINISHES TITANIUM OR SELECT FROM STANDARD FINISHES TO ALIGN WITH SCHOOL BRANDING

S-3 SHELVING – ES LIBRARY



MFR.	KI
SERIES	CROSSROADS
PROD. #	VARIES BASED ON HEIGHT
DESCRIPTION	SHELVING STARTER UNIT – SINGLE FACED WITH BACK PANEL & 2 STRAIGHT END PANELS 2 ADJUSTABLE, 2 FIXED SHELVES MOUNT TO WALL
WARRANTY	LIMITED LIFETIME
SIZE	37 ½"W X 12"D X HEIGHT DETERMINED BASED ON LAYOUT
SPECIES: STAIN:	OAK OR MAPLE SELECT FROM STANDARD FINISHES TO ALIGN WITH SCHOOL FINISHES

S-4A SHELVING – MS/HS LIBRARY



MFR.	KI
SERIES	CROSSROADS
PROD. #	VARIES BASED ON HEIGHT
DESCRIPTION	SHELVING ADDER UNIT – SINGLE FACED WITH BACK PANEL & 1 STRAIGHT ADDER PANEL 2 ADJUSTABLE, 2 FIXED SHELVES
WARRANTY	LIMITED LIFETIME
SIZE	36 ¼"W X 12"D X HEIGHT DETERMINED BASED ON LAYOUT
SPECIES: STAIN:	OAK OR MAPLE SELECT FROM STANDARD FINISHES TO ALIGN WITH SCHOOL FINISHES

S-4B SHELVING – MS/HS LIBRARY



MFR.	KI
SERIES	CROSSROADS
PROD. #	VARIES BASED ON HEIGHT
DESCRIPTION	SHELVING STARTER UNIT – DOUBLE FACED WITH BACK PANEL & 2 STRAIGHT END PANELS 2 ADJUSTABLE, 2 FIXED SHELVES MOUNT TO WALL
WARRANTY	LIMITED LIFETIME
SIZE	37 ½"W X 24"D X HEIGHT DETERMINED BASED ON LAYOUT
SPECIES: STAIN:	OAK OR MAPLE SELECT FROM STANDARD FINISHES TO ALIGN WITH SCHOOL FINISHES

S-5A SHELVING – MS/HS LIBRARY



MFR.	KI
SERIES	CROSSROADS
PROD. #	VARIES BASED ON HEIGHT
DESCRIPTION	SHELVING ADDER UNIT – DOUBLE FACED WITH BACK PANEL & 1 STRAIGHT ADDER PANEL 2 ADJUSTABLE, 2 FIXED SHELVES
WARRANTY	LIMITED LIFETIME
SIZE	36 ¼"W X 24"D X HEIGHT DETERMINED BASED ON LAYOUT
SPECIES: STAIN:	OAK OR MAPLE SELECT FROM STANDARD FINISHES TO ALIGN WITH SCHOOL FINISHES

S-5B SHELVING – MS/HS LIBRARY



MFR.	NEXEL
SERIES	4 SHELF, STAINLESS STEEL WIRE SHELVING UNIT, STARTER
DESCRIPTION	4 POSTS WITH LEVELING FEET PLASTIC SNAP ON SLEEVES 4 WIRE SHELVES INCLUDE NEXEL AW2C WALL MOUNTING BRACKETS
WARRANTY	LIMITED FIFTEEN YEAR WARRANTY AGAINST RUST & CORROSION
SIZE	36"W X 14"D X 74"H
METAL FINISH:	STAINLESS STEEL

S-6A SHELVING – METAL SHELVING



MFR.	NEXEL
SERIES	4 SHELF, STAINLESS STEEL WIRE SHELVING UNIT, ADD ON
DESCRIPTION	2 POSTS WITH LEVELING FEET PLASTIC SNAP ON SLEEVES 4 WIRE SHELVES S HOOK TO JOIN UNITS INCLUDE NEXEL AW2C WALL MOUNTING BRACKETS
WARRANTY	LIMITED FIFTEEN YEAR WARRANTY AGAINST RUST & CORROSION
SIZE	36"W X 14"D X 74"H
METAL FINISH:	STAINLESS STEEL

S-6B SHELVING – METAL SHELVING



MFR.	TENNSCO
SERIES	Z-LINE HEAVY DUTY STARTER DECKING UNIT
PROD. #	ZL7-4824-3D
DESCRIPTION	ADJUSTABLE SHELVES 3 SHELF UNIT WITH EXTRA SHELF - #ZLES-4824D
WARRANTY	LIMITED ONE YEAR WARRANTY
SIZE	48"W X 24"D X 84"H
METAL FINISH:	MEDIUM GREY - MGY

S-7A SHELVING – HEAVY DUTY



MFR.	TENNSCO
SERIES	Z-LINE HEAVY DUTY STARTER DECKING UNIT
PROD. #	ZL7-7224-3D
DESCRIPTION	ADJUSTABLE SHELVES 3 SHELF UNIT WITH EXTRA SHELF - #ZLES-7224D
WARRANTY	LIMITED ONE YEAR WARRANTY
SIZE	72"W X 24"D X 84"H
METAL FINISH:	MEDIUM GREY - MGY

S-7B SHELVING – HEAVY DUTY



MFR.	TENNSCO
SERIES	Z-LINE HEAVY DUTY STARTER DECKING UNIT
PROD. #	ZL7-9624-3D
DESCRIPTION	ADJUSTABLE SHELVES 3 SHELF UNIT WITH EXTRA SHELF - #ZLES-9624D
WARRANTY	LIMITED ONE YEAR WARRANTY
SIZE	96"W X 24"D X 84"H
METAL FINISH:	MEDIUM GREY - MGY

S-7C SHELVING – HEAVY DUTY



MFR.	KI
SERIES	600 SERIES INDUSTRIAL STOOLS
PROD. #	618PA
DESCRIPTION	POLYPROPYLENE SEAT ADJUSTABLE HEIGHT LEGS SELF LEVELING GLIDES
WARRANTY	LIFETIME
SIZE	15 5/8"W X 15 5/8"D X 19-27"H
FINISH – SEAT: FINISH – BASE: FINISH – FEET/BUMPER:	SELECT FROM STANDARD FINISHES TO ALIGN WITH SCHOOL BRANDING WARM GREY (WG) GREY (GRF)

ST-1 STOOL – INDUSTRIAL



MFR.	HON
SERIES	MOTIVATE
PROD. #	HMG3
DESCRIPTION	COUNTER STOOL PLASTIC SHELL ARMLESS (N) STANDARD NYLON GLIDE (E)
WARRANTY	LIMITED LIFETIME
SIZE	21"W X 23"D X 40.5"H
FINISH – FRAME: FINISH – POLY SEAT:	TEXTURED SILVER (PR8) SELECT FROM STANDARD FINISHES TO ALIGN WITH SCHOOL BRANDING

ST-2A TASK STOOL



MFR.	KI
SERIES	INTELLECT WAVE
PROD. #	IWS
DESCRIPTION	TASK STOOL PLASTIC SHELL ARMLESS STANDARD BASE (SB) CARPET CASTERS (C) OR HARD FLOOR CASTERS (S)
WARRANTY	LIMITED LIFETIME
SIZE	23 ½"W X 22 ¼"D X 34 ¼"-44 ½"H
FINISH – POLY SHELL: FINISH – FRAME COLOR:	SELECT FROM STANDARD FINISHES TO ALIGN WITH SCHOOL BRANDING WARM GREY (WG)

ST-2B TASK STOOL



MFR.	KI
SERIES	RUCKUS ACTIVITY HORSESHOE TABLE
PROD. #	RTEEH487220
DESCRIPTION	PLASTIC LAMINATE TOP SIT HEIGHT ADJUSTABLE HORSESHOE TABLE NYLON GLIDES (GNY)
WARRANTY	LIFETIME
SIZE	72"W X 48"D X 20-33"H
FINISH – TABLE TOP LAMINATE: FINISH – EDGE BAND: FINISH – LEGS:	WHITE NEBULA (LWL) WARM GREY (EWG) WARM GREY (WG)

T-1 STUDENT TABLE – ES

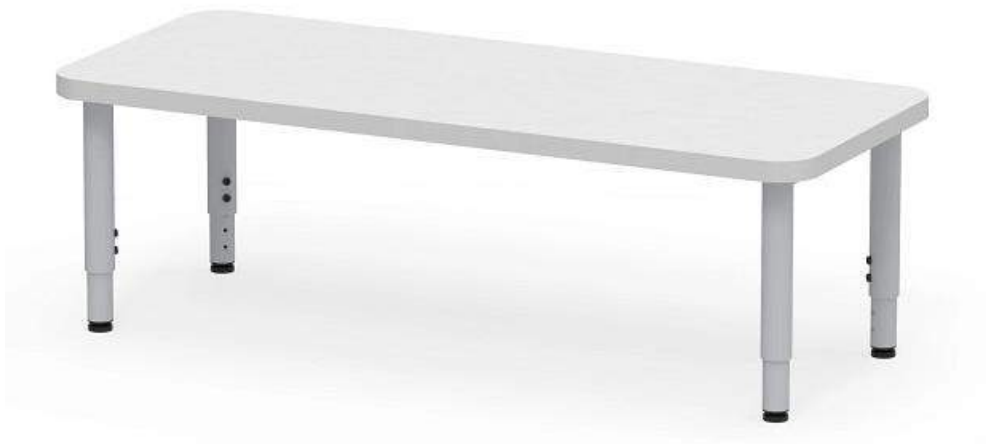

MFR.	KI
SERIES	RUCKUS ACTIVITY RECTANGLE TABLE
PROD. #	RTEEA2436
DESCRIPTION	PLASTIC LAMINATE TOP RECTANGULAR ACTIVITY TABLE WITH ROUNDED CORNERS SIT ADJUSTABLE HEIGHT WITH NYLON GLIDES
WARRANTY	LIFETIME
SIZE	36"W X 24"D X 20-33"H
FINISH – TABLE TOP LAMINATE: FINISH – EDGE BAND: FINISH – LEGS:	WHITE NEBULA (LWL) WARM GREY (EWG) WARM GREY (WG)

T-2A STUDENT TABLE – 4K

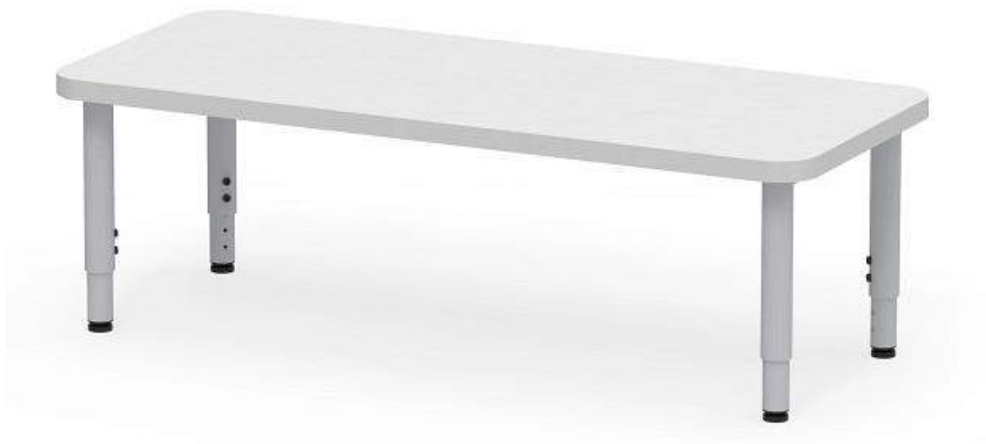

MFR.	KI
SERIES	RUCKUS ACTIVITY RECTANGLE TABLE
PROD. #	RTEEA2448
DESCRIPTION	PLASTIC LAMINATE TOP RECTANGULAR ACTIVITY TABLE WITH ROUNDED CORNERS SIT ADJUSTABLE HEIGHT WITH NYLON GLIDES
WARRANTY	LIFETIME
SIZE	48"W X 24"D X 20-33"H
FINISH – TABLE TOP LAMINATE: FINISH – EDGE BAND: FINISH – LEGS:	WHITE NEBULA (LWL) WARM GREY (EWG) WARM GREY (WG)

T-2B LIBRARY TABLE - ES



MFR.	KI
SERIES	RUCKUS ACTIVITY RECTANGLE TABLE
PROD. #	RTEEA3060
DESCRIPTION	PLASTIC LAMINATE TOP RECTANGULAR ACTIVITY TABLE WITH ROUNDED CORNERS SIT ADJUSTABLE HEIGHT WITH NYLON GLIDES
WARRANTY	LIFETIME
SIZE	60"W X 30"D X 20-33"H
FINISH – TABLE TOP LAMINATE: FINISH – EDGE BAND: FINISH – LEGS:	WHITE NEBULA (LWL) WARM GREY (EWG) WARM GREY (WG)

T-2C LIBRARY TABLE – MS/HS



MFR.	KI
SERIES	STOUT TABLES
PROD. #	SUEFA3660
DESCRIPTION	STOUT ADJUSTABLE-HEIGHT TABLES WITH CASTERS (CCC) BUTCHER BLOCK WOOD TOP (WBB) NO FOOTREST (NFT), NO PEG BOARD (NPB) WITH BAG HOOKS (BH)
WARRANTY	LIFETIME
SIZE	59.93"W X 35.93"D X 27-40"H
FINISH – TOP: FINISH – FRAME & HOOK:	BUTCHER BLOCK SELECT FROM STANDARD FINISHES TO ALIGN WITH SCHOOL BRANDING

T-3A MAKERS SPACE / STEM TABLE



MFR.	KI
SERIES	STOUT TABLES
PROD. #	SUEFA3660
DESCRIPTION	STOUT ADJUSTABLE-HEIGHT TABLES WITH CASTERS (CCC) PHENOLIC RESIN TOP (RNT) NO FOOTREST (NFT), NO PEG BOARD (NPB) WITH BAG HOOKS (BH)
WARRANTY	LIFETIME
SIZE	59.93"W X 35.93"D X 27-40"H
FINISH – TOP: FINISH – FRAME & HOOK:	PHENOLIC RESIN TOP SELECT FROM STANDARD FINISHES TO ALIGN WITH SCHOOL BRANDING

T-3B SCIENCE & ART TABLE



MFR.	KI
SERIES	STOUT TABLES
PROD. #	SUEFA3660
DESCRIPTION	STOUT ADJUSTABLE-HEIGHT TABLES WITH CASTERS (CCC) STAINLESS STEEL TOP NO FOOTREST (NFT), NO PEG BOARD (NPB) WITH BAG HOOKS (BH)
WARRANTY	LIFETIME
SIZE	59.93"W X 35.93"D X 27-40"H
FINISH – TOP: FINISH – FRAME & HOOK:	STAINLESS STEEL SELECT FROM STANDARD FINISHES TO ALIGN WITH SCHOOL BRANDING

T-3C FASC & CULINARY



MFR.	HON
SERIES	ARRANGE
PROD. #	HCTSQR42 HCT29LX
DESCRIPTION	SQUARE TOP X-BASE GLIDES
WARRANTY	LIFETIME
SIZE	42"W X 42"D X 29"H
FINISH – LAMINATE TOP: FINISH – BASE:	SELECT FROM STANDARD FINISHES TO ALIGN WITH SCHOOL FINISHES TITANIUM

T-4A

SIZE WILL BE PROJECT DEPENDED. ARCHITECT TO PROPOSE APPROPRIATE SIZE TABLE BASED ON LAYOUT OF ROOM.
 MULTIUSE TABLE



MFR.	HON
SERIES	ARRANGE
PROD. #	HCTRND42 HCT29LX
DESCRIPTION	ROUND TOP X-BASE GLIDES
WARRANTY	LIFETIME
SIZE	42"DIA X 29"H
FINISH – LAMINATE TOP: FINISH – BASE:	SELECT FROM STANDARD FINISHES TO ALIGN WITH SCHOOL FINISHES TITANIUM

T-4B SIZE WILL BE PROJECT DEPENDED. ARCHITECT TO PROPOSE APPROPRIATE SIZE TABLE BASED ON LAYOUT OF ROOM.
MULTIUSE TABLE

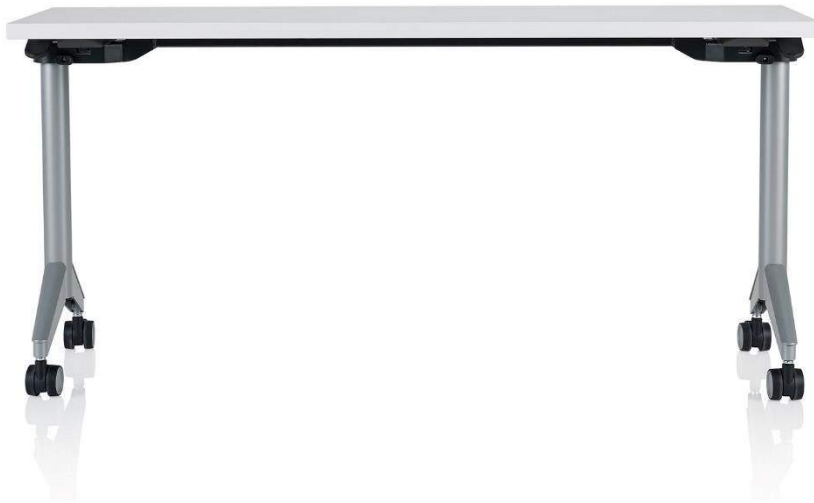

MFR.	KI
SERIES	PIROUETTE TRAINING TABLE
PROD. #	PINR3060T
DESCRIPTION	FIXED HEIGHT BASE – NESTING TOP – RECTANGULAR T-BASE, NO GROMMETS (NNN) 4 BLACK CASTERS W/ SILVER HUB – 2 LOCKING (4EC)
WARRANTY	LIFETIME
SIZE	30"W X 60"D X 29"H
FINISH – LAMINATE TOP: FINISH – EDGE BAND: FINISH – BASE:	SATIN STAINLESS (LSS), SILICON EVOLV (LSV), OR TITANIUM EVOLV (LTV) FLANNEL (EFN) FLANNEL (FN)

T-5 CONFERENCE/COMMUNITY CLASSROOM TABLE



MFR.	KI
SERIES	SONRISA OCCASIONAL TABLE
PROD. #	SNT2121H21
DESCRIPTION	SQUARE NYLON GLIDES (GNY) PLASTIC LAMINATE
WARRANTY	LIFETIME
SIZE	21"W X 21"D X 21.34"H
FINISH – LAMINATE TOP: FINISH – EDGE BAND: FINISH – BASE:	SATIN STAINLESS (LSS), SILICON EVOLV (LSV), OR TITANIUM EVOLV (LTV) FLANNEL (EFN) FLANNEL (FN)

T-6 END TABLE

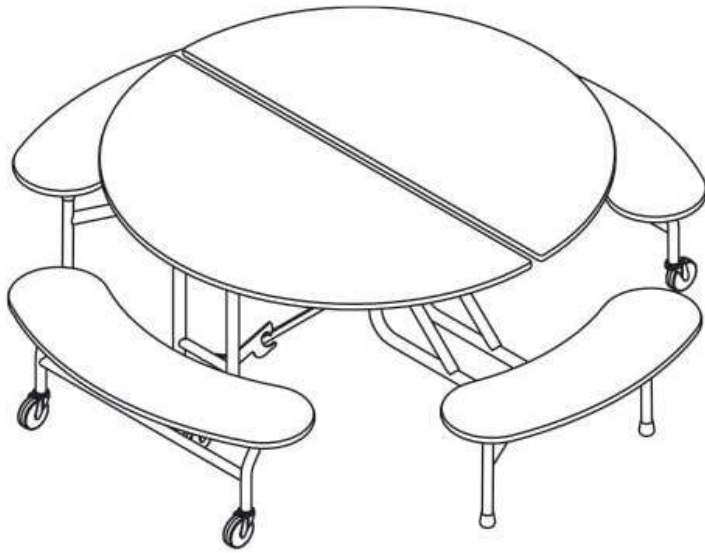

MFR.	KI
SERIES	CAFEWAY CAFETERIA TABLES
PROD. #	ECTRD2707B4PY
DESCRIPTION	ROUND TABLES WITH BENCHES SPRAYED EDGE (SY)
WARRANTY	LIFETIME
SIZE	86"W X 87"D X 27"H
FINISH – LAMINATE TOP FINISH – TABLE & BENCH EDGE FINISH - BASE	FROM STANDARDS TO MATCH BUILDING FINISHES BLACK-CARBON EDGE RAVEN (RV)

T-7A STUDENT CAFETERIA TABLE - ES

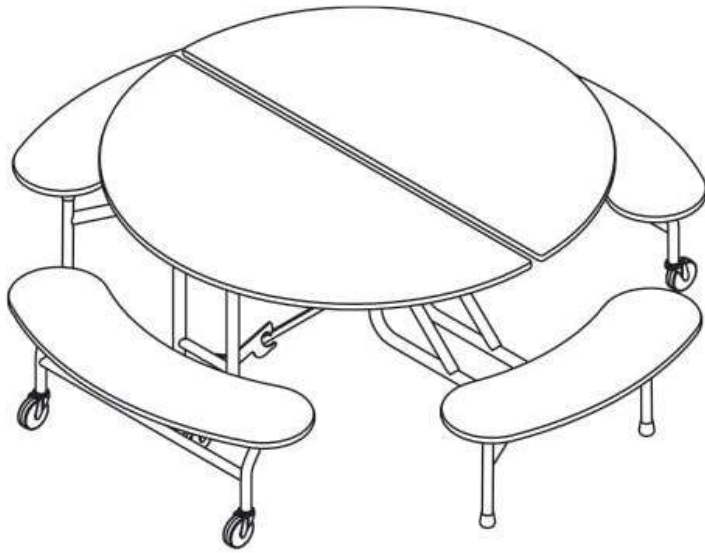

MFR.	KI
SERIES	CAFEWAY CAFETERIA TABLES
PROD. #	ECTRD2905B4PY
DESCRIPTION	ROUND TABLES WITH BENCHES SPRAYED EDGE (SY)
WARRANTY	LIFETIME
SIZE	86"W X 87"D X 29"H
FINISH – LAMINATE TOP FINISH – TABLE & BENCH EDGE FINISH - BASE	FROM STANDARDS TO MATCH BUILDING FINISHES BLACK-CARBON EDGE RAVEN (RV)

T-7B STUDENT CAFETERIA TABLE – MS & HS



MFR.	KI
SERIES	CAFEWAY CAFETERIA TABLES
PROD. #	ECTRG2712BE
DESCRIPTION	RECTANGULAR TABLES WITH BENCHES SPRAYED EDGE (SY)
WARRANTY	LIFETIME
SIZE	146"W X 55"D X 27"H
FINISH – LAMINATE TOP FINISH – TABLE & BENCH EDGE FINISH - BASE	FROM STANDARDS TO MATCH BUILDING FINISHES BLACK-CARBON EDGE RAVEN (RV)

T-8A STUDENT CAFETERIA TABLE - ES



MFR.	KI
SERIES	CAFEWAY CAFETERIA TABLES
PROD. #	ECTRG2912BE
DESCRIPTION	RECTANGULAR TABLES WITH BENCHES SPRAYED EDGE (SY)
WARRANTY	LIFETIME
SIZE	146"W X 55"D X 29"H
FINISH – LAMINATE TOP FINISH – TABLE & BENCH EDGE FINISH - BASE	FROM STANDARDS TO MATCH BUILDING FINISHES BLACK-CARBON EDGE RAVEN (RV)

T-8B STUDENT CAFETERIA TABLE – MS & HS



WILSONART
COLOR: STERLING ASH

MFR.	HON
SERIES	ARRANGE
PROD. #	BASE #HCT29LX TOP #HCTRND42
DESCRIPTION	PLASTIC LAMINATE X-BASE ROUND TOP
WARRANTY	LIMITED LIFETIME
SIZE	42"DIA X 30"H
FINISH – LAMINATE TOP FINISH – EDGE BAND FINISH - BASE	STERLING ASH STERLING ASH TITANIUM

T-9A

SIZE WILL BE PROJECT DEPENDED. ARCHITECT TO PROPOSE APPROPRIATE SIZE TABLE BASED ON LAYOUT OF ROOM.

LARGE PRIVATE OFFICE TABLE



MFR.	HON
SERIES	ABOUND
PROD. #	VARIES
DESCRIPTION	SYSTEMS FURNITURE SOLUTION TACKABLE ACOUSTICAL PANELS WITH OR WITHOUT POWER AS NEEDED FLAT TRIM AND STANDARD FINISHES; FULL HEIGHT TILES WHERE POSSIBLE FRAME SIZE OR WALL HANG TO BE DETERMINED BY PROJECT REQUIREMENTS ADDITIONAL DETAILS TO BE DETERMINED BY PROJECT REQUIREMENTS
SIZE	REFER TO PLANS FOR SIZING
WORKSURFACE FINISH – PLAM COLOR: PANEL FABRIC – PRICE CODE A:	WILSONART, STERLING ASH ANY GRADE A FABRIC

WKST-1 WORKSTATION



**RACINE
UNIFIED
SCHOOL DISTRICT**

UPHOLSTERY SPECIFICATIONS

CHAI	DUNE	BUFF	MOCHA	INK
FOG	ASH	MIST	TORNADO	CHARCOAL
SOL	MANDARIN	PERSIMMON	CHILI	MULBERRY
SEA MIST	CAPRI	ATLANTIC	WILDWOOD	AZURE
SLATE	HORIZON HUDSON	NAVY	GALE	TWILIGHT

THIS UPHOLSTERY IS INTENDED TO BE USED ON L-1A, L-1B, L-1C, L-1D, L-2, & PED-2

MANUFACTURER: PALLAS

PATTERN: ORIGIN

COLOR: SELECT FROM COLORS ABOVE ON A PER PROJECT BASIS

WIDTH: 54"



THIS UPHOLSTERY IS INTENDED TO BE USED ON C-3

MANUFACTURER: PALLAS

PATTERN: LUMIERE

COLOR: SELECT FROM COLORS ABOVE ON A PER PROJECT BASIS

WIDTH: 54"



THIS UPHOLSTERY IS INTENDED TO BE USED ON C-4A, C-4B, L-3, & PED-1

MANUFACTURER: HON

PATTERN: SAXONY

COLOR: SELECT FROM COLORS ABOVE ON A PER PROJECT BASIS

WIDTH: 54"

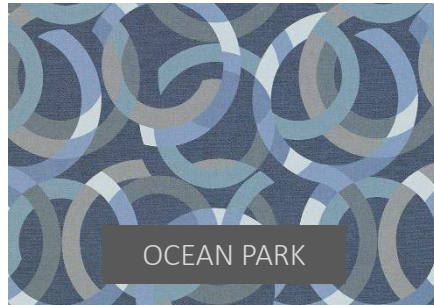
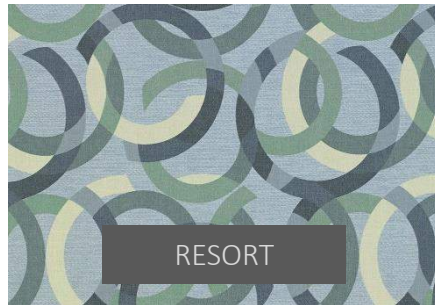
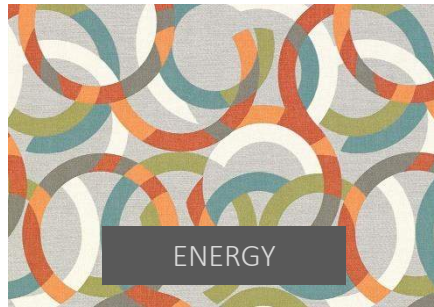
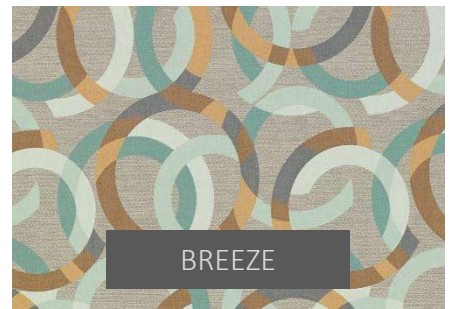
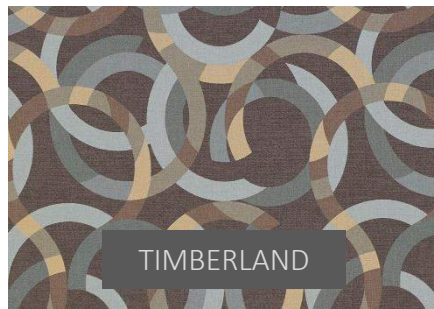
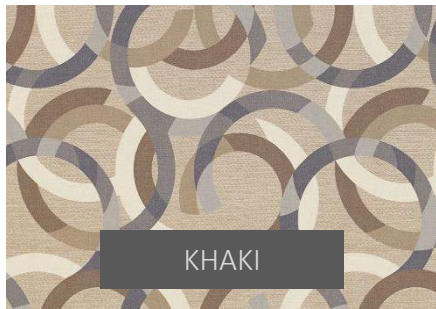

THIS UPHOLSTERY IS INTENDED TO BE USED ON L-3
MANUFACTURER: STINSON
PATTERN: ROUND TRIP
COLOR: SELECT FROM COLORS ABOVE ON A PER PROJECT BASIS
WIDTH: 54"

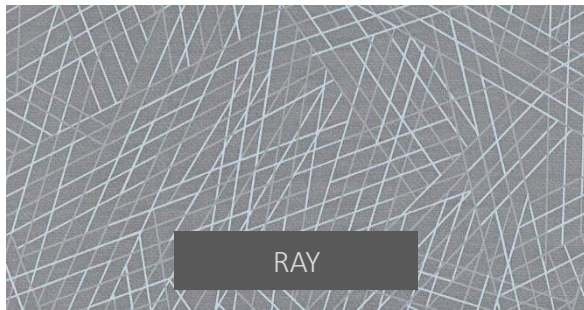

RAY



BLUE



SUEDE

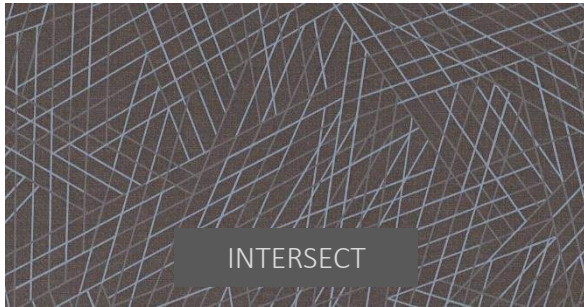

INTERSECT

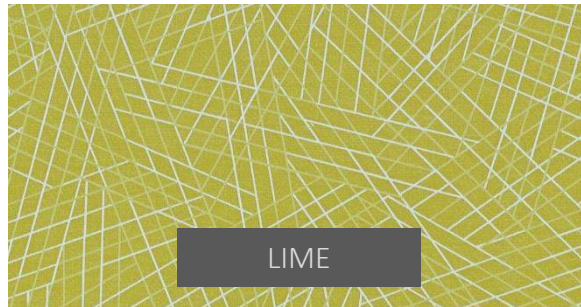

LIME



PARALLEL



SEGMENT

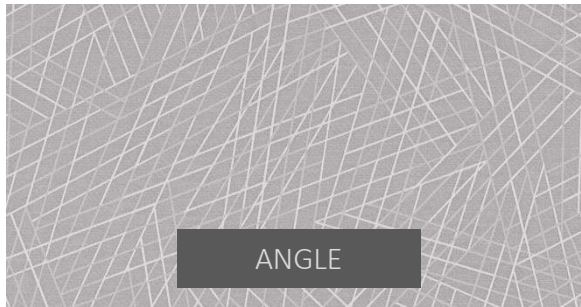

ANGLE



SPICE

THIS UPHOLSTERY IS INTENDED TO BE USED ON L-3
MANUFACTURER: STINSON
PATTERN: VECTOR
COLOR: SELECT FROM COLORS ABOVE ON A PER PROJECT BASIS
WIDTH: 54"