

Greenville Central School District  
Board of Education  
Minutes  
Business Meeting  
Monday  
June 11, 2012

7:00 p.m.

High School Auditorium

**I. Call to Order**

A meeting of the Board of Education was held on Monday, June 11, 2012 in the High School Auditorium. Mr. Wilton Bear, Jr., President, called the meeting to order at 7:08 p.m.

A. Members present:           Wilton Bear, Jr.  
  Ann Holstein  
  Gregory Lampman  
  Jason Reinhard  
  Rosanne Stapleton  
  Lawrence Tompkins

Member absent:                Anne Mitchell

Others present:                Cheryl A. Dudley, Superintendent  
  Jacqueline O'Halloran, District Clerk  
  Donna Accuosti, Director of Human Resources  
  Scott Gardiner, Director of Technology  
  Colleen Hall, Director of Curriculum and Communications  
  Michael Laster, High School Principal  
  Peter Mahan, Elementary School Principal  
  Anders Rasmussen, House Principal  
  Brian Reeve, Middle School Principal  
  Karen Schrader, Supervisor of Transportation  
  Robert Schrader, Supervisor of Buildings and Grounds  
  Tammy J. Sutherland, Assistant Superintendent for Business  
  Paul Ventura, Sr., Food Service Supervisor  
  Linda Wistar, Director of Pupil Personnel Services

There were approximately four hundred (400) visitors to the meeting.

**II. Approval of Agenda**

Anne Holstein moved, seconded by Gregory Lampman and carried unanimously to approve the Agenda for the Business Meeting of June 11, 2012

**III. Accolades**

**CASDA Scholar Recognition Program**

Congratulations were extended to Senior Camryn Benjamin and Wendy Ward on this honor. Camryn said, "Miss Ward's continuous support and unselfishness are what make her a remarkable teacher and individual. My learning experience has truly been enriched by her wisdom."

**Presentations to retirees:**

James Crossett  
*Mr. Crossett retires with thirty-four (34) years of service to the children of the Greenville Central School District as an Art Teacher.*

Kathryn McAneny

*Ms. McAneny retires with twenty-five (25) years of service to the children of the Greenville Central School District as a Social Studies Teacher.*

Gail Richmond

*Ms. Richmond retires with thirty-three (33) years of service to the children of the Greenville Central School District as a Music Teacher.*

Wendy Ward

*Ms. Ward retires with thirty-one (31) years of service to the children of the Greenville Central School District as a Math Teacher.*

Nancy Beers

*Ms. Beers retires with over twelve (12) years of service to the children of the Greenville Central School District as Administrative Assistant to the Superintendent.*

Laraine Farricker

*Ms. Farricker retires with twenty-five (25) years of service to the children of the Greenville Central School District serving in many capacities and retiring as secretary to the Assistant Superintendent of Business.*

Marilyn Nevins

*Ms. Nevins retires with eleven (11) years of service to the children of the Greenville Central School District as a Food Service employee.*

Board of Education President, Wilton Bear, Jr., Superintendent Dudley, Assistant Superintendent for Business, Tammy Sutherland and Principals Michael Laster, Brian Reeve and Peter Mahan, presented plaques and acknowledging their professional service and dedication to the children of the Greenville Central School District.

President Bear, Superintendent Dudley, Michael Laster, Brian Reeve, and Peter Mahan also congratulated Susan Somers, Michael Flagg, Faith Bowers, Nicole Susser, Benjamin Katagiri, Kristi Bullis, Audrey Hynes and Brian Reeve who would be appointed tenure pending Board of Education approval this evening.

#### **Presentation by Greenville Youth Sports Booster Club (GYSBC)**

Booster Club Co-chairs, Rachel DeLong and Pat Cullen gave a brief presentation on the newly formed Greenville Youth Sports Booster Club (GYSBC) created to help fund a modified sports program. Several students also spoke on the advantages of having a modified sports program.

#### **IV. Open Forum**

GCSD employees and several district residents addressed the Board regarding recent reductions in force made in this year's budget cycle. Discussion included the following issues:

- Greenville Faculty Association (GFA) Reductions in Force
- Licensed Practical Nurse (LPN) Reduction in Force
- Health care reinstated for the month of July 2012 to those who lost their health care coverage
- First grade teacher Reduction in Force
- Japanese Reduction in Force
- Support Staff Reductions in Force~Health Insurance
- Executive Session~Reductions in Force
- Reinstatement of SADD Club
- Support of Students with Disabilities
- Unappropriated Fund Balance
- Administrative Salaries

**V. Action Items: A – F:**

Ann Holstein moved, seconded by Rosanne Stapleton, and carried unanimously to approve items (A), (B) and (C):

**A. Accept Minutes**

1. **Business Meeting of May 14, 2012**
2. **Budget Hearing of May 8, 2012**
3. **Annual Budget Vote & Election of May 15, 2012**

**B. Accept Finance Reports for the month ending May 31, 2012 (FY2012-88)**

1. **Treasurer’s Reports**
2. **Appropriation Reports for General, Federal, Cafeteria and Capital Funds**
3. **Revenue Reports for the General, Federal, Cafeteria and Capital Funds**
4. **Cafeteria Profit and Loss Statements**
5. **Transfer of Funds for General Fund**
6. **Internal Claims Report**

**C. Accept Recommendations**

1. **Committee on Special Education from the meetings of:**
  - a. **April 4, 18, 19, 23 25, 26, 2012**
  - b. **May 1, 2, 3, 14, 16, 2012**

Jason Reinhard moved, seconded by Rosanne Stapleton and carried unanimously to approve item (D):

**D. Approve Personnel Agenda**

BE IT RESOLVED that upon the recommendation of Superintendent of Schools, Cheryl A. Dudley, that the Board of Education of the Greenville Central School District approve the following:

**1. Unclassified**

a. Resignation

- |                |   |
|----------------|---|
| 1. Name:       | Colleen M. Hall   |
| Position:      | Director of Curriculum and Communications                 |
| Tenure Area:   | K-12 Administration                                       |
| Certification: | School District Administrator, Permanent Music, Permanent |
| Effective:     | July 1, 2012  |
| Category:      | Resignation   |
|                |   |
| 2. Name:       | James Crossett  |
| Position:      | Art Teacher   |
| Tenure Area:   | Art   |
| Certification: | Art, Permanent  |
| Effective:     | June 30, 2012   |
| Category:      | Retirement  |
|                |   |
| 3. Name:       | Gail Richmond   |
| Position:      | Music Teacher   |
| Tenure Area:   | Music   |
| Certification: | Music, Permanent  |
| Effective:     | June 30, 2012   |
| Category:      | Retirement  |
|                |   |
| 4. Name:       | Kathryn McAneny   |
| Position:      | Social Studies Teacher                                    |
| Tenure Area:   | Social Studies  |

Certification: Social Studies 7-12, Permanent  
Effective: June 30, 2012  
Category: Retirement

5. Name: Wendy Ward  
Position: Mathematics Teacher  
Tenure Area: Mathematics  
Certification: Mathematics 7-12, Permanent  
Physical Education, Permanent  
Effective: June 30, 2012  
Category: Retirement

b. Appointment to Tenure

1. Name: Susan Somers  
Tenure Area: Elementary  
Commencement of service on Tenure:  
Certification: Childhood Education (Grades 1-6), Professional
2. Name: Michael Flagg  
Tenure Area: School Psychologist  
Commencement of service on Tenure: September 1, 2012  
Certification: School Psychologist, Permanent
3. Name: Faith Bowers  
Tenure Area: Teaching Assistant  
Commencement of service on Tenure: September 1, 2012  
Certification: Teaching Assistant, Level III
4. Name: Nicole Susser  
Tenure Area: School Counseling & Guidance  
Commencement of service on Tenure: September 1, 2012  
Certification: School Counselor, Permanent
5. Name: Benjamin Katagiri  
Tenure Area: Social Studies  
Commencement of service on Tenure: September 1, 2012  
Certification: Social Studies 7-12, Initial expiring August 31, 2012
6. Name: Kristi Bullis  
Tenure Area: Education of Children with Handicapping Conditions, General Special Education  
Commencement of service on Tenure: September 1, 2012  
Certification: PreK, Kindergarten & Grades 1-6  
Permanent  
Special Education, Permanent

- 7. Name: Audrey Hynes  
 Tenure Area: Teaching Assistant  
 Commencement of service on Tenure: September 1, 2012  
 Certification: Teaching Assistant, Level III
- 8. Name: Brian Reeve  
 Tenure Area: Administration – Middle School Principal  
 Commencement of service on Tenure: July 1, 2012  
 Certification: School Administrator/Supervisor, Permanent  
 Social Studies 7-12, Permanent

c. Substitutes

- 1. Name: Rachael Kennedy  
 Position: Substitute Teacher (Cairo-Durham)  
 Certification: N/A  
 Effective: June 12, 2012  
 Salary: \$82.00 per diem  
 Status: Cleared for employment
- 2. Name: Dale Loughran  
 Position: Substitute Teacher (Cairo-Durham)  
 Certification: N/A  
 Effective: June 12, 2012  
 Salary: \$82.00 per diem  
 Status: Cleared for employment
- 3. Name: Rebecca Mabee  
 Position: Substitute Teacher and Teaching Assistant (Cairo-Durham)  
 Certification: N/A  
 Effective: June 12, 2012  
 Salary: \$82.00 per diem, Teacher  
 \$75.00 per diem, Teaching Assistant  
 Status: Cleared for employment
- 4. Name: Diana Young  
 Position: Substitute Teacher  
 Certification: Students With Disabilities (Grades 1-6), Initial expiring 8/31/16  
 Childhood Education (Grades 1-6), Initial expiring 8/31/16  
 Effective: May 21, 2012  
 Salary: \$101.00 per diem  
 Status: Cleared for employment

**2. Classified**

a. Approve Contracts

- 1. Central Office Personnel for July 1, 2011 to June 30, 2012  
*(Approval will provide for individual one- year agreements for the Central Office support positions including the District Treasurer, three (3))*

*Administrative Assistants, and the Central Supply Manager/Insurance Clerk at a salary increase of 1.92 % annually)*

b. Resignation

- |            |  |
|------------|--|
| 1. Name:   | Nancy C. Beers                                     |
| Position:  | Administrative Assistant to Superintendent         |
| Effective: | June 30, 2012                                      |
| Category:  | Retirement   |
| 2. Name:   | Laraine C. Farricker                               |
| Position:  | Secretary to Assistant Superintendent for Business |
| Effective: | June 30, 2012                                      |
| Category:  | Retirement   |
| 3. Name:   | Marilyn Nevins                                     |
| Position:  | Food Services                                      |
| Effective: | July 17, 2012                                      |
| Category:  | Retirement   |

Status: All conditional appointments are subject to receipt of a statement from each individual regarding criminal charges and are contingent upon receipt of criminal background clearance from the Commissioner of Education.

**E. Business Management**

Ann Holstein moved, seconded by Gregory Lampman and carried unanimously to approve items (1), (2), (3), and (4):

- 1. Approve contract between the Greenville Central School District and Stieglitz Snyder Architecture for Scott M. Ellis Elementary for Exterior Precast Repairs for \$20,000.00 (2011-2012 Capital Project Budget) (FY2012-89)**
  - a. The design/specification for the replacement of precast coping stones, front steps, front door refurbishment, front door hardware replacement.)*
  
- 2. Approve contract between the Greenville Central School District and Stieglitz Snyder Architecture for the Middle/High School Exterior Paving Renovations for \$18,000.00 (2012-2013 Capital Project Budget) (FY2012-90)**
  - a. The design/specification for the reconstruction of asphalt pavement and adjacent sidewalks including drainage improvements at the entrance circle to the Middle/High School Building.*
  - b. Drainage improvements at the teacher's and student parking lots.*
  - c. Restoration of electrical power to one existing light pole in the vicinity of the flagpole.*
  - d. Site lighting improvements around the entrance loop sidewalk.)*
  
- 3. Award bids:**
  - a. Ink and Toner to: (FY2012-91)**

Global Gov/Ed Solutions Inc.  
M&B Supplies, Inc.  
The Tree House, Inc.  
United Supply

*(This was a cooperative bid with Greenville CSD and Coxsackie-Athens CSD. Bids were opened in the Coxsackie-Athens CSD on Tuesday, May 1, 2012 for ink and toner supplies for the 2012-2013 school year. Bids are awarded*

according to specifications on an "item by item" basis. All bid results are on file in the District Office.)

**b. SED Project #19-07-01-04-0-001-026 for exterior repairs, to include repair of coping stones and front entrance of Scott M. Ellis Elementary School to: (FY2012-92)**

DeBrino Caulking Associates, Inc.  
304 Route 9  
Castleton, NY 12033

*(Bids were opened in the District Office on Friday, May 11, 2012. There were four [4] responses:*

<i>Company</i>	<i>Base Bid</i>	<i>Less contingency</i>	<i>Total</i>
<i>DeBrino Caulking Associates, Inc.,</i>	<i>\$207,300</i>	<i>-\$12,565</i>	<i>\$194,735</i>
<i>Ganem Contracting Corp.,</i>	<i>\$242,000</i>	<i>-\$12,565</i>	<i>\$229,435</i>
<i>PCC Contracting, Inc.</i>	<i>\$252,285</i>	<i>-\$12,565</i>	<i>\$239,720</i>
<i>Mid-State Industries, Ltd.</i>	<i>\$324,811</i>	<i>-\$12,565</i>	<i>\$312,246</i>

*Based on input from the architect, it is recommended to accept the bid from the lowest bidder, DeBrino Caulking Associates, Inc. All bid documents are on file in the Business Office.)*

**4. Accept donations from:**

- a. Elementary PTA for \$1,500.00 to the Greenville Central School District for the 3<sup>rd</sup> and 4<sup>th</sup> grade students at Ellis Elementary to supplement fundraising efforts for the Plimouth Plantation field trip.
- b. Elementary PTA for \$537.00 to the Greenville Central School District for Scott M. Ellis Elementary to renew the online subscription of World Book.
- c. Elementary Student Activity Club for \$225.50 to the Greenville Central School District for Scott M. Ellis Elementary to purchase student agendas for 2012-2013.
- d. Sunrise Farms, Inc. (a subsidiary of Pioneer Hi-Bred International, Inc.) for \$300.00 to the Greenville Central School District to the Greenville FFA as part of the program to honor high yields by the Corn Grower's Association to be used to offset costs for State Fair and State Convention Field Trips.
- e. Greenville Educational Foundation to the Greenville Central School District for \$500.00 to the Art Department to help fund the field trip to the NYC trip to the Museum of Modern Art.
- f. Greenville Educational Foundation to the Greenville Central School District for \$500.00 to the 3<sup>rd</sup> and 4<sup>th</sup> grade students at Ellis Elementary to supplement fundraising efforts for the Plimouth Plantation field trip.

Gregory Lampman moved, seconded by Ann Holstein and carried unanimously to approve items (5), (6) and (7)

**5. Approve contract between the Greenville Central School District and Needham Risk Management Resource Group at the rate of \$1,250.00 per calendar month for 2012-2013 (FY2012-93)**

*(For these services, Client shall pay Consultant at the rate of \$1,250.00 per calendar month for up to 185 hours per year ["Base Annual Hours"] actually spent by Consultant rendering services. Additional costs charged for required testing, i.e. air,*

*and/or asbestos.)*

- 6. Approve Cooperative Purchasing Resolution between the Greenville Central School District and Delaware-Chenango-Madison-Otsego BOCES for 2012-2013**  
*(To be signed by districts participating in the full Cooperative Purchasing Service. This resolution authorizes BOCES to award bids on the behalf of the participating school districts.*

*WHEREAS,*

*The Cooperative Purchasing Service is a plan of a number of public schools*

*WHEREAS,*

*The Cooperative Purchasing Service is a plan of a number of public school districts in the Delaware-Chenango-Madison-Otsego BOCES Area in New York, to bid jointly equipment, supplies and contract items, and*

*WHEREAS,*

*The Central School named below is desirous of participating with other districts in the Delaware-Chenango-Madison-Otsego BOCES in the joint bidding of the items mentioned above as authorized by General Municipal Law, Section 119-o, and*

*WHEREAS,*

*The Central School named below wishes to appoint the Delaware-Chenango-Madison-Otsego BOCES to advertise for bid, accept, tabulate bids and award bids on their behalf; therefore*

*BE IT RESOLVED,*

*That the Board of Education of the Central School listed below hereby appoints the Delaware-Chenango-Madison-Otsego BOCES to represent it in all matters relating above, and designates the Evening Sun Newspaper as the legal publication for all Cooperative Purchasing bid notifications, and,*

*BE IT FURTHER RESOLVED,*

*That the Board of Education of the Central School listed below authorizes the Delaware-Chenango-Madison-Otsego BOCES to represent it in all matters leading up to the entering into a contract for the purchase of the above mentioned commodities, and,*

*BE IT FURTHER RESOLVED,*

*That the Board of Education of the Central School listed below agrees to [1] assume its equitable share of the costs of the Cooperative Bidding; [2] abide by majority decisions of the participating districts; [3] abide by the Award of the BOCES Board; [4] and that after the award of the bid it will conduct all negotiations directly with the successful bidder[s].)*

- 7. Approve Cafeteria Supplies and Food Bid Resolution between the Greenville Central School District and Delaware-Chenango-Madison-Otsego BOCES for 2012-2013**

*(To be signed by districts participating in the Cooperative Food Bid. This resolution appoints a committee to act in the district's behalf and for the district to abide by the committee recommendations and award of bids.*

*WHEREAS,*

*It is a plan of a number of public school districts in the Delaware-Chenango-Madison-Otsego BOCES Area in New York, to bid jointly Cafeteria supplies including but not limited to food and paper items, and*

*WHEREAS,*

*The Central School named below is desirous of participating with other districts in the Delaware-Chenango-Madison-Otsego BOCES Area in the joint bidding of the commodities mentioned above as authorized by General Municipal Law, Section 119-o, and*

*WHEREAS,*

*The Central School named below wishes to appoint a committee made up of participating schools to assume the responsibility for drafting of specifications, advertising for bids, accepting and opening bids, tabulating bids and awarding bids and reporting the results to the schools; therefore;*

*BE IT RESOLVED,*

*That the Board of Education of the Central School listed below hereby appoints the Delaware-Chenango-Madison-Otsego BOCES to represent it in all matters relating above, and designates the Evening Sun Newspaper as the legal publication for all Cooperative Purchasing bid notifications, and,*

*BE IT FURTHER RESOLVED,*

*That the Board of Education of the Central School listed below authorizes the above committee to represent it in all matters leading up to the entering into a contract for the purchase of the above mentioned commodities, and,*

*BE IT FURTHER RESOLVED,*

*That the Board of Education of the Central School listed below agrees to [1] assume its equitable share of the costs of the Cooperative Bidding; [2] abide by majority decisions of the participating districts on quality standards; [3] that it will award contracts according to the recommendations of the committee; [4] and that after the award of the bid it will conduct all negotiations directly with the successful bidder[s].)*

Rosanne Stapleton moved, seconded by Jason Reinhard and carried unanimously to approve items (8) and (9):

**8. Approve generic resolution between the Greenville Central School District and Delaware-Chenango-Madison-Otsego BOCES for 2012-2013**

*(To be signed by all districts. This resolution authorizes BOCES to act in the behalf of the districts in the preparation, advertising, and tabulation of bids, but specifies that bids are to be awarded by the individual districts' Board of Education based on the information supplied by BOCES*

*WHEREAS,*

*It is a plan of a number of public school districts in the Delaware-Chenango-Madison-Otsego BOCES Area in New York, to bid jointly equipment, supplies and contract items, and*

*WHEREAS,*

*The Central School named below is desirous of participating with other districts in the Delaware-Chenango-Madison-Otsego BOCES Area in the joint bidding of the items mentioned above as authorized by General Municipal Law, Section 119-o, and*

*WHEREAS,*

*The Central School named below wishes to appoint a committee made up of participating schools to assume the responsibility for drafting of specifications, advertising for bids, accepting and opening bids, tabulating bids and providing the information to their Board of Education who will make the awards; therefore*  
*BE IT RESOLVED,*

*That the Board of Education of the Central School listed below hereby appoints the Delaware-Chenango-Madison-Otsego BOCES to represent it in all matters relating above, and designates the Evening Sun Newspaper as the legal publication for all Cooperative Purchasing bid notifications and,*

*BE IT FURTHER RESOLVED,*

*That the Board of Education of the Central School listed below authorizes the above committee to represent it in all matters leading up to the entering into a contract for the purchase of the above mentioned items, and,*

*BE IT FURTHER RESOLVED,*

*That the Board of Education of the Central School listed below agrees to [1] abide by majority decisions of the participating districts on quality standards; [2] that it will award contracts based on information provided from the bid; [3] and that after the award of the bid it will conduct all negotiations directly with the successful bidder[3].)*

**9. Approve Declaration of Surplus**

*(As part of the District’s Transportation Replacement Plan, the District has eight [8] used buses to surplus. The District has a guaranteed trade-in value of \$46,000 from Matthews Buses with the caveat that we should try to sell them on our own. The district will work with Delaware-Chenango-Madison-Otsego BOCES who has a service and successfully sells used school buses on EBay. The District will borrow the total cost of the buses less the trade-in value.*

<u>Passenger</u>	<u>Bus#</u>	<u>Year</u>	<u>Age</u>	<u>Mileage</u>	<u>Trade-In</u>
66	125	2003	10	85,226	\$ 5,000
66	126	2003	10	96,077	\$ 5,000
66	127	2003	10	86,070	\$ 5,000
66	128	2003	10	92,630	\$ 5,000
66	129	2003	10	84,564	\$ 5,000
66	132	2003	10	84,452	\$ 5,000
66	137	2004	9	76,512	\$ 8,000
66	138	2004	9	76,206	\$ 8,000
20	139	2002	11	92,791	0
<i>Total</i>					\$46,000

Jason Reinhard moved, seconded by Ann Holstein and carried unanimously to approve item (10):

**10. Approve Bond Resolution dated June 11, 2012 of the Board of Education of the Greenville Central School District authorizing the issuance of not to exceed \$877,929.05 aggregate principal amount of general obligation serial bonds to finance the acquisition of school vehicles at an estimated maximum cost of \$877,929.05, the levy of a tax in annual installments in payment thereof, the expenditure of such sum for such purpose, and determining other matters in connection therewith.**

*(WHEREAS, the qualified voters of the Greenville Central School District (the “School district”) at the annual School District meeting duly held on May 15, 2012, duly approved a proposition (the “Proposition”) authorizing the acquisition of the School Vehicles at a cost not to exceed \$877,929.05, the expenditure of such sum for such purpose, the levy of the necessary tax therefor taking into account state aid received, to be levied and collected in annual installments in such years and in such amounts as may be determined by the Board of Education, and, to finance the same, the issuance of general obligation bonds and notes in an aggregate principal amount not to exceed \$877,929.05; NOW, THEREFORE, BE IT RESOLVED BY THE BOARD OF EDUCATION OF THE GREENVILLE CENTRAL SCHOOL DISTRICT (by the favorable vote of not less than two-thirds of such Board) AS FOLLOWS:*

*Section 1. The Board hereby finds and determines that the acquisition of school buses and vans (collectively, the “School Vehicles”), as approved by, the voters of the School District at the annual School District meeting held on May 15, 2012, is a Type II action within the meaning of the State Environmental Quality Review Act and the regulations promulgated thereunder (collectively, “SEQRA”) and no further action under SEQRA is required with respect to such acquisition.*

*Section 2. The School District shall acquire the School Vehicles, as approved by the voters of the School District at the annual School District meeting duly held on May 15, 2012.*

*Section 3. The School District is hereby authorized to issue its general obligation serial bonds (the “Bonds”) in the aggregate principal amount of not*

*to exceed \$877,929.05 pursuant to the Local Finance Law of New York, in order to finance the acquisition of the School Vehicles.*

*Section 4. The class of objects or purposes to be financed pursuant to this Resolution is the acquisition of the School Vehicles.*

*Section 5. It is hereby determined and stated that (a) the maximum cost of the acquisition of the School Vehicles, as estimated by the Board of Education, is \$877,929.05; (b) no money has heretofore been authorized to be applied to the payment of the cost of said acquisition; (c) the School District plans to finance the cost of said acquisition entirely from funds raised by the issuance of the Bonds and bond anticipation notes hereinafter referred to; and (d) the School District, including any subordinate entity of the School District (within the meaning of Section 265(b)(3)(E) of the Internal Revenue Code of 1986, as amended (the "Code")), is not expected to issue more than \$10,000,000 of "qualified tax-exempt obligations" (as defined in Section 265(b)(3)(B) of the Code) during the 2012 calendar year.*

*Section 6. The following additional matters are hereby determined and stated:*

- a) The period of probable usefulness of the specific objects or purposes for which the bonds authorized by this Resolution are to be issued in five (5) years, within the limitation of Section 11.00(a)(29) of the Law.*
- b) The requirements of Section 37.00 of the Law and Section 416 of the Education Law have been met.*
- c) The Bonds authorized by this Resolution are not private activity bonds as defined in Section 141 of the Code.*
- d) All of the proceeds of the Bonds authorized by this Resolution and any notes issued in anticipation of the sale of said Bonds shall be used to pay for the acquisition of the School Vehicles.*
- e) All actions taken by the employees of the School District in placing the Proposition before the voters are hereby approved, ratified and confirmed.*
- f) The Recitals set forth at the beginning of this Resolution are hereby incorporated in this Resolution as if set forth in full in this place.*

*Section 7. The power to further authorize the issuance of the Bonds and bond anticipation notes and to prescribe the terms, form and contents of the Bonds and bond anticipation notes (including, without limitation, the use of substantially level or declining annual debt service as provided by Section 21 of the Local Finance Law, the power to designate the Bonds and bond anticipation notes as "qualified tax-exempt obligations" as provided in Section 265(b) of the Code and the consolidation with other issues), subject to the provisions of this Resolution and the Local Finance Law, and to sell and deliver the Bonds and bond anticipation notes, is hereby delegated to the President of the Board of Education. The President of the Board of Education is hereby authorized to sign and the District Clerk is hereby authorized to attest any Bonds and bond anticipation notes issued pursuant to this Resolution, and the District Clerk is hereby authorized to affix to such Bonds and bond anticipation notes the corporate seal of the School District.*

*Section 8. The faith and credit of the School District are hereby irrevocably pledged for the payment of the principal of and interest on such Bonds and bond anticipation notes as the same respectively become due and payable. Annual appropriation shall be made in each year sufficient to pay the principal of and interest on such obligations becoming due and payable in such year. Unless paid from other sources, there shall be levied annually on all taxable real*

*property within said School District, a tax sufficient to pay the principal of and interest on such obligations as the same become due and payable.*

*Section 9. The temporary use of available funds of the School District, not immediately required for the purpose or purposes for which the same were borrowed, received or otherwise created, is hereby authorized, ratified and confirmed, pursuant to, and subject to the restrictions of, Section 165.10 of the Law, for the acquisition of the School Vehicles. As provided in Section 165.10 of the Law, the Board intends to reimburse such funds from the proceeds of the bonds or notes authorized hereby. This Resolution shall constitute the declaration of the School District's "official intent" to reimburse expenditures relating to the acquisition of the School Vehicles with proceeds of the Bonds and notes, as required by United States Treasury Regulation Section 1.150-2.*

*Section 10. This Resolution (or a summary hereof) shall be published by the Clerk of the School District together with a notice in substantially the form prescribed by Section 81.00 of said Local Finance Law, and such publication shall be in the official newspaper of the School District. The validity of the Bonds or of any bond anticipation notes issued in anticipation of the sale of the Bonds may be contested only if such obligations are authorized for an object or purpose for which the School District is not authorized to expend money, or the provisions of law which should be complied with at the date of publication of this Resolution are not substantially complied with, and an action, suit or proceeding contesting such validity is commenced within twenty (20) days after the date of such publication; or if said obligations are authorized in violation of the provisions of the Constitution.*

*Section 11. The Board hereby covenants and agrees with the holders from time to time of the Bonds authorized hereby, and any bond anticipation notes issued in anticipation thereof, that the Board will duly and faithfully observe and comply with the provisions of the Code relating to such actions which the Board must take or cause to be taken to ensure the status of the interest on the bonds authorized hereby, and any notes issued in anticipation thereof, is and remains excludable from federal income taxation.*

*Section 12. This Resolution shall take effect immediately upon its adoption.)*

## **F. School Management**

Gregory Lampman moved, seconded by Ann Holstein and carried unanimously to approve the items (1) through (9):

**1. BE IT RESOLVED that the Board of Education appoints the following individuals to serve on the Board of Voter Registration for 2012-2013:**

Kathy Gaspar  
Barbara Soldner  
Edna Rominger  
Elizabeth Caputo  
George Soldner as Alternate

**2. Approve contract between the Greenville Central School District and the Rensselaer City School District for an estimated cost of \$7,100.00 for internal auditing services for the 2012- 2013 school year (FY2012-94)**

*("This fee includes a maximum of ten [10] full time equivalent days service by the internal auditor and any paraprofessionals assigned... If the engagement extends beyond ten [10] days, inclusive, the Greenville Central School District will be billed the additional services at prevailing hourly rates... The fee is based on a \$710.00 per*

*staff day for the internal auditor, based upon a 7.5 hour day and \$400.00 per staff day for any paraprofessional, based upon a 7.5 hour day.”)*

- 3. Approve tutorial contract between the Greenville Central School District and Four Winds Saratoga for 2011-2012**
  - a. This contract is for tutorial services for one (1) district resident student at \$29.00 per hour for ten (10) hours of instruction per week for approximately one to two weeks. **(FY2012-95)**
  - b. This contract is for tutorial services for one (1) district resident student at \$29.00 per hour for five (5) hours of instruction per week for approximately one to two weeks. **(FY2012-96)**
- 4. Approve tutorial contract between the Greenville Central School District and Four Winds Saratoga for 2012-2013 (FY2012-97)**

*(This contract is for tutorial services provided by Four Winds for \$30.00 an hour for instruction for ten [10] hour per week for students in the middle and high school; five [5] hours per week for students in the elementary school.)*
- 5. Approve health and welfare services contract between the Greenville Central School and Berne-Knox-Westerlo Central School District for \$1,874.88 for 2011-2012 (FY2012-98)**

*(This contract provides services to three [3] district resident students attending Helderberg Christian School at \$624.96 each.)*
- 6. Approve contract between the Greenville Central School District and UMC Daycare Center for 2012-2013 (FY2012-99)**

*(This contract is for the provision of Pre-Kindergarten education for students of the District as selected by the process of the lottery.)*
- 7. Approve contract between the Greenville Central School District and Little Angel’s Daycare Center for 2012-2013 (FY2012-100)**

*(This contract is for the provision of Pre-Kindergarten education for students of the District as selected by the process of the lottery.)*
- 8. Approve School District Calendar for 2012-2013 (FY2012-101)**
- 9. Approve Board of Education Calendar for 2012-2013 (FY2012-102)**

## **VI. Discussion**

### **A. Board Committee Reports**

- Quality Education Committee (QEC): Ann Holstein  
No report, next meeting Wednesday, June 20, 2012
- Greenville Educational Foundation (GEF): Ann Holstein  
Mr. Brennan presented the Bricks R Us as a fund raiser for modified sports. Plans for Homecoming 2012 and Greenville Day, September 29, 2012 are being discussed.
- Technology Committee: Lawrence Tompkins  
Have not met since last report
- Gifted & Talented Committee: Ann Holstein  
Have not met since last report

- District Planning Committee (DPC): Wilton Bear, Jr.  
Stieglitz Snyder Architecture discussed roof repairs to the high school and the cost of materials.
- Audit Committee: Lawrence Tompkins, Gregory Lampman, Wilton Bear, Jr.  
Have not met since last report
- Budget Advisory Committee (BAC): Jason Reinhard  
Tammy Sutherland reported that the Committee is looking for more efficient ways to communicate to the public the budget developmental process which would include better use of the website to organize and communicate all budget information.
- Greene County School Boards (GCSBA): Gregory Lampman  
Shared Services/ Bus Garage Update ~ Jason Reinhard  
Cairo-Durham CSD toured our bus garage and facilities in anticipation of a shared service with the Greenville Central School District

B. Other Committee Reports

- Safety and Health Committee: Tammy Sutherland  
Have not met since last report
- Wellness Committee: Tammy Sutherland  
Have not met since last report; June 22 Annual Health Fair for employees

*(Committee schedules vary as some do not meet every month. However, the committees are noted on the agenda each month to keep the Board informed.)*

C. District committee for grant writing

Superintendent Dudley anticipates the formation of a committee at the end of June to investigate any grants that may be available to the school district

D. Fund Balance Discussion

Tammy Sutherland, Assistant Superintendent for Business provided clarification and definitions associated with reporting of fund balances. She shared districts need to be fiscally responsible for the long range. With reductions in State and Federal aid, no mandate relief, tax cap, and contractual costs school districts are facing a funding cliff. Real Property Tax Law§1318 limits the amount of unexpended surplus funds a school district can retain to no more than 4% of the next years' budgetary appropriation.

It is the recommendation of Ms. Sutherland not to use any of the unassigned fund balance to reinstate cuts. This funding source should not be used for an expense that cannot be sustained. One year later the cuts will be made again and you will have no "savings" to help in future years.

**VII. Board Members' input for possible discussion at a later date**

Discussion regarding Gordon Conrow's correspondence regarding Physical Education classes

**VIII. Closing Open Forum**

Discussion continued with the public concerning the following issues:

- Shared Transportation with Cairo-Durham
- Physical Education Compliance
- Health Insurance Refunds
- International Baccalaureate Programme

**IX. Executive Session**

At 9:35 p.m. Jason Reinhard moved, seconded by Ann Holstein and carried unanimously to adjourn to Executive Session after a 20 minutes recess to discuss:

- Contract Negotiations~Greenville Faculty Association (GFA)
- Superintendent Annual Evaluation
- Charge #520-2012-02423 from the EECO (Equal Employment Opportunity Commission)

At 11:18p.m. Jason Reinhard moved, seconded by Ann Holstein and carried unanimously to return to open session.

**X. Adjournment**

At 11:19p.m. Rosanne Stapleton moved, seconded by Gregory Lampman and carried unanimously to adjourn the meeting.

---

District Clerk

---

President Board of Education

Greenville Central School District  
Board of Education  
Minutes  
Business Meeting  
Monday  
June 25, 2012

7:00 p.m.

MS/HS Library Media Center

**I. Call to Order**

A meeting of the Board of Education was held on Monday, June 25, 2012 in the MS/HS Library Media Center. Mr. Wilton Bear, Jr., President, called the meeting to order at 7:00 p.m.

A. Members present: Wilton Bear, Jr.  
Ann Holstein  
Gregory Lampman  
Anne Mitchell  
Jason Reinhard  
Rosanne Stapleton  
Lawrence Tompkins

Others present: Cheryl A. Dudley, Superintendent  
Jacqueline O'Halloran, District Clerk  
Donna Accuosti, Director of Human Resources  
Scott Gardiner, Director of Technology  
Colleen Hall, Director of Curriculum and Communications  
Michael Laster, High School Principal  
Peter Mahan, Elementary School Principal  
Rebecca Martin, Assistant Director of Pupil Personnel Services  
Anders Rasmussen, House Principal  
Brian Reeve, Middle School Principal  
Karen Schrader, Supervisor of Transportation  
Robert Schrader, Supervisor of Buildings and Grounds  
Tammy J. Sutherland, Assistant Superintendent for Business  
Paul Ventura, Sr., Food Service Supervisor  
Linda Wistar, Director of Pupil Personnel Services

There were approximately 150 visitors to the meeting.

**II. Approval of Agenda**

Jason Reinhard moved, seconded by Rosanne Stapleton and carried unanimously to approve the Agenda for the Business Meeting of June 25, 2012

**Code of Conduct Hearing**

The current Code of Conduct was approved at the Board of Education meeting of August 8, 2011. New York State has mandated the implementation of the "Dignity for All Students Act" which requires some changes to the Code of Conduct. Suggestions from district residents will be received through July 11, 2012. Comments from parents and residents will be reviewed by a Code of Conduct Committee and resubmitted for consideration by the Board of Education. The current Code of Conduct document is posted on the District Website.

*("The board of education or the trustees, as defined in section two of this chapter, of every school district within the state, however created, and every board of cooperative educational services and county vocational extension board, shall adopt and amend, as appropriate, a code of conduct for the maintenance of order on school property, including a school function, which shall govern the conduct of students, teachers and other school personnel as well as visitors and shall provide for the enforcement thereof. Such policy may be adopted by the school board or trustees only after at least one public hearing that provides for the participation of school personnel, parents, students and any other interested parties." Education Law – Chapter 16, Title II, Article 55 § 2801)*

There were no public comments regarding the Code of Conduct. The Code of Conduct must be redesigned to address the Dignity for All Students Act. A copy of the Code of Conduct may be found on the District website. Comments and suggestions should be sent to the District Clerk by July 11, 2012. Adoption of the Code of Conduct will be recommended at the August 13, 2012 Board of Education Meeting.

### III. Open Forum

Superintendent Dudley announced that the PTSA will be sponsoring a meeting on Wednesday, June 27, 2012 at 7:00p.m. in the High School Library Advocate for Education in New York now. The purpose of this meeting is to find ways to advocate for education before the next budget cycle.

Public discussion included the following:

- Restoration of all support staff reductions in force
- NYS Compliance in Physical Education
- Bus Maintenance Agreement between the Greenville Central SD and Cairo-Durham Central SD
- Special needs for diabetic students
- Closing of the Middle School cafeteria
- Fontas & Pennel reading assessment scores
- Restoration of teacher reductions in force
- Restoration of Licensed Practical Nurse (LPN) reduction in force

Anne Mitchel moved, seconded by Ann Holstein, and carried unanimously to extend Open Forum for another half-hour.

Jason Reinhard moved, seconded by Ann Holstein and carried unanimously to extend Open Forum for another fifteen minutes.

### IV. Action Items: A – D:

Anne Mitchell moved, seconded by Rosanne Stapleton and carried unanimously to approve item (A):

#### A. Accept Recommendations

##### 1. Committee on Special Education from the meetings of:

- a. May 15, 22, 30 and 31, 2012
- b. June 7 and 8, 2012

Ann Holstein moved, seconded by Jason Reinhard and carried unanimously to approve item (B):

#### B. Approve Personnel Agenda

BE IT RESOLVED that upon the recommendation of Superintendent of Schools, Cheryl A. Dudley, that the Board of Education of the Greenville Central School District approve the following:

##### 1. Unclassified

- a. Recognition of the Greenville Principals' Association  
*(BE IT RESOLVED that the Greenville Central School District Board of Education formally recognize The Greenville Principals' Association as the exclusive representative, for the purposes provided in §204 of the New York State Civil Service Law, of the employees in the following bargaining unit: Elementary Principal, Middle School Principal, High School Principal, House Principal.)*

- b. Designation of Contracts  
*(WHEREAS, on July 10, 2006, the Board of Education (the "Board") of the Greenville Central School District ("the District") approved the terms of the form agreement for administrators employed by the District, then including but not limited to the titles of Principals and Assistant Superintendent for Business; and WHEREAS, the Board subsequently created and filled the following additional administrative positions:*

<i>Title</i>	<i>Effective Date</i>
<i>Director of Curriculum &amp; Communications</i>	<i>July 1, 2009</i>
<i>House Principal</i>	<i>July 1, 2011</i>
<i>Director of Human Resources</i>	<i>July 1, 2011</i>

*NOW, THEREFORE, it is RESOLVED that the position of Director of Curriculum & Communications shall be subject to the terms of the form agreement for administrators, nunc pro tunc, for the period of July 1, 2009 to June 30, 2012; and it is further*

*RESOLVED that the positions of House Principal and Director of Human Resources shall be subject to the terms of the form agreement for administrators, nunc pro tunc, for the period of July 1, 2011 to June 30, 2012.)*

##### c. Substitutes

1. Name: Aileen Rauf
- Position: Extended Term
- Tenure Area: N/A
- Probationary Period: N/A
- Certification: Childhood Education (Grades 1-6)  
Professional  
Literacy (Birth-Grade 6)  
Professional

Effective: February 27, 2012  
 Salary: Column IV Step 4, \$47,987.00 prorated  
 Status: Cleared for employment  
*(According to the current GFA contract Article 1.3, extended term substitute teachers are to be paid on the teacher salary schedule, at the step as determined by the District, for each consecutive day worked for the same teacher for forty-five (45) days or more. Such pay will be retroactive to the first day of employment in that assignment. Effective on the 45<sup>th</sup> day, the extended term substitute will be entitled to the benefits of the CBA. Ms. Rauf is the extended term substitute for Kathleen Gruhle.)*

**II. Classified**

a. Create position

1. Position: Cleaner  
 Classification: GCCS Non-competitive  
 Effective: July 2, 2012 to August 31, 2012  
 Salary: Per hour according to employee's contractual rate of pay/GPF
  
2. Position: Aide/Monitor  
 Classification: GCCS Non-competitive  
 Effective: July 2, 2012 to August 31, 2012  
 Salary: Per hour according to employee's contractual rate of pay/GPF
  
3. Position: Bus Driver  
 Classification: GCCS Non-competitive  
 Effective: July 2, 2012 to August 31, 2012  
 Salary: Per hour according to employee's contractual rate of pay/GPF

c. Transportation Summer 2012

1. Name: Katherine Penniston  
 Position: Aide/Monitor  
 Classification: GCCS Non-competitive  
 Effective: July 2, 2012 to August 31, 2012  
 Salary: Per hour according to employee's contractual rate of pay (\$14.05)/GPF  
 Status: Cleared for employment  
*(This appointment is based on need as required by the student[s] IEP.)*
  
2. Name: Kathleen Rogers  
 Position: Aide/Monitor  
 Classification: GCCS Non-competitive  
 Effective: July 2, 2012 to August 31, 2012  
 Salary: Per hour according to employee's contractual rate of pay (\$15.42)/GPF  
 Status: Cleared for employment  
*(This appointment is based on need as required by the student[s] IEP.)*
  
3. Name: Lynda Wright  
 Position: Aide/Monitor  
 Classification: GCCS Non-competitive  
 Effective: July 2, 2012 to August 31, 2012  
 Salary: Per hour according to employee's contractual rate of pay (\$14.05)/GPF  
 Status: Cleared for employment  
*(This appointment is based on need as required by the student[s] IEP.)*

d. Buildings & Grounds Summer 2012

1. Name: Thomas Fitzgibbons  
 Position: Cleaner  
 Classification: GCCS Non-competitive  
 Effective: July 2, 2012 to August 31, 2012  
 Salary: \$15.48 per hour/GPF  
 Status: Cleared for employment
  
2. Name: Georgina Jones  
 Position: Cleaner  
 Classification: GCCS Non-competitive  
 Effective: July 2, 2012 to August 31, 2012  
 Salary: \$15.48 per hour/GPF  
 Status: Cleared for employment

- |                 |                                 |
|-----------------|---------------------------------|
| 3. Name:        | Mary Judeikis                   |
| Position:       | Cleaner                         |
| Classification: | GCCS Non-competitive            |
| Effective:      | July 2, 2012 to August 31, 2012 |
| Salary:         | \$15.48 per hour/GPF            |
| Status:         | Cleared for employment          |
- e. Bus Drivers Summer 2012
- |            |                                 |
|------------|---------------------------------|
| 1. Name:   | Linda Covais                    |
| Position:  | Bus driver                      |
| Effective: | July 2, 2012 to August 31, 2012 |
| Salary:    | \$22.33 per hour /GPF           |
| Status:    | Cleared for employment          |
- |            |                                 |
|------------|---------------------------------|
| 2. Name:   | Rhonda Hempstead-Julig          |
| Position:  | Bus driver                      |
| Effective: | July 2, 2012 to August 31, 2012 |
| Salary:    | \$22.33 per hour/GPF            |
| Status:    | Cleared for employment          |
- |            |                                 |
|------------|---------------------------------|
| 3. Name:   | James Lawton                    |
| Position:  | Bus driver                      |
| Effective: | July 2, 2012 to August 31, 2012 |
| Salary:    | \$22.33 per hour /GPF           |
| Status:    | Cleared for employment          |
- |            |                                 |
|------------|---------------------------------|
| 4. Name:   | Linda Pidgeon                   |
| Position:  | Cleaner assigned to bus fleet   |
| Effective: | July 2, 2012 to August 31, 2012 |
| Salary:    | \$15.48 per hour/GPF            |
| Status:    | Cleared for employment          |
- |            |                                 |
|------------|---------------------------------|
| 5. Name:   | Sue Spain                       |
| Position:  | Bus driver                      |
| Effective: | July 2, 2012 to August 31, 2012 |
| Salary:    | \$23.47 per hour /GPF           |
| Status:    | Cleared for employment          |

Status: All conditional appointments are subject to receipt of a statement from each individual regarding criminal charges and are contingent upon receipt of criminal background clearance from the Commissioner of Education.

**C. Business Management**

Anne Mitchell moved, seconded by Gregory Lampman and carried unanimously to approve item (1):

**1. Accept donation from:**

- a. The Equine clinic at Oakencroft for \$200.00 to the Greenville Central School District for the HS FFA to offset costs for the horse shows.

Jason Reinhard moved, seconded by Ann Holstein, to postpone voting on the Resolution below until the next Board of Education meeting on July 9, 2012. After discussion the motion was defeated to postpone; 6 opposed to 1 yes (J. Reinhard)

Anne Mitchell moved, seconded by Gregory Lampman and motion carried, 6 yes, 1 no (J. Reinhard) to approve item (2):

**2. IT IS HEREBY RESOLVED that, upon the recommendation of the Superintendent of Schools, the Inter-Municipal Agreement by and between the Greenville Central School District and the Cairo-Durham Central School District dated July 1, 2012 regarding Bus Maintenance Operations is hereby approved. The President of the Board of Education is hereby authorized to execute said agreement on behalf of the School District.**

*(THIS INTER-MUNICIPAL AGREEMENT made and entered into as of this 1<sup>st</sup> day of July, 2012, by and between the CAIRO-DURHAM CENTRAL SCHOOL DISTRICT, a public school district of the State of New York, with offices located at 424 Main Street, Cairo, New York 12413 (hereinafter "Cairo SD") and the GREENVILLE CENTRAL SCHOOL DISTRICT, a public school district of the State of New York with offices located at Rt. 81, Greenville, New York 12083 (hereinafter "Greenville SD").*

*WHEREAS, the Greenville SD owns and maintains facilities and staffing necessary for the repair, maintenance and other tasks associated with maintaining a school bus fleet for a public school district (hereinafter "Bus Maintenance Operations"); and*

*WHEREAS, the Cairo SD operates a school bus fleet but does not own or maintain the facilities and staffing for the repair, maintenance, and other tasks associated with maintaining a school bus fleet for a public school district; and*  
*WHEREAS, the Cairo SD is desirous of utilizing the Bus Maintenance Operations of the Greenville SD; and*  
*WHEREAS, the Greenville SD is desirous of providing Bus Maintenance Operations for the Cairo SD; and*  
*WHEREAS, the Greenville SD is willing to provide Bus Maintenance Operations to the Cairo SD, upon the terms and conditions contained herein; and*  
*WHEREAS, parties have discussed and fully negotiated the costs associated with such services and that entering into this Agreement will be economically beneficial to both parties; and*  
*WHEREAS, Article 5-G, Section 119-o of the General Municipal Law specifically authorizes municipal corporations to enter into inter-municipal cooperative agreements; and*

*NOW, THEREFORE, in consideration of the promises and mutual covenants and agreements contained herein, the parties agree as follows:*

*1. Term – The term of this Agreement shall be from July 1, 2012 through June 30, 2013, unless sooner terminated in accordance with its terms. This Agreement may be extended upon mutual agreement under terms as may be mutually agreed to by the parties.*

*2. Bus Maintenance Operations provided by the Greenville SD shall include, but are not limited to:*

*(a) Routine maintenance, repairs, and service and routine inspections including pre-DOT inspections for all Cairo SD owned vehicles. Such services shall not include major engine repairs or engine swaps, head gasket replacements, transmission rebuilds (transmission exchanges allowable), rear-end rebuilds (rear-end exchanges allowable), injector pump replacements and main wiring harness repairs and other repairs that Greenville SD determines cannot be reasonably performed by its equipment and staff (the Cairo SD shall arrange for other sources for such major repairs);*

*(b) Performance of New York State Department of Transportation mandated vehicle inspections on all Cairo SD vehicles;*

*(c) Maintenance of repair and service records for each Cairo SD vehicle;*

*(d) Routine maintenance and service of all Cairo SD vehicles which shall be scheduled as required or recommended by the manufacturer or NYS and shall be arranged between the Director of Transportation for each School District; and,*

*(e) Road call services related to any Cairo SD vehicle that becomes disabled or is in need of road call services.*

*3. Compensation – In exchange for the Greenville SD providing the above services, the Cairo SD shall pay to it the total sum of \$108,533.00 for the 2012-2013 school year. This sum covers all such services listed above. The cost of parts associated with such services is the responsibility of Cairo SD. Cairo SD shall pay said compensation to Greenville in four equal payments quarterly. In the event of early termination of this Agreement, Greenville SD shall be paid for any pro-rated portion of this annual sum earned to the effective date of termination.*

*4. Indemnity and Insurance.*

*(a)The Greenville SD shall be responsible for repairing any damage to the vehicles of Cairo SD caused when under the supervision of the Greenville SD pursuant to this Agreement.*

*(b)The Cairo SD shall be responsible for repair of any damage done to the Greenville SD Facilities when caused by its operation of its vehicles on the Greenville SD site pursuant to this Agreement.*

*(c)The Cairo SD agrees to indemnify and hold harmless the Greenville SD and its agents and employees from any cause, claim, action, liability, fine, penalty, or proceeding (including attorney's fees) arising, directly or indirectly out of the negligent acts or omissions of the Cairo SD or its officers, employees, or agents with respect to this Agreement. The Greenville SD agrees to indemnify and hold harmless the Cairo SD and its agents and employees for any cause, claim, action, liability, fine, penalty or proceeding (including attorneys' fees) arising directly or indirectly out of the negligent acts or omissions of the Greenville SD or its officers, employees, or agents with respect to this Agreement. This provision, as well as the additional provisions of this Agreement, is solely for the benefit of the parties and the parties intend no benefits to third persons.*

*(d)Each party shall maintain its own insurance to cover the above responsibilities.*

*5. Terms of Agreement*

*(a)This Agreement shall continue in force for an initial period commencing on July 1, 2012 and ending June 30, 2013, and thereafter shall be renewable annually unless terminated by either party at its option upon forty five (45) days' notice to the other party.*

*(b)Either party may terminate this Agreement at any time upon forty five (45) days written notice to the other party or at any time by mutual written agreement.*

*6. Miscellaneous.*

(a) *No Assignment.* The parties agree that this Agreement is based on shared municipal services. Neither party shall assign or subcontract its obligations under this Agreement without the express written consent of the governing board of the other party.

(b) *Notices.* Any and all notices and payments required hereunder shall be addressed as follows, or to such other address as may hereafter be designated in writing by either party hereto:

To Cairo SD: Superintendent of Schools  
Cairo-Durham Central School District  
424 Main Street  
Cairo, NY 12413

To Greenville SD: Superintendent of Schools  
Greenville Central School District  
Rt. 81  
Greenville, NY 12083

(c) *Governing Law, Jurisdiction.* This Agreement shall be governed by the laws of the State of New York. The parties agree and understand that the Supreme Court, Greene County, New York shall have exclusive jurisdiction of any controversy or claim arising out of or relating to this Agreement, or the breach thereof.

(d) *Entire Agreement; Modification; Counterparts.* This Agreement constitutes the complete understating of the parties. No modification of any provision hereof shall be valid unless in writing and signed by both parties. This Agreement may be executed in one or more counterparts, each of which shall be an original for all purposes.

(e) *No Waiver.* No waiver of any breach of any condition of this Agreement shall be binding unless in writing and signed by the party waiving said breach. No such waiver shall in any way affect any other term or condition of this Agreement or constitute a cause or excuse for a repetition of such or any other breach unless the waiver shall include the same.

(f) *Severability.* Any provision of this Agreement is deemed to be invalid or inoperative for any reason, that part shall be deemed modified to the extent necessary to make it valid or operative, or if it cannot be so modified, then severed and the remainder of the Agreement shall continue in full force and effect as if the Agreement had been signed with the invalid portion so modified or eliminated.

7. The parties will meet as necessary to discuss how the agreement is progressing.

8. Agreement Approval – This Agreement is subject to the approval of the Boards of Education of each school district at a duly convened public meeting.)

#### **D. School Management**

Jason Reinhard moved, seconded by Rosanne Stapleton and carried unanimously to approve items (1) and (2):

**1. Approve contract between the Greenville Central School District and Four Winds Saratoga for 2011-2012 (FY2012-104)**

*(This contract is for tutorial services for one [1] district resident student at \$29.00 per hour for ten [10] hours of instruction per week for approximately one to two weeks)*

**2. Approve overnight field trip**

- |                |  |
|----------------|--|
| a. Destination | New York State Fair, 581 State Fair Blvd, Syracuse, NY                     |
| Dates:         | Departing August 27, 2012 at 2:00pm<br>Returning August 31, 2012 at 3:00pm |
| Students:      | Approximately ten (10) HS FFA Students                                     |
| Chaperones:    | Two TBD  |

#### **VI. Discussion**

##### **A. Reserve Fund**

*WHEREAS, pursuant to General Municipal Law §6-m, the Board of Education previously established a Unemployment Insurance Payment Reserve Fund (the “Reserve Fund”); and WHEREAS, the Board of Education anticipates a need to place additional funds into the Reserve Fund upon the conclusion of the 2011-2012 school year*

*NOW, THEREFORE, at a duly called meeting of the Board of Education of the Greenville Central School District, be it*

*RESOLVED, that, upon the recommendation of the Assistant Superintendent for Business, the Board of Education has determined that in may have a need to reserve as much as \$\_\_\_\_\_ in additional funds in the Reserve Fund, and it is further*

*RESOLVED, that upon the closing out of the 2011-2012 school year, the Board will resolve to transfer up to \$ \_\_\_\_\_ in to the Reserve Fund, subject to final approval, from funds available at the close of the 2011-2012 fiscal year.)*

Assistant Superintendent for Business, Tammy Sutherland recommended to restore approximately \$90,000.00 to the Reserve fund for unemployment insurance for 2012-2013 as an action item on the July 9, 2012 Board of Education meeting.

**B. Priorities from Principals for the 2012-2013 Budget**

**VII. Action item:**

**Proposed Reductions in Force (in order of Principal's Priority List)**

**A. Unclassified**

Gregory Lampman moved, seconded by Rosanne Stapleton and carried unanimously to approve item (1):

1. Elimination of Position: 0.2 FTE Physical Education Teacher  
Tenure Area: Physical Education  
Effective: July 1, 2012  
Least senior employee: Gordon Conrow  
*(This position is abolished effective July 1, 2012. Mr. Conrow is the person having the least seniority in the tenure area of Physical Education. Mr. Conrow shall be placed upon the preferred eligible list of the district in accordance with Education Law §3013[3]. Cost of restoration to a 0.8FTE position is \$79,580.00)*

Rosanne Stapleton moved, seconded by Jason Reinhard and carried unanimously to approve item (2) and to review the foreign language program at the District with the Quality Education Committee (QEC):

2. Elimination of Position 0.4FTE Foreign Language Teacher  
Tenure Area: Foreign Language  
Effective: July 1, 2012  
Least senior employee: John Gleason  
*(This position is abolished effective July 1, 2012. Students currently enrolled in Japanese courses will have the option of completing their sequence. A Memorandum of Agreements is to be developed between the Greenville Faculty Association [GFA] and the District on behalf of Mr. Gleason to be assigned to a dual tenure area of Foreign language and Social Studies. Cost of Restoration: 0.2FTE already budgeted, restoration to 0.6FTE is \$37,923.00 )*

Jason Reinhard moved, seconded by Anne Mitchell and carried unanimously to restore the Modified Sports Program (3):

3. Modified Sports  
*(Cost of restoration \$38,023.00)*

**B. Classified**

Jason Reinhard moved, seconded by Ann Holstein for the Elimination of Position (LPN) below (1): Motion defeated unanimously (position restored)

1. Elimination of Position Licensed Practical Nurse (LPN)  
Reduction of 30 minutes plus benefits  
Classification: GCCS Non Competitive  
Effective: July 1, 2012  
*(Cost of restoration \$21,402.00)*

**C. Unclassified**

Anne Mitchell moved, seconded by Ann Holstein and carried unanimously to approve item (1):

1. Elimination of Position: 0.4 FTE Home & Careers Teacher  
Tenure Area: Home Economics  
Effective: July 1, 2012  
Least senior employee: Katherine Schlenker  
*(This position is abolished effective July 1, 2012. Ms. Schlenker is the person having the least seniority in the tenure area of Home Economics. Ms. Schlenker shall be placed upon the preferred eligible list of the district in accordance with Education Law §3013[3]. Cost of restoration from a 0.6FTE to 0.8FTE is \$18,470.00)*

Gregory Lampman moved, seconded by Rosanne Stapleton and carried unanimously to approve item (2):

2. Elimination of Position: 0.6 FTE Business Education Teacher  
Tenure Area: Business Education  
Effective: July 1, 2012  
Least senior employee: Linda Esposito  
*(This position is abolished effective July 1, 2012. Ms. Esposito is the person having the least seniority in the tenure area of Business Education. Ms. Esposito shall be placed upon the preferred eligible list of the district in accordance with Education Law §3013[3]. Cost of restoration from a 0.4FTE to a 0.6FTE is \$18,045.00)*

Anne Mitchell moved, seconded by Jason Reinhard and carried unanimously to approve item (3):

3. Elimination of Position: 1.0FTE Elementary

Tenure Area: Elementary (Computer Technology)  
Effective: July 1, 2012  
Least senior employee: Pamela Hollinde  
*(This position is abolished effective July 1, 2012 Ms. Hollinde is the next person having the least seniority in the tenure area of Elementary. Ms. Hollinde shall be placed upon the preferred eligible list of the district in accordance with Education Law §3013[3]. Cost of restoration to a 1.0FTE is \$102,640.00)*

**D. Classified**

Jason Reinhard moved, seconded by Anne Mitchell and carried unanimously to approve item (1):

1. Reduction in Months

Position: Twelve-Month Clerical  
Classification: GCCS Competitive  
Effective: July 1, 2012

*(The following employees will be reduced from twelve- month positions to ten-month plus 20 days effective July 1, 2012:*

*Marybeth Favicchio  
Deborah Ferello-Sanchez  
Deborah Geurtze  
Dina Klob  
Tina Warnstadt*

*The following employee will be reduced from twelve- month position to ten-month month position effective July 1, 2012:*

*Daphane Pearson*

*Cost of restoration: \$64,268.00)*

**E. Unclassified**

Anne Mitchell moved, seconded by Ann Holstein and carried unanimously to approve the reduction in force items (1) and (2):

1. MS After School Help (2 Math, 2 ELA, 1 Science 1 Social Studies  
*(Cost of restoration \$9,000.00; \$1,500 each)*

2. Elementary Student Activity Club Advisor Stipend  
*(Cost of restoration \$1,989.00)*

Gregory Lampman moved to restore the SADD Club advisor Stipend, seconded by Ann Holstein. The motion carried 6 yes, 1 no (A. Mitchell) to restore (3):

3. SADD Club Advisor Stipend  
*(Cost of restoration \$1,364.00)*

Ann Holstein moved, seconded by Rosanne Stapleton and carried unanimously to approve item (4):

4. Elimination of Position: Elementary (Gifted & Talented Teacher)  
Tenure Area: Elementary  
Effective: July 1, 2012  
Least senior employee: Susan Somers

*(This position is abolished effective July 1, 2012. Ms. Somers is the person having the least seniority in the tenure area of Elementary. Ms. Somers shall be placed upon the preferred eligible list of the district in accordance with Education Law §3013[3]. Cost of restoration \$89,666.00)*

Rosanne Stapleton moved, seconded by Jason Reinhard and carried unanimously to approve item (5):

5. Elimination of Position: 0.4 FTE Art Teacher  
Tenure Area: Art  
Effective: July 1, 2012  
Least senior employee:

*(This position is abolished effective July 1, 2012. There is a 0.6FTE budgeted. This recommendation is 0.2FTE beyond the budget for a 0.8FTE. Cost of restoration \$20,869.00)*

**Proposed Reductions in Force not on Principals Priority List**

Jason Reinhard moved, seconded by Anne Mitchell and carried unanimously to approve item (6):

6. Reduction in Force: Elementary  
Tenure Area: Elementary  
Effective: July 1, 2012  
Least senior employees: Pam Germain-Asam  
Karen Rosenberg

*(Reasons for Reduction in Force:  
Teacher[s] returning from Leave of Absence*

*Teacher[s] returning from Special Assignment*  
*Next least senior employee[s]: Pam Germain-Asam*  
*Karen Rosenberg*

*Ms. Germain-Asam and Ms. Rosenberg shall be placed upon the preferred eligible list of the district in accordance with Education Law §3013[3].)*

Ann Holstein moved, seconded by Lawrence Tompkins and carried unanimously to approve item (7):

7. Elimination of Position: 0.4FTE Agriculture  
Tenure Area: Agriculture  
Effective: July 1, 2012  
Least senior employee: Michaela Kehrer  
*(This position is abolished effective July 1, 2012 Ms. Kehrer is the next person having the least seniority in the tenure area of Agriculture. Ms. Kehrer shall be placed upon the preferred eligible list of the district in accordance with Education Law §3013[3].)*

Gregory Lampman moved, seconded by Rosanne Stapleton and carried unanimously to approve item (8):

8. Elimination of Position: 0.2FTE Mathematics  
Tenure Area: Mathematics  
Effective: July 1, 2012  
Least senior employee: TBD  
*(This position is abolished effective July 1, 2012. The next person having the least seniority in the tenure area of Mathematics shall be placed upon the preferred eligible list of the district in accordance with Education Law §3013[3].)*

Anne Mitchell moved, seconded by Ann Holstein and carried unanimously to approve item (9):

9. Elimination of Position: 0.2 FTE Health Teacher  
Tenure Area: Health  
Effective: July 1, 2012  
Least senior employee: James Tyrrell  
*(This position is abolished effective July 1, 2012. Mr. Tyrrell is the person having the least seniority in the tenure area of Health. Mr. Tyrrell shall be placed upon the preferred eligible list of the district in accordance with Education Law §3013[3].)*

Anne Mitchell moved, seconded by Rosanne Stapleton and carried unanimously to approve item (10):

10. Elimination of Position: 1.0FTE Teaching Assistant  
Tenure Area: Teaching Assistant  
Effective: July 1, 2012  
Least senior employee: Amie Roe  
*(This position is abolished effective July 1, 2012. Ms. Roe is the person having the least seniority in the tenure area of Elementary. Ms. Roe shall be placed upon the preferred eligible list of the district in accordance with Education Law §3013[3].)*

## **F. Classified**

### **a. Reduction in Force**

Anne Mitchell moved, seconded by Jason Reinhard to postpone action on (1) Reduction in Hours, until the Board of Education Meeting on July 9, 2012. The motion was carried unanimously.

#### **1. Reduction in Hours**

Position: Aide/Monitor  
Classification: GCCS Non-Competitive  
Effective: July 1, 2012

*(Daily hours for the following employees will be reduced effective July 1, 2012 to the following:*

*Lisa Johnson [3 hours and 35 minutes]*  
*Diane Fox [6 hours]*  
*Laura Mastrantuono [6 hours 5 minutes]*  
*Gloria Louban [6 hours 10 minutes]*  
*Arlene Furmanek [6 hours 15 minutes]*  
*Dorothy Benning [4 hours 5 minutes]*  
*Edith DeSarno [4 hours 55 minutes])*

Rosanne Stapleton moved, seconded by Ann Holstein and carried unanimously to approve items (2), (3), (4) and (5):

#### **2. Reduction in Hours**

Position: Food Services  
Classification: GCCS Non-Competitive  
Effective: July 1, 2012

*(Daily hours for the following employees will be reduced by fifteen [15] minutes*

each effective July 1, 2012 as follows:

*Katherine Allen  
Gloria Caggiano  
Frankie Callahan  
Mary Haller  
Dawn Herwick  
Mary Judeikis  
Kristine Pastina  
Denise Ridings  
Catherine Stock  
Michele Weidman)*

3. Reduction in Hours

Position: Clerical (two hours)  
Classification: GCCS Competitive  
Effective: July 1, 2012  
Name: Zena Higgins

4. Reduction in Force

Position: Bus Driver  
Classification: GCCS Non-Competitive  
Effective: July 1, 2012  
Least senior employee: Wanda Bates

5. Reduction in Force

Position: Late Bus Runs  
Classification: GCCS Non-Competitive  
Effective: July 1, 2012

*(Due to the elimination of the late bus, the following bus drivers will lose the late bus run:*

*Linda Covais  
Thomas Fitzgibbons  
James Lawton  
Katherine Penniston  
Susan Spain)*

**VIII. Board members' input for possible discussion at a later date**

Student Achievement: Math & ELA, International Baccalaureate, Propane fuel for buses.

**IX. Closing Open Forum**

Resident Duncan Macpherson thanked Board members Wilton Bear, Jr. and Lawrence Tompkins for their years of service on the Board of Education.

Points of Discussion included:

- Reduction in Support Staff and loss of insurance
- Bus Maintenance Agreement between the Greenville Central SD and the Cairo-Durham Central SD
- Administrative Contracts
- Shared Services for Human Resources and Curriculum Coordinator

**X. Executive Session**

At 11:00 p.m. Anne Mitchell moved, seconded by Jason Reinhard and carried unanimously to adjourn to Executive Session to discuss:

- Contract negotiations concerning the GFA
- Superintendent's Annual Review with the Superintendent

At 12:45 a.m. Rosanne Stapleton moved, seconded by Ann Holstein and carried unanimously to return to open session.

**XI. Adjournment**

At 12.46 a.m. Rosanne Stapleton moved, seconded by Ann Holstein and carried unanimously to adjourn the meeting.

---

District Clerk

---

President, Board of Education

**APPROPRIATION STATUS REPORT - BY FUNCTION: FOR PERIOD 07/01/11 - 06/30/12 (Detail)**

ACCOUNT	DESCRIPTION	ORIG BUDGET	ADJUSTMENTS	ADJ BUDGET	EXPENSED	ENCUMBERED	AVAILABLE
SA 2110.450-01-BOOK	BOOK STORE	999.70	223.14	1,222.84	407.00	0.00	815.84
SA 2110.450-01-MENT	MENTORING CLUB	1,103.68	292.59	1,396.27	0.00	0.00	1,396.27
SA 2110.450-01-STUD	STUDENT COUNCIL	1,959.91	6,511.24	8,471.15	3,793.21	0.00	4,677.94
SA 2110.450-01-YEAR	ELEM YEARBOOK	1,227.91	4,382.48	5,610.39	0.00	0.00	5,610.39
SA 2110.450-02-2011	CLASS OF 2011	2,317.59	0.00	2,317.59	2,317.59	0.00	0.00
SA 2110.450-02-2012	CLASS OF 2012	7,686.35	20,138.19	27,824.54	27,824.54	0.00	0.00
SA 2110.450-02-2013	CLASS OF 2013	7,361.98	14,429.64	21,791.62	12,596.79	0.00	9,194.83
SA 2110.450-02-2014	CLASS OF 2014	2,011.91	6,179.72	8,191.63	2,512.29	0.00	5,679.34
SA 2110.450-02-2015	CLASS OF 2015	940.03	2,598.64	3,538.67	822.30	0.00	2,716.37
SA 2110.450-02-2016	CLASS OF 2016	660.03	0.00	660.03	0.00	0.00	660.03
SA 2110.450-02-2017	CLASS OF 2017	1,671.18	1,800.00	3,471.18	2,185.54	0.00	1,285.64
SA 2110.450-02-ARTC	ART CLUB	98.70	0.00	98.70	0.00	0.00	98.70
SA 2110.450-02-ATHL	ATHLETIC	7,384.92	7,750.00	15,134.92	5,725.91	0.00	9,409.01
SA 2110.450-02-AWAR	AWARDS	80.07	3,500.00	3,580.07	3,500.00	0.00	80.07
SA 2110.450-02-BAND	BAND	4,192.29	100.00	4,292.29	0.00	0.00	4,292.29
SA 2110.450-02-CHEE	CHEERLEADING	10.82	0.00	10.82	0.00	0.00	10.82
SA 2110.450-02-CULI	CULINARY CLUB	551.73	0.00	551.73	0.00	0.00	551.73
SA 2110.450-02-FORE	INTERNATIONAL CLUB	1,068.04	0.00	1,068.04	0.00	0.00	1,068.04
SA 2110.450-02-INTE	INTERACT CLUB	1,016.00	1,122.38	2,138.38	1,191.32	0.00	947.06
SA 2110.450-02-LIBR	HS LIBRARY CLUB	228.10	0.00	228.10	0.00	0.00	228.10
SA 2110.450-02-MUSI	HS MUSICAL	11,515.17	9,338.57	20,853.74	7,076.51	0.00	13,777.23
SA 2110.450-02-NLHS	NATIONAL HONOR SOCIETY	1,138.84	603.38	1,742.22	1,027.70	0.00	714.52
SA 2110.450-02-PEPC	PEP CLUB	878.45	377.78	1,256.23	0.00	0.00	1,256.23
SA 2110.450-02-SADD	SADD	270.08	2,640.00	2,910.08	2,910.08	0.00	0.00
SA 2110.450-02-SALE	SALES TAX	1,018.73	4,020.14	5,038.87	4,272.07	0.00	766.80
SA 2110.450-02-SFFA	SENIOR FFA	3,603.29	15,874.91	19,478.20	14,668.88	0.00	4,809.32
SA 2110.450-02-SKIC	SKI CLUB	1,239.31	0.00	1,239.31	0.00	0.00	1,239.31
SA 2110.450-02-STUD	HS STUDENT COUNCIL	3,333.36	3,774.93	7,108.29	3,905.21	0.00	3,203.08
SA 2110.450-02-VIDE	VIDEO CLUB	1,151.36	46.30	1,197.66	200.00	0.00	997.66
SA 2110.450-02-YEAR	HS YEARBOOK	4,768.29	13,168.27	17,936.56	13,898.24	0.00	4,038.32
SA 2110.450-03-JFFA	JR FFA	2,086.83	571.63	2,658.46	270.69	0.00	2,387.77
SA 2110.450-03-MNHS	JUNIOR NATIONAL HONOR SOCIETY	629.91	130.00	759.91	135.56	0.00	624.35
SA 2110.450-03-MUSI	MS MUSICAL	7,299.62	3,413.99	10,713.61	3,065.74	0.00	7,647.87
SA 2110.450-03-SKIC	MS SKI CLUB	613.05	0.00	613.05	0.00	0.00	613.05
SA 2110.450-03-STUD	MS STUDENT COUNCIL	7,486.44	3,763.74	11,250.18	4,827.92	0.00	6,422.26
SA 2110.450-03-YEAR	MS YEARBOOK	416.19	5,279.65	5,695.84	4,364.20	0.00	1,331.64
<b>SA 2110....</b>	<b>*</b>	<b>90,019.86</b>	<b>132,031.31</b>	<b>222,051.17</b>	<b>123,499.29</b>	<b>0.00</b>	<b>98,551.88</b>
<b>SA 21....</b>	<b>**</b>	<b>90,019.86</b>	<b>132,031.31</b>	<b>222,051.17</b>	<b>123,499.29</b>	<b>0.00</b>	<b>98,551.88</b>
<b>SA 2....</b>	<b>***</b>	<b>90,019.86</b>	<b>132,031.31</b>	<b>222,051.17</b>	<b>123,499.29</b>	<b>0.00</b>	<b>98,551.88</b>
<b>GRAND TOTALS</b>		<b>90,019.86</b>	<b>132,031.31</b>	<b>222,051.17</b>	<b>123,499.29</b>	<b>0.00</b>	<b>98,551.88</b>

**Greenville Central School  
Investment Report 2011/2012**

<u>Account</u>	<u>Interest Earned</u>
General premier money market	29,753.20
Trust & Agency	2,301.85
Capital	1,144.10
Capital Reserve	2,713.56
Tax Certiorari	41.06
Unemployment	368.69
Retirement	313.08
	<hr/>
<b>Total Earned</b>	<b><u><u>36,635.54</u></u></b>

Dated: July 9, 2012

---

  
Janet Maassmann, District Treasurer

Greenville Central School  
Transfer of Funds  
June 2012

FROM:		TO:		AMOUNT:			
1)	2250 470 09 0000	Tuition - Private Schools	\$ 442	2250 400 07 0003	State Services	\$ 442	*
2)	2070 490 07 0007	Regional Scoring	\$ 3,688	1989 400 07 0001	Bond & Note Issue Expense	\$ 3,688	*
3)	2610 400 07 0000	Computer Support	\$ 2,031	2610 450 02 0008	Computer Supplies	\$ 2,031	*
4)	2850 150 07 0000	Salaries	\$ 638	2815 160 07 0000	Salaries	\$ 638	*
5)	1620 160 07 0000	Salaries	\$ 13,241	1240 160 05 0000	Salaries	\$ 10,229	*
				1310 160 05 0000	Salaries	\$ 3,012	*
6)	2855 150 07 0000	Salaries - coaches	\$ 2,990	2855 450 07 0017	Modified Teams	\$ 2,990	*
7)	1620 404 07 0653	Mats and Carpets	\$ 1,000	1620 450 07 0671	Paper Supplies	\$ 1,000	*
	1620 404 07 0659	Fire System Service contract	\$ 186	1620 450 07 0670	Cleaning Supplies	\$ 186	*
8)	2110 120 01 0000	Salaries K-3	\$ 21,228	2110 480 07 0011	K-12 Textbooks	\$ 21,228	*
9)	2110 450 07 0011	K-12 Supplies	\$ 52	A2110480030053	Textbooks	\$ 52	*
10)	1010 400 05 0103	Conference & Travel	\$ 175	1040 400 05 0000	Conference & Travel	\$ 175	*
11)	5510 400 04 0001	Outside Labor	\$ 2,500	5510 450 04 0001	Parts	\$ 2,500	*
12)	2070 400 07 0000	In-service Education	\$ 13	2070 450 07 0000	In-service Education	\$ 13	*
13)	2250 470 09 0000	Private Tuition	\$ 2,218	2250 490 07 0000	BOCES - Tuition	\$ 2,218	*
14)	2250 490 07 0000	BOCES - Tuition	\$ 209	2250 400 07 0003	State Services	\$ 209	*
15)	2070 490 07 0007	Regional Scoring	\$ 10,678	2630 490 07 0000	Questar - Network Printers	\$ 10,678	*
			<u>\$ 61,289</u>			<u>\$ 61,289</u>	

- 1) Transfer needed to cover a Psychological Evaluation (Grapeville Student - billed to district of residence)
- 2) Transfer to cover expenses related to the sale of bonds (bus purchase) - carryover
- 3) Transfer from computer support to computer supplies for year end purchases - carryover
- 4) Transfer among salary codes - under budgeted
- 5) Transfer among salary codes to pay for year end retirement expenses (sick leave, vacation leave) and Superintendents performance evaluation
- 6) Transfer to set up unused funds budgeted under athletics for a carryover to go towards modified sports
- 7) Transfer among building & ground codes for year end supply purchase
- 8) Transfer to purchase the Math in Focus textbooks for middle school and workbooks for elementary school (new curriculum)
- 9) Transfer from supplies to textbooks
- 10) Transfer among conference & travel codes - annual workshop for district clerk
- 11) Transfer among transportation codes for year end part order

- 12) Transfer among in-service contractual code to supply code for supplies
- 13) Transfer among tuition codes (private/BOCES)
- 14) Transfer for the cost of Interpreter/translator services - regents (ESL - English Second Language)
- 15) Transfer among Questar codes - Some of the costs associated with network printers (copiers) were coded under contractual codes

BOARD OF EDUCATION

July 9, 2012

Transfer made pending Board approval \*

**Board Action Sheet**  
**Meeting Date: 04/27/2012**  
**Greenville Central School District**

Printed: 06/19/2012 10:41

*Committee : Greenville MS/HS CSE Sub-Committee*

D	DOB	Gender	Grd	Disability	Meeting	Mtg Date	Ref Date	Outcome	12 Mth
010800674	11/14/1993	M	G11	Traumatic brain injury	Annual Review	04/27/12		IEP Change: Remains Classified	
	<b>Primary Service</b>		<b>Fut. End Date</b>	<b>Service Description</b>	<b>Freq / Cycle Minutes</b>	<b>Delivery Recommendations</b>	<b>School/ Location</b>		
CURRENT YEAR	Yes	09/07/2011	06/22/2012	Consultant Teacher services direct/indirect	1/Quarter 45 Minutes	Direct	Hospital Setting Hospital		
NEXT YEAR	Yes	09/05/2012	06/21/2013	Consultant Teacher services direct/indirect	1/Quarter 60 Minutes	Direct	Hospital Setting Hospital		

**Minutes:** Annual review. Change of IEP. Student will receive IEP diploma June 2012. Student will continue to receive special education services until the age of 21.

Total Meetings: 1

**Board Action Sheet**  
**Meeting Date: 05/04/2012**  
**Greenville Central School District**

Printed: 06/20/2012 9:39

*Committee : Greenville CSE*

D	DOB	Gender	Grd	Disability	Meeting	Mtg Date	Ref Date	Outcome	12.Mth
900000169	12/07/2006	M	PRK	Preschool student with a disability   As of 09/01/12: Autism	Transfer Student/Intake	05/04/12		IEP Change: Remains Classified	
	<b>Primary Service</b>	<b>Start Date</b>	<b>Fut. End Date</b>	<b>Service Description</b>	<b>Freq / Cycle Minutes</b>	<b>Delivery Recommendations</b>	<b>School/ Location</b>	<b>Coordinating Service Provider</b>	
CURRENT YEAR	Yes	09/07/2011	06/22/2012	2.5 Hour Integrated Preschool Program Class	5/Weekly 150 Minutes	8 STUDENTS/1 TEACHER/1 AIDE	Country Acres in classroom	FAMILY & EDUCATIONAL CONSULTANTS	
CURRENT YEAR	No	09/07/2011	06/22/2012	Speech/Language Therapy	3/Weekly 30 Minutes	Individual	Country Acres Push-in services	FAMILY & EDUCATIONAL CONSULTANTS	
CURRENT YEAR	No	09/07/2011	06/22/2012	Occupational Therapy	2/Weekly 30 Minutes	Individual	Country Acres Push-in services	FAMILY & EDUCATIONAL CONSULTANTS	
CURRENT YEAR	No	09/07/2011	06/22/2012	Physical Therapy	2/Weekly 30 Minutes	Individual	Country Acres Push-in services	FAMILY & EDUCATIONAL CONSULTANTS	
NEXT YEAR	Yes	07/02/2012	08/10/2012	2.5 Hour Integrated Preschool Program Class	5/Weekly 150 Minutes	8 STUDENTS/1 TEACHER/1 AIDE	Country Acres in classroom	FAMILY & EDUCATIONAL CONSULTANTS	
NEXT YEAR	No	07/02/2012	08/10/2012	Occupational Therapy	2/Weekly 30 Minutes	Individual	Country Acres Push-in services	FAMILY & EDUCATIONAL CONSULTANTS	
NEXT YEAR	No	07/02/2012	08/10/2012	Physical Therapy	2/Weekly 30 Minutes	Individual	Country Acres Push-in services	FAMILY & EDUCATIONAL CONSULTANTS	
NEXT YEAR	No	07/02/2012	08/10/2012	Speech/Language Therapy	3/Weekly 30 Minutes	Individual	Country Acres Push-in services	FAMILY & EDUCATIONAL CONSULTANTS	
NEXT YEAR	Yes	09/01/2012	06/30/2013	Consultant Teacher Direct	5/Weekly 60 Minutes	Direct	Greenville Elementary School English Classroom		
NEXT YEAR	No	09/01/2012	06/30/2013	Consultant Teacher Direct	5/Weekly 60 Minutes	Direct	Greenville Elementary School Math class		
NEXT YEAR	No	09/01/2012	06/30/2013	Occupational Therapy	2/Weekly 30 Minutes	Group	Greenville Elementary School Push In/Pull out		

**Board Action Sheet**  
**Meeting Date: 05/04/2012**  
**Greenville Central School District**

Printed: 06/20/2012 9:39

*Committee : Greenville CSE*

D		DOB	Gender	Grd	Disability	Meeting	Mtg Date	Ref Date	Outcome	12 Mth
NEXT YEAR	No	09/01/2012	06/30/2013		Physical Therapy	1/Weekly 30 Minutes	Group		Greenville Elementary School Push In/Pull out	
NEXT YEAR	No	09/01/2012	06/30/2013		Speech/Language Therapy	1/Weekly 30 Minutes	Individual		Greenville Elementary School Push In/Pull out	
NEXT YEAR	No	09/01/2012	06/30/2013		Speech/Language Therapy	2/Weekly 30 Minutes	Group		Greenville Elementary School Push In/Pull out	

**Total Meetings: 6**

**Board Action Sheet**  
**Meeting Date: 05/08/2012**  
**Greenville Central School District**

Printed: 06/19/2012 11:18

*Committee : Greenville CSE Sub-Committee*

ID	DOB	Gender	Grd	Disability	Meeting	Mtg Date	Ref Date	Outcome	12 Mth
----	-----	--------	-----	------------	---------	----------	----------	---------	--------

000010836	06/19/2003	M	G03	Speech or language impairment	Reevaluation/ Annual	05/08/12		IEP Change: Remains Classified	
-----------	------------	---	-----	-------------------------------	----------------------	----------	--	--------------------------------	--

	Primary Service	Start Date	Fut. End Date	Service Description	Freq / Cycle Minutes	Delivery Recommendations	School/ Location
CURRENT YEAR	Yes	09/07/2011	06/22/2012	12:1:1 class	5/Weekly 360 Minutes		Greenville Elementary School Special Education Classroom
CURRENT YEAR	No	09/07/2011	06/22/2012	Speech/Language Therapy	3/Weekly 30 Minutes	Group	Greenville Elementary School Classroom/Office (pull-out service)
NEXT YEAR	Yes	09/01/2012	06/30/2013	12:1:1 class	5/Weekly 360 Minutes		Greenville Elementary School Special Education Classroom
NEXT YEAR	No	09/01/2012	06/30/2013	Speech/Language Therapy	3/Weekly 30 Minutes	Group	Greenville Elementary School Classroom/Office (pull-out service)

**Minutes:** Annual review. Change of IEP.

010600017	02/25/2001	F	G05	Learning disability	Reevaluation/ Annual	05/08/12		IEP Change: Remains Classified	
-----------	------------	---	-----	---------------------	----------------------	----------	--	--------------------------------	--

	Primary Service	Start Date	Fut. End Date	Service Description	Freq / Cycle Minutes	Delivery Recommendations	School/ Location
CURRENT YEAR	Yes	09/07/2011	06/22/2012	Special Class Reading	5/Weekly 45 Minutes		Greenville Elementary School Special Education Classroom
CURRENT YEAR	No	09/07/2011	06/22/2012	Speech/Language Therapy	2/Weekly 45 Minutes	Group	Greenville Elementary School Classroom/Office (pull-out service)
CURRENT YEAR	No	09/07/2011	06/22/2012	Integrated Co-Teaching Services	5/Weekly 120 Minutes	Direct	Greenville Elementary School General education classroom
NEXT YEAR	Yes	09/01/2012	06/30/2013	Resource Room	3/6 Day Cycle 40 Minutes		Greenville Middle School Special Education Classroom

**Board Action Sheet**  
**Meeting Date: 05/08/2012**  
**Greenville Central School District**

Printed: 06/19/2012 11:18

*Committee : Greenville CSE Sub-Committee*

D	DOB	Gender	Grd	Disability	Meeting	Mtg Date	Ref Date	Outcome	12 Mth
NEXT YEAR	No	09/01/2012	06/30/2013	Speech/Language Therapy	3/Weekly 30 Minutes	Group		Greenville Middle School Classroom/Office (pull-out service)	
NEXT YEAR	No	09/01/2012	06/30/2013	Special Class Math	5/Weekly 40 Minutes			Greenville Middle School Special Education Classroom	
NEXT YEAR	No	09/01/2012	06/30/2013	Integrated Co-Teaching Services	5/Weekly 40 Minutes	Direct		Greenville Middle School English Classroom	
NEXT YEAR	No	09/01/2012	06/30/2013	Special Class Reading	5/Weekly 40 Minutes			Greenville Middle School Special Education Classroom	

**Minutes:** Annual review. Change of IEP.

010700437	05/08/2002	M	G04	Hearing impairment		Annual Review	05/08/12		IEP Change: Remains Classified
	<b>Primary Service</b>	<b>Start Date</b>	<b>Fut. End Date End Date</b>	<b>Service Description</b>	<b>Freq / Cycle Minutes</b>	<b>Delivery Recommendations</b>		<b>School/ Location</b>	

**Minutes:** Annual review. Student does not receive special education classroom instruction. Student receives testing accommodations and program modifications due to students hearing impairment.

010700421	04/17/2002	F	G04	Learning disability		Annual Review	05/08/12		IEP Change: Remains Classified
	<b>Primary Service</b>	<b>Start Date</b>	<b>Fut. End Date End Date</b>	<b>Service Description</b>	<b>Freq / Cycle Minutes</b>	<b>Delivery Recommendations</b>		<b>School/ Location</b>	
CURRENT YEAR	Yes	09/07/2011	06/22/2012	Special Class Reading	5/Weekly 45 Minutes			Greenville Elementary School Special Education Classroom	
CURRENT YEAR	No	09/07/2011	06/22/2012	Integrated Co-Teaching Services	5/Weekly 120 Minutes	Direct		Greenville Elementary School General education classroom	
CURRENT YEAR	No	09/07/2011	06/22/2012	Occupational Therapy	1/Weekly 30 Minutes	Group		Greenville Elementary School Classroom/Office (pull-out service)	

**Board Action Sheet**  
**Meeting Date: 05/08/2012**  
**Greenville Central School District**

Printed: 06/19/2012 11:18

*Committee : Greenville CSE Sub-Committee*

ID	DOB	Gender	Grd	Disability	Meeting	Mtg Date	Ref Date	Outcome	12 Mth
NEXT YEAR	Yes	09/01/2012	06/30/2013	Special Class Reading	5/Weekly 30 Minutes			Greenville Elementary School Special Education Classroom	
NEXT YEAR	No	09/01/2012	06/30/2013	Occupational Therapy	1/Weekly 30 Minutes	Group		Greenville Elementary School Classroom/Office (pull-out service)	
NEXT YEAR	No	09/01/2012	06/30/2013	Integrated Co-Teaching Services	5/Weekly 120 Minutes	Direct		Greenville Elementary School General education classroom	

**Minutes:** Annual review. Change of IEP.

900000635	06/19/2000	M	G05	Emotional disturbance	Transfer Student/Intake Annual Review	05/08/12 05/08/12		IEP Change: Remains Classified IEP Change: Remains Classified
-----------	------------	---	-----	-----------------------	---	----------------------	--	--

	Primary Service	Start Date	Fut. End Date	Service Description	Freq / Cycle Minutes	Delivery Recommendations	School/ Location
CURRENT YEAR	Yes	05/08/2012	06/22/2012	Integrated Co-Teaching Services	5/Weekly 120 Minutes	Direct	Greenville Elementary School General education classroom
CURRENT YEAR	No	05/08/2012	06/22/2012	Speech/Language Therapy	2/Weekly 30 Minutes	Group	Greenville Elementary School Classroom/Office (pull-out service)
CURRENT YEAR	No	05/08/2012	06/22/2012	Counseling	1/Weekly 30 Minutes	Individual	Greenville Elementary School Classroom/Office (pull-out service)
NEXT YEAR	Yes	09/01/2012	06/30/2013	8:1:1 Class	5/Weekly 80 Minutes		Greenville Middle School Special Education Classroom
NEXT YEAR	No	09/01/2012	06/30/2013	Counseling	1/Weekly 30 Minutes	Individual	Greenville Middle School Classroom/Office (pull-out service)
NEXT YEAR	No	09/01/2012	06/30/2013	Counseling	1/Weekly 30 Minutes	Group	Greenville Middle School Classroom/Office (pull-out service)

**Minutes:** Student entered GCS having previously been identified as a student with a disability. Change of IEP.

**Board Action Sheet**  
**Meeting Date: 05/08/2012**  
**Greenville Central School District**

Printed: 06/19/2012 11:18

*Committee : Greenville CSE Sub-Committee*

ID	DOB	Gender	Grd	Disability	Meeting	Mtg Date	Ref Date	Outcome	12 Mth
----	-----	--------	-----	------------	---------	----------	----------	---------	--------

900000211	12/22/2005	M	KFD	Speech or language impairment	Annual Review	05/08/12		IEP Change: Remains Classified	
-----------	------------	---	-----	-------------------------------	---------------	----------	--	--------------------------------	--

		Primary Service	Fut. End Date	Service Description	Freq / Cycle Minutes	Delivery Recommendations	School/ Location
CURRENT YEAR	Yes	09/07/2011	06/22/2012	Speech/Language Therapy	3/Weekly 30 Minutes	Group	Greenville Elementary School Classroom/Office (pull-out service)
NEXT YEAR	Yes	09/01/2012	06/30/2013	Speech/Language Therapy	2/Weekly 30 Minutes	Group	Greenville Elementary School Classroom/Office (pull-out service)

**Minutes:** Annual review. Change of IEP.

900000445	08/05/2004	M	G02	Speech or language impairment	Annual Review	05/08/12		IEP Change: Remains Classified	
-----------	------------	---	-----	-------------------------------	---------------	----------	--	--------------------------------	--

		Primary Service	Fut. End Date	Service Description	Freq / Cycle Minutes	Delivery Recommendations	School/ Location
CURRENT YEAR	Yes	09/07/2011	06/22/2012	Integrated Co-Teaching Services	5/Weekly 120 Minutes	Direct	Greenville Elementary School General education classroom
CURRENT YEAR	No	09/07/2011	06/22/2012	Speech/Language Therapy	3/Weekly 30 Minutes	Group	Greenville Elementary School Classroom/Office (pull-out service)
CURRENT YEAR	No	09/07/2011	06/22/2012	Counseling	1/Weekly 30 Minutes	Group	Greenville Elementary School Classroom/Office (pull-out service)
NEXT YEAR	Yes	09/01/2012	06/30/2013	Integrated Co-Teaching Services	5/Weekly 120 Minutes	Direct	Greenville Elementary School General education classroom
NEXT YEAR	No	09/01/2012	06/30/2013	Counseling	1/Weekly 30 Minutes	Group	Greenville Elementary School Classroom/Office (pull-out service)
NEXT YEAR	No	09/01/2012	06/30/2013	Special Class Reading	5/Weekly 30 Minutes		Greenville Elementary School Special Education Classroom

**Board Action Sheet**  
**Meeting Date: 05/08/2012**  
**Greenville Central School District**

Printed: 06/19/2012 11:18

*Committee : Greenville CSE Sub-Committee*

D	DOB	Gender	Grd	Disability	Meeting	Mtg Date	Ref Date	Outcome	12 Mth
---	-----	--------	-----	------------	---------	----------	----------	---------	--------

NEXT YEAR	No	09/01/2012	06/30/2013	Speech/Language Therapy	3/Weekly 30 Minutes	Group		Greenville Elementary School Classroom/Office (pull-out service)	
-----------	----	------------	------------	-------------------------	------------------------	-------	--	---	--

**Minutes:** Annual review. Change of IEP.

**Total Meetings: 8**

**Board Action Sheet**  
**Meeting Date: 05/17/2012**  
**Greenville Central School District**

Printed: 06/28/2012 9:52

*Committee : Greenville CSE*

ID	DOB	Gender	Grd	Disability	Meeting	Mtg Date	Ref Date	Outcome	12 Mth
----	-----	--------	-----	------------	---------	----------	----------	---------	--------

900000194	04/25/2007	M	PS	Preschool student with a disability   As of 09/01/12: Other health impairm	Transfer Student/Intake	05/17/12		IEP Change: Remains Classified	X
-----------	------------	---	----	---	-------------------------	----------	--	--------------------------------	---

	Primary Service	Start Date	Fut. End Date	Service Description	Freq / Cycle Minutes	Delivery Recommendations	School/ Location	Coordinating Service Provider
NEXT YEAR	Yes	09/01/2012	06/30/2013	Consultant Teacher services direct/indirect	5/Weekly 120 Minutes	Direct	Greenville Elementary School General education classroom	
NEXT YEAR	No	09/01/2012	06/30/2013	Speech/Language Therapy	1/Weekly 30 Minutes	Individual	Greenville Elementary School Push In/Pull out	
NEXT YEAR	No	09/01/2012	06/30/2013	Speech/Language Therapy	2/Weekly 30 Minutes	Group	Greenville Elementary School Push In/Pull out	
NEXT YEAR	No	09/01/2012	06/30/2013	Occupational Therapy	2/Weekly 30 Minutes	Individual	Greenville Elementary School Push In/Pull out	
NEXT YEAR	No	09/01/2012	06/30/2013	Occupational Therapy	1/Weekly 30 Minutes	Group	Greenville Elementary School Push In/Pull out	
NEXT YEAR	No	09/01/2012	06/30/2013	Physical Therapy	2/Weekly 30 Minutes	Group	Greenville Elementary School Push In/Pull out	

**Minutes:** 1:1 aide support. Nursing care plan. Safety plan. Small bus curb to curb.

900000292	07/10/2007	F	UPK	Preschool student with a disability   As of 09/01/12: Autism	Transfer Student/Intake	05/17/12		IEP Change: Remains Classified	X
-----------	------------	---	-----	---	-------------------------	----------	--	--------------------------------	---



**Board Action Sheet**  
**Meeting Date: 05/29/2012**  
**Greenville Central School District**

Printed: 06/28/2012 10:06

*Committee : Greenville MS/HS CSE Sub-Committee*

ID	DOB	Gender	Grd	Disability	Meeting	Mtg Date	Ref Date	Outcome	12.Mth
----	-----	--------	-----	------------	---------	----------	----------	---------	--------

900000563	04/05/1994	F	G12	Learning disability	Annual Review	05/29/12		IEP Change: Remains Classified	
	<b>Primary Service</b>			<b>Fut. End Date Service Description</b>	<b>Freq / Cycle Minutes</b>	<b>Delivery Recommendations</b>	<b>School/ Location</b>		
CURRENT YEAR	Yes	01/03/2012	06/22/2012	Questar III GED program	5/Weekly 150 Minutes	Direct	Columbia Greene Education Ce Questar III		
NEXT YEAR	Yes	09/01/2012	06/30/2013	Questar III GED program	5/Weekly 150 Minutes	Direct	Columbia Greene Education Ce Questar III		

**Minutes:** Annual review. Change of IEP.

010700132	06/30/1994	M	G11	Emotional disturbance	Reevaluation/ Annual	05/29/12		IEP Change: Remains Classified	
	<b>Primary Service</b>			<b>Fut. End Date Service Description</b>	<b>Freq / Cycle Minutes</b>	<b>Delivery Recommendations</b>	<b>School/ Location</b>		
CURRENT YEAR	Yes	09/07/2011	12/14/2011	Counseling	1/Weekly 40 Minutes	Individual	Greenville High School Classroom/Office (pull-out service)		
CURRENT YEAR	No	09/07/2011	12/14/2011	Consultant Teacher services direct/indirect	5/Weekly 40 Minutes	Indirect	Greenville High School in ALP class		

**Minutes:** Annual review. Change of IEP. Student will not be receiving special education services at this time. The student will continue to receive program modifications and testing accommodations.

030700015	07/17/1991	M	G12	Other health impairment	Annual Review	05/29/12		IEP Change: Remains Classified	
	<b>Primary Service</b>			<b>Fut. End Date Service Description</b>	<b>Freq / Cycle Minutes</b>	<b>Delivery Recommendations</b>	<b>School/ Location</b>		

**Board Action Sheet**  
**Meeting Date: 05/29/2012**  
**Greenville Central School District**

Printed: 06/28/2012 10:06

*Committee : Greenville MS/HS CSE Sub-Committee*

D	DOB	Gender	Grd	Disability	Meeting	Mtg Date	Ref Date	Outcome	12 Mth
---	-----	--------	-----	------------	---------	----------	----------	---------	--------

CURRENT YEAR	Yes	09/07/2011	06/22/2012	Questar III GED program	5/Weekly 180 Minutes	Direct		Questar III class in LEA setti Special Education Classroom	
--------------	-----	------------	------------	-------------------------	-------------------------	--------	--	---	--

**Minutes:** Annual review. Student will age out of special education services June 2012.

010300144		12/27/1993	F	G12	Other health impairment			Reevaluation/ Annual	05/29/12		IEP Change: Remains Classified
	<b>Primary Service</b>	<b>Start Date</b>	<b>Fut. End Date</b>	<b>Service Description</b>	<b>Freq / Cycle Minutes</b>	<b>Delivery Recommendations</b>	<b>School/ Location</b>				
CURRENT YEAR	Yes	09/07/2011	06/22/2012	Questar III GED program	5/Weekly 180 Minutes	Direct	Questar III class in LEA setti Questar III				
NEXT YEAR	Yes	09/01/2012	06/30/2013	Resource Room	5/Weekly 40 Minutes		Greenville High School Special Education Classroom				
NEXT YEAR	No	09/01/2012	06/30/2013	Integrated Co-Taught Math	5/Weekly 40 Minutes	Direct	Greenville High School Math class				
NEXT YEAR	No	09/01/2012	06/30/2013	Integrated Co-Taught English	5/Weekly 40 Minutes	Direct	Greenville High School English Classroom				

**Minutes:** Annual review. Change of IEP.

900000141		12/24/1991	F	UGS	Multiple disabilities			Annual Review	05/29/12		IEP Change: Remains Classified
	<b>Primary Service</b>	<b>Start Date</b>	<b>Fut. End Date</b>	<b>Service Description</b>	<b>Freq / Cycle Minutes</b>	<b>Delivery Recommendations</b>	<b>School/ Location</b>				
CURRENT YEAR	Yes	09/07/2011	06/22/2012	ILP class with career studies	5/Weekly 360 Minutes		Questar III class in LEA setti Special Education Classroom				
CURRENT YEAR	No	09/07/2011	06/22/2012	Visually Impaired Service	7/Weekly 30 Minutes	Individual	Questar III class in LEA setti Special Education Classroom				

**Board Action Sheet**  
**Meeting Date: 05/29/2012**  
**Greenville Central School District**

Printed: 06/28/2012 10:06

*Committee : Greenville MS/HS CSE Sub-Committee*

D		DOB	Gender	Grd	Disability	Meeting	Mtg Date	Ref Date	Outcome	12 Mth
NEXT YEAR	Yes	09/01/2012	06/30/2013		Questar III GED program	5/Weekly 150 Minutes	Direct		Questar III class in LEA setti Special Education Classroom	
NEXT YEAR	No	09/01/2012	06/30/2013		Visually Impaired Service	5/Weekly 90 Minutes	Individual		Questar III class in LEA setti Special Education Classroom	

**Minutes:** Annual review. Change of IEP.

**Total Meetings: 6**

**Board Action Sheet**  
**Meeting Date: 06/06/2012**  
**Greenville Central School District**

Printed: 06/28/2012 10:21

*Committee : Greenville CSE*

ID	DOB	Gender	Grd	Disability	Meeting	Mtg Date	Ref Date	Outcome	12 Mth
----	-----	--------	-----	------------	---------	----------	----------	---------	--------

90000636	12/06/2001	F	G03	 As of 09/01/12: Multiple disabilities	New Referral	06/06/12	04/06/12	Initial Placement
----------	------------	---	-----	---	--------------	----------	----------	-------------------

	Primary Service	Start Date	Fut. End Date	Service Description	Freq / Cycle Minutes	Delivery Recommendations	School/ Location
NEXT YEAR	Yes	09/01/2012	06/30/2013	8:1:1 Class	5/Weekly 360 Minutes		Greenville Elementary School Special Education Classroom
NEXT YEAR	No	09/01/2012	06/30/2013	Counseling	1/Weekly 30 Minutes	Individual	Greenville Elementary School Classroom/Office (pull-out service)
NEXT YEAR	No	09/01/2012	06/30/2013	Counseling	1/Weekly 30 Minutes	Group	Greenville Elementary School Classroom/Office (pull-out service)
NEXT YEAR	No	09/01/2012	06/30/2013	Speech/Language Therapy	2/Weekly 30 Minutes	Group	Greenville Elementary School Classroom/Office (pull-out service)

**Minutes:** Student meets the criteria to be identified as a student with a disability.

**Board Action Sheet**  
**Meeting Date: 06/06/2012**  
**Greenville Central School District**

Printed: 06/28/2012 10:21

*Committee : Greenville CSE Sub-Committee*

ID	DOB	Gender	Grd	Disability	Meeting	Mtg Date	Ref Date	Outcome	12 Mth
010700042	04/29/2002	F	UGK	Multiple disabilities	Annual Review	06/06/12		IEP Change: Remains Classified	
	<b>Primary Service</b>	<b>Start Date</b>	<b>Fut. End Date</b>	<b>Service Description</b>	<b>Freq / Cycle Minutes</b>	<b>Delivery Recommendations</b>	<b>School/ Location</b>		
CURRENT YEAR	Yes	09/07/2011	06/22/2012	6:1:1 class	5/Weekly 360 Minutes		Greenville Elementary School Special Education Classroom		
CURRENT YEAR	No	09/07/2011	06/22/2012	Occupational Therapy	1/Weekly 30 Minutes	Individual	Greenville Elementary School Classroom/Office (pull-out service)		
CURRENT YEAR	No	09/07/2011	06/22/2012	Occupational Therapy	2/Weekly 30 Minutes	Group	Greenville Elementary School Special Education Classroom		
CURRENT YEAR	No	09/07/2011	06/22/2012	Physical Therapy	1/Weekly 30 Minutes	Group	Greenville Elementary School Special Education Classroom		
CURRENT YEAR	No	09/07/2011	06/22/2012	Physical Therapy	1/Weekly 30 Minutes	Individual	Greenville Elementary School Classroom/Office (pull-out service)		
CURRENT YEAR	No	09/07/2011	06/22/2012	Adapted Physical Education	3/Weekly 40 Minutes	6 STUDENTS/1 TEACHER/1 AIDE	Greenville Elementary School Push into Physical Education		
CURRENT YEAR	No	09/07/2011	06/22/2012	Counseling	1/Weekly 30 Minutes	Group	Greenville Elementary School Classroom/Office (pull-out service)		
CURRENT YEAR	No	09/07/2011	06/22/2012	Speech/Language Therapy	2/Weekly 30 Minutes	Individual	Greenville Elementary School Classroom/Office (pull-out service)		
CURRENT YEAR	No	09/07/2011	06/22/2012	Speech/Language Therapy	3/Weekly 30 Minutes	Group	Greenville Elementary School Special Education Classroom		
NEXT YEAR	Yes	07/02/2012	08/10/2012	Speech/Language Therapy	2/Weekly 30 Minutes	Individual	Questar III class in LEA setti Classroom/Office (pull-out service)		
NEXT YEAR	No	07/02/2012	08/10/2012	8:1:2 CLASS	5/Weekly 360 Minutes		Questar III class in LEA setti Special Education Classroom		
NEXT YEAR	No	07/02/2012	08/10/2012	Occupational Therapy	1/Weekly 30 Minutes	Individual	Questar III class in LEA setti Classroom/Office (pull-out service)		
NEXT YEAR	No	07/02/2012	08/10/2012	Speech/Language Therapy	1/Weekly 30 Minutes	Group	Questar III class in LEA setti Classroom/Office (pull-out service)		

**Board Action Sheet**  
**Meeting Date: 06/06/2012**  
**Greenville Central School District**

Printed: 06/28/2012 10:21

*Committee : Greenville CSE Sub-Committee*

D		DOB	Gender	Grd	Disability	Meeting	Mtg Date	Ref Date	Outcome	12 Mth
NEXT YEAR	No	07/02/2012	08/10/2012		Occupational Therapy	1/Weekly 30 Minutes	Group		Questar III class in LEA setti Classroom/Office (pull-out service)	
NEXT YEAR	Yes	09/01/2012	06/30/2013		Consultant Teacher services direct/indirect	1/Weekly 120 Minutes	Direct		Greenville Elementary School General education classroom	
NEXT YEAR	No	09/01/2012	06/30/2013		Occupational Therapy	2/Weekly 30 Minutes	Group		Greenville Elementary School Classroom/Office (pull-out service)	
NEXT YEAR	No	09/01/2012	06/30/2013		Consultant Teacher Direct	5/Weekly 30 Minutes	Direct		Greenville Elementary School English Classroom	
NEXT YEAR	No	09/01/2012	06/30/2013		Adapted Physical Education	3/Weekly 40 Minutes			Greenville Elementary School General education classroom	
NEXT YEAR	No	09/01/2012	06/30/2013		Speech/Language Therapy	3/Weekly 30 Minutes	Individual		Greenville Elementary School Push In/Pull out	
NEXT YEAR	No	09/01/2012	06/30/2013		Speech/Language Therapy	2/Weekly 30 Minutes	Group		Greenville Elementary School Push In/Pull out	
NEXT YEAR	No	09/01/2012	06/30/2013		Consultant Teacher Direct	5/Weekly 30 Minutes	Direct		Greenville Elementary School Math class	
NEXT YEAR	No	09/01/2012	06/30/2013		Physical Therapy	1/Weekly 30 Minutes	Individual		Greenville Elementary School Push In/Pull out	
NEXT YEAR	No	09/01/2012	06/30/2013		Occupational Therapy	1/Weekly 30 Minutes	Individual		Greenville Elementary School Classroom/Office (pull-out service)	
NEXT YEAR	No	09/01/2012	06/30/2013		Physical Therapy	1/Weekly 30 Minutes	Group		Greenville Elementary School Push In/Pull out	
NEXT YEAR	No	09/01/2012	06/30/2013		Counseling	1/Weekly 30 Minutes	Individual		Greenville Elementary School Classroom/Office (pull-out service)	
NEXT YEAR	No	09/01/2012	06/30/2013		Counseling	1/Weekly 30 Minutes	Group		Greenville Elementary School Classroom/Office (pull-out service)	

**Minutes:** Annual review. Change of IEP.



**Board Action Sheet**  
**Meeting Date: 06/06/2012**  
**Greenville Central School District**

Printed: 06/28/2012 10:21

*Committee : Greenville MS/HS CSE Sub-Committee*

D	DOB	Gender	Grd	Disability	Meeting	Mtg Date	Ref Date	Outcome	12 Mth
---	-----	--------	-----	------------	---------	----------	----------	---------	--------

900000634	07/22/1997	M	G09	Learning disability	Transfer Student/Intake Annual Review	06/06/12 06/06/12		IEP Change: Remains Classified IEP Change: Remains Classified	
-----------	------------	---	-----	---------------------	---	----------------------	--	--	--

	Primary Service	Start Date	Fut. End Date	Service Description	Freq / Cycle Minutes	Delivery Recommendations	School/ Location
CURRENT YEAR	Yes	06/06/2012	06/22/2012	12:1:1 class	5/Weekly 40 Minutes		Greenville High School Special Education Classroom
CURRENT YEAR	No	06/06/2012	06/22/2012	Resource Room	5/Weekly 40 Minutes		Greenville High School Special Education Classroom
CURRENT YEAR	No	06/06/2012	06/22/2012	Integrated Co-Taught Math	5/Weekly 40 Minutes	Direct	Greenville High School Math class
CURRENT YEAR	No	06/06/2012	06/22/2012	Integrated Co-Taught English	5/Weekly 40 Minutes	Direct	Greenville High School English Classroom
NEXT YEAR	Yes	09/01/2012	06/30/2013	12:1:1 class	5/Weekly 40 Minutes		Greenville High School Special Education Classroom
NEXT YEAR	No	09/01/2012	06/30/2013	Integrated Co-Taught Math	5/Weekly 40 Minutes	Direct	Greenville High School Math class
NEXT YEAR	No	09/01/2012	06/30/2013	Resource Room	5/Weekly 40 Minutes		Greenville High School Special Education Classroom
NEXT YEAR	No	09/01/2012	06/30/2013	Integrated Co-Taught English	5/Weekly 40 Minutes	Direct	Greenville High School English Classroom

**Minutes:** Student entered GCS having been previously identified as a student with a disability.

900000207	07/12/1995	M	G10	Learning disability	Annual Review	06/06/12		IEP Change: Remains Classified	
-----------	------------	---	-----	---------------------	---------------	----------	--	--------------------------------	--

	Primary Service	Start Date	Fut. End Date	Service Description	Freq / Cycle Minutes	Delivery Recommendations	School/ Location
--	-----------------	------------	---------------	---------------------	----------------------	--------------------------	------------------

Board Action Sheet  
Meeting Date: 06/06/2012  
Greenville Central School District

Printed: 06/28/2012 10:21

Committee : Greenville MS/HS CSE Sub-Committee

ID	DOB	Gender	Grd	Disability	Meeting	Mtg Date	Ref Date	Outcome	12 Mth
----	-----	--------	-----	------------	---------	----------	----------	---------	--------

**Minutes:** Student's meeting was held. Recommendations were made that the student would be transferring to a program that is not in this district and is not this district's CSE responsibility.

Total Meetings: 6

**Board Action Sheet**  
**Meeting Date: 06/07/2012**  
**Greenville Central School District**

Printed: 06/28/2012 11:40

*Committee : Greenville MS/HS CSE Sub-Committee*

ID	DOB	Gender	Grd	Disability	Meeting	Mtg Date	Ref Date	Outcome	12 Mth
----	-----	--------	-----	------------	---------	----------	----------	---------	--------

90000061	11/19/1992	F	UGS	Multiple disabilities	Reevaluation/ Annual	06/07/12		IEP Change: Remains Classified	X
----------	------------	---	-----	-----------------------	-------------------------	----------	--	--------------------------------	---

	Primary Service	Start Date	Fut. End Date End Date	Service Description	Freq / Cycle Minutes	Delivery Recommendations	School/ Location
CURRENT YEAR	Yes	09/07/2011	06/22/2012	12:1:1 class	5/Weekly 180 Minutes		Greenville High School Special Education Classroom
CURRENT YEAR	No	09/07/2011	06/22/2012	Speech/Language Therapy	1/Weekly 40 Minutes	Group	Greenville High School Classroom/Office (pull-out service)
CURRENT YEAR	No	09/07/2011	06/22/2012	Speech/Language Therapy	1/Weekly 40 Minutes	Individual	Greenville High School Classroom/Office (pull-out service)
CURRENT YEAR	No	09/07/2011	06/22/2012	Physical Therapy	1/Weekly 30 Minutes	Individual	Greenville High School Classroom/Office (pull-out service)
CURRENT YEAR	No	09/07/2011	06/22/2012	Physical Therapy	1/Weekly 30 Minutes	Group	Greenville High School Classroom/Office (pull-out service)
NEXT YEAR	Yes	07/01/2012	08/10/2012	8:1:2 CLASS	5/Weekly 360 Minutes		Questar III class in LEA setti Special Education Classroom
NEXT YEAR	No	07/01/2012	08/10/2012	Physical Therapy	2/Weekly 30 Minutes	Group	Questar III class in LEA setti Classroom/Office (pull-out service)
NEXT YEAR	Yes	09/01/2012	06/30/2013	ARC - School to Work	5/Weekly 360 Minutes		Ulster Greene ARC all settings

**Minutes:** Annual review. Change of IEP.

010800703	04/09/1993	M	UGS	Multiple disabilities	Annual Review	06/07/12		IEP Change: Remains Classified
-----------	------------	---	-----	-----------------------	---------------	----------	--	--------------------------------

	Primary Service	Start Date	Fut. End Date End Date	Service Description	Freq / Cycle Minutes	Delivery Recommendations	School/ Location
CURRENT YEAR	Yes	09/07/2011	06/22/2012	Career Studies	5/Weekly 360 Minutes		Questar III class in LEA setti all settings

**Board Action Sheet**  
**Meeting Date: 06/07/2012**  
**Greenville Central School District**

Printed: 06/28/2012 11:40

*Committee : Greenville MS/HS CSE Sub-Committee*

D	DOB	Gender	Grd	Disability	Meeting	Mtg Date	Ref Date	Outcome	12 Mth
NEXT YEAR	Yes	09/01/2012	06/30/2013	ARC - School to Work	5/Weekly 120 Minutes			Ulster Greene ARC all settings	
NEXT YEAR	No	09/01/2012	06/30/2013	Career Studies	5/Weekly 120 Minutes			Questar III class in LEA setti Special Education Classroom	

**Minutes:** Annual review. Change of IEP.

**Total Meetings: 5**

**Board Action Sheet**  
**Meeting Date: 06/12/2012**  
**Greenville Central School District**

Printed: 06/28/2012 10:23

*Committee : Greenville CSE*

ID	DOB	Gender	Grd	Disability	Meeting	Mtg Date	Ref Date	Outcome	12 Mth
----	-----	--------	-----	------------	---------	----------	----------	---------	--------

000010110	07/17/2006	M	KFD	Non-disabled   As of 09/01/12: Speech or language impairment	New Referral	06/12/12	05/03/12	Initial Placement
-----------	------------	---	-----	--	--------------	----------	----------	-------------------

	Primary Service	Start Date	Fut. End Date	Service Description	Freq / Cycle Minutes	Delivery Recommendations	School/ Location
NEXT YEAR	Yes	09/01/2012	06/30/2013	Special Class Reading	5/Weekly 30 Minutes		Greenville Elementary School Special Education Classroom
NEXT YEAR	No	09/01/2012	06/30/2013	Consultant Teacher Direct	5/Weekly 60 Minutes	Direct	Greenville Elementary School English Classroom
NEXT YEAR	No	09/01/2012	06/30/2013	Speech/Language Therapy	2/Weekly 30 Minutes	Group	Greenville Elementary School Classroom/Office (pull-out service)

**Minutes:** Student meets the criteria to be identified as a student with a disability.

**Board Action Sheet**  
**Meeting Date: 06/12/2012**  
**Greenville Central School District**

Printed: 06/28/2012 10:23

*Committee : Greenville CSE Sub-Committee*

ID	DOB	Gender	Grd	Disability	Meeting	Mtg Date	Ref Date	Outcome	12 Mth
000010939	10/10/2003	M	G03	Learning disability	Annual Review	06/12/12		IEP Change: Remains Classified	
	<b>Primary Service</b>	<b>Start Date</b>	<b>Fut. End Date</b>	<b>Service Description</b>	<b>Freq / Cycle Minutes</b>	<b>Delivery Recommendations</b>	<b>School/ Location</b>		
CURRENT YEAR	Yes	09/07/2011	06/22/2012	Special Class Reading	5/Weekly 45 Minutes		Greenville Elementary School Special Education Classroom		
CURRENT YEAR	No	09/07/2011	06/22/2012	Integrated Co-Teaching Services	5/Weekly 120 Minutes	Direct	Greenville Elementary School Math and English Classes		
CURRENT YEAR	No	09/07/2011	06/22/2012	Speech/Language Therapy	2/Weekly 30 Minutes	Group	Greenville Elementary School Classroom/Office (pull-out service)		
CURRENT YEAR	No	09/07/2011	06/22/2012	Occupational Therapy	2/Weekly 30 Minutes	Group	Greenville Elementary School Classroom/Office (pull-out service)		
NEXT YEAR	Yes	09/01/2012	06/30/2013	Special Class Reading	5/Weekly 45 Minutes		Greenville Elementary School Special Education Classroom		
NEXT YEAR	No	09/01/2012	06/30/2013	Physical Therapy	2/Weekly 30 Minutes	Group	Greenville Elementary School Classroom/Office (pull-out service)		
NEXT YEAR	No	09/01/2012	06/30/2013	Counseling	1/Weekly 30 Minutes	Group	Greenville Elementary School Classroom/Office (pull-out service)		
NEXT YEAR	No	09/01/2012	06/30/2013	Consultant Teacher Direct	5/Weekly 60 Minutes	Direct	Greenville Elementary School Math and English Classes		
NEXT YEAR	No	09/01/2012	06/30/2013	Resource Room	5/Weekly 45 Minutes		Greenville Elementary School Special Education Classroom		
NEXT YEAR	No	09/01/2012	06/30/2013	Occupational Therapy	2/Weekly 30 Minutes	Group	Greenville Elementary School Classroom/Office (pull-out service)		

**Minutes:** Annual review. Change of IEP.



**Board Action Sheet**  
**Meeting Date: 06/12/2012**  
**Greenville Central School District**

Printed: 06/28/2012 10:23

*Committee : Greenville MS/HS CSE Sub-Committee*

D	DOB	Gender	Grd	Disability	Meeting	Mtg Date	Ref Date	Outcome	12 Mth
---	-----	--------	-----	------------	---------	----------	----------	---------	--------

010500015	10/27/1998	M	G07	 As of 09/01/12: Learning disability	New Referral	06/12/12	01/13/12	Initial Placement	
-----------	------------	---	-----	---	--------------	----------	----------	-------------------	--

	Primary Service	Start Date	Fut. End Date	End Date	Service Description	Freq / Cycle Minutes	Delivery Recommendations	School/ Location
NEXT YEAR	Yes	09/01/2012	06/30/2013	06/30/2013	Resource Room	3/6 Day Cycle 40 Minutes		Greenville Middle School Special Education Classroom
NEXT YEAR	No	09/01/2012	06/30/2013	06/30/2013	Integrated Co-Taught English	5/Weekly 40 Minutes	Direct	Greenville Middle School English Classroom

**Minutes:** Student meets the criteria to be identified as a student with a disability.

010801027	10/03/1997	M	G08	Speech or language impairment	Program Review	06/12/12		IEP Change: Remains Classified	
-----------	------------	---	-----	-------------------------------------	----------------	----------	--	-----------------------------------	--

	Primary Service	Start Date	Fut. End Date	End Date	Service Description	Freq / Cycle Minutes	Delivery Recommendations	School/ Location
CURRENT YEAR	Yes	09/07/2011	06/22/2012	06/22/2012	Integrated Co-Taught English	5/Weekly 40 Minutes	Direct	Greenville Middle School English Classroom
CURRENT YEAR	No	09/07/2011	06/22/2012	06/22/2012	Resource Room	5/Weekly 40 Minutes		Greenville Middle School Resource Room
CURRENT YEAR	No	09/07/2011	06/22/2012	06/22/2012	Counseling	1/Weekly 20 Minutes	Individual	Greenville Middle School Classroom/Office (pull-out service)
NEXT YEAR	Yes	09/01/2012	06/30/2013	06/30/2013	Resource Room	3/6 Day Cycle 40 Minutes		TECH Valley High School Resource Room
NEXT YEAR	No	09/01/2012	06/30/2013	06/30/2013	Counseling	1/Weekly 30 Minutes	Group	TECH Valley High School Classroom/Office (pull-out service)

**Board Action Sheet**  
**Meeting Date: 06/12/2012**  
**Greenville Central School District**

Printed: 06/28/2012 10:23

*Committee : Greenville MS/HS CSE Sub-Committee*

ID	DOB	Gender	Grd	Disability	Meeting	Mtg Date	Ref Date	Outcome	12 Mth
----	-----	--------	-----	------------	---------	----------	----------	---------	--------

NEXT YEAR	No	09/01/2012	06/30/2013	Consultant Teacher services direct/indirect	5/Weekly 40 Minutes	Direct		TECH Valley High School English Classroom	
-----------	----	------------	------------	--	------------------------	--------	--	--	--

**Minutes:** Program review. Change of program for 2012-13.

**Total Meetings: 5**

**Board Action Sheet**  
**Meeting Date: 06/19/2012**  
**Greenville Central School District**

Printed: 06/28/2012 10:25

*Committee : Greenville CSE*

ID	DOB	Gender	Grd	Disability	Meeting	Mtg Date	Ref Date	Outcome	12 Mth
----	-----	--------	-----	------------	---------	----------	----------	---------	--------

000010937	05/28/2004	F	G02	 As of 09/01/12: Learning disability	New Referral	06/19/12	05/03/12	Initial Placement
-----------	------------	---	-----	---	--------------	----------	----------	-------------------

	Primary Service	Start Date	Fut. End Date	Service Description	Freq / Cycle Minutes	Delivery Recommendations	School/ Location
NEXT YEAR	Yes	09/01/2012	06/30/2013	Special Class Reading	5/Weekly 30 Minutes		Greenville Elementary School Special Education Classroom
NEXT YEAR	No	09/01/2012	06/30/2013	Consultant Teacher Direct	5/Weekly 60 Minutes	Direct	Greenville Elementary School English Classroom

**Minutes:** Student meets the criteria to be identified as a student with a disability.

900000363	06/14/2001	M	G04	 As of 09/01/12: Learning disability	New Referral	06/19/12	04/02/12	Initial Placement
-----------	------------	---	-----	---	--------------	----------	----------	-------------------

	Primary Service	Start Date	Fut. End Date	Service Description	Freq / Cycle Minutes	Delivery Recommendations	School/ Location
NEXT YEAR	Yes	09/01/2012	06/30/2013	Resource Room	5/Weekly 45 Minutes		Greenville Elementary School Special Education Classroom
NEXT YEAR	No	09/01/2012	06/30/2013	Consultant Teacher services direct/indirect	5/Weekly 30 Minutes	Direct	Greenville Elementary School English Classroom
NEXT YEAR	No	09/01/2012	06/30/2013	Special Class Reading	5/Weekly 45 Minutes		Greenville Elementary School Special Education Classroom

**Minutes:** Student meets the criteria to be identified as a student with a disability.



**Board Action Sheet**  
**Meeting Date: 06/21/2012**  
**Greenville Central School District**

Printed: 06/28/2012 10:16

*Committee : Greenville CSE Sub-Committee*

D	DOB	Gender	Grd	Disability	Meeting	Mtg Date	Ref Date	Outcome	12 Mth
000010053	06/22/2005	F	G01	Emotional disturbance	Reevaluation/ Annual	06/21/12		IEP Change: Remains Classified	X
	<b>Primary Service</b>	<b>Start Date</b>	<b>Fut. End Date</b>	<b>Service Description</b>	<b>Freq / Cycle Minutes</b>	<b>Delivery Recommendations</b>	<b>School/ Location</b>		
CURRENT YEAR	Yes	09/07/2011	06/22/2012	Counseling	1/Weekly 30 Minutes	Group	Greenville Elementary School Classroom/Office (pull-out service)		
CURRENT YEAR	No	09/07/2011	06/22/2012	Occupational Therapy	2/Weekly 30 Minutes	Group	Greenville Elementary School Classroom/Office (pull-out service)		
CURRENT YEAR	No	12/01/2011	06/22/2012	8:1:1 Class	5/Weekly 360 Minutes		Greenville Elementary School Special Education Classroom		
CURRENT YEAR	No	12/01/2011	06/22/2012	Counseling	1/Weekly 30 Minutes	Individual	Greenville Elementary School Classroom/Office (pull-out service)		
NEXT YEAR	Yes	07/02/2012	08/10/2012	Questar III Extended Year Summer Program	5/Weekly 360 Minutes	8 STUDENTS/1 TEACHER/1 AIDE	Questar III class in LEA setti Questar III		
NEXT YEAR	Yes	09/05/2012	06/21/2013	Day Treatment Program	5/Weekly 360 Minutes	8 STUDENTS/1 TEACHER/1 AIDE	Parson's Day Treatment Special Education Classroom		
NEXT YEAR	No	09/05/2012	06/21/2013	Occupational Therapy	1/Weekly 30 Minutes	Group	Parson's Day Treatment Push In/Pull out		

**Total Meetings: 1**

**Board Action Sheet**  
**Meeting Date: 05/04/2012**  
**Greenville Central School District**

Printed: 06/20/2012 9:39

*Committee : Greenville CPSE*

ID	DOB	Gender	Grd	Disability	Meeting	Mtg Date	Ref Date	Outcome	12 Mth
900000404	01/24/2007	M	PRK	Preschool student with a disability   As of 06/23/12: Declassified	Annual Review	05/04/12		IEP Change: Declassified	
	<b>Primary Service</b>	<b>Start Date</b>	<b>Fut. End Date</b>	<b>Service Description</b>	<b>Freq / Cycle</b>	<b>Delivery</b>	<b>School/ Location</b>	<b>Coordinating Service Provider</b>	
CURRENT YEAR	Yes	09/07/2011	06/22/2012	Speech/Language Therapy	2/Weekly 30 Minutes	Individual	Greene County Head Start Push In/Pull out	EARLY CHILDHD LNG CT GREENE CO	
900000283	03/15/2007	M	PRK	Preschool student with a disability	Annual Review	05/04/12		IEP Change: Remains Classified	X
	<b>Primary Service</b>	<b>Start Date</b>	<b>Fut. End Date</b>	<b>Service Description</b>	<b>Freq / Cycle</b>	<b>Delivery</b>	<b>School/ Location</b>	<b>Coordinating Service Provider</b>	
CURRENT YEAR	Yes	09/07/2011	06/22/2012	5 hour self contained class	5/Weekly 300 Minutes	5 hour self contained class	COARC Starting Place in classroom	COARC	
CURRENT YEAR	No	09/07/2011	06/22/2012	Occupational Therapy	2/Weekly 30 Minutes	Individual	COARC Starting Place in classroom	COARC	
CURRENT YEAR	No	09/07/2011	06/22/2012	Counseling	1/Weekly 30 Minutes	Group	COARC Starting Place Classroom/Office (pull-out service)	COARC	
CURRENT YEAR	No	09/07/2011	06/22/2012	Speech/Language Therapy	3/Weekly 30 Minutes	Individual	COARC Starting Place in classroom	COARC	
CURRENT YEAR	No	09/07/2011	06/22/2012	Counseling	1/Weekly 30 Minutes	Individual	COARC Starting Place in classroom	COARC	
CURRENT YEAR	No	09/07/2011	06/22/2012	Physical Therapy	2/Weekly 30 Minutes	Individual	COARC Starting Place in classroom	COARC	

**Board Action Sheet**  
**Meeting Date: 05/04/2012**  
**Greenville Central School District**

Printed: 06/20/2012 9:39

*Committee : Greenville CPSE*

ID	DOB	Gender	Grd	Disability	Meeting	Mtg Date	Ref Date	Outcome	12 Mth
NEXT YEAR	Yes	07/02/2012	08/30/2012	Speech/Language Therapy	2/Weekly 30 Minutes	Individual	Home Home Based	COUNTY OF GREENE	

**Minutes:** The student will receive Summer services as a preschooler with a disability. The student will be declassified at the end of Summer 2012.

ID	DOB	Gender	Grd	Disability	Meeting	Mtg Date	Ref Date	Outcome	12 Mth
900000169	12/07/2006	M	PRK	Preschool student with a disability	Annual Review	05/04/12		IEP Change: Remains Classified	X
	<b>Primary Service</b>	<b>Start Date</b>	<b>Fut. End Date</b>	<b>Service Description</b>	<b>Freq / Cycle Minutes</b>	<b>Delivery Recommendations</b>	<b>School/ Location</b>	<b>Coordinating Service Provider</b>	
CURRENT YEAR	Yes	09/07/2011	06/22/2012	2.5 Hour Integrated Preschool Program Class	5/Weekly 150 Minutes	8 STUDENTS/1 TEACHER/1 AIDE	Country Acres in classroom	FAMILY & EDUCATIONAL CONSULTANTS	
CURRENT YEAR	No	09/07/2011	06/22/2012	Speech/Language Therapy	3/Weekly 30 Minutes	Individual	Country Acres Push-in services	FAMILY & EDUCATIONAL CONSULTANTS	
CURRENT YEAR	No	09/07/2011	06/22/2012	Occupational Therapy	2/Weekly 30 Minutes	Individual	Country Acres Push-in services	FAMILY & EDUCATIONAL CONSULTANTS	
CURRENT YEAR	No	09/07/2011	06/22/2012	Physical Therapy	2/Weekly 30 Minutes	Individual	Country Acres Push-in services	FAMILY & EDUCATIONAL CONSULTANTS	
NEXT YEAR	Yes	07/02/2012	08/10/2012	2.5 Hour Integrated Preschool Program Class	5/Weekly 150 Minutes	8 STUDENTS/1 TEACHER/1 AIDE	Country Acres in classroom	FAMILY & EDUCATIONAL CONSULTANTS	
NEXT YEAR	No	07/02/2012	08/10/2012	Occupational Therapy	2/Weekly 30 Minutes	Individual	Country Acres Push-in services	FAMILY & EDUCATIONAL CONSULTANTS	
NEXT YEAR	No	07/02/2012	08/10/2012	Physical Therapy	2/Weekly 30 Minutes	Individual	Country Acres Push-in services	FAMILY & EDUCATIONAL CONSULTANTS	
NEXT YEAR	No	07/02/2012	08/10/2012	Speech/Language Therapy	3/Weekly 30 Minutes	Individual	Country Acres Push-in services	FAMILY & EDUCATIONAL CONSULTANTS	
NEXT YEAR	Yes	09/01/2012	06/30/2013	Consultant Teacher Direct	5/Weekly 60 Minutes	Direct	Greenville Elementary School English Classroom		
NEXT YEAR	No	09/01/2012	06/30/2013	Speech/Language Therapy	1/Weekly 30 Minutes	Individual	Greenville Elementary School Push In/Pull out		

**Board Action Sheet**  
**Meeting Date: 05/04/2012**  
**Greenville Central School District**

Printed: 06/20/2012 9:39

*Committee : Greenville CPSE*

ID	DOB	Gender	Grd	Disability	Meeting	Mtg Date	Ref Date	Outcome	12 Mth
NEXT YEAR	No	09/01/2012	06/30/2013	Speech/Language Therapy	2/Weekly 30 Minutes	Group		Greenville Elementary School Push In/Pull out	
NEXT YEAR	No	09/01/2012	06/30/2013	Consultant Teacher Direct	5/Weekly 60 Minutes	Direct		Greenville Elementary School Math class	
NEXT YEAR	No	09/01/2012	06/30/2013	Occupational Therapy	2/Weekly 30 Minutes	Group		Greenville Elementary School Push In/Pull out	
NEXT YEAR	No	09/01/2012	06/30/2013	Physical Therapy	1/Weekly 30 Minutes	Group		Greenville Elementary School Push In/Pull out	

**Minutes:** The student will be classified as a preschooler with a disability for the summer 2012.

900000421	09/11/2008	M	PRK	Preschool student with a disability		Annual Review	05/04/12	IEP Change: Remains Classified	X
	<b>Primary Service</b>	<b>Start Date</b>	<b>Fut. End Date</b>	<b>Service Description</b>	<b>Freq / Cycle</b>	<b>Delivery</b>	<b>School/ Location</b>	<b>Coordinating Service Provider</b>	
CURRENT YEAR	Yes	01/02/2012	06/22/2012	Speech/Language Therapy	3/Weekly 30 Minutes	Individual	Home Home Based	EARLY CHILDHOOD LEARNING	
NEXT YEAR	Yes	07/02/2012	08/15/2012	Speech/Language Therapy	3/Weekly 30 Minutes	Individual	Home Home Based	EARLY CHILDHOOD LEARNING	
NEXT YEAR	Yes	09/01/2012	06/30/2013	Speech/Language Therapy	3/Weekly 30 Minutes	Individual	Home Home Based	EARLY CHILDHOOD LEARNING	

900000479	08/02/2008	M		Preschool student with a disability		Annual Review	05/04/12	IEP Change: Remains Classified	X
	<b>Primary Service</b>	<b>Start Date</b>	<b>Fut. End Date</b>	<b>Service Description</b>	<b>Freq / Cycle</b>	<b>Delivery</b>	<b>School/ Location</b>	<b>Coordinating Service Provider</b>	
CURRENT YEAR	Yes	09/07/2011	10/14/2011	Counseling	1/Weekly 30 Minutes	Individual	Greene County Head Start in classroom	COUNTY OF GREENE	

**Board Action Sheet**  
**Meeting Date: 05/04/2012**  
**Greenville Central School District**

Printed: 06/20/2012 9:39

*Committee : Greenville CPSE*

ID		DOB	Gender	Grd	Disability	Meeting	Mtg Date	Ref Date	Outcome	12 Mth
CURRENT YEAR	No	09/07/2011	10/14/2011	Occupational Therapy	2/Weekly 30 Minutes	Individual		Greene County Head Start in classroom	COUNTY OF GREENE	
CURRENT YEAR	No	09/07/2011	10/14/2011	Special Education Itinerant Teacher	2/Weekly 60 Minutes	Direct		Greene County Head Start in classroom	EARLY CHILDHOOD LEARNING	
CURRENT YEAR	Yes	10/17/2011	06/22/2012	5 hour Integrated Class 5:1:1	5/Weekly 300 Minutes			Greene County Head Start Special Education Classroom	EARLY CHLDHHD LNG CT GREENE CO	
CURRENT YEAR	No	10/17/2011	06/22/2012	Occupational Therapy	2/Weekly 30 Minutes	Individual		Greene County Head Start Push In/Pull out	EARLY CHLDHHD LNG CT GREENE CO	
CURRENT YEAR	No	10/17/2011	06/22/2012	Counseling	1/Weekly 30 Minutes	Individual		Greene County Head Start Push In/Pull out	EARLY CHLDHHD LNG CT GREENE CO	
CURRENT YEAR	No	12/23/2011	06/22/2012	Speech/Language Therapy	3/Weekly 30 Minutes	Individual		Greene County Head Start Push In/Pull out	EARLY CHLDHHD LNG CT GREENE CO	
NEXT YEAR	Yes	07/09/2012	08/17/2012	5 hour Integrated Class 5:1:1	5/Weekly 300 Minutes			Greene County Head Start Special Education Classroom	EARLY CHLDHHD LNG CT GREENE CO	
NEXT YEAR	No	07/09/2012	08/17/2012	Counseling	1/Weekly 30 Minutes	Individual		Greene County Head Start Push In/Pull out	EARLY CHLDHHD LNG CT GREENE CO	
NEXT YEAR	No	07/09/2012	08/17/2012	Speech/Language Therapy	3/Weekly 30 Minutes	Individual		Greene County Head Start Push In/Pull out	EARLY CHLDHHD LNG CT GREENE CO	
NEXT YEAR	Yes	09/01/2012	06/30/2013	5 hour Integrated Class 5:1:1	5/Weekly 300 Minutes			Greene County Head Start Special Education Classroom	EARLY CHLDHHD LNG CT GREENE CO	
NEXT YEAR	No	09/01/2012	06/30/2013	Counseling	1/Weekly 30 Minutes	Individual		Greene County Head Start Push In/Pull out	EARLY CHLDHHD LNG CT GREENE CO	
NEXT YEAR	No	09/01/2012	06/30/2013	Speech/Language Therapy	3/Weekly 30 Minutes	Individual		Greene County Head Start Push In/Pull out	EARLY CHLDHHD LNG CT GREENE CO	

**Minutes:** Annual Review. ESY recommended. Change IEP.

**Board Action Sheet**  
**Meeting Date: 05/10/2012**  
**Greenville Central School District**

Printed: 06/19/2012 11:08

Committee : Greenville CPSE

ID	DOB	Gender	Grd	Disability	Meeting	Mtg Date	Ref Date	Outcome	12 Mth
900000366	01/04/2008	M	PRK	Preschool student with a disability	Annual Review	05/10/12		IEP Change: Remains Classified	
	<b>Primary Service</b>	<b>Start Date</b>	<b>Fut. End Date</b>	<b>Service Description</b>	<b>Freq / Cycle Minutes</b>	<b>Delivery Recommendations</b>	<b>School/ Location</b>	<b>Coordinating Service Provider</b>	
CURRENT YEAR	Yes	09/07/2011	06/22/2012	4.5 Hour Self Contained class	5/Weekly 270 Minutes	4.5 hour self contained	Early Childhood Education Cent in classroom	EARLY CHILDHOOD EDUC CTR	
CURRENT YEAR	No	09/07/2011	06/22/2012	Occupational Therapy	3/Weekly 30 Minutes	Individual	Early Childhood Education Cent in classroom	EARLY CHILDHOOD EDUC CTR	
CURRENT YEAR	No	09/07/2011	06/22/2012	Speech/Language Therapy	3/Weekly 30 Minutes	Individual	Early Childhood Education Cent in classroom	EARLY CHILDHOOD EDUC CTR	
CURRENT YEAR	No	09/07/2011	06/22/2012	Speech/Language Therapy	2/Weekly 30 Minutes	Group	Early Childhood Education Cent in classroom	EARLY CHILDHOOD EDUC CTR	
NEXT YEAR	Yes	07/09/2012	08/17/2012	4.5 Hour Self Contained class	5/Weekly 270 Minutes	4.5 hour self contained	Early Childhood Education Cent in classroom	EARLY CHILDHOOD EDUC CTR	
NEXT YEAR	No	07/09/2012	08/17/2012	Occupational Therapy	2/Weekly 30 Minutes	Individual	Early Childhood Education Cent in classroom	EARLY CHILDHOOD EDUC CTR	
NEXT YEAR	No	07/09/2012	08/17/2012	Speech/Language Therapy	3/Weekly 30 Minutes	Individual	Early Childhood Education Cent in classroom	EARLY CHILDHOOD EDUC CTR	
NEXT YEAR	No	07/09/2012	08/17/2012	Speech/Language Therapy	2/Weekly 30 Minutes	Group	Early Childhood Education Cent in classroom	EARLY CHILDHOOD EDUC CTR	
NEXT YEAR	Yes	09/04/2012	06/21/2013	4.5 Hour Self Contained class	5/Weekly 270 Minutes	4.5 hour self contained	Early Childhood Education Cent in classroom	EARLY CHILDHOOD EDUC CTR	
NEXT YEAR	No	09/04/2012	06/21/2013	Occupational Therapy	3/Weekly 30 Minutes	Individual	Early Childhood Education Cent in classroom	EARLY CHILDHOOD EDUC CTR	
NEXT YEAR	No	09/04/2012	06/21/2013	Speech/Language Therapy	3/Weekly 30 Minutes	Individual	Early Childhood Education Cent in classroom	EARLY CHILDHOOD EDUC CTR	
NEXT YEAR	No	09/04/2012	06/21/2013	Speech/Language Therapy	2/Weekly 30 Minutes	Group	Early Childhood Education Cent in classroom	EARLY CHILDHOOD EDUC CTR	



Board Action Sheet  
 Meeting Date: 05/10/2012  
 Greenville Central School District

Printed: 06/19/2012 11:08

Committee : Greenville CPSE

D	DOB	Gender	Grd	Disability	Meeting	Mtg Date	Ref Date	Outcome	12 Mth
NEXT YEAR	No	09/01/2012	06/30/2013	Occupational Therapy	1/Weekly 30 Minutes	Individual	Home	Home/Parent Paid Preschool	COUNTY OF ALBANY

**Minutes:** The student will receive a follow up speech evaluation through CPSE.

**Total Meetings: 3**

**Board Action Sheet**  
**Meeting Date: 05/17/2012**  
**Greenville Central School District**

Printed: 06/28/2012 9:49

*Committee : Greenville CPSE*

ID	DOB	Gender	Grd	Disability	Meeting	Mtg Date	Ref Date	Outcome	12 Mth
900000194	04/25/2007	M	PS	Preschool student with a disability	Annual Review	05/17/12		IEP Change: Remains Classified	X
	<b>Primary Service</b>	<b>Start Date</b>	<b>Fut. End Date</b>	<b>Service Description</b>	<b>Freq / Cycle Minutes</b>	<b>Delivery Recommendations</b>	<b>School/ Location</b>	<b>Coordinating Service Provider</b>	
CURRENT YEAR	Yes	09/07/2011	06/22/2012	4 Hour Integrated Class	5/Weekly 240 Minutes	4 hour Integrated Class	Circle of Friends in classroom	EARLY CHILDHOOD LEARNING	
CURRENT YEAR	No	09/07/2011	06/22/2012	Physical Therapy	2/Weekly 30 Minutes	Individual	Circle of Friends in classroom	EARLY CHILDHOOD LEARNING	
CURRENT YEAR	No	09/07/2011	06/22/2012	Speech/Language Therapy	3/Weekly 30 Minutes	Individual	Circle of Friends in classroom	EARLY CHILDHOOD LEARNING	
CURRENT YEAR	No	09/07/2011	06/22/2012	Occupational Therapy	3/Weekly 30 Minutes	Individual	Circle of Friends in classroom	EARLY CHILDHOOD LEARNING	
NEXT YEAR	Yes	07/09/2012	08/17/2012	4 Hour Integrated Class	5/Weekly 240 Minutes	4 hour Integrated Class	Circle of Friends in classroom	EARLY CHILDHOOD LEARNING	
NEXT YEAR	No	07/09/2012	08/17/2012	Occupational Therapy	3/Weekly 30 Minutes	Individual	Circle of Friends in classroom	EARLY CHILDHOOD LEARNING	
NEXT YEAR	No	07/09/2012	08/17/2012	Physical Therapy	2/Weekly 30 Minutes	Individual	Circle of Friends in classroom	EARLY CHILDHOOD LEARNING	
NEXT YEAR	No	07/09/2012	08/17/2012	Speech/Language Therapy	3/Weekly 30 Minutes	Individual	Circle of Friends in classroom	EARLY CHILDHOOD LEARNING	

**Minutes:** door to door special transportation provided by Greene County due to student's developmental delays. Student will receive 1:1 aide support while at program.

**Board Action Sheet**  
**Meeting Date: 05/17/2012**  
**Greenville Central School District**

Printed: 06/28/2012 9:49

*Committee : Greenville CPSE*

ID	DOB	Gender	Grd	Disability	Meeting	Mtg Date	Ref Date	Outcome	12 Mth
----	-----	--------	-----	------------	---------	----------	----------	---------	--------

900000292	07/10/2007	F	UPK	Preschool student with a disability	Annual Review	05/17/12		IEP Change: Remains Classified	X
-----------	------------	---	-----	-------------------------------------	---------------	----------	--	--------------------------------	---

	Primary Service	Start Date	Fut. End Date	Service Description	Freq / Cycle Minutes	Delivery Recommendations	School/ Location	Coordinating Service Provider
CURRENT YEAR	Yes	09/07/2011	06/22/2012	Special Education Itinerant Teacher	10/Weekly 30 Minutes		Nature's Way Preschool and UP Home/Parent Paid Preschool	FAMILY & EDUCATIONAL CONSULTANTS
CURRENT YEAR	No	09/07/2011	06/22/2012	Occupational Therapy	4/Weekly 30 Minutes	Individual	Home Home Based	ADVANCED THERAPY, P.L.L.C.
CURRENT YEAR	No	09/07/2011	06/22/2012	Speech/Language Therapy	4/Weekly 30 Minutes	Individual	Nature's Way Preschool and UP Home/Parent Paid Preschool	FAMILY & EDUCATIONAL CONSULTANTS
NEXT YEAR	Yes	07/02/2012	08/10/2012	Special Education Itinerant Teacher	3/Weekly 60 Minutes		Home Home/Parent Paid Preschool	FAMILY & EDUCATIONAL CONSULTANTS

900000433	07/10/2007	M	UPK	Declassified	Annual Review	05/17/12		IEP Change: Declassified
-----------	------------	---	-----	--------------	---------------	----------	--	--------------------------

	Primary Service	Start Date	Fut. End Date	Service Description	Freq / Cycle Minutes	Delivery Recommendations	School/ Location
CURRENT YEAR	Yes	09/14/2011	06/22/2012	Occupational Therapy	2/Weekly 30 Minutes	Individual	Nature's Way Preschool and UP in classroom

**Minutes:** The student no longer meets the criteria as a preschool student with a disability.

900000186	10/12/2007	M	PS	Preschool student with a disability	Annual Review	05/17/12		IEP Change: Remains Classified	X
-----------	------------	---	----	-------------------------------------	---------------	----------	--	--------------------------------	---

	Primary Service	Start Date	Fut. End Date	Service Description	Freq / Cycle Minutes	Delivery Recommendations	School/ Location	Coordinating Service Provider
--	-----------------	------------	---------------	---------------------	----------------------	--------------------------	------------------	-------------------------------

**Board Action Sheet**  
**Meeting Date: 05/17/2012**  
**Greenville Central School District**

Printed: 06/28/2012 9:49

*Committee : Greenville CPSE*

D		DOB	Gender	Grd	Disability	Meeting	Mtg Date	Ref Date	Outcome	12 Mth
CURRENT YEAR	Yes	09/07/2011	06/22/2012		Speech/Language Therapy	3/Weekly 30 Minutes	Individual	Early Childhood Learning Cente Push-in services	EARLY CHILDHOOD LEARNING	
CURRENT YEAR	No	09/07/2011	06/22/2012		Occupational Therapy	2/Weekly 30 Minutes	Individual	Early Childhood Learning Cente in classroom	EARLY CHILDHOOD LEARNING	
NEXT YEAR	Yes	07/02/2012	08/10/2012		Speech/Language Therapy	2/Weekly 30 Minutes	Individual	Early Childhood Learning Cente Push-in services	EARLY CHILDHOOD LEARNING	
NEXT YEAR	No	07/02/2012	08/10/2012		Occupational Therapy	2/Weekly 30 Minutes	Individual	Early Childhood Learning Cente in classroom	EARLY CHILDHOOD LEARNING	

**Total Meetings: 4**

**Board Action Sheet**  
**Meeting Date: 06/07/2012**  
**Greenville Central School District**

Printed: 06/28/2012 11:40

*Committee : Greenville CPSE*

<b>ID</b>	<b>DOB</b>	<b>Gender</b>	<b>Grd</b>	<b>Disability</b>	<b>Meeting</b>	<b>Mtg Date</b>	<b>Ref Date</b>	<b>Outcome</b>	<b>12 Mth</b>
900000372	03/20/2009	F	PS	Preschool student with a disability	New Referral	06/07/12	03/27/12	Initial Placement	
	<b>Primary Service</b>	<b>Start Date</b>	<b>Fut. End Date</b>	<b>Service Description</b>	<b>Freq / Cycle</b>	<b>Delivery Recommendations</b>	<b>School/ Location</b>	<b>Coordinating Service Provider</b>	
NEXT YEAR	Yes	09/05/2012	06/21/2013	Occupational Therapy	1/Weekly 30 Minutes	Individual	Home Home Based	COUNTY OF GREENE	
900000577	06/18/2008	M	PS	Preschool student with a disability	Annual Review	06/07/12		IEP Change: Remains Classified	X
	<b>Primary Service</b>	<b>Start Date</b>	<b>Fut. End Date</b>	<b>Service Description</b>	<b>Freq / Cycle</b>	<b>Delivery Recommendations</b>	<b>School/ Location</b>	<b>Coordinating Service Provider</b>	
CURRENT YEAR	Yes	04/16/2012	06/22/2012	4 Hour Integrated Class	5/Weekly 240 Minutes		Circle of Friends Special Education Classroom	EARLY CHILDHOOD LEARNING	
CURRENT YEAR	No	04/16/2012	06/22/2012	Speech/Language Therapy	4/Weekly 30 Minutes	Individual	Early Childhood Learning Cente Special Education Classroom	EARLY CHILDHOOD LEARNING	
NEXT YEAR	Yes	07/09/2012	08/17/2012	4 Hour Integrated Class	5/Weekly 240 Minutes		Circle of Friends Special Education Classroom	EARLY CHILDHOOD LEARNING	
NEXT YEAR	No	07/09/2012	08/17/2012	Speech/Language Therapy	3/Weekly 30 Minutes	Individual	Early Childhood Learning Cente Special Education Classroom	EARLY CHILDHOOD LEARNING	
NEXT YEAR	No	07/09/2012	08/17/2012	Occupational Therapy	2/Weekly 30 Minutes	Individual	Circle of Friends Push In/Pull out	EARLY CHILDHOOD LEARNING	
NEXT YEAR	Yes	09/05/2012	06/21/2013	4 Hour Integrated Class	5/Weekly 240 Minutes		Circle of Friends Special Education Classroom	EARLY CHILDHOOD LEARNING	
NEXT YEAR	No	09/05/2012	06/21/2013	Occupational Therapy	3/Weekly 30 Minutes	Individual	Circle of Friends Push In/Pull out	EARLY CHILDHOOD LEARNING	
NEXT YEAR	No	09/05/2012	06/21/2013	Speech/Language Therapy	4/Weekly 30 Minutes	Individual	Early Childhood Learning Cente Special Education Classroom	EARLY CHILDHOOD LEARNING	

**Board Action Sheet**  
**Meeting Date: 06/07/2012**  
**Greenville Central School District**

Printed: 06/28/2012 11:40

*Committee : Greenville CPSE*

ID	DOB	Gender	Grd	Disability	Meeting	Mtg Date	Ref Date	Outcome	12 Mth
----	-----	--------	-----	------------	---------	----------	----------	---------	--------

90000639	06/11/2009	M		Preschool student with a disability	Transfer Student/Intake	06/07/12		IEP Change: Remains Classified	
	<b>Primary Service</b>		<b>Fut. End Date</b>	<b>Service Description</b>	<b>Freq / Cycle Minutes</b>	<b>Delivery Recommendations</b>	<b>School/ Location</b>	<b>Coordinating Service Provider</b>	
NEXT YEAR	Yes		09/05/2012 06/21/2013	5 hour self contained class	5/Weekly 300 Minutes		CloverPatch Special Education Classroom	CENTER FOR DISABILITIES SERVICES	
NEXT YEAR	No		09/05/2012 06/21/2013	Speech/Language Therapy	3/Weekly 30 Minutes	Individual	CloverPatch Push In/Pull out	CENTER FOR DISABILITIES SERVICES	
NEXT YEAR	No		09/05/2012 06/21/2013	Occupational Therapy	2/Weekly 30 Minutes	Individual	CloverPatch Push In/Pull out	CENTER FOR DISABILITIES SERVICES	

**Minutes:** Door to door special transportation provided 5 days per week by Greene County.

**Board Action Sheet**  
**Meeting Date: 06/15/2012**  
**Greenville Central School District**

Printed: 06/28/2012 10:53

*Committee : Greenville CPSE*

D	DOB	Gender	Grd	Disability	Meeting	Mtg Date	Ref Date	Outcome	12 Mth
90000401	01/09/2008	M	PS	Preschool student with a disability	Annual Review	06/15/12		IEP Change: Remains Classified	X
	<b>Primary Service</b>	<b>Start Date</b>	<b>Fut. End Date</b>	<b>Service Description</b>	<b>Freq / Cycle Minutes</b>	<b>Delivery Recommendations</b>	<b>School/ Location</b>	<b>Coordinating Service Provider</b>	
CURRENT YEAR	Yes	09/07/2011	06/22/2012	4 Hour Integrated Class	5/Weekly 240 Minutes		Circle of Friends in classroom	EARLY CHILDHOOD LEARNING	
CURRENT YEAR	No	09/07/2011	09/23/2011	Occupational Therapy	3/Weekly 30 Minutes	Individual	Circle of Friends in classroom	EARLY CHILDHOOD LEARNING	
CURRENT YEAR	No	09/07/2011	09/23/2011	Occupational Therapy	1/Weekly 30 Minutes	Individual	Home Home Based	COUNTY OF GREENE	
CURRENT YEAR	No	09/07/2011	06/22/2012	Speech/Language Therapy	2/Weekly 30 Minutes	Individual	Circle of Friends in classroom	EARLY CHILDHOOD LEARNING	
CURRENT YEAR	No	09/07/2011	06/22/2012	Speech/Language Therapy	2/Weekly 60 Minutes	Individual	Home Home Based	COUNTY OF GREENE	
CURRENT YEAR	No	09/07/2011	06/15/2012	Physical Therapy	1/Weekly 30 Minutes	Individual	Circle of Friends in classroom	EARLY CHILDHOOD LEARNING	
CURRENT YEAR	No	09/26/2011	06/22/2012	Occupational Therapy	1/Weekly 60 Minutes	Individual	Home Home Based	COUNTY OF GREENE	
CURRENT YEAR	No	09/26/2011	06/22/2012	Occupational Therapy	2/Weekly 30 Minutes	Individual	Circle of Friends Push In/Pull out	EARLY CHILDHOOD LEARNING	
CURRENT YEAR	No	06/18/2012	06/23/2012	Physical Therapy	3/Weekly 30 Minutes	Individual	Circle of Friends in classroom	EARLY CHILDHOOD LEARNING	
NEXT YEAR	Yes	07/02/2012	08/10/2012	4 Hour Integrated Class	5/Weekly 240 Minutes		Circle of Friends in classroom	EARLY CHILDHOOD LEARNING	
NEXT YEAR	No	07/02/2012	08/10/2012	Speech/Language Therapy	2/Weekly 60 Minutes	Individual	Home Home Based	COUNTY OF GREENE	
NEXT YEAR	No	07/02/2012	08/10/2012	Physical Therapy	3/Weekly 30 Minutes	Individual	Circle of Friends in classroom	EARLY CHILDHOOD LEARNING	

**Board Action Sheet**  
**Meeting Date: 06/15/2012**  
**Greenville Central School District**

Printed: 06/28/2012 10:53

*Committee : Greenville CPSE*

D	DOB	Gender	Grd	Disability	Meeting	Mtg Date	Ref Date	Outcome	12 Mth
NEXT YEAR	No	07/02/2012	08/10/2012	Speech/Language Therapy	2/Weekly 30 Minutes	Individual	Circle of Friends in classroom	EARLY CHILDHOOD LEARNING	
NEXT YEAR	No	07/02/2012	08/10/2012	Occupational Therapy	2/Weekly 30 Minutes	Individual	Circle of Friends Push In/Pull out	EARLY CHILDHOOD LEARNING	
NEXT YEAR	No	07/02/2012	08/10/2012	Occupational Therapy	1/Weekly 60 Minutes	Individual	Home Home Based	COUNTY OF GREENE	
NEXT YEAR	Yes	09/05/2012	06/21/2013	4 Hour Integrated Class	5/Weekly 240 Minutes	Individual	Circle of Friends in classroom	EARLY CHILDHOOD LEARNING	
NEXT YEAR	No	09/05/2012	06/21/2013	Speech/Language Therapy	2/Weekly 30 Minutes	Individual	Circle of Friends in classroom	EARLY CHILDHOOD LEARNING	
NEXT YEAR	No	09/05/2012	06/21/2013	Speech/Language Therapy	2/Weekly 60 Minutes	Individual	Home Home Based	COUNTY OF GREENE	
NEXT YEAR	No	09/05/2012	06/21/2013	Occupational Therapy	1/Weekly 60 Minutes	Individual	Home Home Based	COUNTY OF GREENE	
NEXT YEAR	No	09/05/2012	06/21/2013	Occupational Therapy	2/Weekly 30 Minutes	Individual	Circle of Friends Push In/Pull out	EARLY CHILDHOOD LEARNING	
NEXT YEAR	No	09/05/2012	06/21/2013	Physical Therapy	3/Weekly 30 Minutes	Individual	Circle of Friends Push In/Pull out	EARLY CHILDHOOD LEARNING	

90000578	07/25/2008	M	PS	Preschool student with a disability	Annual Review	06/15/12	IEP Change: Remains Classified	X
	<b>Primary Service</b>	<b>Start Date</b>	<b>Fut. End Date</b>	<b>Service Description</b>	<b>Freq / Cycle Minutes</b>	<b>Delivery Recommendations</b>	<b>School/ Location</b>	<b>Coordinating Service Provider</b>
CURRENT YEAR	Yes	02/14/2012	06/22/2012	Speech/Language Therapy	4/Weekly 30 Minutes	Individual	Circle of Friends Push In/Pull out	COUNTY OF GREENE
CURRENT YEAR	No	02/14/2012	06/22/2012	Occupational Therapy	2/Weekly 30 Minutes	Individual	Circle of Friends Push In/Pull out	COUNTY OF GREENE
NEXT YEAR	Yes	07/02/2012	08/10/2012	Speech/Language Therapy	3/Weekly 30 Minutes	Individual	Circle of Friends Push In/Pull out	COUNTY OF GREENE

**Board Action Sheet**  
**Meeting Date: 06/15/2012**  
**Greenville Central School District**

Printed: 06/28/2012 10:53

*Committee : Greenville CPSE*

ID	DOB	Gender	Grd	Disability	Meeting	Mtg Date	Ref Date	Outcome	12 Mth
----	-----	--------	-----	------------	---------	----------	----------	---------	--------

NEXT YEAR	Yes	09/05/2012	06/21/2013	Speech/Language Therapy	4/Weekly 30 Minutes	Individual	Circle of Friends Push In/Pull out	COUNTY OF GREENE	
NEXT YEAR	No	09/05/2012	06/21/2013	Occupational Therapy	2/Weekly 30 Minutes	Individual	Circle of Friends Push In/Pull out	COUNTY OF GREENE	

900000584		07/15/2009	M	PRK	Preschool student with a disability	Transfer Student/Intake	06/15/12	IEP Change: Remains Classified	
	<b>Primary Service</b>	<b>Start Date</b>	<b>End Date</b>	<b>Service Description</b>	<b>Freq / Cycle Minutes</b>	<b>Delivery Recommendations</b>	<b>School/ Location</b>	<b>Coordinating Service Provider</b>	
NEXT YEAR	Yes	09/05/2012	06/21/2013	Special Education Itinerant Teacher	4/Weekly 60 Minutes	Direct	Home Home Based	FAMILY & EDUCATIONAL CONSULTANTS	
NEXT YEAR	No	09/05/2012	06/21/2013	Occupational Therapy	3/Weekly 60 Minutes	Individual	Home Home Based	FAMILY & EDUCATIONAL CONSULTANTS	
NEXT YEAR	No	09/05/2012	06/21/2013	Speech/Language Therapy	4/Weekly 60 Minutes	Individual	Home Home Based	FAMILY & EDUCATIONAL CONSULTANTS	

900000140		07/09/2009	F	PRK	Preschool student with a disability	Transfer Student/Intake	06/15/12	IEP Change: Remains Classified	
	<b>Primary Service</b>	<b>Start Date</b>	<b>End Date</b>	<b>Service Description</b>	<b>Freq / Cycle Minutes</b>	<b>Delivery Recommendations</b>	<b>School/ Location</b>	<b>Coordinating Service Provider</b>	
NEXT YEAR	Yes	09/05/2012	06/21/2013	Speech/Language Therapy	2/Weekly 30 Minutes	Individual	Home Home Based	COUNTY OF GREENE	

**Board Action Sheet**  
**Meeting Date: 06/15/2012**  
**Greenville Central School District**

Printed: 06/28/2012 10:53

*Committee : Greenville CPSE*

D	DOB	Gender	Grd	Disability	Meeting	Mtg Date	Ref Date	Outcome	12 Mth
900000206	11/03/2008	M	PS	Preschool student with a disability	New Referral	06/15/12	04/17/12	Initial Placement	
	<b>Primary Service</b>	<b>Start Date</b>	<b>Fut. End Date</b>	<b>Service Description</b>	<b>Freq / Cycle Minutes</b>	<b>Delivery Recommendations</b>	<b>School/ Location</b>	<b>Coordinating Service Provider</b>	
NEXT YEAR	Yes	09/05/2012	06/21/2013	Speech/Language Therapy	2/Weekly 30 Minutes	Individual	Home Home/Parent Paid Preschool	COUNTY OF GREENE	
900000196	03/09/2008	M	PRK	Non-disabled	New Referral	06/15/12	05/04/12	Not Eligible	
	<b>Primary Service</b>	<b>Start Date</b>	<b>Fut. End Date</b>	<b>Service Description</b>	<b>Freq / Cycle Minutes</b>	<b>Delivery Recommendations</b>	<b>School/ Location</b>		
	<b>Minutes:</b>	The student does not qualify as a preschooler with a disability at this time. Not Eligible.							
900000197	03/09/2008	M	PRK	Non-disabled	New Referral	06/15/12	05/04/12	Not Eligible	
	<b>Primary Service</b>	<b>Start Date</b>	<b>Fut. End Date</b>	<b>Service Description</b>	<b>Freq / Cycle Minutes</b>	<b>Delivery Recommendations</b>	<b>School/ Location</b>		
	<b>Minutes:</b>	The student does not meet the criteria as a preschooler with a disability at this time. Not Eligible.							
900000172	12/18/2008	M	PS	Preschool student with a disability	Annual Review	06/15/12		IEP Change: Remains Classified	
	<b>Primary Service</b>	<b>Start Date</b>	<b>Fut. End Date</b>	<b>Service Description</b>	<b>Freq / Cycle Minutes</b>	<b>Delivery Recommendations</b>	<b>School/ Location</b>	<b>Coordinating Service Provider</b>	
CURRENT YEAR	Yes	02/14/2012	06/22/2012	Speech/Language Therapy	2/Weekly 30 Minutes	Individual	Home Home Based	COUNTY OF ALBANY	

**Board Action Sheet**  
**Meeting Date: 06/15/2012**  
**Greenville Central School District**

Printed: 06/28/2012 10:53

*Committee : Greenville CPSE*

ID	DOB	Gender	Grd	Disability	Meeting	Mtg Date	Ref Date	Outcome	12 Mth
CURRENT YEAR	No	02/14/2012	06/22/2012	Physical Therapy	2/Weekly 30 Minutes	Individual	Home Home Based	COUNTY OF ALBANY	
CURRENT YEAR	No	02/14/2012	06/22/2012	Preschool Service Coordination	1/Monthly 30 Minutes	Individual	Home Home Based	COUNTY OF ALBANY	
NEXT YEAR	Yes	09/05/2012	06/21/2013	Speech/Language Therapy	2/Weekly 30 Minutes	Individual	Home Home Based	COUNTY OF ALBANY	
NEXT YEAR	No	09/05/2012	06/21/2013	Preschool Service Coordination	1/Monthly 30 Minutes	Individual	Home Home Based	COUNTY OF ALBANY	
NEXT YEAR	No	09/05/2012	06/21/2013	Physical Therapy	2/Weekly 30 Minutes	Individual	Home Home Based	COUNTY OF ALBANY	

---

900000631	09/12/2007	F	PS	Non-disabled		New Referral	06/15/12	03/26/12	Not Eligible
<b>Primary Service</b>	<b>Start Date</b>	<b>End Date</b>	<b>Fut. End Date</b>	<b>Service Description</b>	<b>Freq / Cycle Minutes</b>	<b>Delivery Recommendations</b>	<b>School/ Location</b>		

**Minutes:** Student does not qualify as a preschooler with a disability at this time. Not Eligible.

**Total Meetings: 9**

Greenville Central School District  
Board of Education  
PERSONNEL AGENDA  
Business Meeting  
July 9, 2012  
MS/HS Library Media Center

✓ **D. Personnel Agenda**

BE IT RESOLVED that upon the recommendation of Superintendent of Schools, Cheryl A. Dudley, that the Board of Education of the Greenville Central School District approve the following:

**1. Classified**

a. Appointment

1. Name of Appointee: Daphane Pearson  
Position: Administrative Assistant to the Assistant Superintendent of Business at forty (40) hours per week, twelve (12) months per year  
Classification: GCCS/Competitive  
Effective: July 1, 2012  
Salary: \$46,500.00 (District Office Contract; prior position GPF contract)  
Status: Cleared for Employment

b. Reduction in Force

1. Elimination of Position: Accounts Payable/Insurance Clerk/  
GCCS Senior Account Clerk  
(District Office Contract)  
Classification: GCCS Senior Account Clerk  
Effective: July 1, 2012  
Least senior employee: Claire Gustavson  
*(This position is abolished effective July 1, 2012. Ms. Gustavson is the person having the least seniority. Ms. Gustavson shall be placed upon the preferred eligible list of the district.)*

Status: All conditional appointments are subject to receipt of a statement from each individual regarding criminal charges and are contingent upon receipt of criminal background clearance from the Commissioner of Education.

JUN 28 2012

District Office



**GREENVILLE**  
CENTRAL SCHOOL DISTRICT

MEMORANDUM

TO: Cheryl A. Dudley/Superintendent of Schools

FROM: Tammy J. Sutherland/Assistant Superintendent for Business 

RE: Refuse removal bid

DATE: June 27, 2012

Refuse removal bids were opened in the Business Office on Wednesday, June 27, 2012. Bid packets were mailed to nine (9) prospective bidders with three (3) responses.

It is my recommendation to award the bid in the amount of \$150.00 per pickup for refuse removal (base bid) and \$30.00 per pickup for single stream recycling (Alternate 1) to bidder, County Waste & Recycling Services, Inc., 1927 Route 9, Clifton Park, NY 12065. The cost for the 2011-2012 school year was \$173.10 per pickup for the refuse removal (base bid) and \$24.60 for single stream recycling.

**REFUSE REMOVAL for 2011-2012 school year**

**BID OPENING**

**June 27, 2012**

**10:00 a.m.**

**Refuse removal  
amount per diem**

**Alternate 1 single  
stream recycling**

**Non-collusive  
bid statement**

Allied Waste Services	No Bid		
County Waste	\$150.00	\$30.00	Yes
Waste Management	\$155.35	\$27.66	Yes

**Submission of bid packets**

ORIGINAL

**Bids are to be received in the:**  
Greenville Central School District Office  
P.O. Box 129  
4982 SR 81  
Greenville, NY 12083

Attn: Tammy J. Sutherland/Assistant Superintendent for Business

**Bid packages shall be submitted in a clearly marked sealed envelope labeled:**

**Greenville Central School District**  
Attn: Tammy J. Sutherland/Assistant Superintendent for Business

**Refuse Removal and Recycling**  
**for 2012-2013 SCHOOL YEAR**

**Wednesday, June 27, 2012**  
**10:00 a.m.**  
**District Office**

GREENVILLE CENTRAL SCHOOL  
PO BOX 129, 4976 ROUTE 81  
GREENVILLE, NEW YORK 12083

BID FORM FOR REFUSE REMOVAL FOR 2012-2013

**BASE BID: BIDDER MUST PROVIDE DUMPSTER PICK-UP SERVICE  
AND  
PROVIDE DUMPSTER EQUIPMENT**

The undersigned hereby proposes and agrees to comply with ALL the specifications for refuse removal and provide service at the following rate:

TOTAL PER DIEM: \$ 150.00

Additional fees (if any) provide explanation: \$ \_\_\_\_\_  
\_\_\_\_\_  
\_\_\_\_\_

We propose to furnish the following:

**\*\*Set forth number of times of pick-ups; and type of dumpster that will be provided\*\***

**ALTERNATE 1 SINGLE STREAM RECYCLING:**

**DESCRIPTION:**

See attached  
\_\_\_\_\_  
\_\_\_\_\_  
\_\_\_\_\_

The undersigned hereby proposes and agrees to comply with ALL the specifications for refuse removal and provide service at the following rate:

TOTAL PER DIEM: \$ 30.00

Additional fees (if any) provide explanation: \$ \_\_\_\_\_  
\_\_\_\_\_  
\_\_\_\_\_

DATE: 6.26.12

SIGNED BY: 

Name of Company: County Waste + Recycling Services, Inc.

Address: 1927 Route 9 Clifton Park, N.Y. 12065

Name of Contact Person: Ernie Palmer

Title: Major Account Manager

Phone Number: 518-470-4924 cell#



June 26, 2012

Greenville Central Schools  
PO Box 129  
4976 Route 81  
Greenville, New York 12083

Re: Bid for Refuse Removal for 2012-2013

Dear Ms. Sutherland,

The following information is for service levels and time frames as outlined in your recent bid.

Trash service from July 1, 2012 through August 31, 2012, County Waste & Recycling will provide (5) 6 yard front load containers serviced "On Call" at \$150.00 per Diem (per pickup). From September 1, 2012 through June 30, 2013 they will be serviced 2 times per week at \$150.00 per Diem (per pickup).

Recycling service from July 1, 2012 through August 31, 2012, County Waste & Recycling will provide (3) 4 yard front load containers serviced "On Call" at \$30.00 per Diem (per pickup). From September 1, 2012 through June 30, 2013 they will be serviced 1 time per week at \$30.00 per Diem (per pickup).

County Waste will furnish (9) 65 gallon toters and (4) 35 gallon toters labeled Single Stream for internal use at no additional charge.

We will also provide 150 labels listing acceptable and unacceptable recycling items for use on smaller recycling bins.

County Waste will place (1) 10 yard roll off container for all acceptable metals, serviced "On Call" at no charge.

Please feel free to contact me with any questions. I can be reached directly at 518-470-4924 or by email at [ErnieP@wcnx.org](mailto:ErnieP@wcnx.org).

Sincerely,

A handwritten signature in black ink, appearing to read "Ernie Palmer", written over a horizontal line.

Ernie Palmer  
Major Account Manager

Enc.

BID PROPOSAL CERTIFICATIONS

Firm Name	County Waste + Recycling Services Inc.	
Business Address	1927 Route 9 Clifton Park, N.Y. 12065	
Telephone Number	518-877-7007	Date of Bid 6.27.12

I. General Bid Certification

The bidder certifies that he will furnish, the prices herein quoted, the materials, equipment and/or services as proposed on this bid.

II. Non-Collusive Bidding Certification

By submission of this bid proposal, the bidder certifies that he is complying with Section 103-d of the General Municipal Law as follows:

Statement of non-collusion in bids and proposals to political subdivision of the state. Every bid or proposal hereafter made to a political subdivision of the state or any public department, agency or official thereof where competitive bidding is required by statute, rule regulation, or local law, for work or services performed or to be performed or goods sold or to be sold, shall contain the following statement subscribed by the bidder and affirmed by such bidder as true under the penalties of perjury: Non-collusive bidding certification.

“(a) By submission of this bid, each bidder and each person signing on behalf of any bidder certifies, and in the case of a joint bid each party thereto certifies as to its own organization, under penalty of perjury, that to the best of knowledge and belief:

(1) The prices in this bid have been arrived at independently without collusion, consultation, communication or agreement, for the purpose of restricting competition, as to any matter relating to such prices with any other bidder or with any competitor;

(2) Unless otherwise required by law, the prices which have been quoted in this bid have not knowingly been disclosed by the bidder and will not be disclosed by the bidder prior to opening, directly or indirectly, to any other bidder or to any competitor; and

(3) No attempt has been made or will be made by the bidder to induce any other person, partnership or corporation to submit or not to submit a bid for the purpose of restricting competition.”

(b) A bid shall not be considered for award nor shall any award be made where (a) (1) (2) and (3) above have not been complied with, provided, however, that if in any case the bidder cannot make the foregoing certification, the bidder shall so state and shall furnish with the bid a signed statement which sets forth in detail the reasons therefor. Where (a) (1) (2) and (3) above have not been complied with, the bid shall not be considered for award nor shall any award be made unless the head of the purchasing unit of the political subdivision, public department, agency or official thereof to which the bid is made, or his designee, determines that such disclosure was not made for the purpose of restricting competition.

The fact that a bidder (a) has published price lists, rates, or tariffs covering items being procured, (b) has informed prospective customers of proposed or pending publication of new or revised price lists for such items, or (c) has sold the same items to other customers at the same prices being bid, does not constitute, without more, a disclosure within the meaning subparagraph 1 (a).

2. Any bid hereafter made to any political subdivision of the state or any public department, agency or official thereof by a corporate bidder for work or services performed or to be performed or goods sold or to be sold, where competitive bidding is required by statute, rule, regulation, or local law, and where such bid contains the certification referred to in subdivision one of the section, shall be deemed to have been authorized by the board of directors of the bidder, and such authorization shall be deemed to include the signing and submission of the bid and the inclusion therein of the certificate as to non-collusion as the act and deed of the corporation.

  
\_\_\_\_\_  
Signature (Authorized)

Division Manager  
\_\_\_\_\_  
Title

# FRONT END LOAD CONTAINERS // FLAT TOP

## 2 YARD FLAT NESTABLE

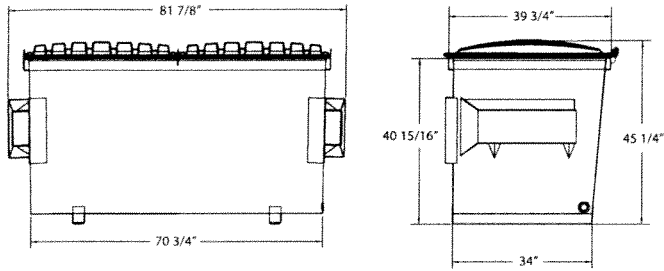

## 6 YARD FLAT

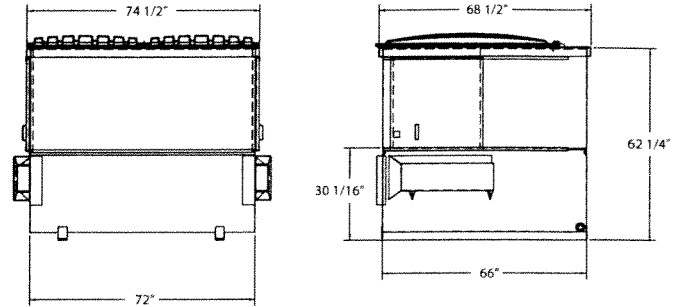

## 3 YARD FLAT NESTABLE

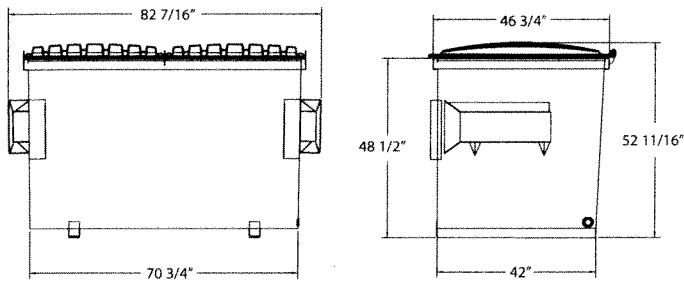

## 8 YARD FLAT

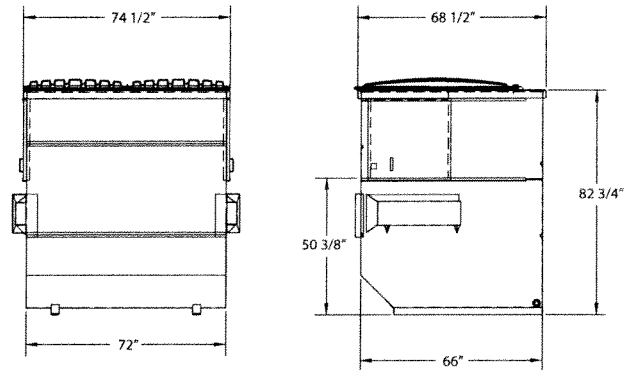

## 4 YARD FLAT

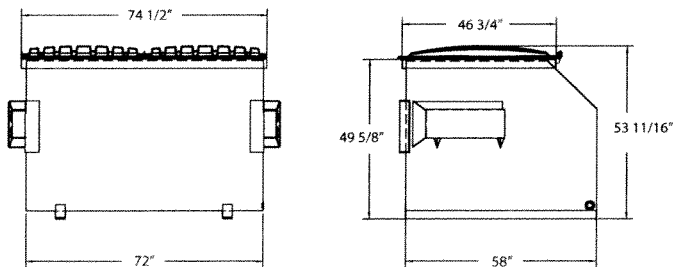

## 10 YARD FLAT

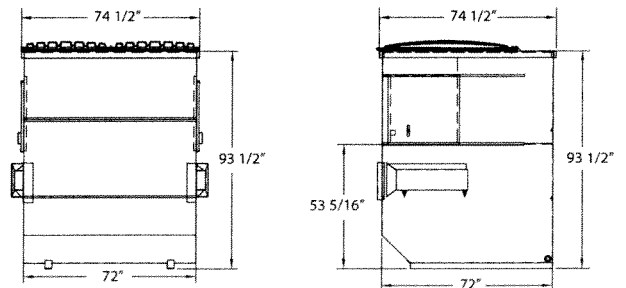

	2 YARD*	3 YARD*	4 YARD	6 YARD	8 YARD	10 YARD
48 ft. trailer flat / drop	42 / 52	28 / 36	18 / 18	8 / 14	8 / 8	7 / 7
53 ft. trailer flat / drop	45 / 57	32 / 42	20 / 20	9 / 16	9 / 9	8 / 8
Plastic lid standard	37" x 41" single wall	37" x 48" single wall	37" x 48" single wall	37" x 58" single wall	37" x 58" single wall	37" x 58" single wall
Sides	12 gauge	12 gauge	12 gauge	12 gauge	12 gauge	12 gauge
Bottom	10 gauge	10 gauge	10 gauge	10 gauge	10 gauge	10 gauge
Weight	505 lbs.	602 lbs.	732 lbs.	971 lbs.	1,110 lbs.	1,543 lbs.

\* Nestable

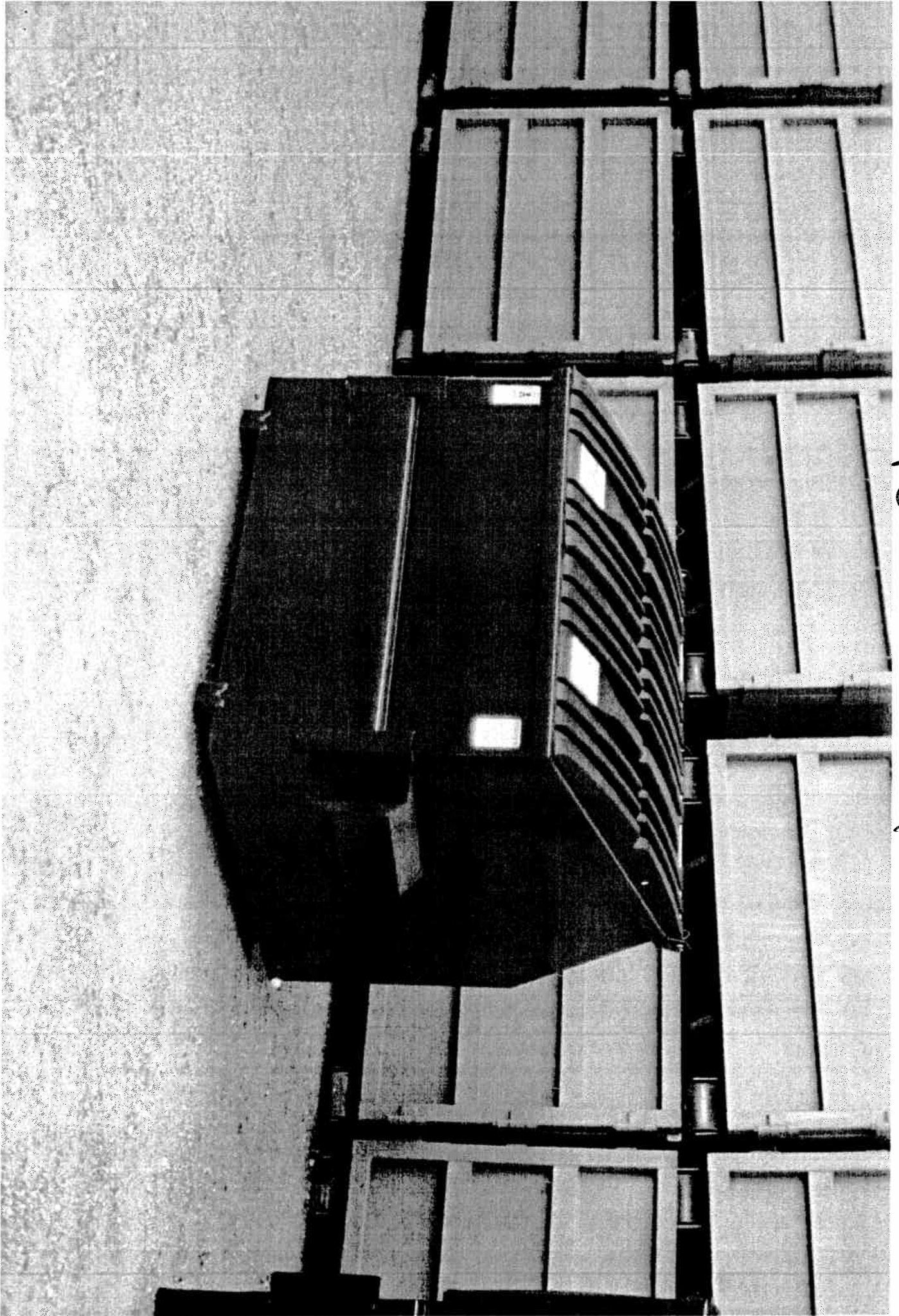

föR trash

# FRONT END LOAD CONTAINERS // SLANT TOP

## 2 YARD SLANT NESTABLE

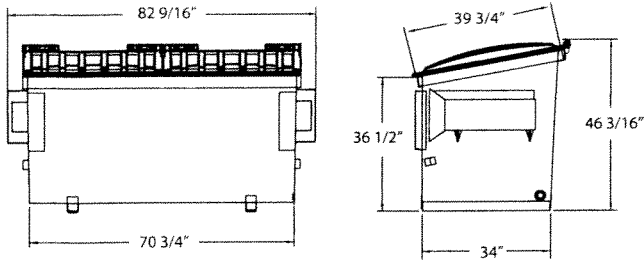

## 6 YARD SLANT

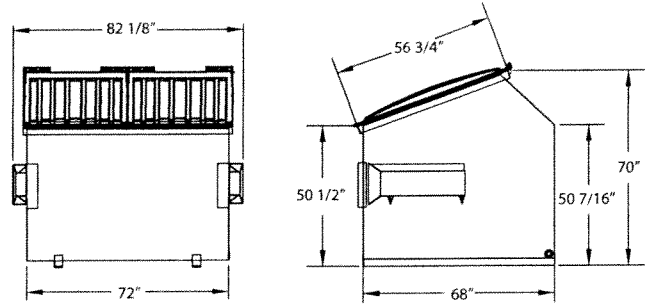

## 3 YARD SLANT NESTABLE

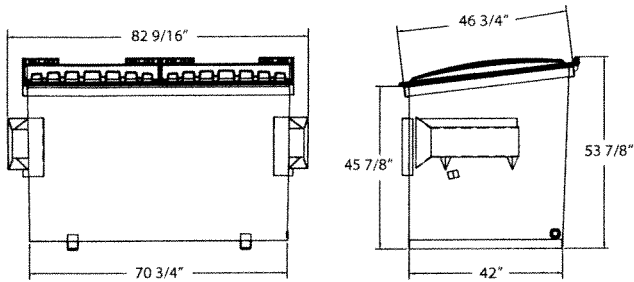

## 8 YARD SLANT

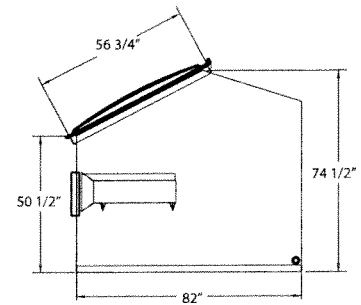

## 4 YARD SLANT NESTABLE

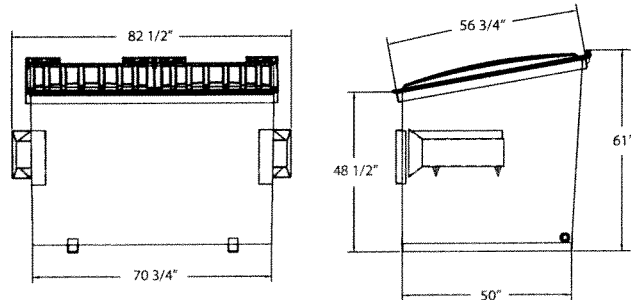

	2 YARD*	3 YARD*	4 YARD*	6 YARD	8 YARD
48 ft. trailer flat / drop	42 / 52	24 / 33	20 / 28	8 / 14	7 / 7
53 ft. trailer flat / drop	48 / 60	26 / 36	22 / 31	9 / 16	8 / 8
Plastic lid standard	37" x 41" single wall	37" x 48" single wall	37" x 58" single wall	37" x 58" single wall	37" x 58" single wall
Sides	12 gauge	12 gauge	12 gauge	12 gauge	12 gauge
Bottom	10 gauge	10 gauge	10 gauge	10 gauge	10 gauge
Weight	504 lbs.	608 lbs.	709 lbs.	971 lbs.	1,103 lbs.

\* Nestable



877-468-9278 | wastequip.com

# FRONT END LOAD CONTAINERS



 **WASTEQUIP**

**Toter**

**Albreath**

 **Accurate**

  
**MOUNTAIN TARP  
PIONEER**

**CUSCO**

**PARTS  
PLACE**

for Single Stream

# Steel Front End Load (FEL) Containers

Wastequip Front End Load Containers (FELs) are engineered using heavy gauge steel to withstand the stress of continued use. Standard models feature 12 gauge sides and 10 gauge bottoms, high density polyethylene lids and fully welded in-seams. Our heavy duty models have 10 gauge sides and 7 gauge bottoms for added strength and durability. Containers are primed inside and outside to reduce corrosion. Wastequip containers meet ANSI safety specifications and dimensional standards for haulers. With locations throughout North America, Wastequip can meet your container needs quickly.

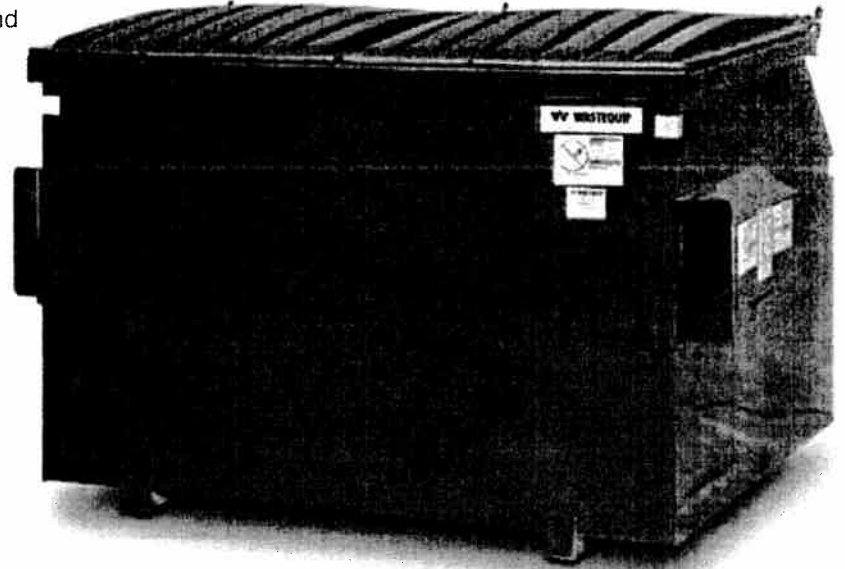

**Styles:** Flat, slant, hatchback and nestable (slant and flat)  
**Sizes:** 2, 3, 4, 6, 8, and 10 cubic yards

*Wastequip's standard steel FEL models feature 12 gauge sides and 10 gauge bottoms, high density polyethylene lids and fully welded in-seams.*

## FEATURES

### 1) FORK POCKETS:

- 3-way flared fork pockets protect from damage by the trucks forks and easily guides forks into the pockets
- Taco gussets welded to the bottom of the fork pockets help extend pocket life by providing added strength to the bottom of the pockets
- Fully welded pockets at critical stress points reduce fork damage and ensure long service life

### 2) CONSTRUCTION:

- Rounded bumper pads help prevent damage to the front of the container
- Floor channels are capped at both ends to prevent debris from getting inside and extend up the front and back walls to create extra support

### 2) CONSTRUCTION (CONT'D):

- Fully welded no-step gusset across the top of the fork pocket provides added safety and support
- Top edges are rounded and smooth for added safety during customer loading
- Interlocking top channel frame provides added strength
- Primed inside and outside to reduce corrosion
- Painted in one of several standard colors
- Nestable 2, 3 & 4 yard containers reduce shipping costs and required storage space

### 3) LIDS:

- Single wall, double lip lids ensure durability
- Optional lids upon request

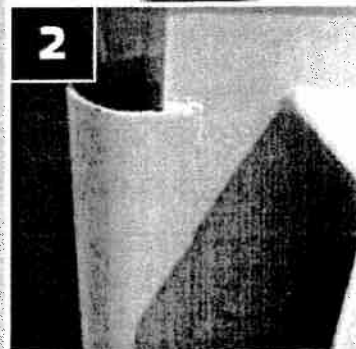

**Greenville Central School District  
Request for Bids**

**A. Description:  
2012-2013 Refuse Removal and Recycling Bid**

**B. Background**

The Greenville Central School District serves approximately 1,300 students in grades Kindergarten through 12<sup>th</sup> grade. The District facilities located on one campus of 80 acres include one elementary school, a combined middle and high school, and transportation facility.

**Project Location and Contact Information**

**Address**

Greenville Central School District  
P.O. Box 129  
4982 State Route 81  
Greenville, NY 12083

**Greenville CSD Contact Person:**

Name Robert A. Schrader  
Title Supervisor of Buildings and Grounds  
P: (518) 966 – 5070 x 462  
F: (518) 966 – 8346  
Email: schraderb@greenville.k12.ny.us

**C. Desired Scope of Services**

The Greenville Central School District is soliciting bids from qualified and experienced companies for Refuse Removal and Recycling.

**D. Written Proposal Format - Base Bid – Refuse Removal**

Respondents are directed to prepare and submit written bids which shall include, at a minimum, the following:

1. Bids are to be recorded under “Total Per Diem Line”.
2. Bids are to include the number of pick-ups and the type of dumpsters that will be provided (include pictures of the dumpsters).
3. Bid prices will be for July 1, 2012 to June 30, 2013.
4. Additional fees, example fuel surcharges must be listed on the bid.
5. Refuse is to be picked up:
  - a. When school is in session – minimum of two (2) pick-ups per week, approximately 81 pick-ups for the year. Scheduled pickups will not exceed more than three days (72 hours) on weekdays and no more than four days (96) hours when Saturday and Sunday are included between pickups.
  - b. School District will call for pick-ups during the months of July and August and during school vacation periods that are beyond those specified in the attached schedule.
  - c. Attached schedules (#1 and #2 are components of the refuse bid specifications).
  - d. Each pick-up shall include both the Elementary and Secondary School locations.
  - e. Pickup times: between 3:15 PM and 7:30 AM – pickup cannot occur during school hours (7:30 am and 3:15 pm). This will be enforced and loss of contract during contract terms shall result for violation of this requirement.
6. Contractor shall inspect the site and dumpster locations prior to bidding.

7. Equipment – Contractor must provide a minimum of five (5) 5-cubic yard slant dumpsters. Loading access side of the dumpsters cannot exceed 48” height and has to be a minimum of 5’ across (clear opening). The opposite side of the dumpster cannot exceed 60” height.
8. The disposal or process of the refuse removal shall comply with all Greene County Solid Waste Disposal regulations and New York State Department of Environmental rules and regulations.

**Written Proposal Format – Alternate 1 Single Stream Recycling**

1. Bids are to be recorded under “Total Per Diem Line”
2. Bids are to include the number of pick-ups and the type of dumpsters that will be provided (include pictures of the dumpsters).
3. Bid prices will be for July 1, 2012 to June 30, 2013.
4. Additional fees, example fuel surcharges must be listed on the bid.
5. Recycling is to be picked up
  - a. When school is in session – minimum of one (1) pick-up per week, approximately 48 pick-ups. Scheduled pickups will not exceed more than seven (7) days.
  - b. School District will call for pick-ups during the months of July and August and during school vacation periods that are beyond those specified in the attached schedule.
  - c. Attached schedules (#1 and #2 are components of the recycling bid specifications).
  - d. Each pick-up shall include the Elementary School, Secondary School and Bus Garage locations.
  - e. Pickup times: between 3:15 PM and 7:30 AM – pickup cannot occur during school hours (7:30 am and 3:15 pm). This will be enforced and loss of contract during contract terms shall result for violation of this requirement.
6. Contractor shall inspect the site and dumpster locations, prior to bidding.
7. The disposal or process of the recycling shall comply with all Greene County Solid Waste Disposal regulations and New York State Department of Environmental rules and regulations.
8. Equipment – Contractor must provide a minimum of three (3) 4-cubic yard slant dumpsters. Loading access side of the dumpsters cannot exceed 48” height and has to be a minimum of 5’ across (clear opening). The opposite side of the dumpster cannot exceed 63” height. Two independent opening covers need to be provided on all dumpsters to allow easy access.
  - a. Contractor had to provide at no cost a total of nine (9) 65 gallon and four (4) 35 gallon wheeled plastic covered single stream recycling bins for use to bring recyclables to the dumpsters.
  - b. All bins must have recycling labels that include a list of items acceptable and items unacceptable.
  - c. Contractor to provide at no cost, 150 adhesive recycling labels listing items acceptable and unacceptable for use on smaller recycling bins.
9. Acceptable Items: The following items (excluding paper and cardboard) are to be picked up by the contractor in the recyclable dumpsters. Chip board/box board, juice boxes, milk cartons, aluminum cans, glass bottles (all colors), tin and bi-metallic containers (including aerosol cans), aseptic milk/juice cartons, aluminum foil, plastic containers (recycle 1-7 symbol), lids, and frozen food cartons.
10. Contractor to provide at no cost for pick up one 10 cubic yard open low sided dumpster for steel metal recycling to be able to accept bus brake drums (no brakes), steel wheels, metal sheeting, steel desks, shelving, and miscellaneous steel and brackets. This to be located at bus garage. School District will call for pick-ups. All bids and accompanying documentation

become the property of the Greenville Central School District. The school district reserves the right to reject any and all bids received, to modify the proposal and award, or to re-issue a request for bids if it deems that it is not satisfied with responses or is unable to proceed with and award at this time.

**E. Selection Process & Timeline**

1. Issue bid specifications: June 15, 2012
2. Bids Due to District: June 27, 2012 prior to 10 a.m.
3. Bid Opening: Wednesday, June 27, 2012 @ 10:00 a.m.
4. Anticipated Action: Board of Education Meeting ~ July 9, 2012
5. Final awards will not be based on low price alone. Other factors considered will be:
  - a. The contractor's ability to meet the bid specifications to include dumpsters, bins, pick- up times, and variety of recyclable items picked up, etc...
  - b. Any additional costs, example, fuel surcharge.
  - c. The price submitted – prices will be based on the per diem rate x the # of pickups.

**Submission of bid packages:** Bids shall be submitted as follows:

One copy of your written proposal, supporting documentation and a signed non-collusion certification are to be submitted in a clearly marked sealed enveloped labeled:

**Greenville Central School District  
2012-2013 Refuse & Recycling Bid  
By 10:00 A.M. on June 27, 2012 to:**

Tammy J. Sutherland/Assistant Superintendent for Business  
Greenville Central School District  
Business Office  
4982 State Route 81  
P.O. BOX 129  
Greenville, NY 12083

Thank you for your interest.

cc: Board of Education  
Tammy J. Sutherland, Assistant Superintendent for Business  
Project File

GREENVILLE CENTRAL SCHOOL  
PO Box 129, 4982 SR 81  
Greenville, New York 12083

**SPECIFICATIONS FOR REFUSE REMOVAL FOR 2012-2013**

CONTRACT PERIOD: July 1, 2012 through June 30, 2013

SPECIFICATIONS: Refuse is to be picked up **AS SCHEDULED BELOW** when school is in session. Contractor will be notified when school is not in session - minimum of two (2) pick-ups per week, approximately 81 pick-ups for the year. Scheduled pickups will occur, such as, "NOT TO EXCEED MORE THAN THREE DAYS (72 hrs) APART ON WEEKDAYS" and "NO MORE THAN FOUR DAYS (96 hours) APART WHEN SATURDAY and SUNDAY ARE INCLUDED BETWEEN PICKUPS". Will call for pick-ups during the months of July and August or school vacations that are beyond those specified in the attached schedules. The attached schedules (#1 & #2) are considered a component of this specification. Each pick-up shall include both the Elementary and the Secondary School. Contractor shall inspect site to be knowledgeable of access and dumpster locations, prior to bidding. The disposal of the contents from these dumpsters shall comply with all Greene County Solid Waste Disposal regulations and New York State Department of Environmental rules and regulations.

EQUIPMENT: Contractor must provide a minimum of five (5) 5-cubic yard dumpsters. Loading access to dumpsters cannot exceed 48" high on one side, with opposite side access not to exceed 60" in height. Accessible or loading side has to be a minimum of 5' across (clear opening).

\*Award will be based on total cost of bid (per diem rate x # of pickups)\*

\*\*\*\*\*

**ALTERNATE 1:  
SPECIFICATIONS FOR SINGLE STREAM RECYCLING FOR 2012-2013**

CONTRACT PERIOD: July 1, 2012 through June 30, 2013

SPECIFICATIONS: The pick up of Single Stream Recyclables (excluding paper and cardboard) is to be picked up **AS SCHEDULED BELOW** when school is in session. Contractor will be notified when school is not in session - minimum of one (1) pick-up per week, approximately 48 pick-ups. Scheduled pickups will occur, such as, "NOT TO EXCEED MORE THAN 7 DAYS APART BETWEEN PICKUPS". School will call for pick-ups during the months of July and August or school vacations that are beyond those specified in the attached schedules. The attached schedules (#1 & #2) are considered a component of this specification. Each pick-up shall include the Elementary, the Secondary School, and **Bus Garage**. Contractor shall inspect site to be knowledgeable of access and dumpster locations, prior to bidding. The disposal or processing of the contents from these dumpsters shall comply with all Greene County Solid Waste Disposal regulations and New York State Department of Environmental rules and regulations.

Acceptable Items: The following items (excluding paper and cardboard) have to be acceptable by Bidder in the recyclable dumpsters. Chip board/box board; juice boxes; milk cartons; aluminum cans; glass bottles (all colors); tin and bi-metallic containers (including aerosol cans); Aseptic Milk/juice cartons; aluminum foil; plastic containers (recycle 1-7 symbol); lids; frozen food cartons; bus brake drums (no brakes); steel wheels; metal sheeting; and miscellaneous steel and brackets.

EQUIPMENT: Contractor must provide a minimum of three (3) 4-cubic yard slant dumpsters. Loading access to dumpsters cannot exceed 48" high on one side, with opposite side access not to exceed 63" in height. Accessible or loading side has to be a minimum of 5' across (clear opening). Two independent opening covers have to be provided on all Dumpsters to allow easy access. The contractor shall provide at no cost for pick up one (1) 10 yard dumpster for the bus brake drums, steel wheels, metal sheeting, and miscellaneous steel and brackets. (The school district will call for pick-ups on this dumpster and this dumpster only.)

Contractor has to provide at **no cost** a total of nine (9) 65 gallon and four (4) 35 gallon wheeled plastic covered Single Stream Recycling bins for use to bring recyclables to dumpsters. All bins must have Recycling labels and labels listing items acceptable and items unacceptable.

Labels: Contractor to provide at no cost 150 adhesive recycling labels listing items acceptable and unacceptable for use on smaller recycling bins.

\*Award will be based on total cost of bid (per diem rate x # of pickups)\*

**REFUSE & RECYCLING SCHEDULE FOR SERVICE**

Please be advised that the following schedule of hours is to be followed by the successful bidder for refuse and recyclable removal:

**B E T W E E N:**

**3:15 PM and 7:30 AM**

**Pickup cannot occur during school hours (7:30 a.m. - 3:15 p.m.) This will be enforced and loss of contract during contract term shall result for violation of this requirement.**

**It is the intent of Greenville Central School to award to the lowest responsible Bidder provided the bid does not exceed the funds available. Greenville School shall have the right to waive informalities or irregularities in a bid received and to accept the bid which, in the District's judgement, is in the District's own best interests. Greenville Central School shall have the right to accept or reject to determine the low bidder on the basis of the sum of the Base Bid.**

**Schedule #1: Summer Refuse & Recycling Pick Ups**

**Mondays Only**

**July 9, 2012 (Refuse & Recycling)**

**July 23, 2012**

**August 6, 2012 (Refuse & Recycling)**

**Thursdays Only**

**July 5, 2012**

**July 19, 2012 (Refuse & Recycling)**

**August 16, 2012**

**August 23, 2012(Refuse & Recycling)**

**August 30, 2012 (Refuse & Recycling)**

**September 6, 2012**

**Then back to normal Mondays and Thursdays pickups starting  
September 10, 2012**

**Schedule # 2: Do Not Pick Up Refuse or Recycling on  
the Following Days**

**Refuse:**

**Thursdays**

**December 27, 2012**

**February 21, 2013**

**April 4, 2013**

**Mondays**

**November 26, 2012**

**December 31, 2012**

**February 25, 2013**

**April 8, 2013**

**The school is closed during this time and pickup is not required.**

## TRANSPORTATION AGREEMENT

This agreement is entered into between the Greenville Central School District, (“Greenville”) with a principal place of business at Route 81, Greenville, New York 12083 and Cairo-Durham Central School District (“Cairo-Durham”) with a principal place of business at P.O. Box 780, Cairo, New York 12413 concerning transportation for certain students of Cairo-Durham (the “Students”) who attend certain programs outside both Greenville and Cairo-Durham.

1. **Transportation Services.** Greenville shall transport the students of Cairo-Durham from the morning pick-up point specified to the following programs, and from those programs to the afternoon drop-off point specified for the 2012 summer as specified below.
  - a. **Columbia-Greene Educational Center:** Cairo-Durham shall pay Greenville \$452.16 (\$54.86 daily rate x 6 days /(\$41.00 daily rate x 3 days ) for Cairo-Durham students transported to the Columbia-Greene Educational Center at 131 Union Turnpike, Hudson, NY 12534. Greenville will transport the students of Cairo from a morning pick-up point at Cairo-Durham High School (June 22 - 29) to the program and from the program to an afternoon drop-off point at Cairo-Durham High School and from a morning pick-up point at the Catskill CSD (July 2, 3 and 5) to the program and to an afternoon drop-off point at Catskill CSD.
  - b. **Center for Spectrum Services:** Cairo-Durham shall pay Greenville \$4,403.94 (\$151.86 daily rate x 29 days) for Cairo-Durham students transported to the Center for Spectrum Services at 70 Kukuk Lane, Kingston, NY 12401. Cairo-Durham will provide and pay for an aide on this transportation. Greenville will transport the students of Cairo-Durham from a morning pick-up point at each student’s home to the program and from the program to an afternoon drop-off point at each student’s home.
  - c. **Wildwood (Curry Road):** Cairo-Durham shall pay Greenville \$3,253.51 (\$112.19 daily rate x 29 days) for Cairo-Durham students transported from Wildwood (take home only) at 2995 Curry Road Extension, Schenectady, NY 12303 and for the cost of a shared aide. Greenville will transport the student of Cairo-Durham from the program to an afternoon drop-off point at the student’s home.
2. **Payment:** Therefore, Cairo-Durham agrees to pay the sum total of \$8,109.61 to Greenville for the above-stated services. Payment shall be due and owing within 30 days after the date of invoice, but in any event no later than September 15, 2012, whichever comes first.
3. **Termination:** This agreement may be terminated by Greenville, in sum or in part, upon 14 days notice to Cairo-Durham, in the event that due to changes in attendance or enrollment:
  - a. Greenville discontinues its bus run to one of the programs; or
  - b. Such bus is filled to capacity with Greenville students.

Further, Greenville may terminate this agreement with 48 hours notice to Cairo-Durham, in the event that a Cairo-Durham student violates the Greenville Code of Conduct or otherwise engages in inappropriate conduct while on the Greenville bus or on Greenville property. Greenville administrators shall also have the authority to suspend the student from Greenville bus transportation in accordance with its policies and the Education Law.

4. **Insurance, Defense and Indemnification:** Cairo-Durham shall provide to Greenville a certificate of insurance, attached hereto as Exhibit A. Cairo-Durham shall defend, indemnify and save harmless Greenville, its officials, employees and agents, from and against all claims, damages, losses and expenses arising out of or in consequence of any negligent or intentional act or omission of Cairo-Durham, its officials, employees, volunteers or agents to the extent of its or their responsibility for such claims, damages, losses and expenses. Cairo-Durham shall further reimburse Greenville for any property damage to Greenville's property which may be caused by the actions of any Cairo-Durham student. Greenville shall defend, indemnify and save harmless Cairo-Durham, its officials, employees and agents, from and against all claims, damages, losses and expenses arising out of or in consequence of any negligent or intentional act or omission of Greenville, its officials, employees, volunteers or agents to the extent of its or their responsibility for such claims, damages, losses and expenses.
5. **Board Approval:** This Agreement shall not become final and binding unless and until it is approved by the Boards of Education of Greenville and Cairo-Durham. By signing below, the Superintendent of Schools for each district represents that he/she has been authorized by his/her district's Board of Education to enter into this Agreement.
6. **Choice of Law and Forum:** This Agreement shall be governed by the laws of the State of New York and any dispute arising out of or under this Agreement shall be resolved in an action or proceeding commenced in a court of competent jurisdiction in the County of Greene, State of New York.
7. **Entire Agreement:** This Agreement contains the entire agreement between the parties with respect to the subject matter hereof, and supersedes and replaces all prior negotiations, correspondence, conversations, agreements, and understandings concerning the subject matter hereof. Accordingly, the parties agree that no deviation from the terms hereof shall be predicated upon prior representations, agreements or understandings, whether oral or written.
8. **Modification:** Neither this Agreement nor any of its terms may be changed or modified, waived, or terminated (unless as otherwise provided hereunder) except by an instrument in writing signed by an authorized representative of the party against whom the enforcement of the change, waiver, or termination is sought.

**GREENVILLE CENTRAL  
SCHOOL DISTRICT**

**CAIRO-DURHAM CENTRAL  
SCHOOL DISTRICT**

By: \_\_\_\_\_  
Cheryl Dudley  
Superintendent of Schools

By: \_\_\_\_\_  
Gregory Sanik  
Interim Superintendent of Schools

Date:

Date:

## TRANSPORTATION AGREEMENT

This agreement is entered into between the Cairo-Durham Central School District, ("Cairo-Durham") with a principal place of business at 424 Main Street Cairo, New York 12413 and Greenville Central School District ("Greenville") with a principal place of business at Route 81, Greenville, New York 12083 concerning transportation for certain students of Greenville (the "Students") who attend certain programs outside both Greenville and Cairo-Durham.

1. **Transportation Services** Cairo-Durham shall transport the students of Greenville from the morning pick-up point specified to the following programs, and from those programs to the afternoon drop-off point specified for the 2012 summer as specified below.
  - a. Wildwood, Altamont Summer Program: Greenville shall pay Cairo-Durham \$4,710.47 (\$162.43 daily rate x 29 days) for a Greenville student transported to the Wildwood Altamont Summer Program at, 1212 Leesome Lane, Altamont, New York 12009. Cairo-Durham will transport the student from a morning pick-up point at the student's home to the program and from the program to an afternoon drop-off point at the student's home.
  - b. Parsons: Greenville shall pay Cairo-Durham \$4,369.14 (\$150.66 daily rate x 29 days) for a Greenville student transported to the Parsons Summer Program at, 60 Academy Road, Albany, NY 12208. Cairo-Durham will transport the student from a morning pick-up point at the student's home to the program and from the program to an afternoon drop-off point at the student's home.
2. **Payment:** Therefore, Greenville agrees to pay the sum total of \$9,079.61 to Cairo-Durham for the above-stated services. Payment shall be due and owing within 30 days after the date of invoice, but in any event no later than September 15, 2012, whichever comes first.
3. **Termination:** This agreement may be terminated by Cairo-Durham, in sum or in part, upon 14 days notice to Greenville, in the event that due to changes in attendance or enrollment:
  - a. Cairo-Durham discontinues its bus run to one of the programs; or
  - b. Such bus is filled to capacity with Cairo-Durham students.

Further, Cairo-Durham may terminate this agreement with 48 hours notice to Greenville, in the event that a Greenville student violates the Cairo-Durham Code of Conduct or otherwise engages in inappropriate conduct while on the Cairo-Durham bus or on Cairo-Durham property. Cairo-Durham administrators shall also have the authority to suspend the student from Cairo-Durham bus transportation in accordance with its policies and the Education Law.

4. **Insurance, Defense and Indemnification:** Greenville shall provide to Cairo-Durham a certificate of insurance, attached hereto as Exhibit A. Greenville shall defend, indemnify and save harmless Cairo-Durham, its officials, employees and agents, from and against all claims, damages, losses and expenses arising out of or in consequence of any negligent or intentional act or omission of Greenville, its officials, employees, volunteers or agents to the extent of its or their responsibility for such claims, damages, losses and expenses. Greenville shall further reimburse Cairo-Durham for any property damage to Cairo-Durham's property which may be caused by the actions of any Greenville student. Cairo-Durham shall defend, indemnify and save harmless Greenville, its officials, employees and agents, from and against all claims, damages, losses and expenses arising out of or in consequence of any negligent or intentional act or omission of Cairo-Durham,

its officials, employees, volunteers or agents to the extent of its or their responsibility for such claims, damages, losses and expenses.

5. **Board Approval:** This Agreement shall not become final and binding unless and until it is approved by the Boards of Education of Greenville and Cairo-Durham. By signing below, the Superintendent of Schools for each district represents that he/she has been authorized by his/her district's Board of Education to enter into this Agreement.
6. **Choice of Law and Forum:** This Agreement shall be governed by the laws of the State of New York and any dispute arising out of or under this Agreement shall be resolved in an action or proceeding commenced in a court of competent jurisdiction in the County of Greene, State of New York.
7. **Entire Agreement:** This Agreement contains the entire agreement between the parties with respect to the subject matter hereof, and supersedes and replaces all prior negotiations, correspondence, conversations, agreements, and understandings concerning the subject matter hereof. Accordingly, the parties agree that no deviation from the terms hereof shall be predicated upon prior representations, agreements or understandings, whether oral or written.
8. **Modification:** Neither this Agreement nor any of its terms may be changed or modified, waived, or terminated (unless as otherwise provided hereunder) except by an instrument in writing signed by an authorized representative of the party against whom the enforcement of the change, waiver, or termination is sought.

**GREENVILLE CENTRAL  
SCHOOL DISTRICT**

**CAIRO-DURHAM CENTRAL  
SCHOOL DISTRICT**

By: \_\_\_\_\_  
Cheryl Dudley  
Superintendent of Schools

By: \_\_\_\_\_  
Gregory Sanik  
Interim Superintendent of Schools

Date:

Date:

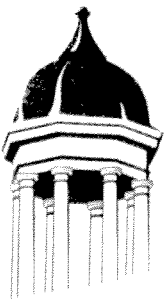

June 29, 2012

A letter was recently sent to you by the middle/ high school nurses that discussed the administration of insulin during after-school activities. We write to clarify the responsibilities of the District regarding students with diabetes and the administration of insulin during after-school activities.

The District understands and is committed to working with students and their parents/guardians to ensure that students with diabetes are able to participate in school-sponsored extracurricular activities outside of school hours. To ensure that each student's specific needs are met, advance planning and collaboration will be required among parents/guardians, school nurses, school staff, and principals. For example, diabetes management strategies should be included in health care and/or emergency care plans for students who participate in school-sponsored extracurricular activities. In addition, depending on the situation, a school nurse or trained staff may be required to cover such extracurricular activities.

In furtherance of its commitment to educate staff about diabetes, the District plans to train its school personnel, including bus drivers, cafeteria workers, athletic personnel, and nursing staff, on diabetes, what it is, how to recognize it, and what to do if a student with diabetes seems to be behaving differently from one's norm. The first training for coaches is planned for August 2012.

In order to plan for the coming school year, please contact your principal and/or school nurse if you are interested in updating your child's health care and/or emergency care plan to include diabetes management strategies for school-sponsored extracurricular activities.

Please feel free to contact us if you have any questions.

Sincerely,

Mrs. Debbie-Theiss Mackey, RN  
Middle / High School Nurse

Mr. Brian W. Reeve  
Middle School Principal