



Halifax Area School District

'Prepared, Engaged & Responsible Citizens'

# HALIFAX ELEMENTARY SCHOOL FEASIBILITY STUDY PUBLIC UPDATE

NOVEMBER 29, 2017



# TEAM



**KCBA – *Arch /Interior /Structural Design***



**Snyder Hoffman Associates – *MEP Engineering***



**K&W Engineers – *Civil Engineering***



**Landmark Commercial Realty – *Real Estate***

Graphic Icons by The Noun Project – [www.thenounproject.com](http://www.thenounproject.com)



Halifax Area School District  
'Prepared, Engaged & Responsible Citizens'



ENROLLMENT



SECURITY



CODE COMPLIANCE



CURRICULUM



**EDUCATIONAL**



Halifax Area School District  
*'Prepared, Engaged & Responsible Citizens'*

**OPERATIONAL**

BUILDING SYSTEMS



FLEXIBILITY



TECHNOLOGY



EFFICIENCY



A large, modern, multi-level atrium with a glass balcony, bookshelves, and tables. The space is bright and open, with a glass balcony overlooking the main area. The ground floor features bookshelves, a reception desk, and several tables with chairs. The ceiling has recessed lighting and circular pendant lights. The overall atmosphere is clean, professional, and inviting.

**YOU'RE NOT ALONE**

# YEAR OF ORIGINAL CONSTRUCTION FOR 1,194 SCHOOL BUILDINGS IN PA

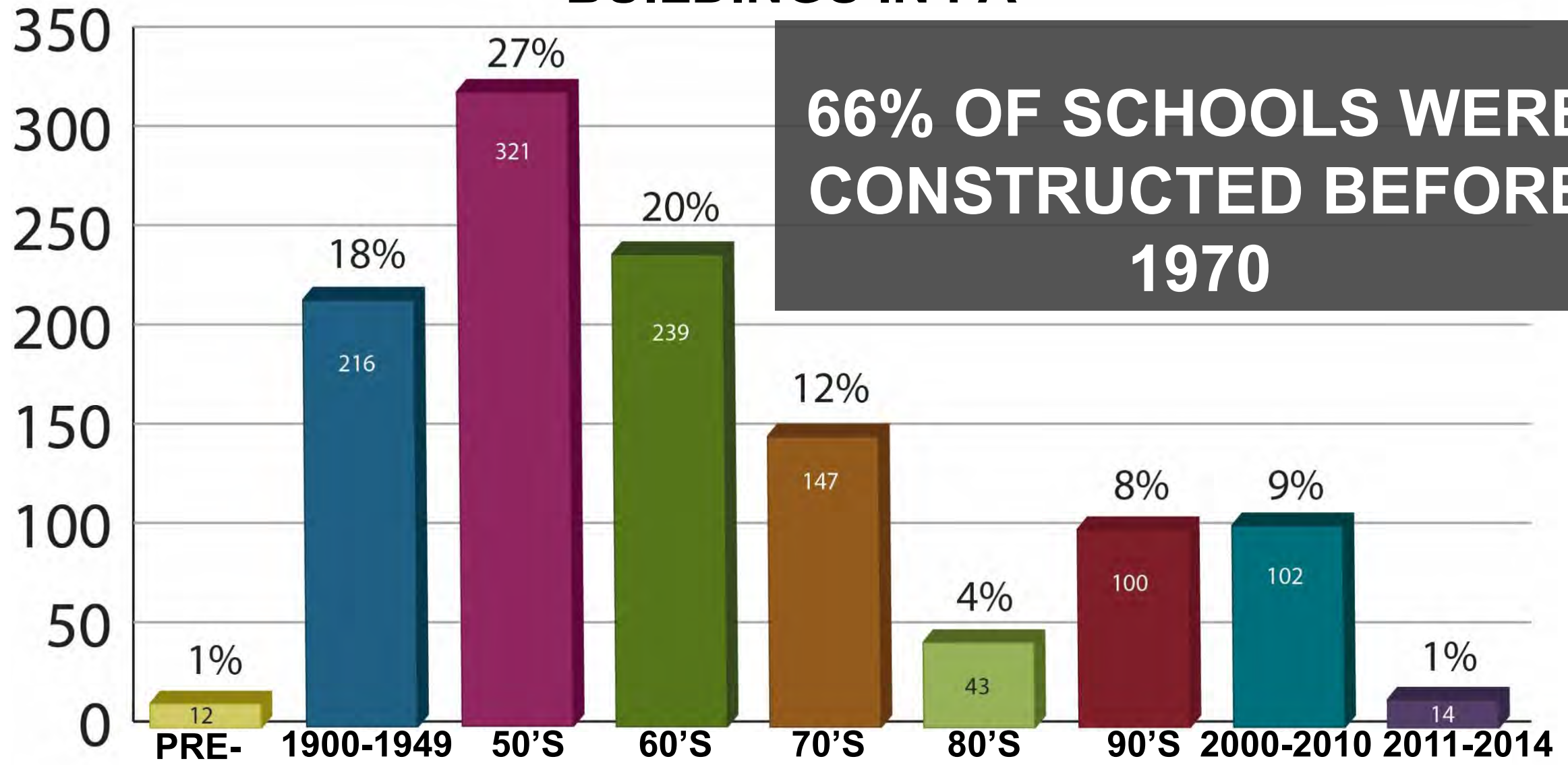

\*Data drawn from Pennsylvania Department of Education's 2014 School Facilities Survey.

## Future challenges

Chief school administrators' biggest expected challenges **over the next year.**

	All School Districts
Budget pressures/lack of funding	86.4%
Bargaining issues	38.9%
School construction/maintenance	25.7%

Increasing enrollment	5.1%	0.7%	0.0%	12.2%	6.7%	4.8%
Principal/Administrator recruitment/retention	4.3%	2.8%	16.7%	4.1%	6.7%	0.0%
IDEA and state special education requirements (IUs Only)	n/a	n/a	n/a	n/a	n/a	19.0%
Student recruitment/quotas (CTCs Only)	n/a	n/a	n/a	n/a	24.4%	n/a
Relations with participating school districts (CTCs and IUs Only)	n/a	n/a	n/a	n/a	17.8%	4.8%

# BUILDING SYSTEM PROBLEMS IN PENNSYLVANIA'S SCHOOLS

What is the biggest problem with school buildings?

	All School Districts	Urban	Suburban	CTCs	IUs	
Mechanical/ Electrical /HVAC issues	43.0%	38.8%	30.0%	30.0%	30.0%	
Structural issues	11.3%	10.4%	12.5%	12.5%	5.0%	10.0%
Inadequate space	10.4%	5.6%	18.8%	16.3%	37.5%	20.0%

\*Data drawn from 2016-17 study commissioned by the Pennsylvania Public Education Foundation





**YESTERDAY'S  
MANUFACTURING JOBS**



**TODAY'S  
MANUFACTURING JOBS**

# S · T · E · M



## JOB GROWTH INDEX 2017

### Interesting STEM Statistics:

- Between 2005 and 2015, STEM employment grew by 24.4%, over five times more than non-STEM employment
- Average STEM-employment wages are 29% higher than non-STEM employment wages
- Average unemployment in STEM fields is 2.5%, compared with 5.5% for non-STEM employment

An aerial photograph of a rural landscape, showing a patchwork of green and brown fields, roads, and a small town or village in the lower-left corner. The image is semi-transparent, serving as a background for the text.

# **BUILDING ASSESSMENT REVIEW**

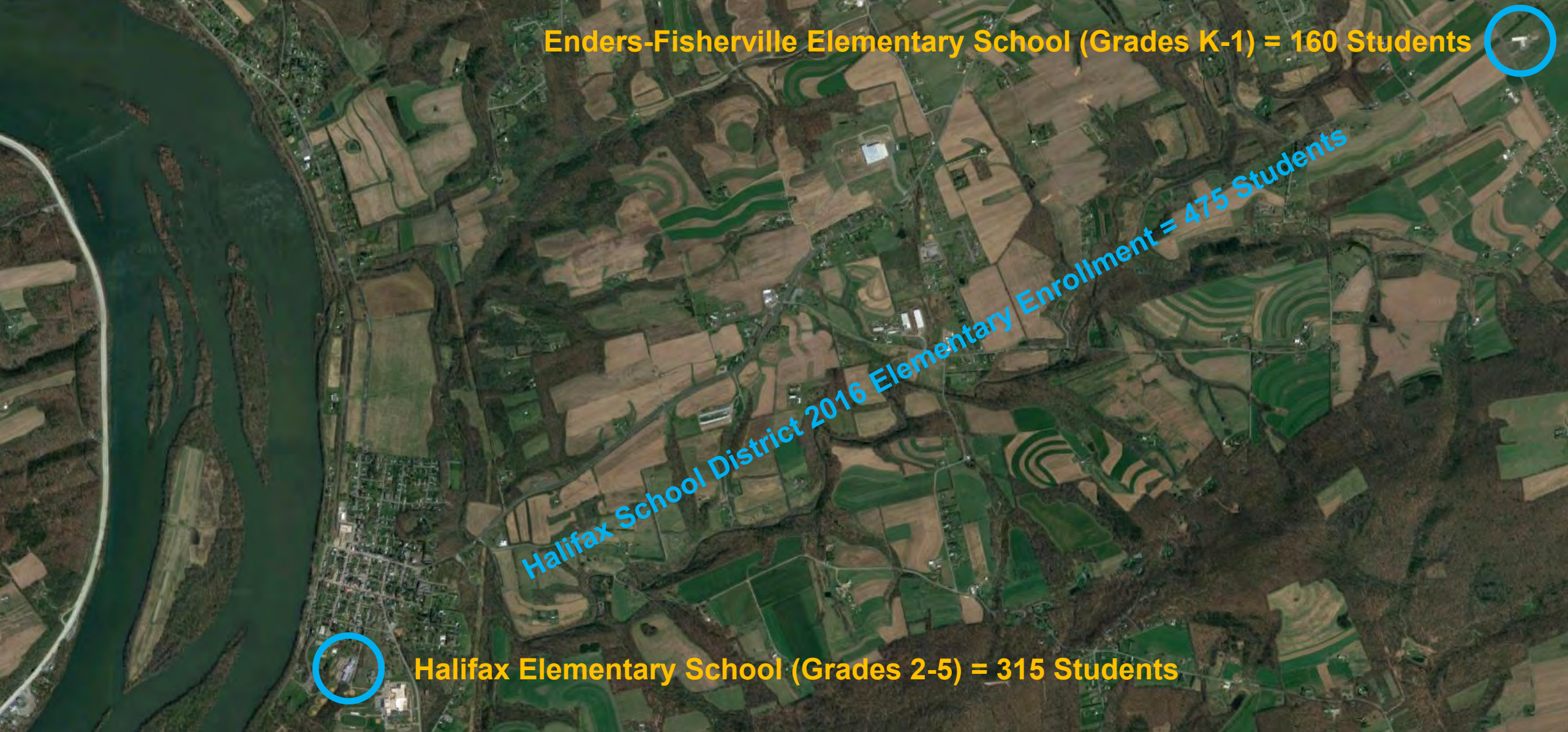

Enders-Fisherville Elementary School (Grades K-1) = 160 Students

Halifax School District 2016 Elementary Enrollment = 475 Students

Halifax Elementary School (Grades 2-5) = 315 Students



## Enders-Fisherville ES (Grades K-1)

- The building (1958) is 58 years old many of its systems are at the end of their functional lifespan
- Uncertainty about the septic / well
- Uncertainty electrical service
- Code + Safety issues
- \$31,218.43 major repairs in 2015
- **Additional \$17,872 in 2016**
- Probable sale - \$269,950 - \$404,925
- Student Capacity = 200 students
- **Lacks SGI's / LGI's / Dedicated Science**



## Enders-Fisherville ES (Grades K-1)

- Enders-Fisherville Elementary School (EES) originally built in 1958, with alterations and additions completed in 1988, 2002
- 1 story building - 26,995 SF
- Modular Classroom: 1600 SF
- The building is 58 years old many of its systems are at the **end of their functional lifespan.**



## Enders-Fisherville ES (Grades K-1)

- The building is located on a relatively flat 10.2 acre site adjacent in Jackson Township, about **6.2 miles outside of the Borough of Halifax**
- 5 buses service this school
- Uncertainty about the **septic system** size / capacity / condition / water pressure
- Rural roads deteriorate quickly during weather events.

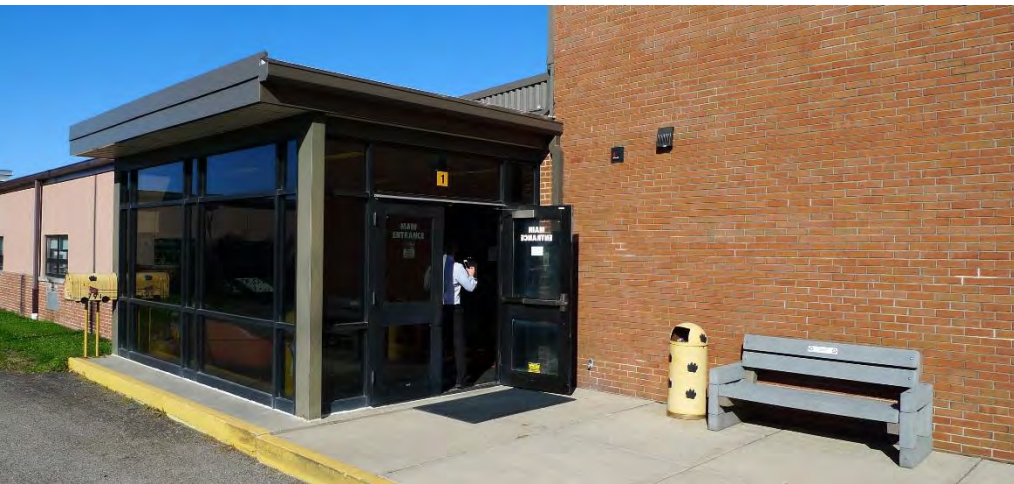

## Enders-Fisherville ES (Grades K-1)

- Building does not have a building-wide fire suppression system
- Building **does not have a secure entrance**
- Building does not have separate restrooms for visitors + students
- Loss of water pressure and/or inadequate flow is routinely experienced based on intensity of facilities usage



## Enders-Fisherville ES (Grades K-1)

- There are many areas where surface deterioration can be seen on the exterior
- Windows are in **poor condition** showing signs of age and are in need of replacement
- Signs of water infiltration were noticed in the ceilings



## Enders-Fisherville ES (Grades K-1)

- Door hardware **not ADA compliant**
- Issues throughout the building with restricted approach
- Classroom sinks are **not ADA compliant**
- Classroom doors + hardware are not sufficient for modern security standards



## Enders-Fisherville ES (Grades K-1)

- Majority of the HVAC systems are 18 years old and **nearing end of their useful lives**
- The school does not have a central cooling plant, packaged terminal air conditioning units serve select locations
- The classroom unit ventilators are outdated by today's standards for **indoor air quality**
- Art Classroom does not meet ventilation rates required by the International Mechanical Code



## Enders-Fisherville ES (Grades K-1)

- Majority of the plumbing fixtures + equipment are nearing, or have exceeded, the end of their useful lives
- Renovations to the toilet rooms should address any **ADA/Accessibility issues** as well as current water conservation requirements and the “Reduction of Lead in Drinking Water Act”

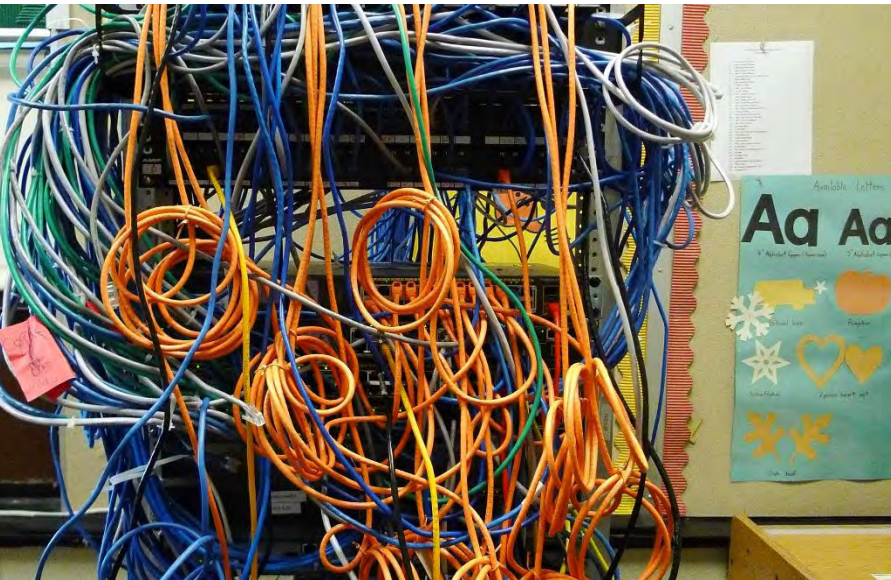

## Enders-Fisherville ES (Grades K-1)

- Average classroom contains four receptacles (two front + two rear of room) which is less than today's standards with six to eight receptacles per classroom
- Building mounted lighting switches do **not meet ADA requirements**
- The emergency generator should be replaced with a unit capable of adding walk-in coolers, freezers and minimal building heat
- **Frequent power outages occur**



## Enders-Fisherville ES (Grades K-1)

- Classrooms in building are of adequate size, although the attached restrooms have accessibility issues
- Several Classrooms are **underused** during parts of the day
- No Small Group Instruction areas in the school



## Enders-Fisherville ES (Grades K-1)

- The multi-purpose room acts as the school's gymnasium, cafeteria and auditorium
- The school does not have a Large Group Instruction space
- There is no dedicated Science Classroom

# Enders-Fisherville ES (Grades K-1)

- \$31,218.43 major repairs in 2015
- **Additional \$17,872 in 2016**

## ENDERS FISHERVILLE

11/30/2016 Freezer Down	2,000.00	
11/30/2016 Various Minor Repairs Month of July through November	1,387.31	Our maintenance did labor
Note: This included a crumbling sewer pipe under boys bathroom.		
10/1/2016 Electrical outlet on stage caught fire- Outlet bypassed	0.00	Our maintenance did labor
10/6/2016 Generator Repair	4,670.10	
10/6/2016 Fire Alarm Repair	420.00	
11/3/2016 McClure Water Repair	644.77	
6/16/2016 Freezer Down	1,225.42	
6/14/2016 Walk in Cooler Down	3,475.00	
10/10/2015 Freezer Down	2,643.81	
6/30/2016 Various Minor Repairs Month of July 2015 through June 2016	1406.45	Our maintenance did labor
Various Date Sewage alarm goes off. Cost above in minor repairs	0.00	Our maintenance did labor
Summer 16 Bypass faulty intercom system, bells ring through phone	0.00	CAIU Gratis: Test case

**17,872.86**

## Large Items Prior to July 2015

2014/2015 Building repairs to Infrastructure	8,770.67
2014/2015 Building repairs to Infrastructure	4,574.90

**31,218.43**



## Building Analysis – Cost Events Halifax Area School District



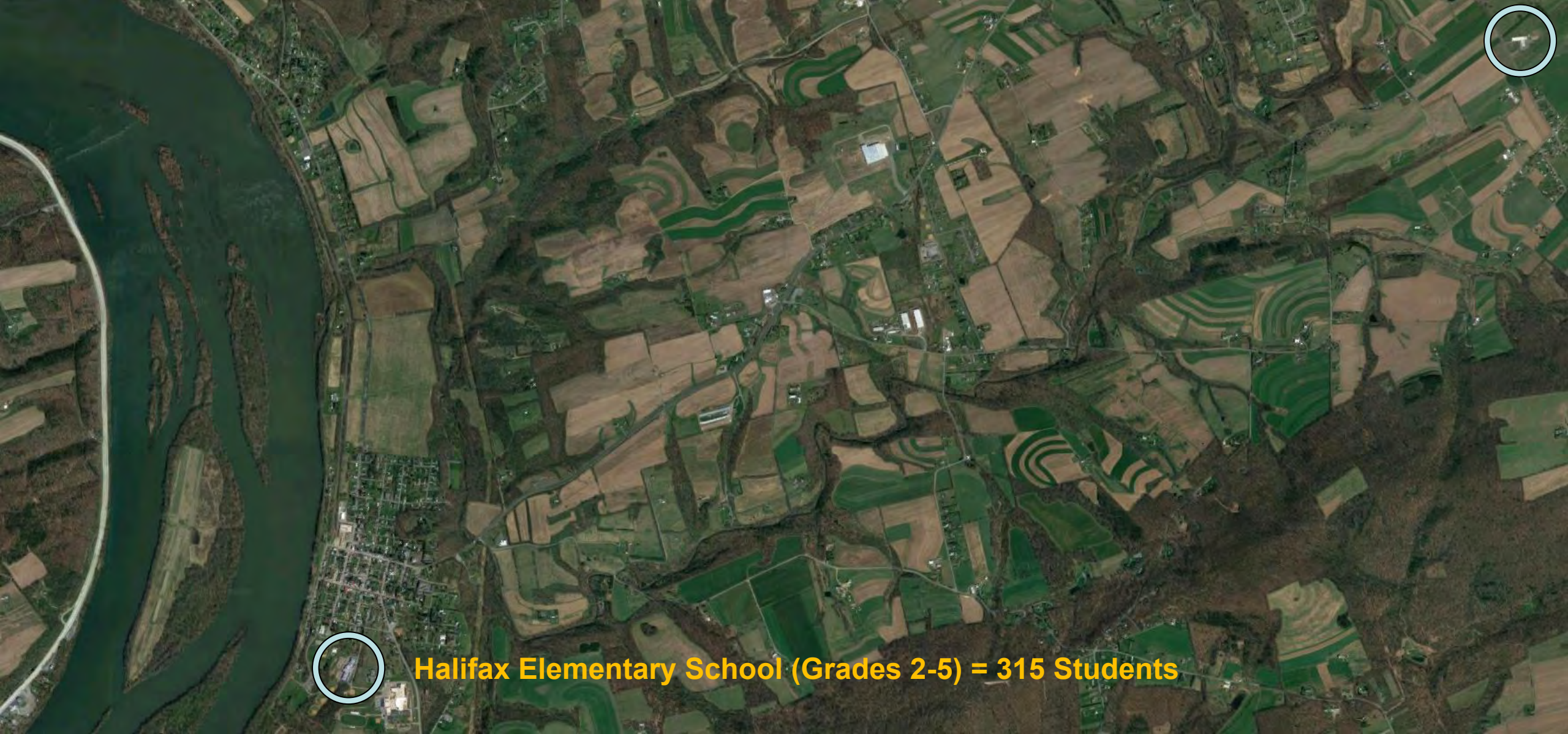

**Halifax Elementary School (Grades 2-5) = 315 Students**



## Halifax ES (Grades 2-5)

- Halifax Elementary School (1968) is 48 years old and many of its systems are at the end of their functional lifespan
- HVAC fair condition/10 years of life
- Parking + Bus safety issues
- Code + Safety issues
- \$87,245.55 major repairs in 2015
- **Additional \$34,514 in 2016**
- **Additional \$40,000 recently for boiler**
- Probable sale - \$556,250 - \$834,375
- Student Capacity = 400 students
- Lacks SGI's / LGI's / Dedicated Science

Building Analysis - Assessment Summary

Halifax Area School District





## Halifax ES (Grades 2-5)

- Halifax Elementary School (HES) was originally built in 1968, with alterations and additions completed in 1988
- 55,625 sq. ft. (1.5 story building)
- Upper Level Floor Plan: 34,784 SF
- Lower Level Floor Plan: 20,841 SF
- Halifax Elementary School is 48 years old and many of its systems are at the end of their functional lifespan, it is also **in need of aesthetic and infrastructure renovations**



## Halifax ES (Grades 2-5)

- The building is located on a **7.3 acre steeply sloping** site adjacent to the Halifax Area School District (HASD) Middle and High School complex within the Borough of Halifax on School Road
- Not enough space for all of the buses to line up in this area (stacking back onto School Street) - students/parents cross in-between the buses traveling to/from parked vehicles along the eastern edge of School Street (this is a **significant safety concern**)



## Halifax ES (Grades 2-5)

- Student drop-off occurs on the back (or west) side of the building in an area that is not very well defined
- Parents line up for this pick-up area as much as 30-40 minutes in advance of dismissal, **causing concerns with stacked vehicles** in the hard surface play area which may still be in use by students



## Halifax ES (Grades 2-5)

- Building does not have a building-wide fire suppression system
- Building **does not have a secure entrance**
- Door hardware into classrooms and storage areas are **not ADA compliant**
- The doors and door hardware into many classrooms are **not sufficient for modern security standards**



## Halifax ES (Grades 2-5)

- Critical railings **do not meet code** and do not offer proper fall protection
- Classrooms sinks are **not ADA compliant**
- Exterior access points begin on grade but not all are handicap accessible, some transition to steps at exits



## Halifax ES (Grades 2-5)

- As a whole, the HVAC systems are in fair condition and the District should expect another 5-8 years of serviceable life from its components
- The Corridor return/relief plenum system must be revised to comply with the requirements of the International Mechanical Code. **Use of a Corridor as a plenum is not permitted**
- Art Classroom **does not meet ventilation** rates required by the International Mechanical Code



## Halifax ES (Grades 2-5)

- Majority of the plumbing fixtures and equipment are original and nearing, or have exceeded, **the end of their useful lives**
- The existing domestic water heater appears to have exceeded its life expectancy and **should be replaced**
- Renovations to the toilet rooms should address any **ADA/Accessibility issues** as well as current water conservation requirements and the “Reduction of Lead in Drinking Water Act”



## Halifax ES (Grades 2-5)

- Electrical systems are original and in fair to poor condition
- Building mounted lighting switches were measured at 50" above finished floor which do not meet ADA requirement
- **Multiple exit signs not working** properly
- Building fire alarm system does **not meet current code requirements**



## Halifax ES (Grades 2-5)

- Classrooms in the building are slightly oversized, but overall classrooms/building lacks storage
- Most classrooms have good natural light, except for the band, music and health rooms, which are in **windowless** areas of the lower level general
- Several of the classrooms are not being used to capacity, several rooms are used only ½ of the day, and a few are used for other activities



## Halifax ES (Grades 2-5)

- A reading support SGI is currently located in a windowless storage room on the lower level, the building lacks SGI spaces
- No Large Group Instruction space
- **Autistic classroom restroom is undersized, does not support student/instructor needs**
- No dedicated science classroom
- The multi-purpose room acts as the school's gym, cafeteria and auditorium



## Halifax ES (Grades 2-5)

- Halifax Elementary School (1968) is 48 years old and many of its systems are at the end of their functional lifespan
- HVAC fair condition/10 years of life
- Parking + Bus safety issues
- Code + Safety issues
- \$87,245.55 major repairs in 2015
- **Additional \$34,514 in 2016**
- **Additional \$40,000 recently for boiler**
- Probable sale - \$556,250 - \$834,375
- Student Capacity = 400 students



- Lacks SGI's / LGI's / Dedicated Science

Building Analysis – Recent Incidents

Halifax Area School District

# Halifax ES (Grades 2-5)

- \$87,245.55 major repairs in 2015
- **Additional \$34,514 in 2016**
- **Additional \$40,000 recently for boiler**

## HALIFAX ELEMENTARY

DATE	DESCRIPTION	COST	
11/30/2016	Intercom System in classroom does not work		Working on it. Cost to be determined
11/30/2016	Dishwasher / Cafeteria.. Major Leak. Estimate	5,000.00	
11/30/2016	Smart Board Projector /No longer works, old one of the originals	1,300.00	
11/2/2016	Repipe Expansion Tank for Boiler Hot water loop	1,527.00	Our maintenance assisted
11/21/2016	Bathroom Repairs (Crumbling pipes)	208.19	Our maintenance did labor
11/16/2016	HVAC System-Computer Repairs	270.00	
11/30/2016	Various Minor Repairs Month of July through November	2,060.40	Our maintenance did labor
11/30/2016	McClure water and HVAC Repairs Month of July through November	11,290.48	
9/22/2016	Door seals replaced	373.30	Our maintenance did labor
11/30/2016	Major roof repair	8,000.00	
3/20/2016	Walk in Cooler Down	427.08	
6/30/2016	Various Minor Repairs Month of July 2015 through June 2016	4,057.91	Our maintenance did labor
		<b>34,514.36</b>	

## Large Items Prior to July 2015

2014	Pa System	14,673.00
2014/2015	Building repairs to Infrastructure	13,646.62
2013/2015	Cafeteria Window Coverings	3,359.00
2014/2015	Building repairs to Infrastructure	21,052.57
		<b>87,245.55</b>



## Building Analysis – Cost Events Halifax Area School District



An aerial photograph of a rural landscape, showing a patchwork of green and brown fields, a small town with a grid street pattern on the left, and a winding road or canal. The image is semi-transparent, serving as a background for the text.

# **Capacities/ Program / Budgets Review**

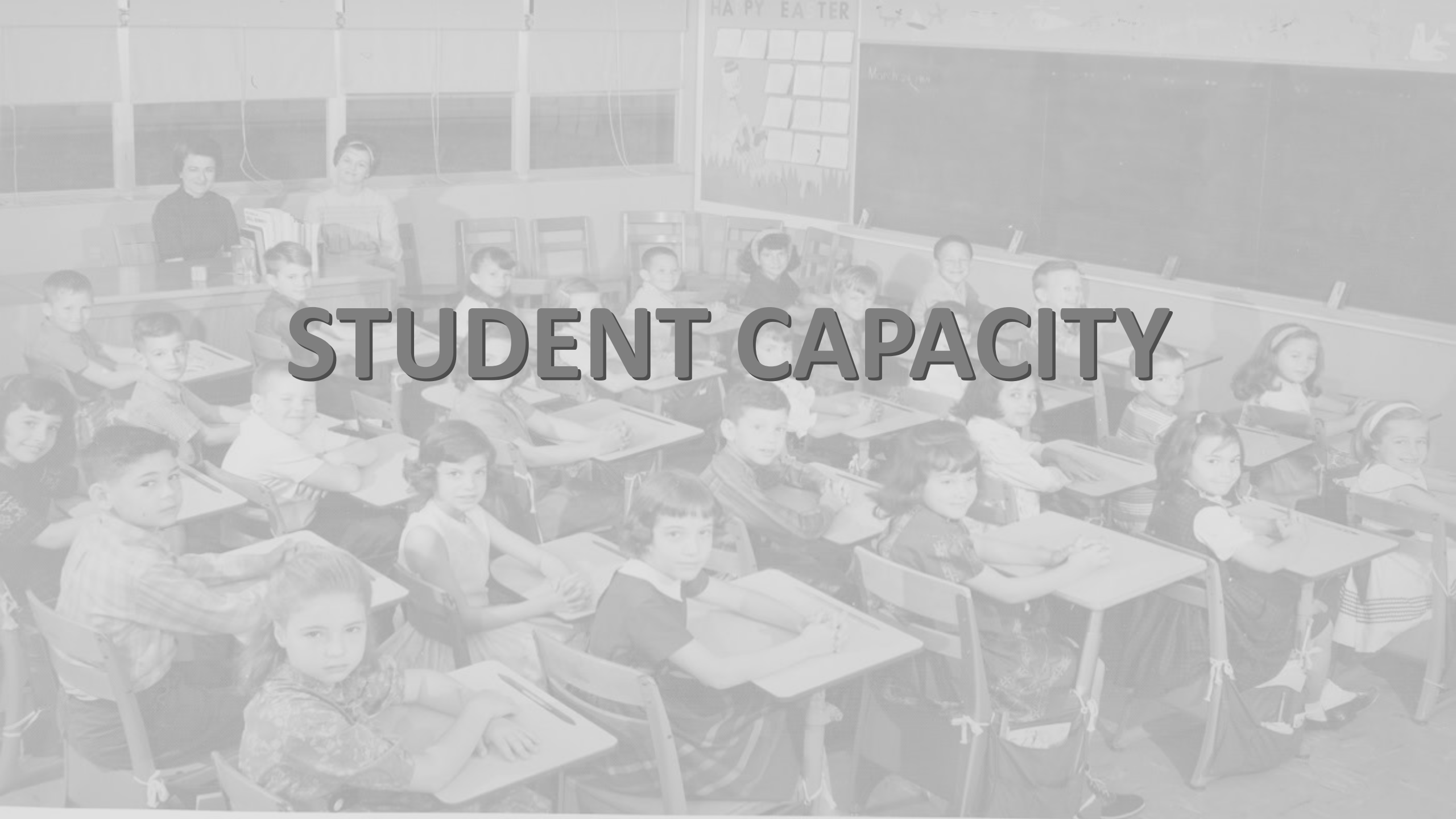

# STUDENT CAPACITY



HAPPY EASTER

March 24, 1944



National Center for  
Education Statistics

2011 Study:

National Average Primary  
School Enrollment = 450

Current HASD Enrollment:

Enders-Fisherville (K-1) = 150

Halifax Elementary (2-5) = 314

***TOTAL = 464 Students***

# Recommended ES Capacity is 85% or 22 Students / Classroom

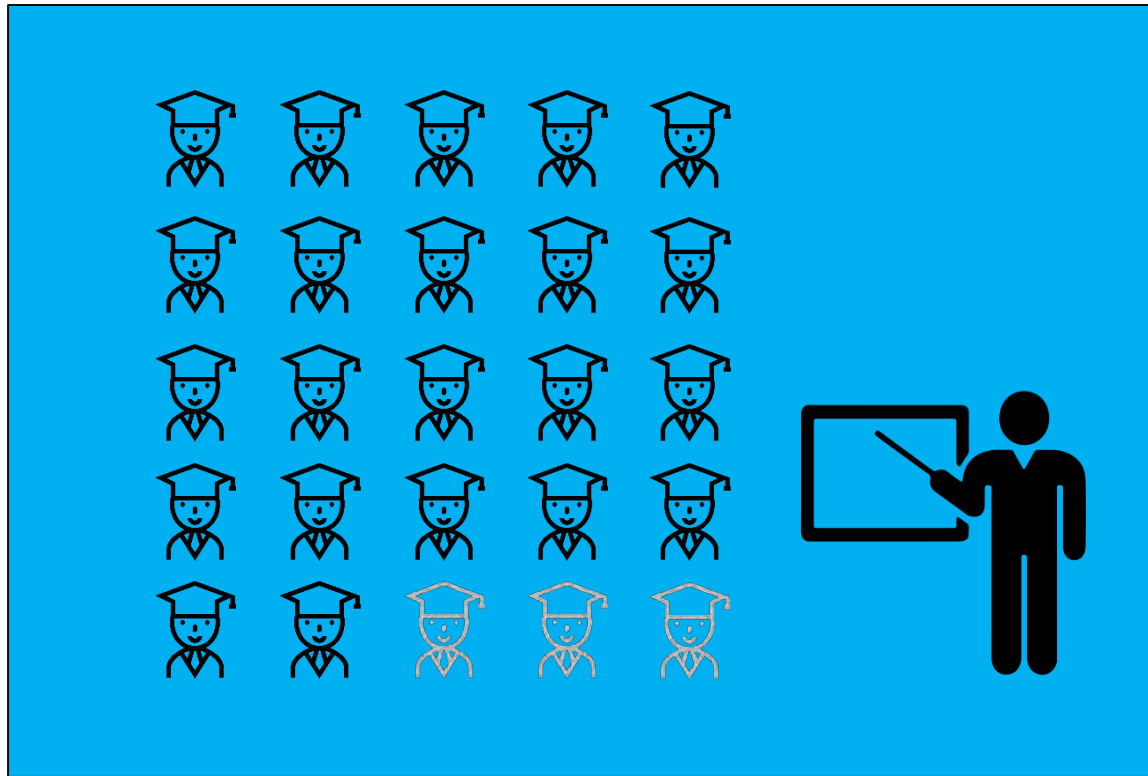

## *PDE Capacity:*

Maximum capacity as determined by the state. Equates every classroom to hold 25 students.

## *Actual Capacity:*

True capacity of the school based on how the space is actually used. **Accounts for dedicated spaces for special education and learning support.**

## *Target Capacity:*

Multiplies the actual capacity by 0.88 which reduces class size down from 25 to 22 students in each class.

	Existing			Capacity		Remarks
	No.	NSF	Total	Per Room	Total	
<b>ACADEMIC CENTER</b>						
<b>Core Programs</b>						
Kindergarten	4	950	3,800	25	100	includes toilet room
First Grade	4	950	3,800	25	100	includes toilet room
Second Grade	4	950	3,800	25	100	includes toilet room
Third Grade	4	875	3,500	25	100	
Fourth Grade	4	875	3,500	25	100	
Fifth Grade	4	875	3,500	25	100	
Title One Classroom	2	660	1,320	0	0	
Special Education Classrooms	1	660	660	0	0	
Small Group Instruction	6	660	3,960	0	0	
Full Time Autistic Support Classroom	1	950	950	0	0	includes toilet room
<b>Subtotal</b>	<b>34</b>		<b>28,790</b>		<b>600</b>	

<b>STUDENT CAPACITY (PDE)</b>					600	
<b>2015/2016 ENROLLMENT</b>					475	
<b>CAPACITY AVAILABLE</b>					125	79%

<b>ADDITIONAL EDUCATIONAL SPACES</b>						
<b>ART AND MUSIC CENTER</b>						
General Art Classroom	1	950	950	0	0	
Art Storage	1	100	100	0	0	
General Music Classroom	1	950	950	0	0	
Music Storage	1	100	100	0	0	
Music Practice Room	1	100	100	0	0	

<b>TECHNOLOGY CENTER</b>						
General Science Classroom	1	950	950	0	0	includes sinks and storage
Library	1	1,600	1,600	0	0	
Library Office	1	200	200	0	0	
Library Storage	1	200	200	0	0	

<b>SCHOOL COMMONS</b>						
Gymnasium/Cafeteria	1	5,000	5,000	0	0	
Storage	1	300	300	0	0	
Kitchen	1	1,665	1,665	0	0	includes storage, office, serving, & DW
Faculty Room	1	550	550	0	0	

<b>SCHOOL ADMINISTRATION</b>						
Reception	1	500	500	0	0	
Conference Room	1	200	200	0	0	
Offices (Principal and Assistant Principal)	2	180	360	0	0	
Guidance Office	1	180	180	0	0	
Special Education Office	1	300	300	0	0	Office with secretary space
Workroom	1	180	180	0	0	
Storage	1	160	160	0	0	
Nurse Suite	1	600	600	0	0	
<b>Subtotal</b>	<b>9</b>		<b>2,480</b>	<b>0</b>	<b>0</b>	

ACADEMIC TOTAL	34		28,790		600	CAPACITY
ADDITIONAL EDUCATIONAL	16		10,665			
ADMINISTRATION TOTAL	9		2,480			
BUILDING NET TOTAL			41,935			
BUILDING GROSS TOTAL			78,350			
GROSSING FACTOR			1.87			

# Program 600 Students (Grades K-5)

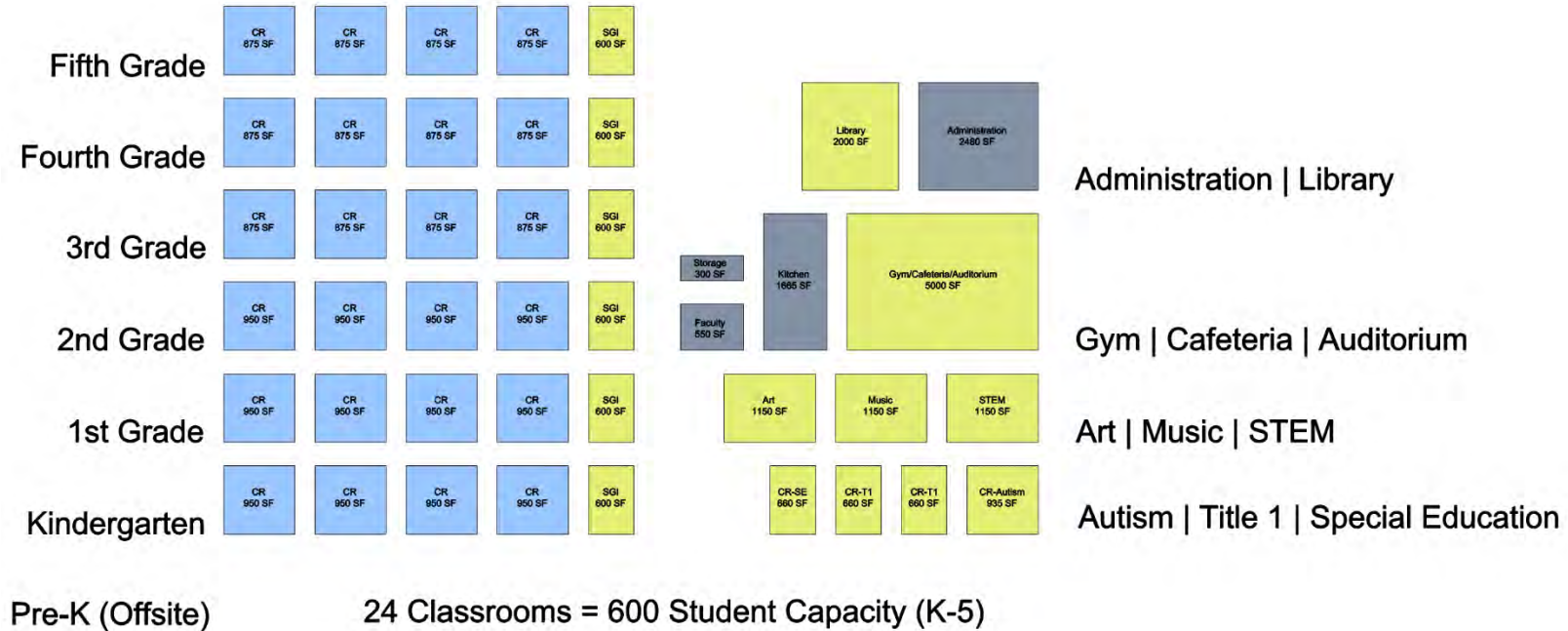

Pre-K (Offsite)

24 Classrooms = 600 Student Capacity (K-5)

# Recommended Capacity is 85% or 22 Students / Classroom

	<u>*Current Enrollment</u>	<u>3 Classrooms/Grade</u>	<u>4 Classrooms/Grade</u>
Kindergarten	76 students	26 students	19 students
First	74 students	25 students	19 students
Second	75 students	25 students	19 students
Third	68 students	23 students	17 students
Fourth	88 students	30 students	22 students
Fifth	83 students	28 students	21 students

464 students

\*2017 Enrollment #'s

26/classroom

20/classroom



# Recommended Capacity for an Elementary School is 85%

## Halifax ES (Grades 2-5)

- Student Capacity = 400 students
- 2017/2018 Enrollment = 314 students
- Capacity Available = (86 students)

150 target

79%

## Enders ES (Grades K-1)

- Student Capacity = 200 students
- 2017/2018 Enrollment = 150 students
- Capacity Available = (50 students)

314 target

75%



To Renovate

or

not to Renovate?



## Renovation options summary

- Halifax School District Committee agrees to consolidate elementary schools
  - Shared resources (nurse, principal, specialists, new educational opportunities)
- Enders too small to include Halifax kids
- Halifax too small to include Enders kids

## Renovation options cost estimates

- Renovation of Enders = \$8.3million
- Renovation of Halifax = \$15.7million
- **TOTAL = \$24million**

***\*Educational disruptions during construction***



## Expansion options summary

- **Enders Fishersville Elementary School**
  - Site furthest away from population
  - No utilities to existing site
  - Maintenance costs higher than Halifax
- **Halifax Elementary School**
  - Small site with steep slopes
  - Parking and bus circulation concerns

## Renovation options cost estimates

- Expansion of Enders = \$24million
- Expansion of Halifax = \$21.2million

***\*Educational disruptions during construction***

Renovate Enders ES (K-1) = \$8.3 M  
Renovate Halifax ES (2-5) = \$15.7 M  
**Total Both Projects = \$24 M**

**Expand Enders ES (K-5) = \$24 M**

**Expand Halifax ES (K-5) = \$21.2 M**



kcb Architects



Halifax Elementary  
Halifax Area School District  
Halifax, Pennsylvania



kcb Architects



Halifax Elementary  
Halifax Area School District  
Halifax, Pennsylvania



SITE AREA =  
7.3 ACRES

SITE AREA =  
4.66 ACRES

SITE AREA =  
10 ACRES

SITE AREA =  
25 ACRES

kcb Architects



Halifax Elementary  
Halifax Area School District  
Halifax, Pennsylvania





SITE AREA =  
25 ACRES

HALIFAX AREA MIDDLE SCHOOL  
AND HIGH SCHOOL

kcb Architects



Halifax Elementary  
Halifax Area School District  
Halifax, Pennsylvania



ATHLETIC  
FIELDS

HALIFAX AREA MIDDLE SCHOOL  
AND HIGH SCHOOL

SITE AREA =  
25 ACRES

kcb Architects



Halifax Elementary  
Halifax Area School District  
Halifax, Pennsylvania

HALIFAX  
ELEMENTARY SCHOOL

SITE AREA =  
25 ACRES

ATHLETIC  
FIELDS

HALIFAX AREA MIDDLE SCHOOL  
AND HIGH SCHOOL

kcb Architects



Halifax Elementary  
Halifax Area School District  
Halifax, Pennsylvania



SCHOOL STREET



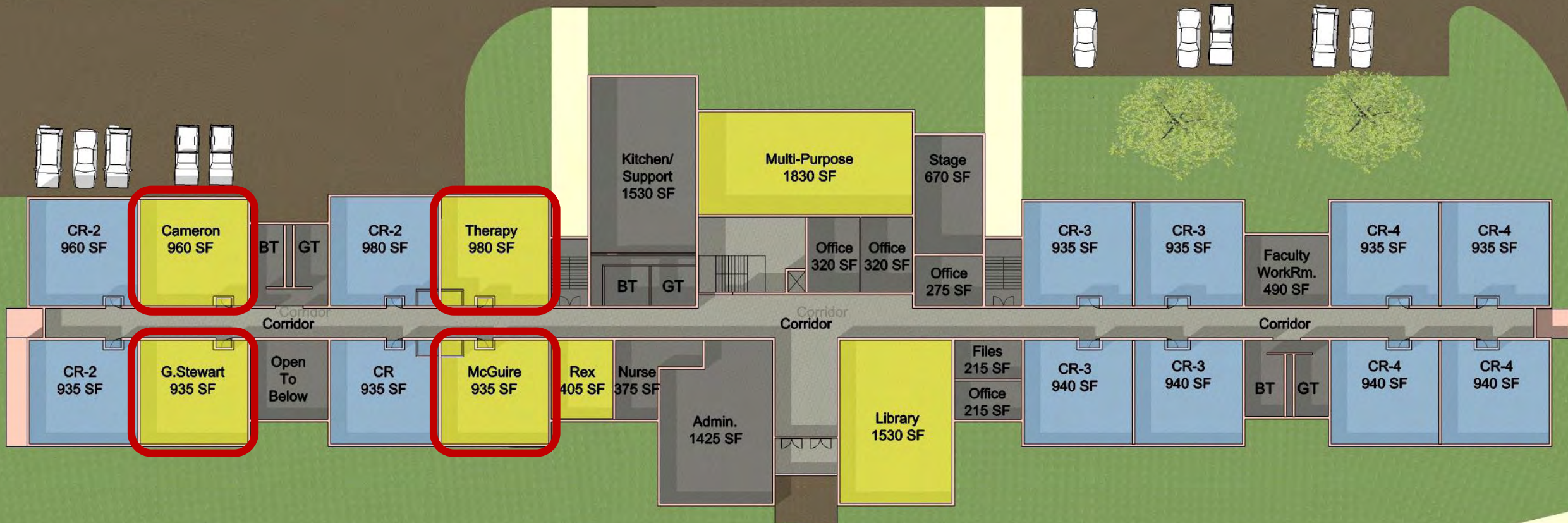

## Existing Classroom Usage

- 16 Classrooms
- 4 used for Special Education

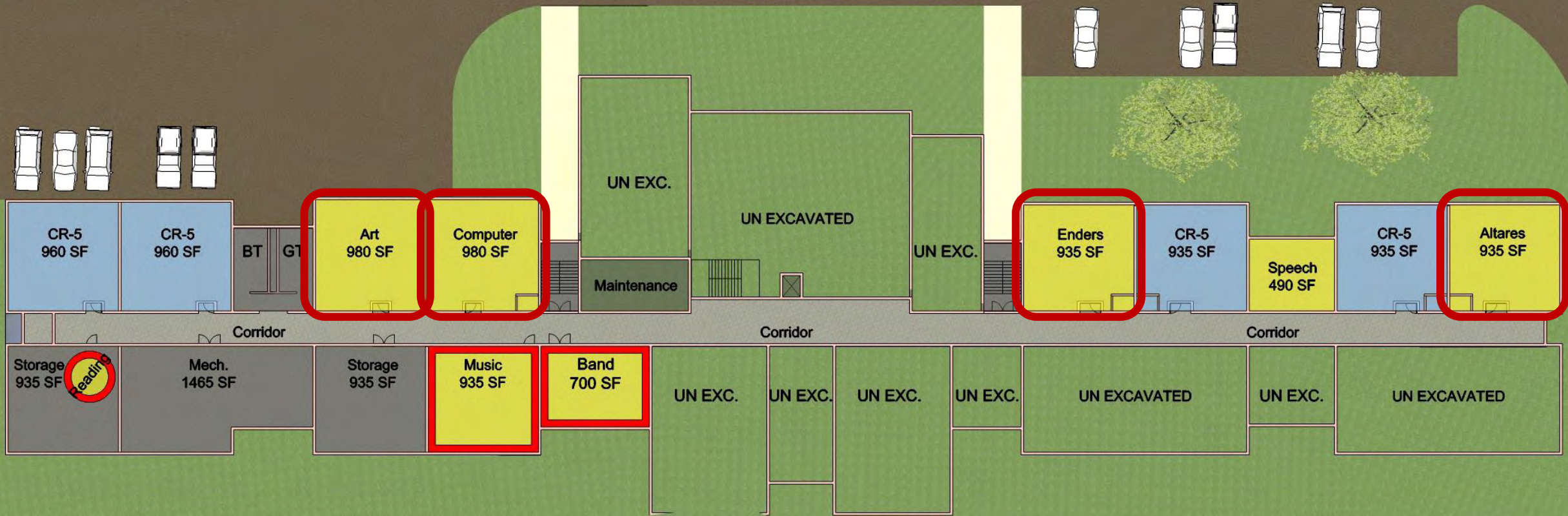

## Existing Classroom Usage

- 8 Classrooms
- 2 used for Special Education
- 2 used for Art and Technology

## Existing Classroom Usage

- 24 Total Classrooms in School
- 6 used for Special Education
- 2 used for Art and Technology

• 16 General Education Classrooms  
4 classrooms per grade (2-5)

• Class sizes average is 20 kids

- 2-1/2 classrooms per grade (K-5)
- Class sizes would range from 30 to 38 kids per classroom

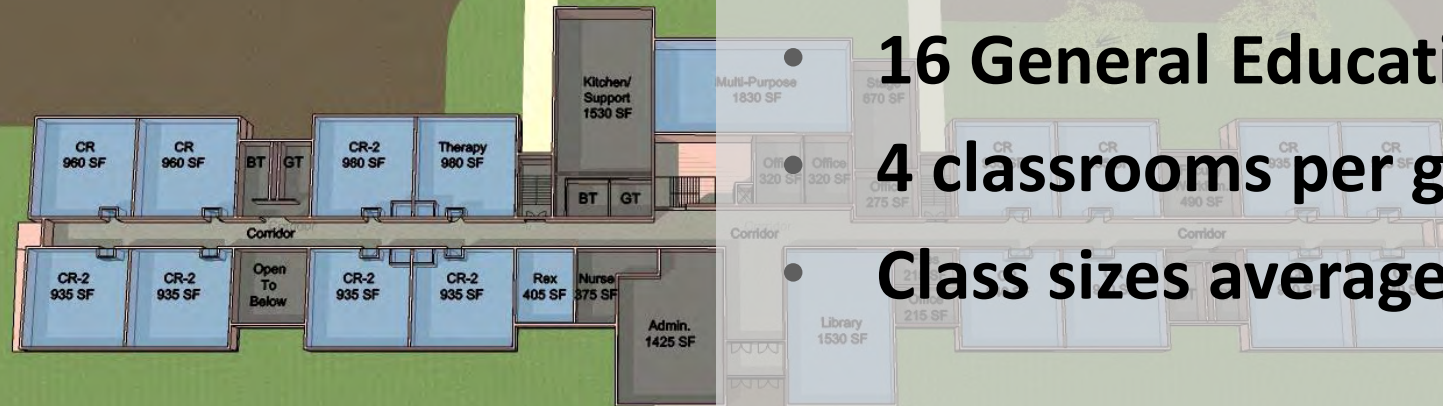



SCHOOL STREET



## Halifax Expansion Summary

- Limited area to expand
- Elongates existing school further
- Does not include all desired educational program
- No ability to expand in the future
- Doesn't solve vehicular safety concerns
- Major renovation while kids are in the school

# Halifax New Building Summary

- Limited area to expand to build new school
- Forced to create another long and straight layout
- Difficult construction phasing

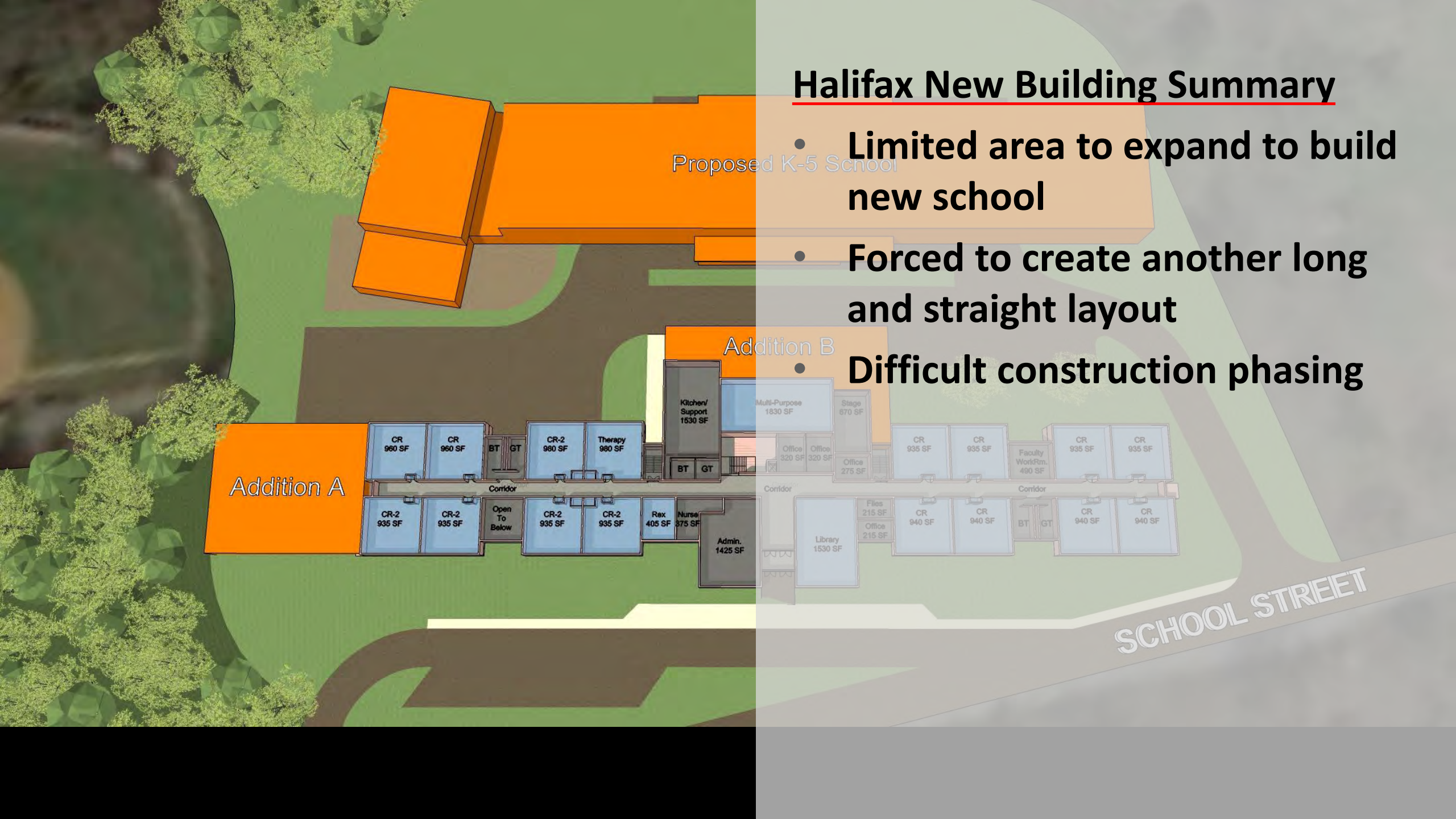

Renovate Enders ES (K-1) = \$8.3 M

Renovate Halifax ES (2-5) = \$15.7 M

**Total Both Projects = \$24 M**

**Expand Enders ES (K-5) = \$24 M**

**Expand Halifax ES (K-5) = \$21.2 M**

**New Building (Halifax Site) (K-5) = \$25.5 M**

**New Building (Alternative Site) (K-5) = \$?M**

HALIFAX  
ELEMENTARY SCHOOL

SITE AREA =  
25 ACRES

ATHLETIC  
FIELDS

HALIFAX AREA MIDDLE SCHOOL  
AND HIGH SCHOOL

kcb Architects



Halifax Elementary  
Halifax Area School District  
Halifax, Pennsylvania

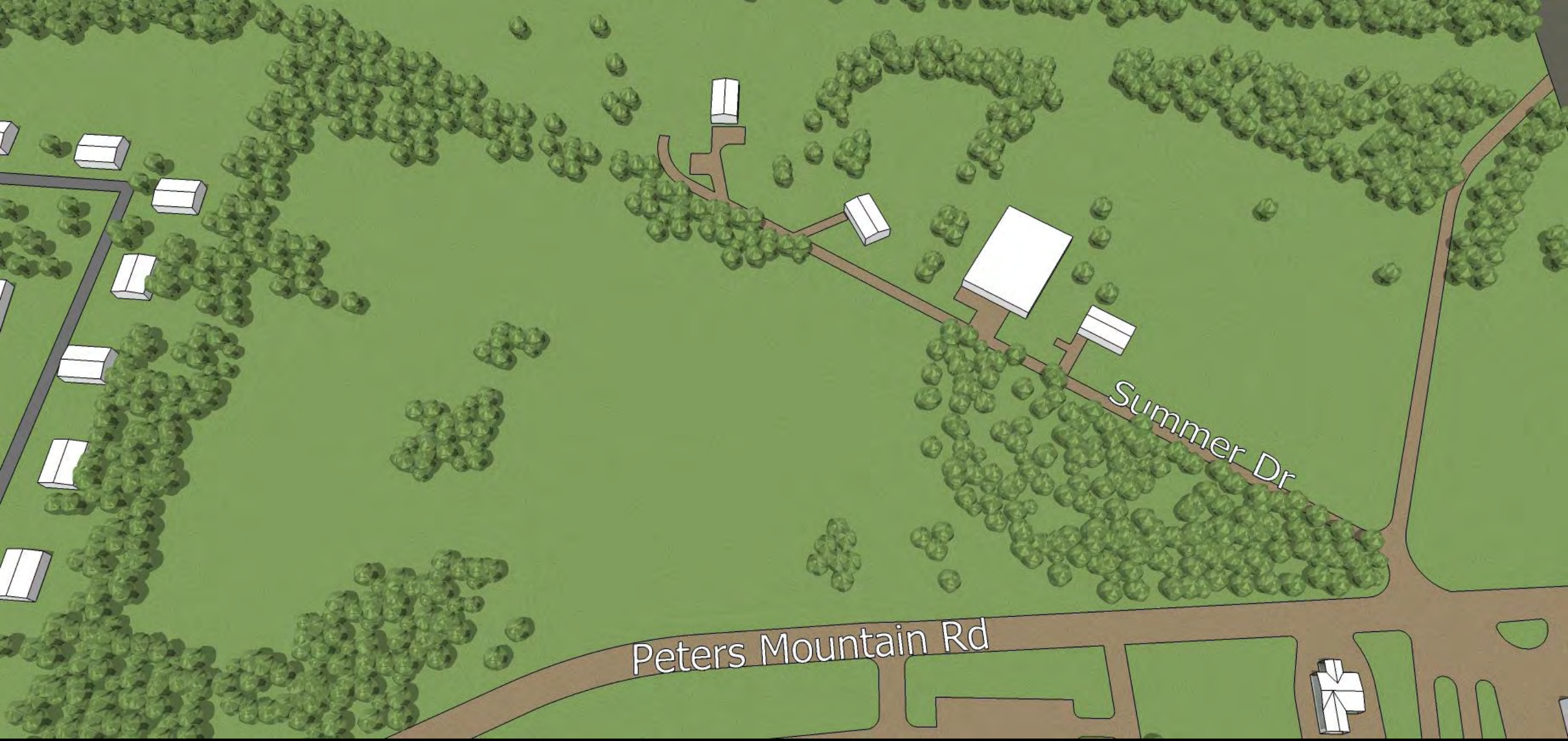

Peters Mountain Rd

Summer Dr

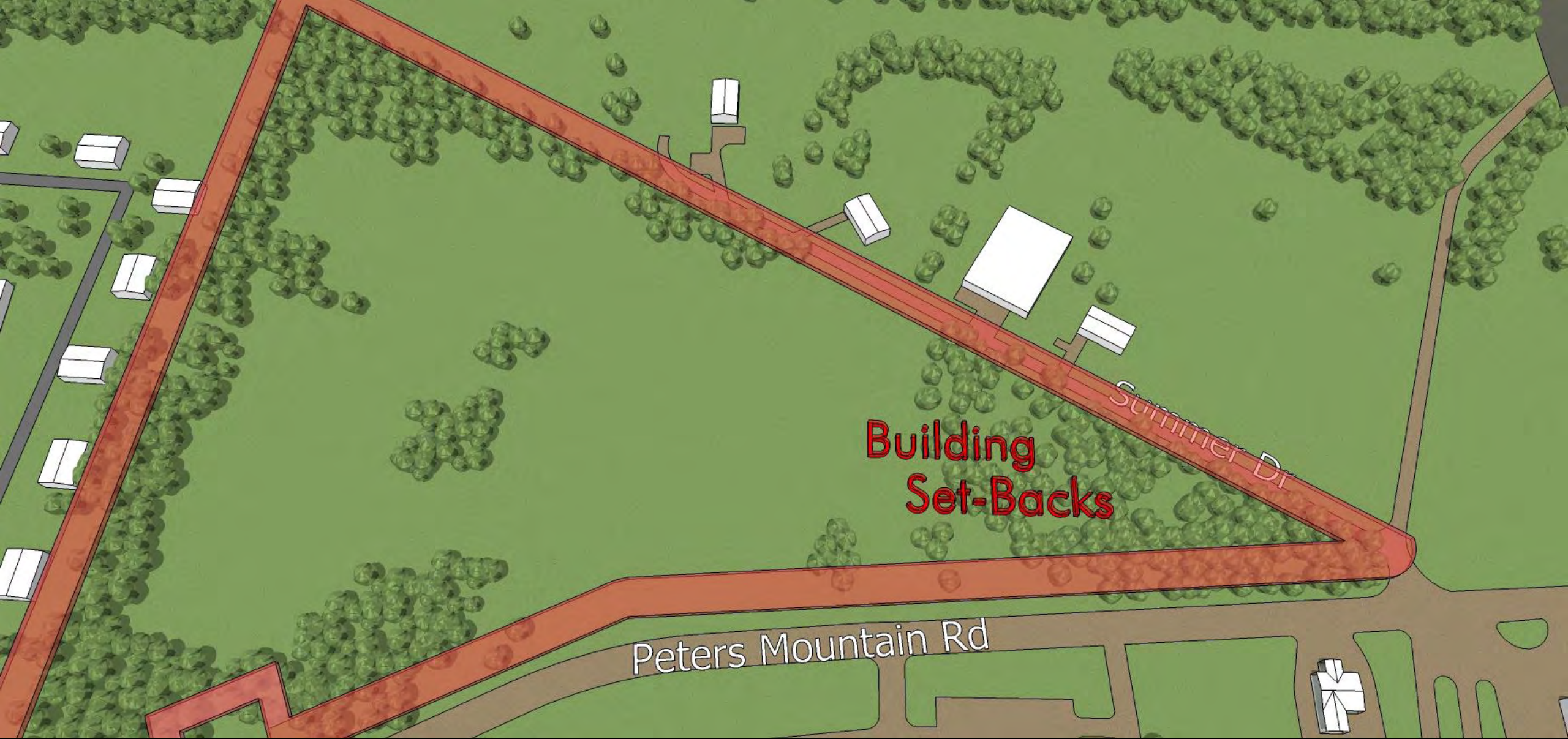

**Building  
Set-Backs**

Peters Mountain Rd

Summer Dr

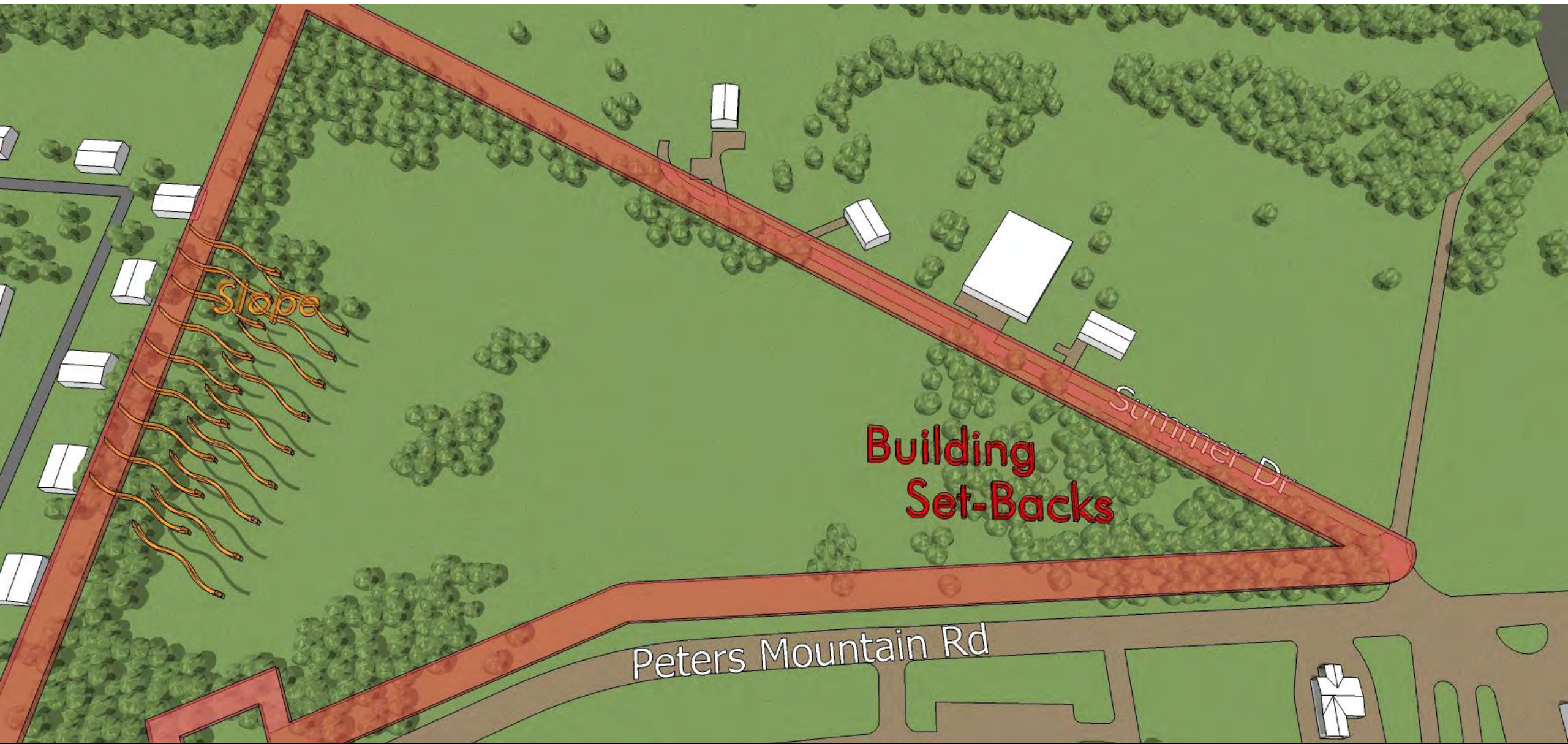

Slope

Building Set-Backs

Summer Dr

Peters Mountain Rd

Academics

Play  
Fields

Community

Car

Bus



Play  
Fields

Academics

Bus

Community

Academics

Car

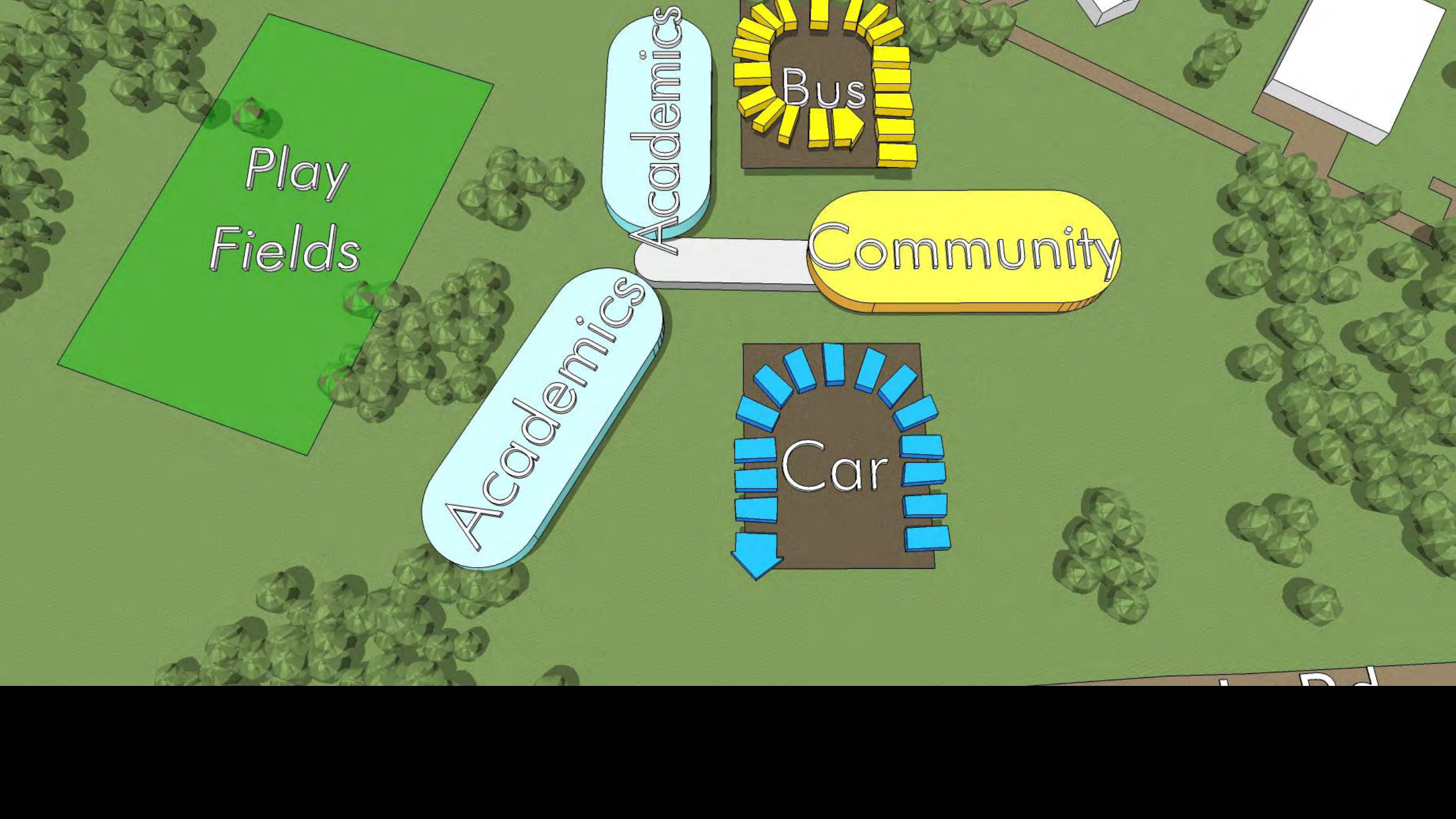

Play  
Fields

Academics

Bus

Community

Academics

~~Entry~~

Car



Play  
Fields

Academics

Bus

Community

Admin

~~Entry~~

Academics

Car



Play  
Fields

3rd - 5th  
Grade



Community

Kindergarten  
- 2nd Grade

Pre-K



Admin



Play  
Fields

3rd - 5th  
Grade

Bus

Community

Literacy  
Center Admin

Kindergarten  
- 2nd Grade

Entry

Pre-K

Car

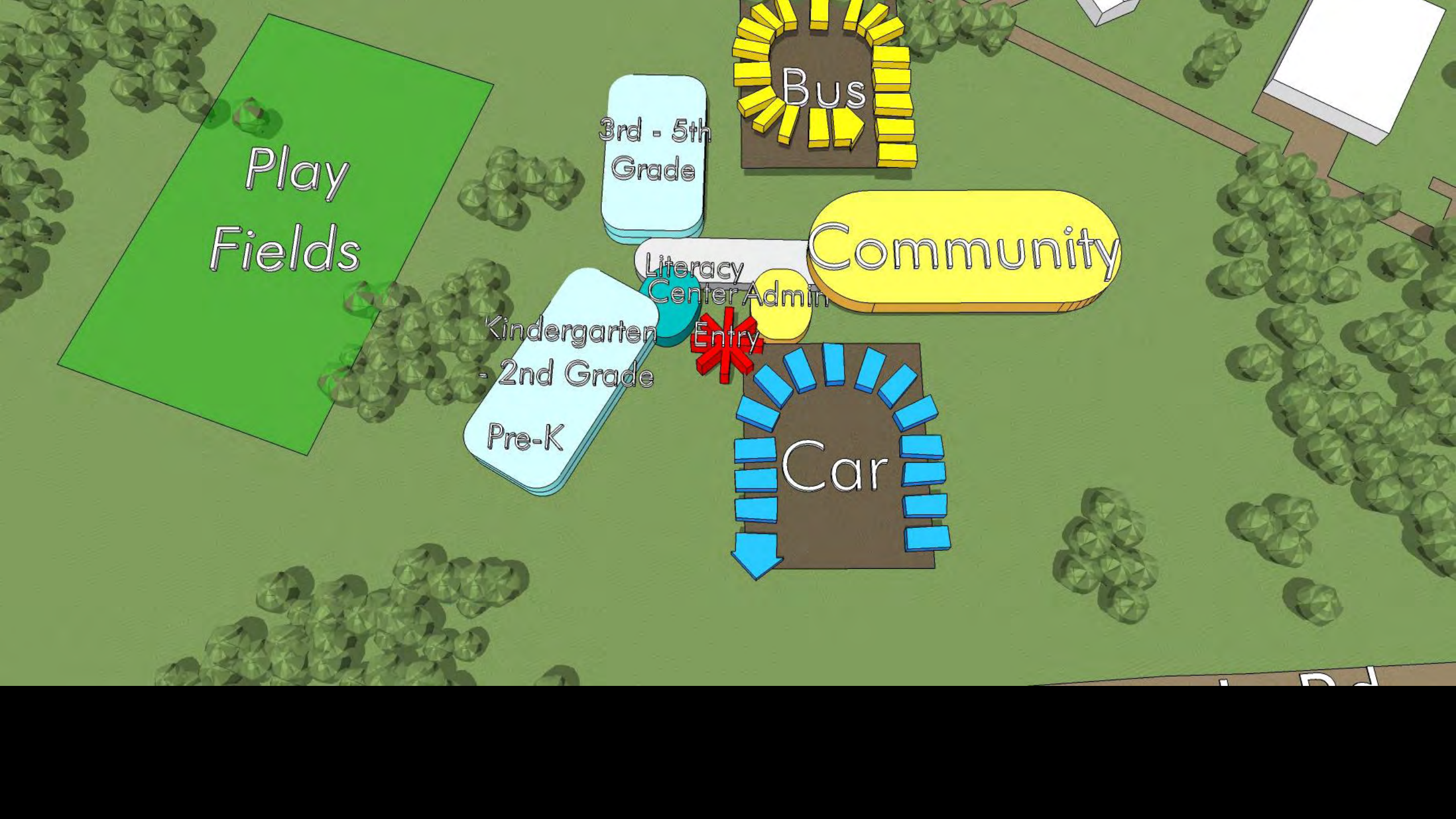

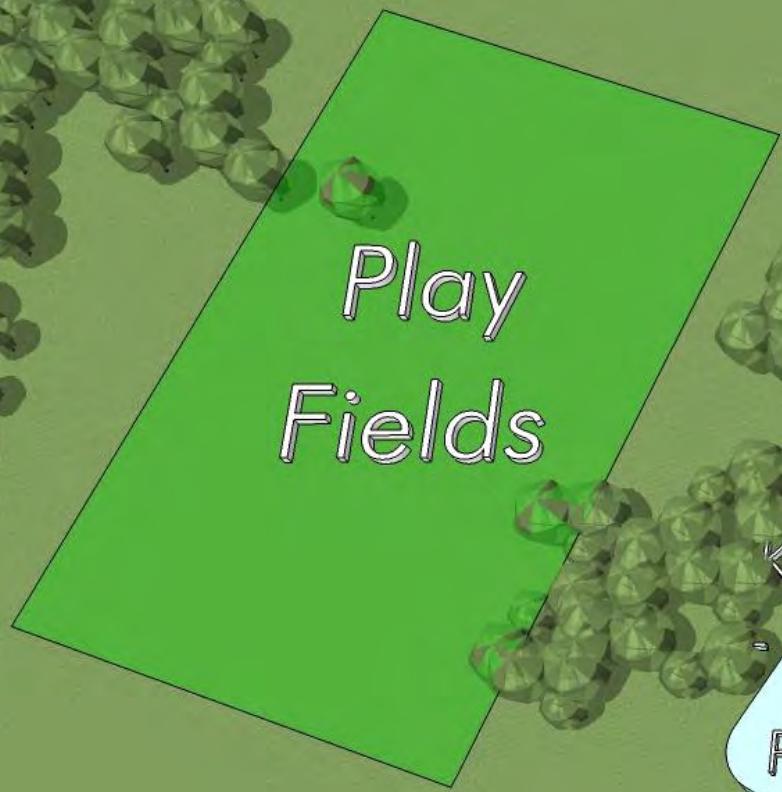

3rd - 5th  
Grade

STEM

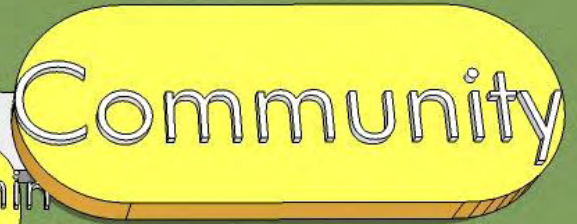

Music  
& Art

Literacy  
Center Admin



Kindergarten  
- 2nd Grade

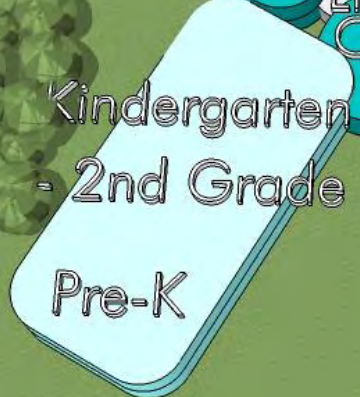

Car

... D ...

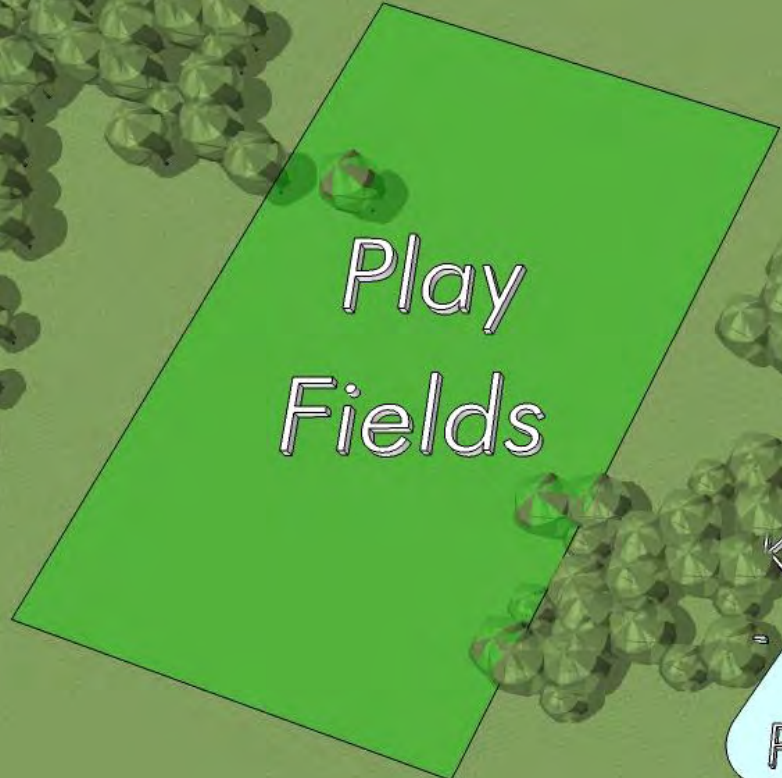

Play  
Fields



Pre-K

Kindergarten  
- 2nd Grade

3rd - 5th  
Grade

Music  
& Art

STEM

Literacy  
Center

Entry



Bus

Multi-  
Purpose

Stage



Car



Cafe/  
Kitchen Service

Admin

... D ...



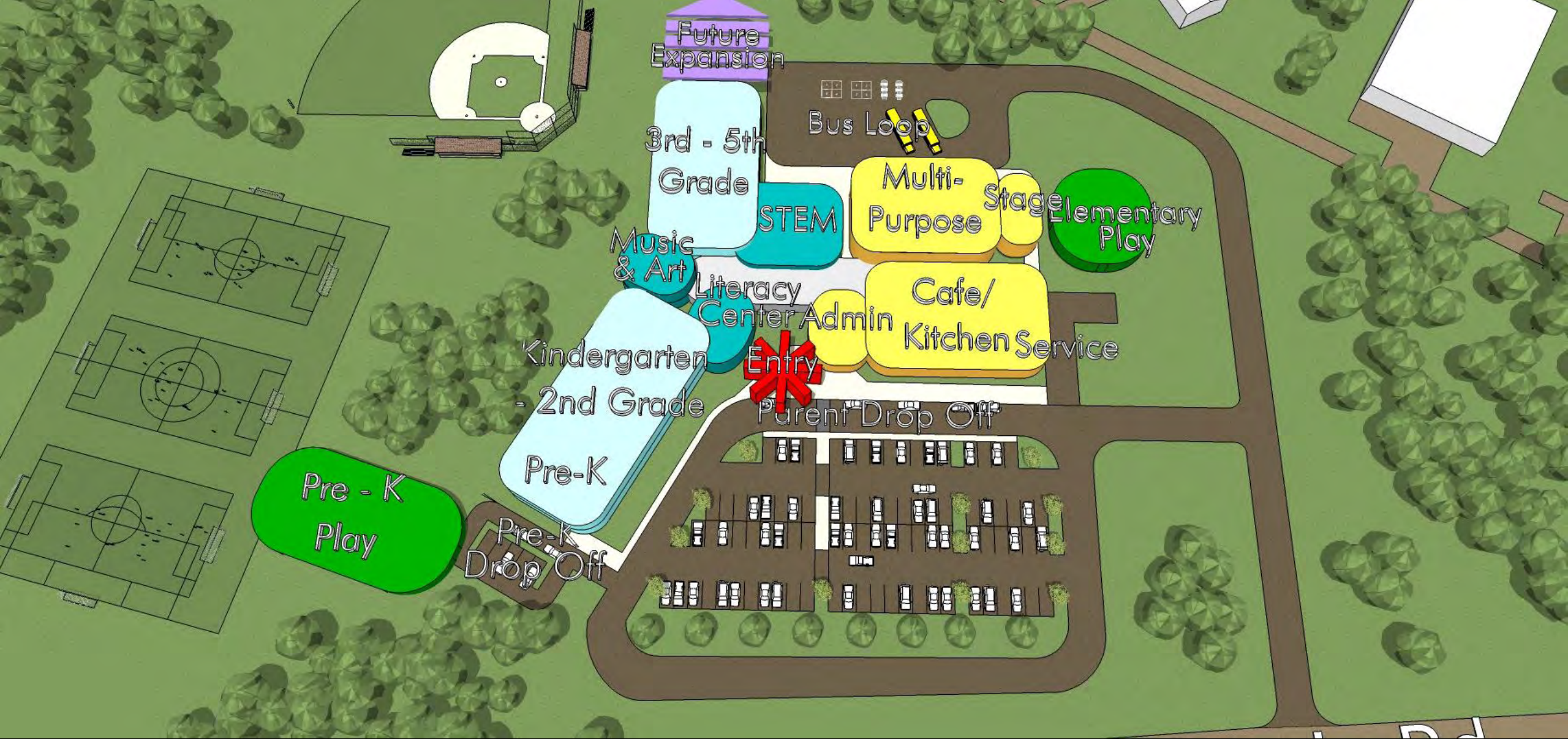

Future Expansion

Bus Loop

3rd - 5th Grade

Multi-Purpose

Stage

Elementary Play

STEM

Music & Art

Literacy Center

Admin

Cafe/  
Kitchen Service

Kindergarten - 2nd Grade

Entry

Parent Drop Off

Pre-K

Pre - K Play

Pre-k Drop Off

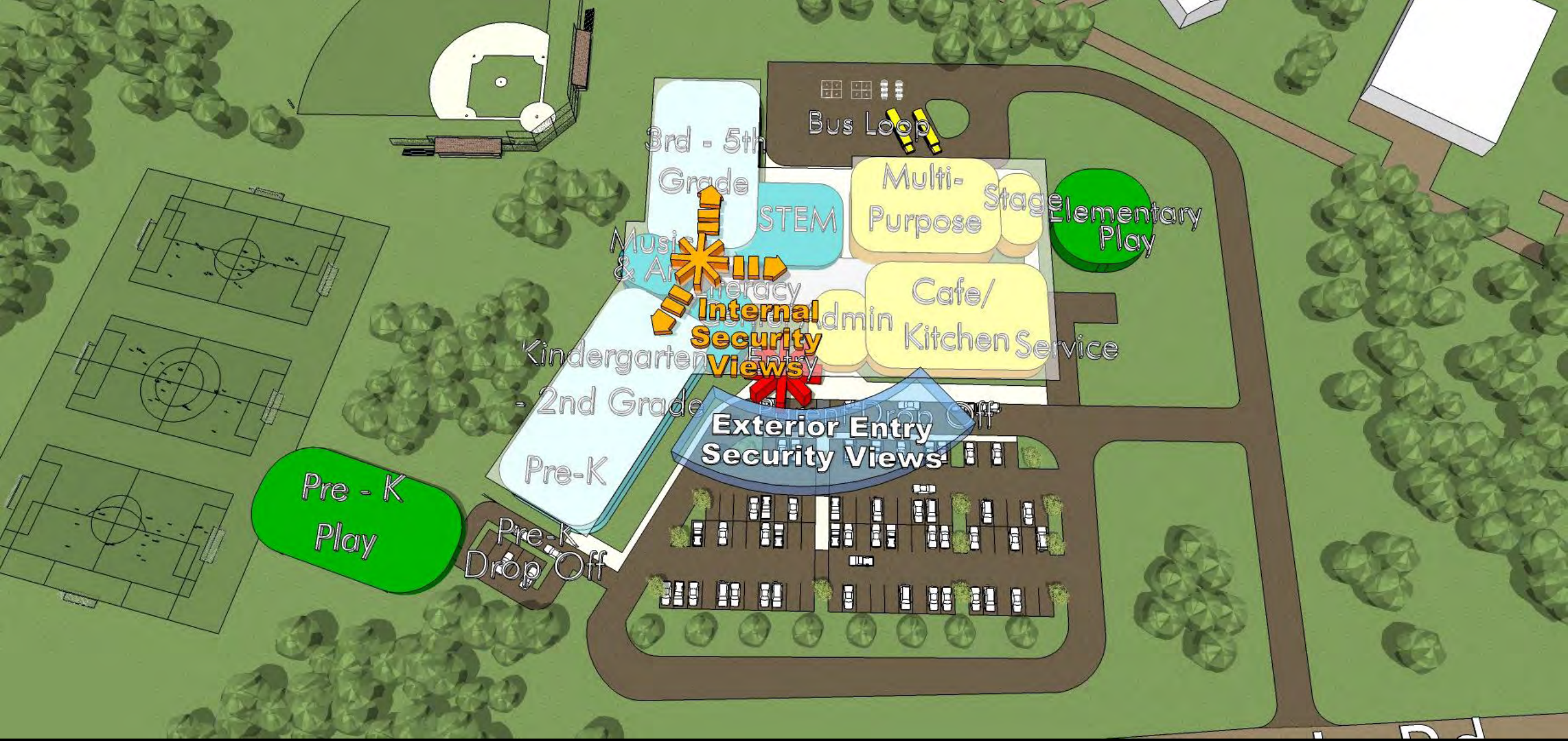

3rd - 5th  
Grade

Bus Loop

Multi-  
Purpose

Stage

Elementary  
Play

STEM

Music  
& Art

Internal  
Security  
Views

Admin

Cafe/  
Kitchen

Service

Kindergarten

2nd Grade

Exterior Entry  
Security Views

Drop Off

Pre-K

Pre - K  
Play

Pre-k  
Drop Off



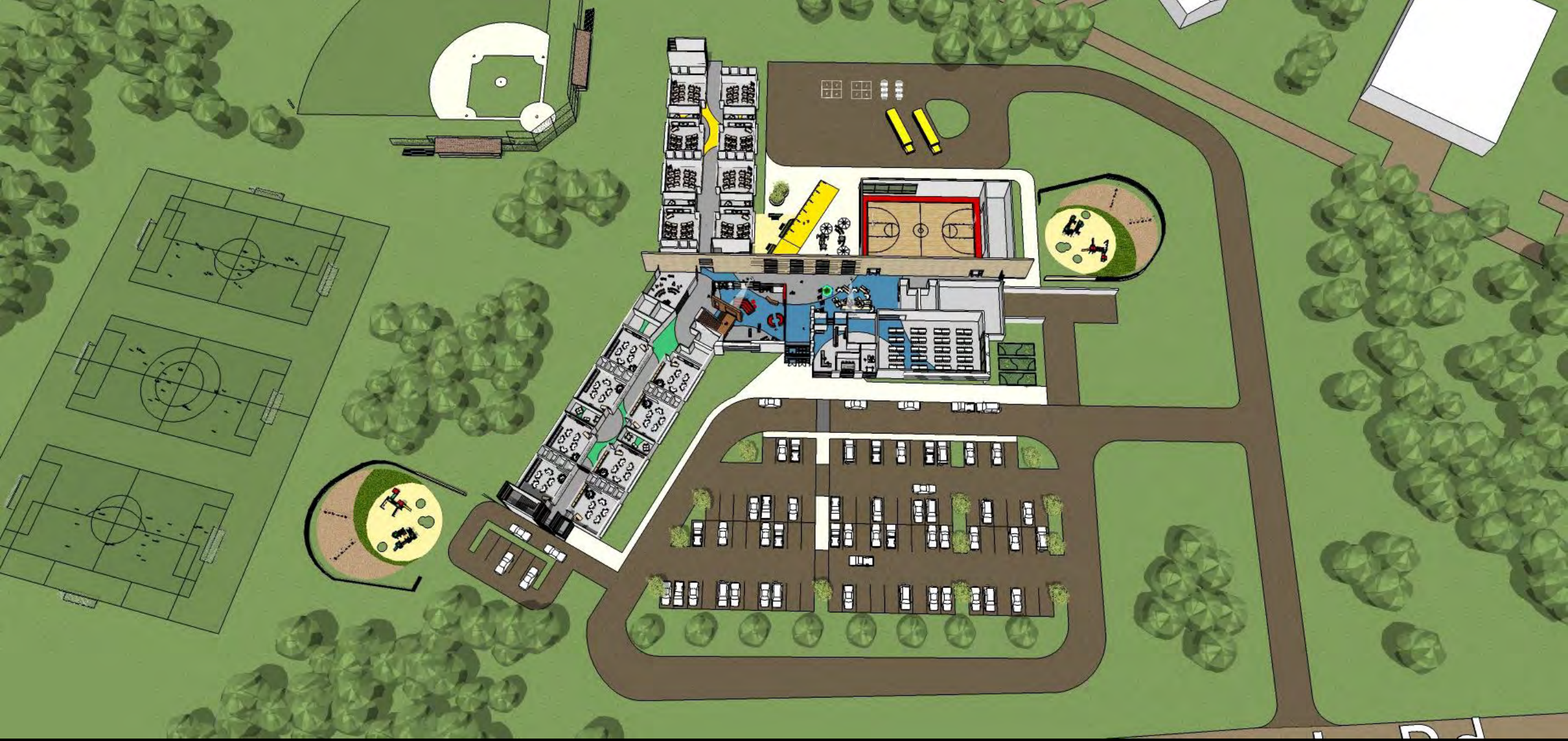

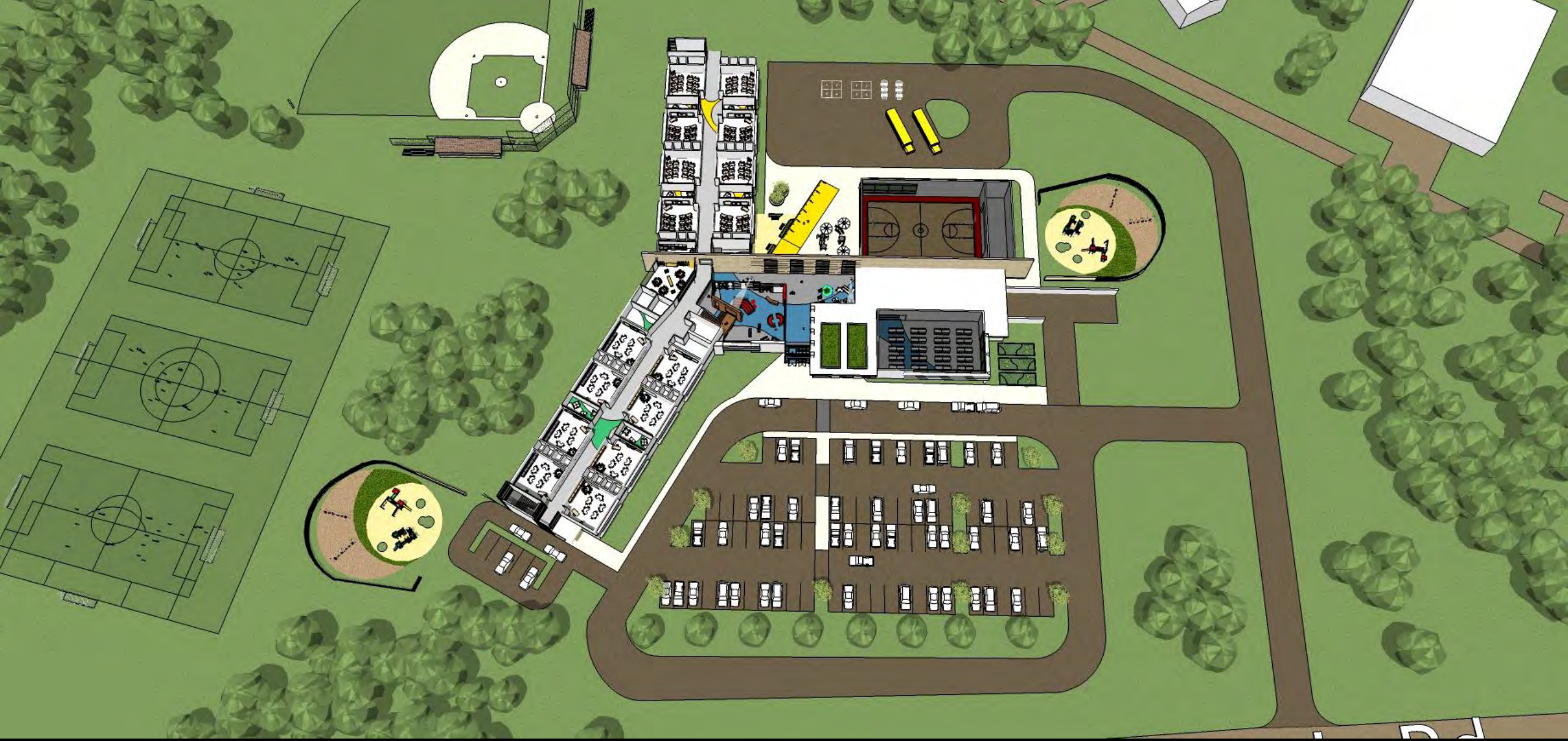



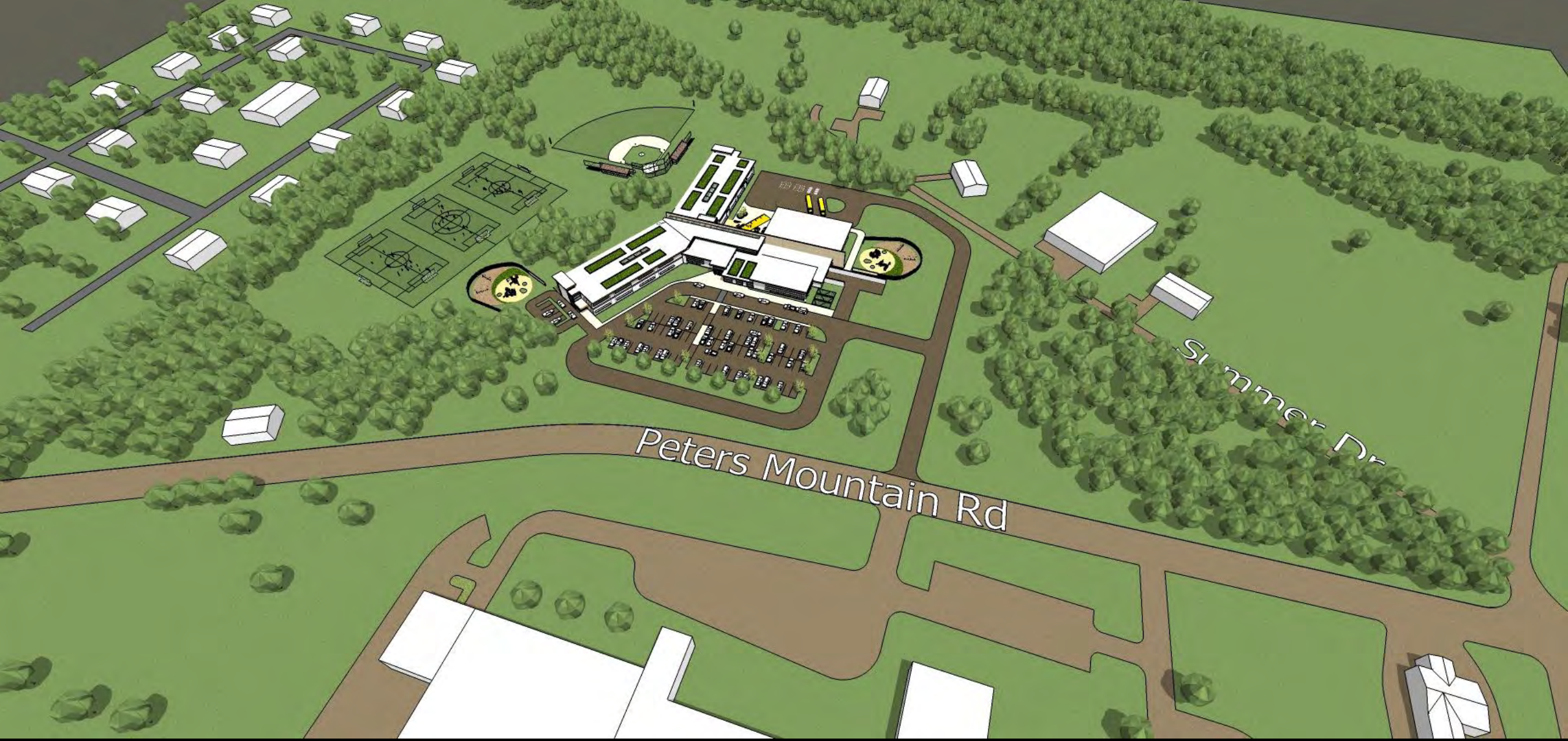

Peters Mountain Rd

Summer Dr

Renovate Enders ES (K-1) = \$8.3 M

Renovate Halifax ES (2-5) = \$15.7 M

**Total Both Projects = \$24 M**

Expand Enders ES (K-5) = \$24 M

Expand Halifax ES (K-5) = \$21.2 M

New Building (Halifax Site) (K-5) = \$25.5 M

**New Building (Alternative Site) (K-5) = \$26.5M**



education



bus



pedestrian

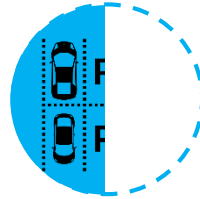

parking

**Expand Halifax ES (K-5) = \$21.2 M**

24 months



education



bus



pedestrian



parking

**New Building (Halifax ES Site) (K-5) = \$25.5 M**

30 months



schedule

**New Building (Alternate Site) (K-5) = \$26.5 M**

18 months

# NEW ELEMENTARY SCHOOL HALIFAX AREA SCHOOL DISTRICT

ACTION	2018												2019			
	JAN.	FEB.	MAR.	APR.	MAY	JUN.	JUL.	AUG.	SEPT.	OCT.	NOV.	DEC.	JAN.	FEB.	MAR.	APR.
<b>PLANNING PHASE</b>	← duration of 2 months bi-monthly meetings →															
Building Project Committee meets to discuss the project and to review priorities and design options																
<b>SCHEMATIC DESIGN PHASE</b>	← duration of 3 months bi-monthly meetings →															
Programming workshops Sustainability goals setting Site and building concepts Conceptual educational layouts Safety/security design review Budget analysis	<b>Public Presentation</b> 															
<b>DESIGN DEVELOPMENT PHASE</b>	← duration of 3 months bi-monthly meetings →															
Coordination with administrative departments Sustainability workshops Building systems selection Fit-out classrooms and common spaces Detailed site and building layout Safety/security design review Budget analysis First public presentation	<b>Public Presentation</b> 															
<b>CONSTRUCTION DOCUMENTS PHASE</b>	← duration of 5 months bi-monthly meetings →															
Value engineering Constructability reviews BIM project documentation Review bidding strategies Safety/security design review Budget analysis Act 34 hearing							<b>Public Presentation</b> 									
<b>BIDDING</b>	← duration of 3 months meet as needed →															
Construction Documents out for bidding Receive bids and award contracts							<b>Public Presentation</b> 		<b>Public Presentation</b> 							



**A/E TEAM**  
KCBA Architects  
MEP Engineer  
Acoustics Consultant  
Kitchen Consultant



**CONSTRUCTION CONSULTANTS**  
Construction Manager  
District Solicitor  
Civil Engineer



**BUILDING PROJECT COMMITTEE**  
School Board  
Dr. Michele Orner, Superintendent  
New Elementary School Principal  
Business Manager  
Director of Operations  
Other individuals identified by district



**END USERS**  
New Elementary School Principal  
New Elementary School Faculty and Teachers  
District Administrative Departments:  
Food Service, Transportation, IT, Security, Maintenance  
New Elementary School students

# DISCUSSION

