



USD 330
Mission Valley

Master Planning

HTK 
ARCHITECTS



AGENDA

INTRODUCTION

MISSION STATEMENT:

Mission Valley School District is dedicated to providing a safe, orderly learning environment in which to direct and assist students as they prepare for a fulfilling and productive life.

DISTRICT ASSESSMENT

EXPLORE OPTIONS

FUNDING

QUESTIONS?



INTRODUCTION



MISSION STATEMENT:

Mission Valley School District is dedicated to providing a safe, orderly learning environment in which to direct and assist students as they prepare for a fulfilling and productive life.

| COMMITTEE PURPOSE

- **Chart a direction**
- **Provide community perspective**
- **Prioritize needs**
- **Be informed**
- **Share positive, accurate information**
- **Ask Questions**

MEETINGS

- October – District Survey
- November 8 – Board Approved Starting Master Plan
- December 1 – District Leadership
22 – Field Review with Engineer
- January 4 – Staff Interviews
5 – District Leadership
26 – Committee – Review Facility Assessment
- February 16 – Committee – Options
- March 9 - Committee – Review
14 - Board Meeting – Recommendation
30 – Committee – TBD
- April 11 – Board Meeting
- May 9 – *Board Resolution of Bond
- August 2 – *Bond Election

COMMITTEE FEEDBACK

1. In your opinion, what are the greatest facility needs?

Committee

1. Career & Technical Education
2. Athletic Facilities
3. Infrastructure Upgrades
4. Security Upgrades
5. HS Upgrades

October District Survey

1. Athletic Upgrades
2. CTE
3. Infrastructure Upgrades
4. 7-12 Classroom Upgrades
5. Security Upgrades

| COMMITTEE FEEDBACK

2. *What will the community see as greatest need?*

Community

1. Career & Technical Education, CTE
2. Athletic Facilities
3. HS Upgrades
4. Infrastructure Upgrades
5. Community Center
6. School facility for education and athletics
7. Code Compliance
8. ROI to community / landowner

| COMMITTEE FEEDBACK

3. What will be the biggest challenge moving forward?

1. People & Bond Issue Communication (all groups)
2. Money / Budget / Mill Levy / Taxes
3. Housing and bringing people here.
4. Deciding priority of upgrades

FEEDBACK

Building Committee

•Responses:

1 IYO, what are the three greatest facility needs?	1	2	3	4	5	6	Additional Comments:
Career, Technical Ed Facilities	X	X	X	X	X	X	Flexibility: Ag (Greenhouse, Ventilation), Business, FCS, STEM, Technology(IT) Indoor/outdoor facilities. Track & Field, Baseball, Softball, Football practice field. Internet and Phone
Athletic Facilities	X	X	X	X	X	X	
Mechanical/Plant/Electrical/IT Improvements	X	X	X	X	X	X	
Security		X					
HS		X					
2 What will the community see as the greatest need?							
Community Center	X						Hub. Information. Job Ownership. Housing - where can people live. Development Electrial, Roofing
ROI to community/landowners	X						
School facilities for education and athletics	X						
Structural Systems/Building Upgrades		X			X		
Code Compliance		X					
CTE		X	X		X	X	
Athletic Upgrades		X			X		
HS			X			X	
3 What will be the biggest challenge moving forward?							
Money/Budget/Mill Levy/Taxes	X		X	X	X	X	Bond amount? Get bond info out to community. Advertise the positives. Explain issues/problems. Getting farmers,land owners,tax payers w/no kids on board. Bring people here.
People & Bond Issue Communications	X	X	X	X	X	X	
Housing	X						
Deciding priority of upgrades					X		
4 What surprised you tonight?							
Ag is more than shop, label bldg. appropriately.	X						Ag Ed Facilities
All the "needs" of the building	X				X		
Outdated H.S.		X	X			X	
Costs of Materials			X		X		
ES Heat Pump needs replaced					X		
Age of buildings						X	
5 What is one question you still have?							
Timeline?	X						How to promote and get ahead of the opposition? Remove items from discussion that are operational expenses
How to get more ppl involved/informed?	X			X			
\$\$\$ /Budget over 10M to cause ML increase?		X	X		X		
What if the bond doesn't pass?		X					
Separate operational expenses?				X			
Show problems						X	

DISTRICT ASSESSMENT



DISTRICT BOUNDARIES

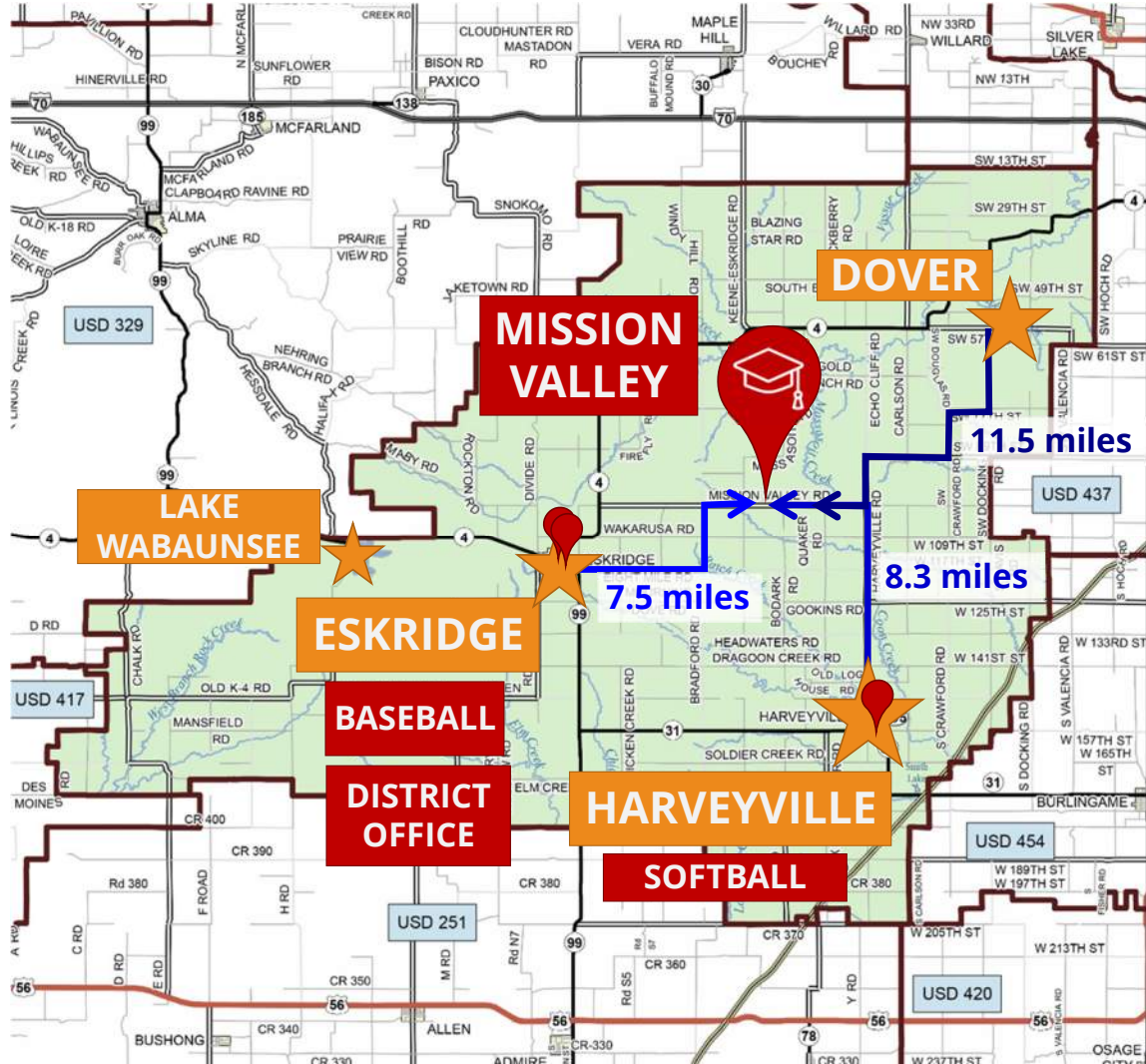

- **TOWNS** ★
 - Harveyville- 8.3 mi
 - Eskridge – 7.5 mi
 - Dover – 11.5 mi
 - Lake Wabaunsee
 - 372 square miles

- **FACILITIES** 📍
 - School Facility
 - District Office
 - Baseball Field in Eskridge
 - Softball Field in Harveyville

SITE LAYOUT

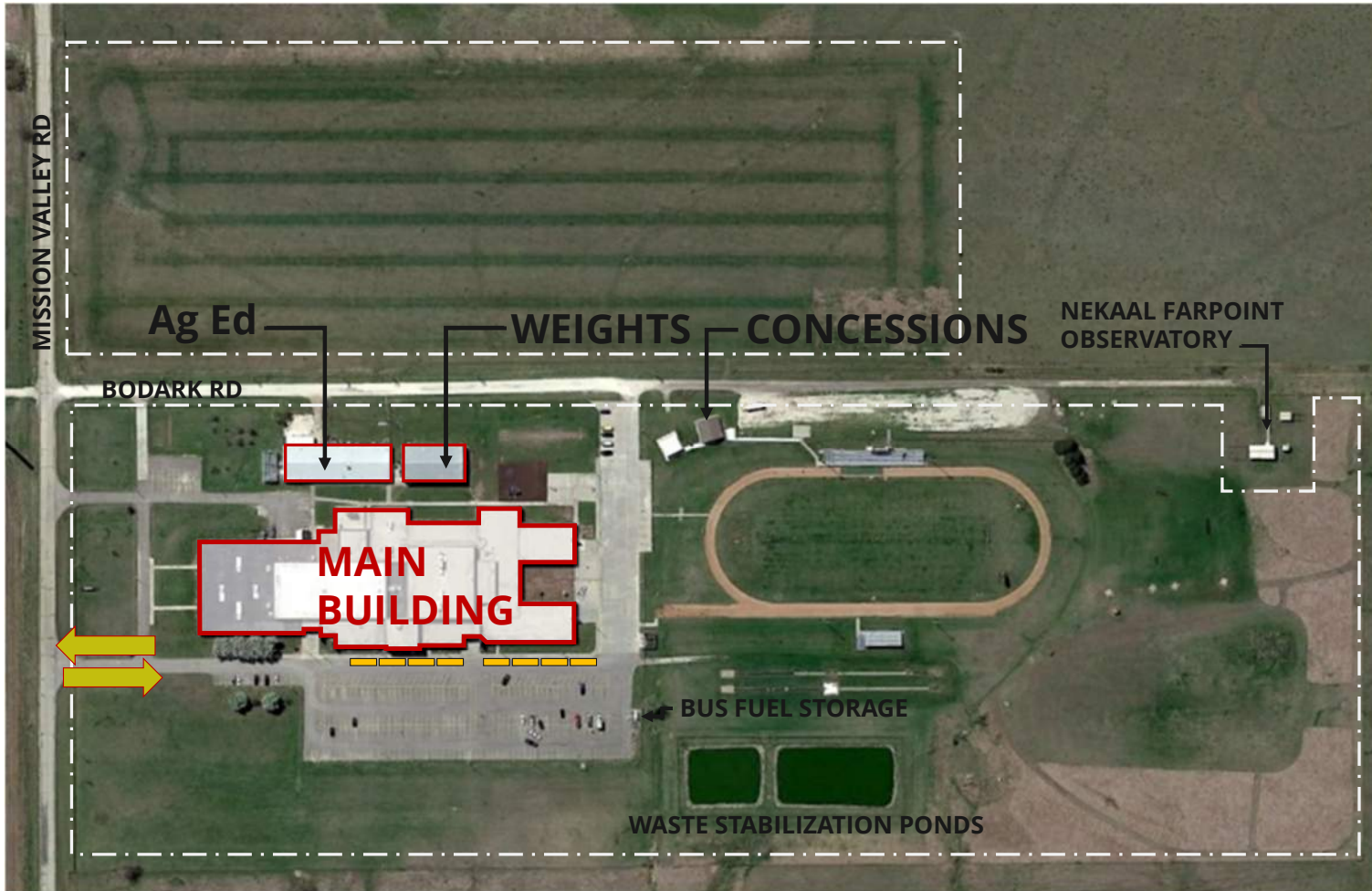

- **Property**
 - Property Line
 - Bus Circulation
 - Parking
 - Track
 - Pond
- **Buildings**
 - Main Building
 - Shop
 - Weights
 - Concessions
 - Storage
- **Site Needs**
 - Lighting
 - Signage
 - Paving
 - Bus Entry
 - Security

SCHOOL

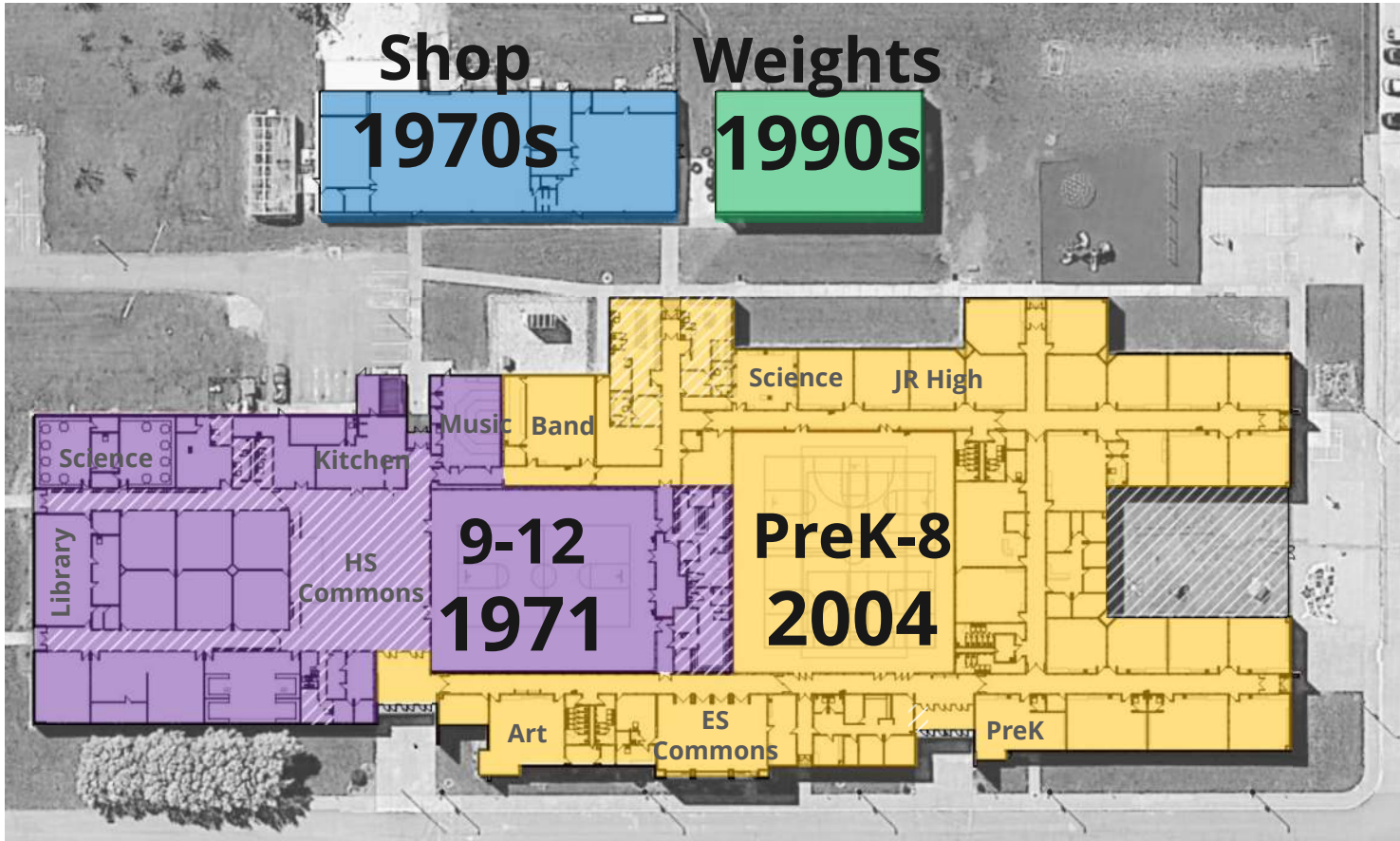

- **Mission Valley USD 330**
 - Flint Hills League
 - 447 students
 - 6 more than last yr
 - 28 less 10 yrs or
 - 63 less 20 yrs
 - 128,700 sf
 - 120 staff
- **HIGH SCHOOL 9-12**
 - 1971 = 51 yrs
 - 45,100 sf
 - Shop: 1970s +/- 50 yrs
 - 10,600 sf
 - Weights: 1990s +/- 30yrs
 - 6,000 sf
- **JR & ELEMENTARY SCHOOL PK-8**
 - 2004 - 18 yrs
 - 67,000 sf

PROGRAM & CHANGE IN USE

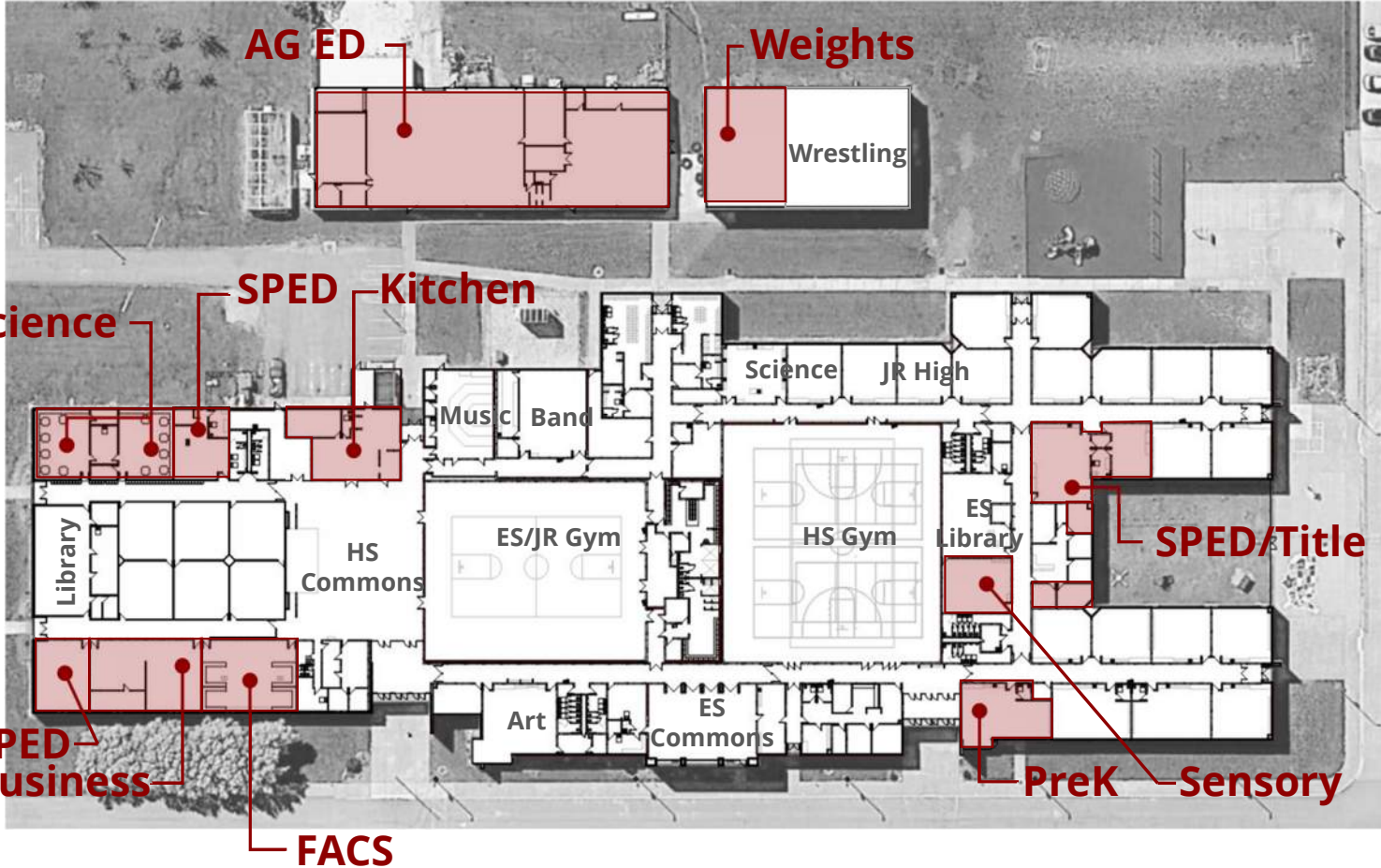

Programs

- Science
- SPED
- Kitchen
- SPED/Title
- Sensory
- PreK
- FACS
- Business
- SPED



HIGH SCHOOL

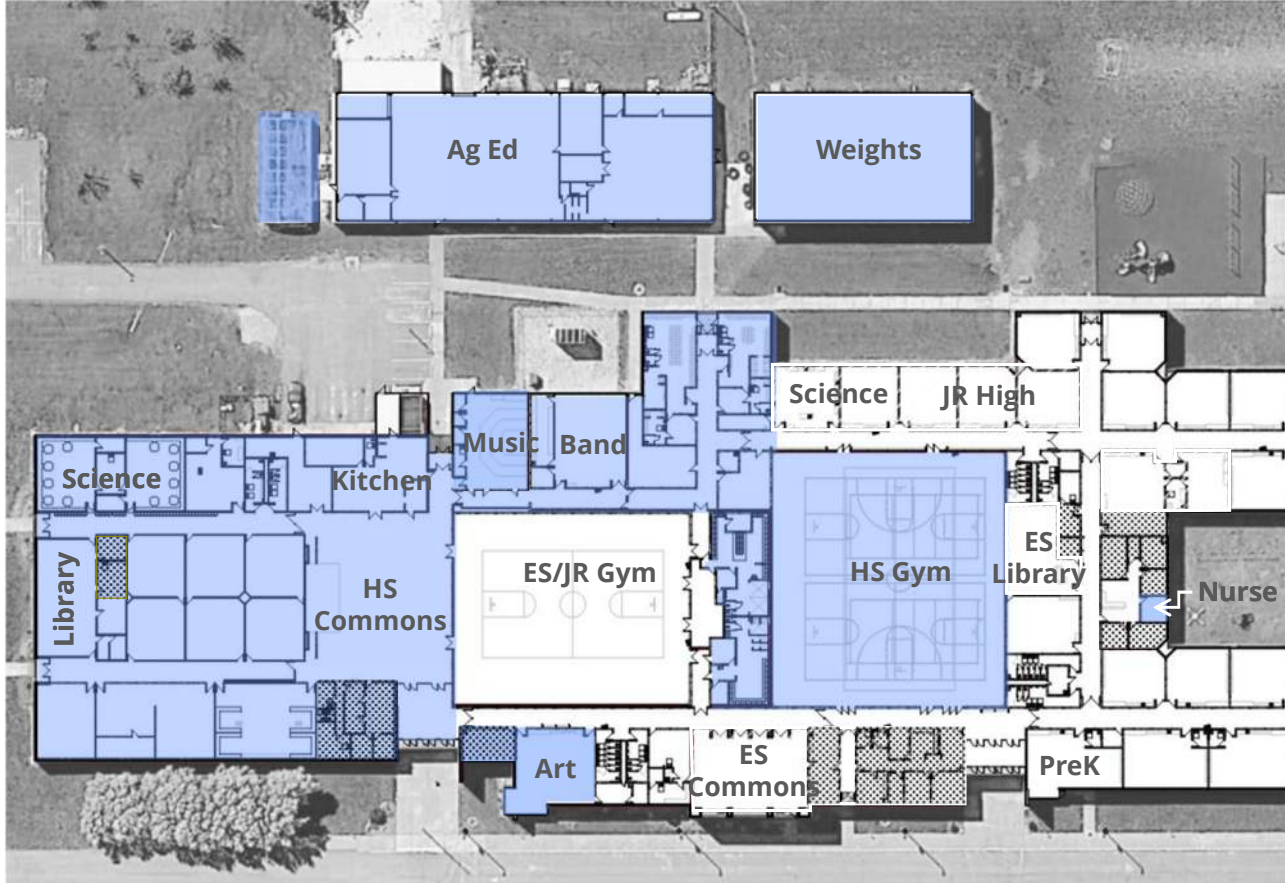

		High School
Facility Condition		
Building Envelope	Site	3
	Exterior Wall & Windows	2
	Building/Structural	4
Systems	Roofing	1
	Electrical	1
	HVAC	3
	Plumbing	3
	Technology	3
Interior	Phones/Intercom	1
	Flooring	1
	Walls	2
	Ceiling	3
	Casework	3
	Signage	2
	Asbestos	2
Security	Security	2
	Fire & Safety	2
Program/Space Condition		
Educational Support	Classrooms	2
	Collaboration Space	3
	Administration	1
	Media Center	2
	Special Education Needs	2
	Gymnasium	3
	Cafeteria	2
	Career & Training Education	2
	Science	2
	Student Restrooms	3
	ADA	3
	Athletics	2
	Storage	2
Facility Status Key: 1-2 Absent-Fail 3 Average 4-5 Excellent		



JR HS & ELEMENTARY

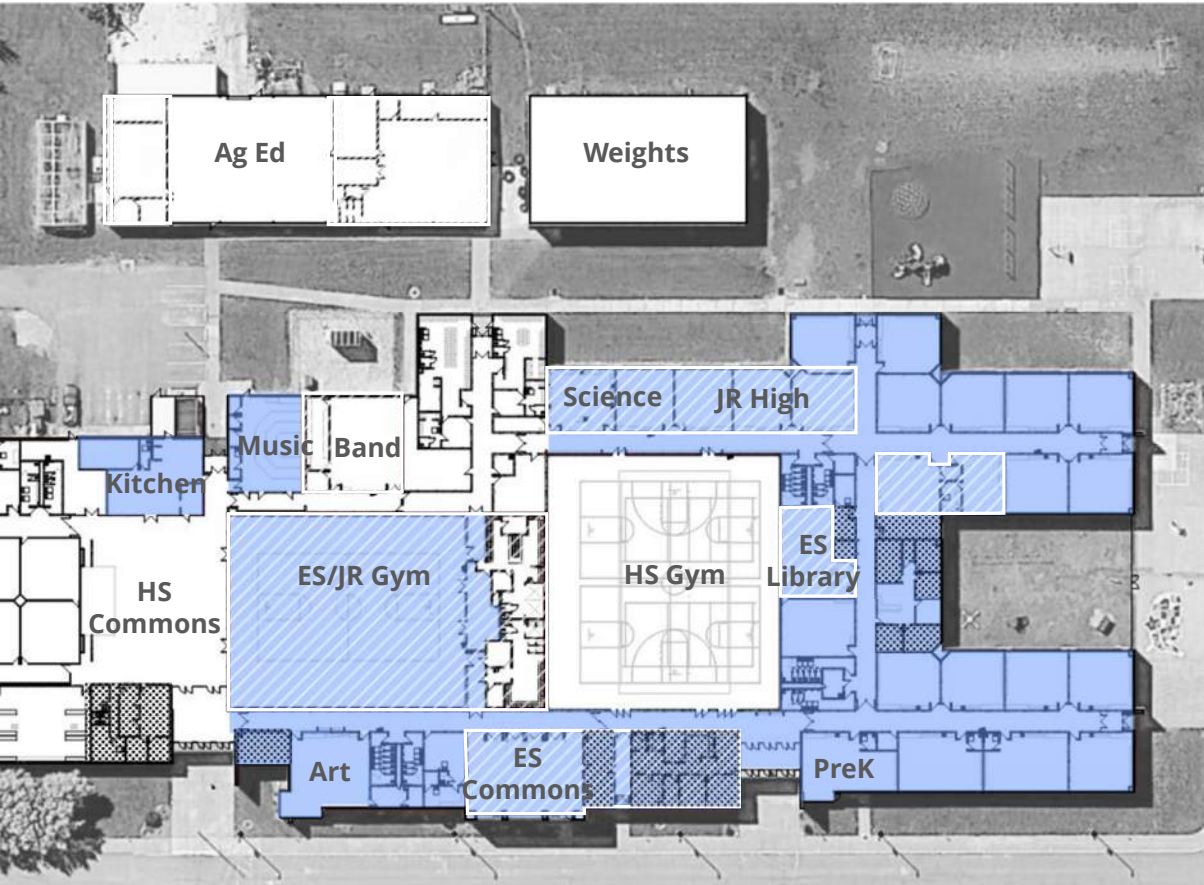

		Jr High	Elem School	
Facility Condition				
	Site	3	3	
Building Envelope	Exterior Wall & Windows	4	4	
	Building/Structural	4	4	
	Roofing	1	1	
Systems	Electrical	2	2	
	HVAC	2	2	
	Plumbing	4	4	
	Technology	3	3	
	Phones/Intercom	3	3	
Interior	Flooring	2	2	
	Walls	3	3	
	Ceiling	3	3	
	Casework	4	4	
	Signage	4	4	
	Asbestos	5	5	
	Security	3	4	
Fire & Safety	4	4		
Program/Space Condition				
	Classrooms	3	3	
	Collaboration Space	2	2	
Educational Support	Administration	2	2	
	Media Center	4	4	
	Special Education Needs	4	4	
	Gymnasium	3	3	
	Cafeteria	4	4	
	Career & Training Education	3	3	
	Science	4	4	
	Student Restrooms	3	3	
	ADA	4	4	
	Athletics	3	3	
Storage	2	2		
Facility Status Key:		1-2 Absent-Fail	3 Average	4-5 Excellent

EXPLORE OPTIONS



COMMITTEE FEEDBACK

1. In your opinion, what are the greatest facility needs?

Committee

1. Career & Technical Education
2. Athletic Facilities
3. Infrastructure Upgrades
4. Security Upgrades
5. HS Upgrades

October District Survey

1. Athletic Upgrades
2. CTE
3. Infrastructure Upgrades
4. 7-12 Classroom Upgrades
5. Security Upgrades

PRIORITIZE NEEDS

Facility Needs

1. Career & Technical Education:

- may included Ag Ed, Business & FACS

- Base - Renovate Existing: \$2.6M - \$3M

- Rec. - Renovation + Build New: \$4.375M

- Add. – All New Construction: \$6.5M

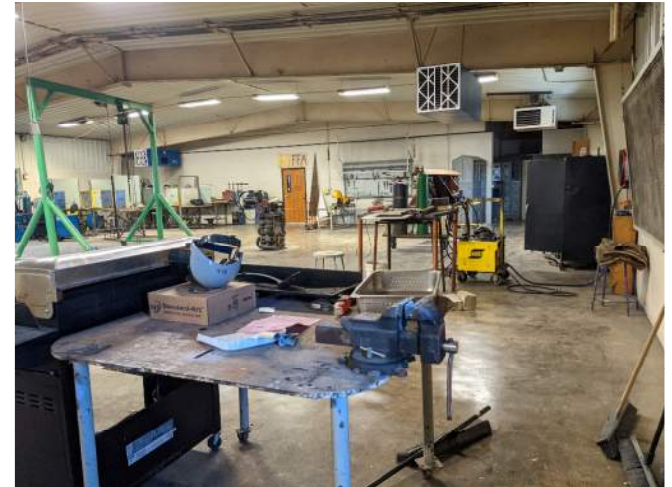

1. CTE – Base Scope

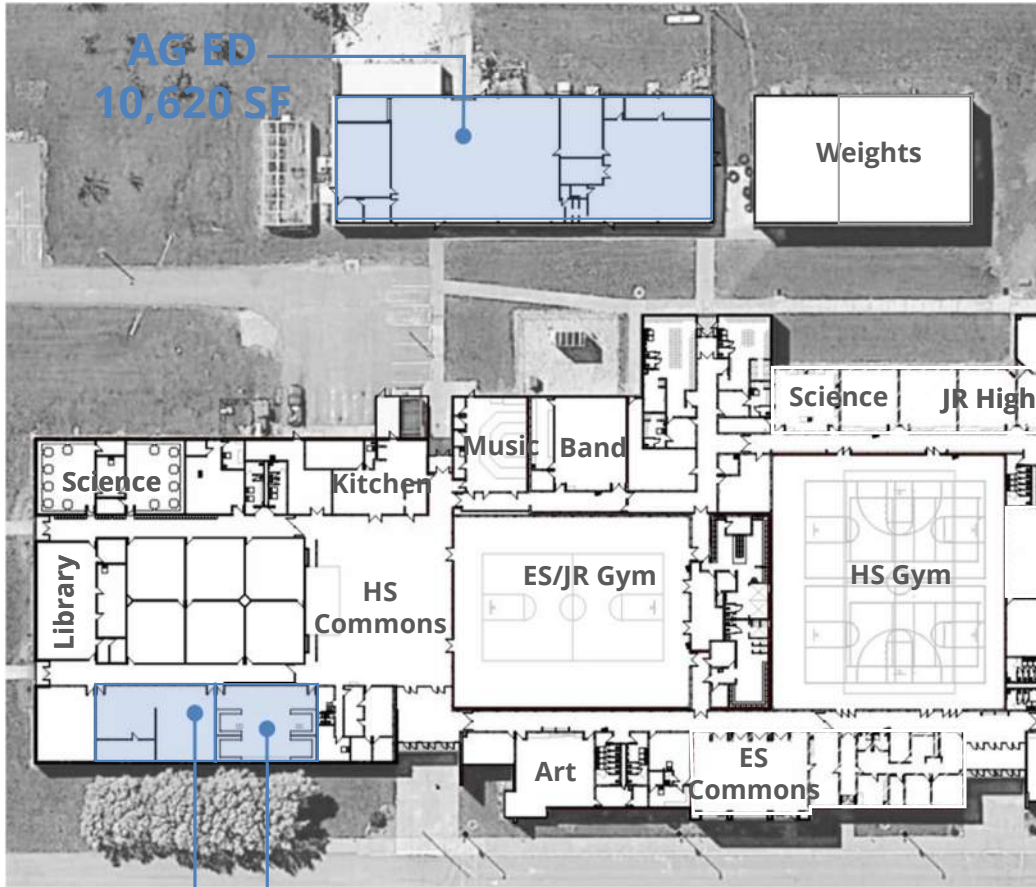

- **RENOVATE - \$2.6 - \$3M**

- Ag Ed: \$1.5 - \$2M
- FACS: \$312,000
- Business: \$375,000

- **NEW CONSTRUCTION**

- **RENO + NEW CON**

Business
1,887 SF

FACS
1,610 SF

1. CTE – Additional Scope

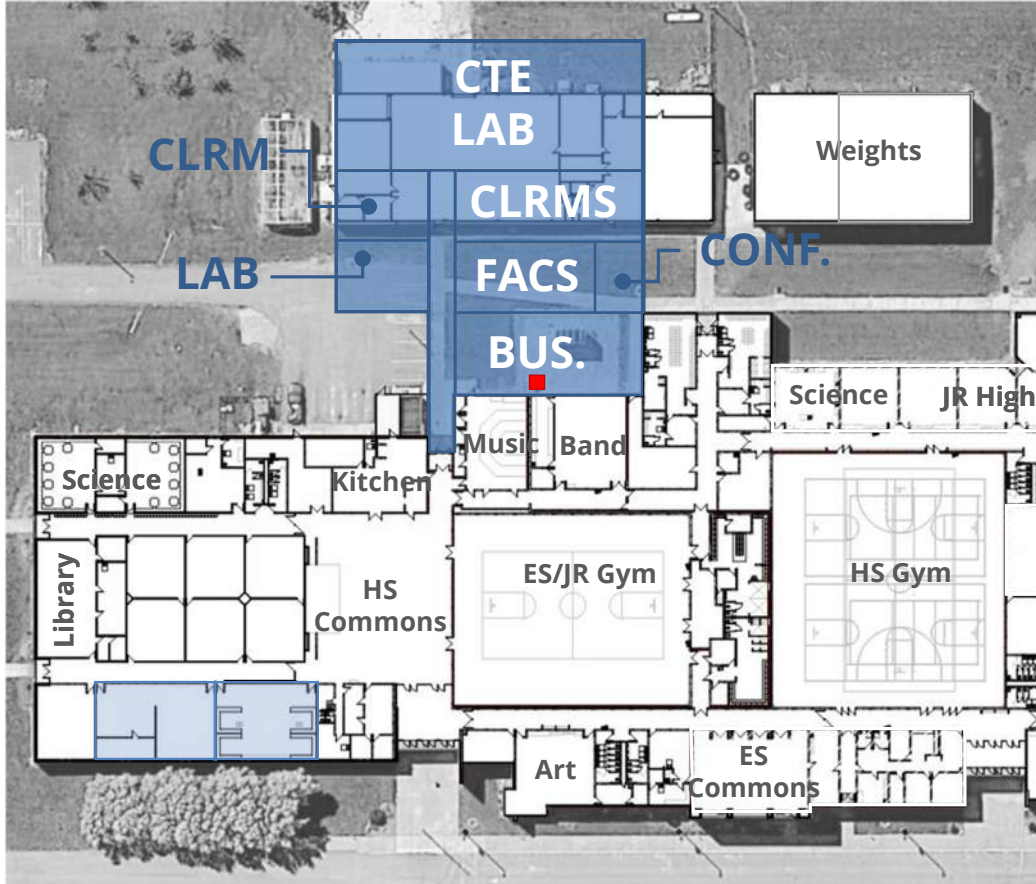

- RENOVAITON
- **NEW CONSTRUCITON \$6.5M**
 - Ag Ed: \$3.75M
 - FACS: \$686k
 - Business: \$1.125M
 - Lab & Hall: \$800k
- RENO + NEW CON

1. CTE – Recommended

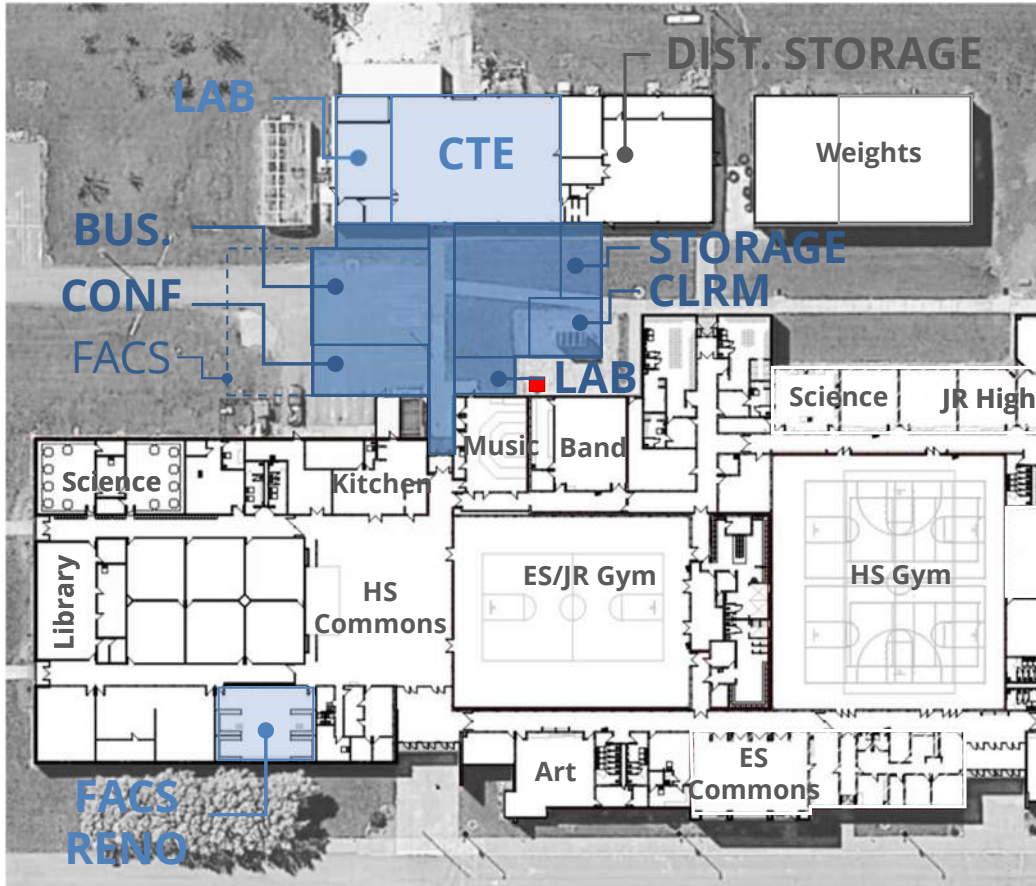

- RENOVAITON
- NEW CONSTRUCITON
- **RENO + NEW CON: \$4.375M**
 - Ag Ed: \$2.9 M
 - FACS Reno: \$311k
 - Business NC: \$1.125M

PRIORITIZE NEEDS

Facility Needs

2. Athletic Upgrades

Recommended - \$4.24M

- Baseball Field
- Softball Field
- Track – 8 lane
- Stadium Lights

Additional Scope - \$9.26M

- Recommended +
 - Ball Field Parking & Restrooms \$590k
 - Turf Field
 - Wrestling
 - Weights
 - Football LKRM
 - Complex Signage
 - Concessions + Storage

2. ATHLETIC UPGRADES

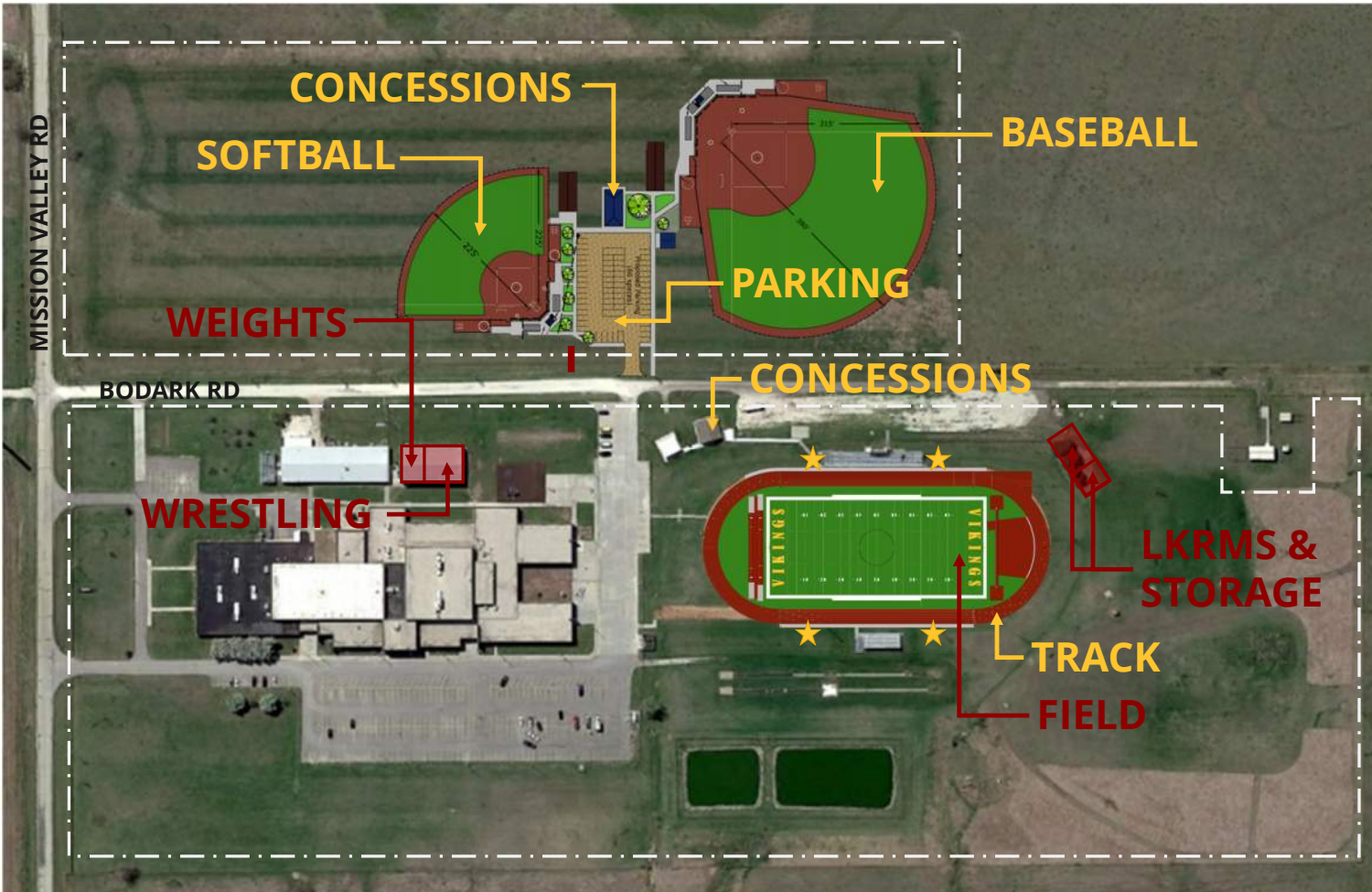

Recommended - \$4.4M

- Baseball
- Softball
- Track
- Stadium lights

Additional Scope - \$9.3M

- Ball Field Parking & Restrooms
- Turf field
- Wrestling
- Weights
- LKRMS
- Complex Signage
- Storage & Concessions



PRIORITIZE NEEDS

Facility Needs

3. Infrastructure Upgrades

Base - \$2.1M

- Roof @ ES + part HS
- HS Electrical
- HS Mechanical
 - Replace 7 RTUs + Gym AC

Recommended - \$3.1M

- Base Scope +
- ES Mechanical: Heat Pumps
- Fire Alarm

Add. Scope - \$3.85M

- Base + Rec. Items +
- HS Plumbing
- HS Commons
- ES lighting
- ES Electrical
- CAT 6 Cabling
- Fiber

3. INFRASTRUCTURE UPGRADES

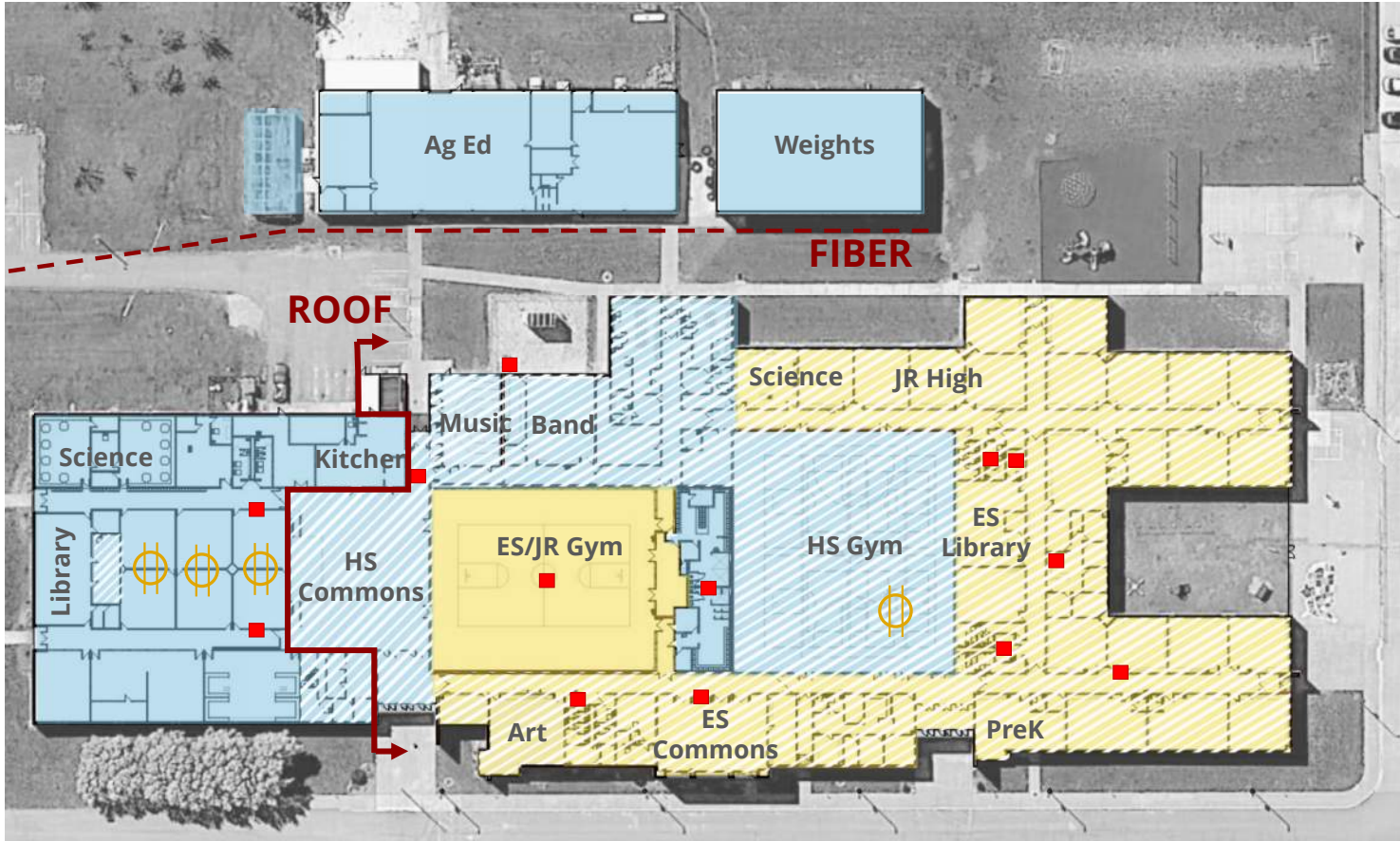

Base Scope - \$2.1M

- Roof @ ES and partial HS
- HS Electrical Ⓞ
- HS Mech ■

Recommended - \$3.1M

- Base Scope +
- ES Mech Heat Pumps ■
- Fire Alarm

Add. Scope - \$3.85M

- Base + Rec. Items +
- HS Plumbing
- HS Commons
- Addition Items

PRIORITIZE NEEDS

Facility Needs

4. Security Upgrades

Base Scope - \$714k

- HS Secure Entry + Admin Renovation
- HS Intercom System

Recommended - \$999k

- Base Scope +
 - Phones
 - Security Cameras

Add. Scope - \$1.02M

- HS Secure Entry + Admin NC + Reno
- HS Intercom
- Phones
- Security Cameras
- Entry Canopies



4. Security Upgrades

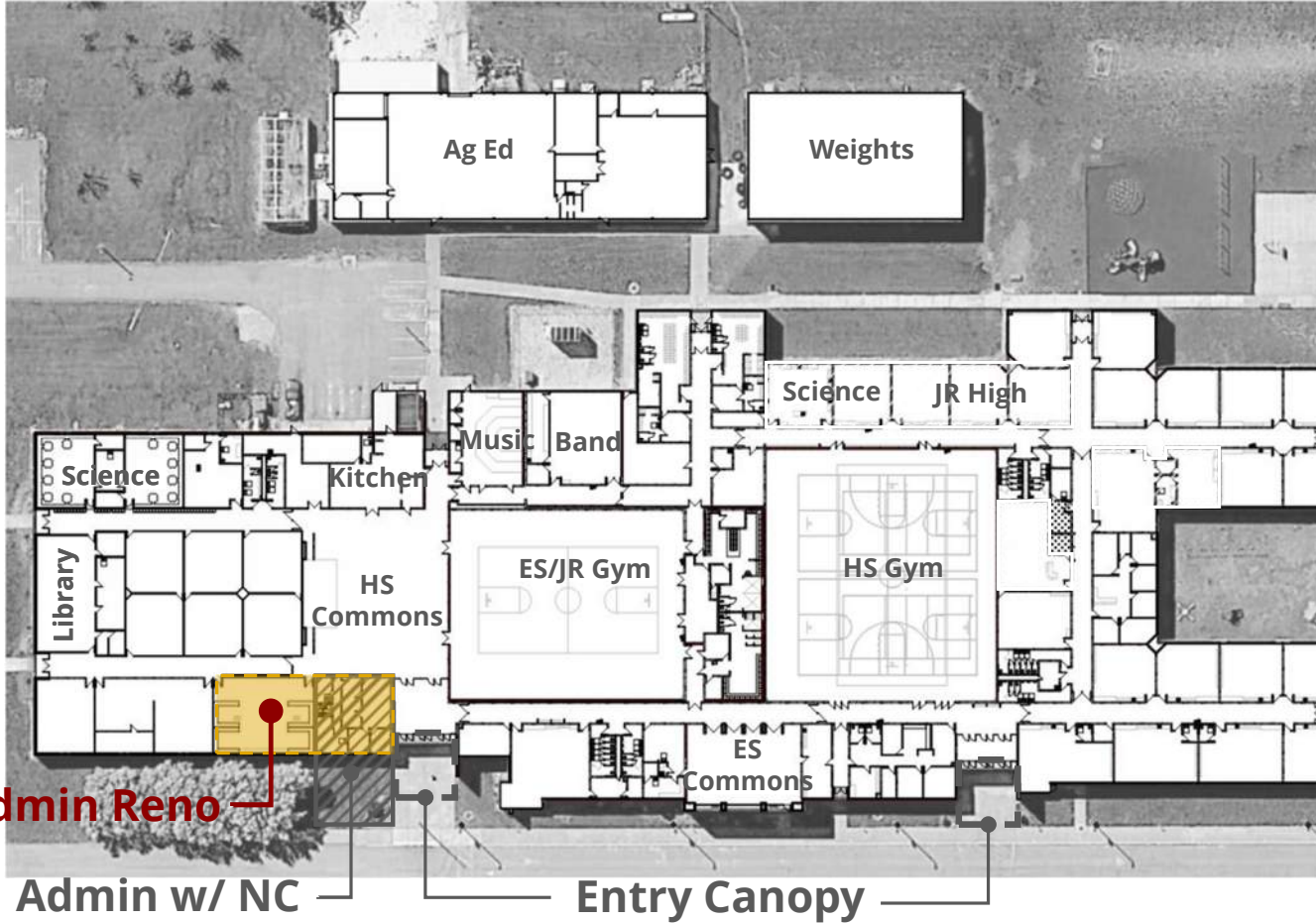

Base Scope - \$714k

- HS Secure Entry + Admin Renovation
- HS Intercom System

Recommended - \$999k

- Base Scope+
- Phones
- Security Cameras

Add. Scope - \$1.02M

- HS Secure Entry + Admin NC + Reno
- HS Intercom
- Phones
- Security Cameras
- Entry Canopies

PRIORITIZE NEEDS

Facility Needs

5. High School Improvements

Base Scope - \$202k Recommended - \$1.55M

- Flooring Replacement
 - w/ Abatement
 - Masonry Repair
- Base Scope+
 - Rated Walls & Doors
 - Science Classrooms & Prep
 - Ceiling replacement
 - Band & Vocal Finishes
 - SPED



Add. Scope - \$2.92M

- Base + Rec. +
- Acoustics
- Lockers
- Finishes
- Library/ Staff Development
- Gym Sound System

5. HIGH SCHOOL

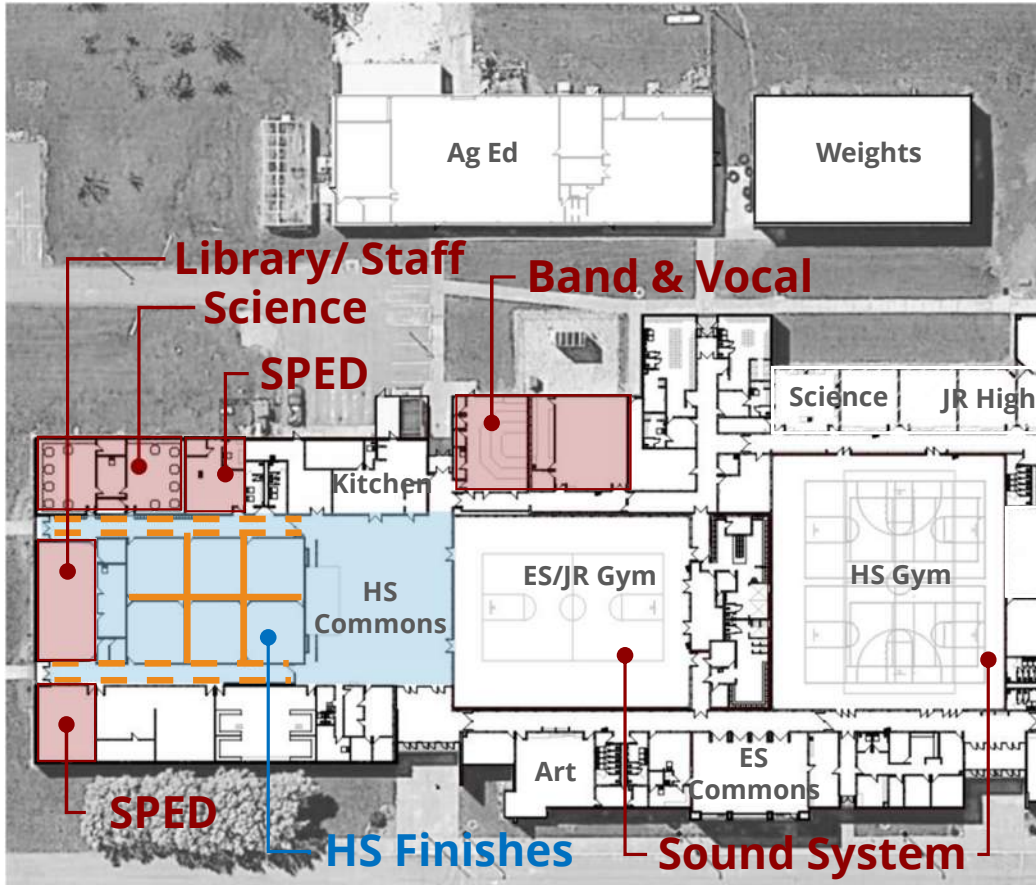

Base Scope - \$202k

- Abatement
- Flooring Replacement
- Masonry Repair

Recommended - \$1.5M

- Base Scope +
- Rated Walls & Doors
- Science Classrooms & Prep
- Ceiling replacement
- Band & Vocal Finishes
- SPED

Add. Scope - \$2.9M

- Base + Rec. +
- Acoustics
- Lockers
- Finishes
- Library/ Staff Development
- Gym Sound System

PRIORITIZE

Facility Needs

6. District Needs

Base Scope - \$454k

- ES Flooring

Recommended - \$1.8 M

- Base Scope +
 - Bus Separation
 - Move Fuel + Bus Drain
 - Original Gym Bleachers
 - Gym Floor Replacement
 - ES Workroom,
Conference Room, Office
 - Kitchen Improvements

Add. Scope - \$4 M

- Base + Rec. +
 - West Playground Turf
 - Monument Sign @ Road
 - Entry Landscape
 - South Sidewalk
 - Parking Increase
 - Volleyball Nets & Roller Shades
 - Gym Acoustics
 - PK Classroom Addition
 - ES Hallway Ceilings
 - Stage Lighting
 - District Storage

6. District Needs - Interior

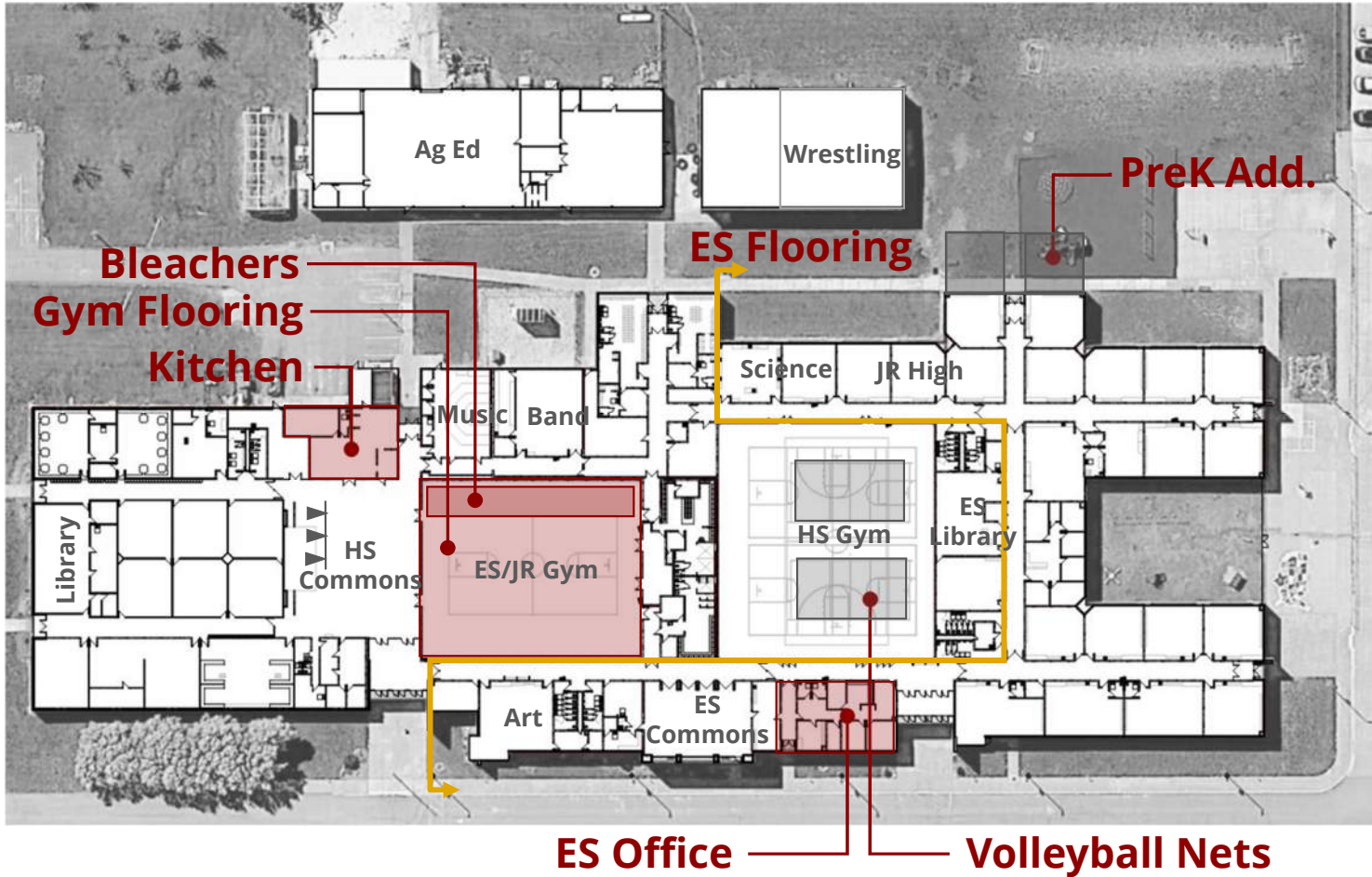

Base Scope - \$454k

- ES Flooring

Recommended - \$1.8M

- Gym Bleachers
- Replace Gym Floor
- ES Wkrm, Conf. Rm & Office
- Kitchen Improvements

Add. Scope - \$4M

- Volleyball Nets & Shades
- Gym Acoustics
- PK Classroom Add.
- ES Hallway Ceilings
- Stage Lighting



6. District Needs - Exterior

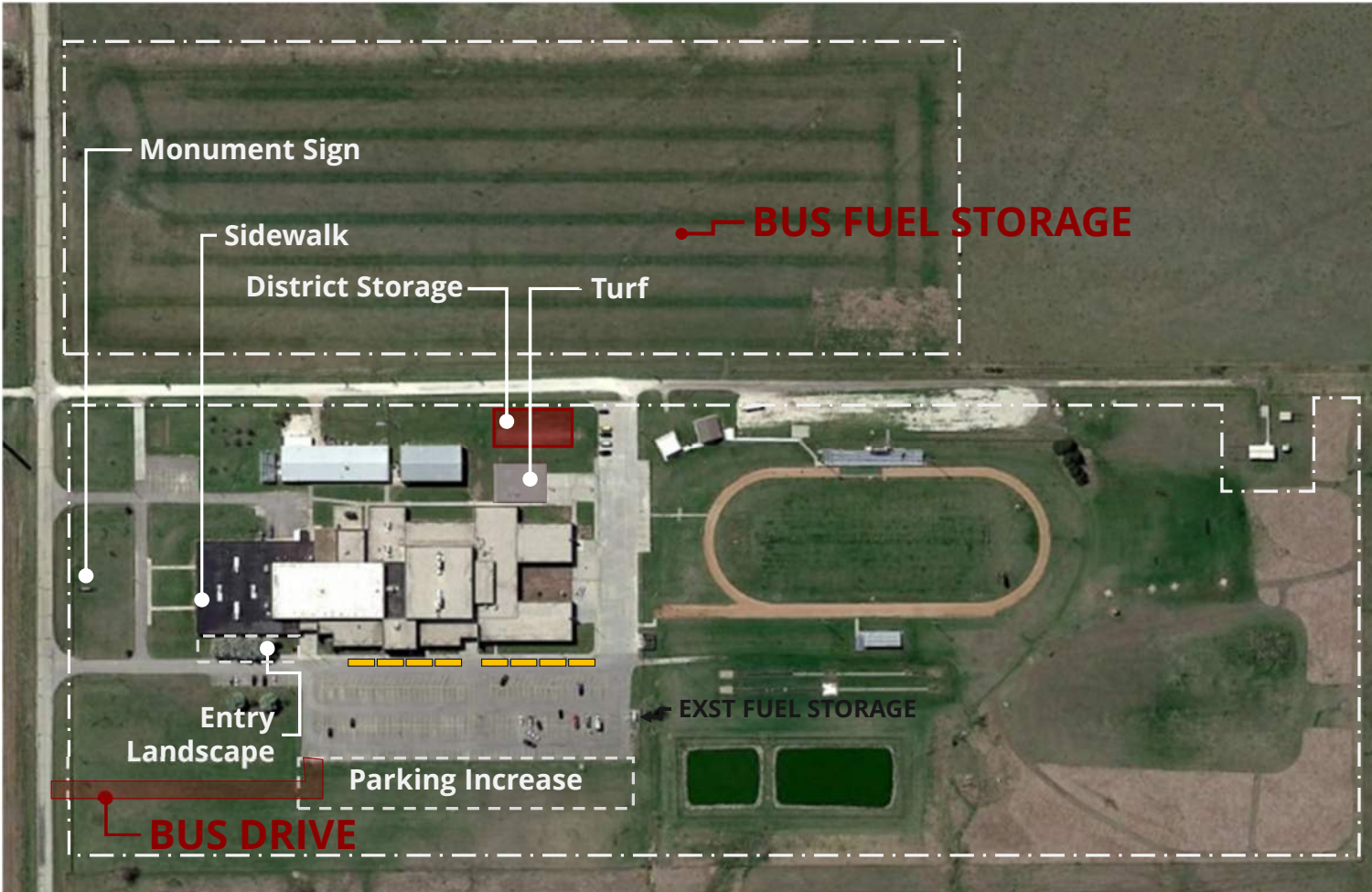

Recommended - \$1.8M

- Bus Separation
- Move Fuel + Bus Drain
- + Interior work

Add. Scope - \$4M

- Rec. +
- West Playground Turf
- Monument Sign @ Road
- Entry Landscape
- South Sidewalk
- Parking Increase
- District Storage
- + Interior Work

COMBINED PRIORITIES 1-6

Base Scope - \$10.378M +/-

1. CTE: **CTE Renovation**
2. Athletics: **Baseball + Softball Fields + Track**
3. Infrastructure: **Roof, HS Power & Mechanical**
4. Security: **HS Secure Entry + HS Intercom**
5. HS Improvements: **HS Flooring + Exterior Repair**
6. Other: **ES Flooring**

Recommended - \$14.4 M

- **Base Scope +**
 - **CTE Renovation + New Construction**
 - **ES Mechanical, Fire Alarm**
 - **Phones and Cameras**
 - **HS Walls and Doors, HS Ceilings + SPED**
 - **Site Work w/ Bus and Interior Gyms**

Added Scope - \$14.4 M - \$23M

- **CTE all new Construction**
- **Parking, Restrooms, & Concessions, Turf, Football Locker rooms +**
- **LED Lighting, Fiber, CAT 6 Cabling**
- **Site Improvements**

FUNDING



CHRYSLER AND THE OAD
COURTESY OF THE OAD
DONOR

HOME	PERIOD	GUEST
FOULS	PLAYER FOUL	FOULS
SCORE	MATCH	SCORE

FUNDING

School District Options

- Capital Outlay
- ESSER Funds
- Bond Issue
 - \$9 M no tax increase
 - \$12.5 M increase of \$32.56 /yr = \$2.71 /mo on \$100k home
 - \$17.5 M increase of \$98.68 /yr = \$8.22 /mo on \$100k home

CAPITAL OUTLAY

Past Projects

- **2010-2022** – Door Locks and Cameras (\$200k)
- **2015-2016** – HS upgrades: clrm walls, doors, windows, HVAC, LED lights, SPED restroom (\$320k)
- **2017** – HVAC & Electrical Upgrades (\$820k)
- **2021** – Fiber Optic System (\$60k) + Playground, locker room, K-6 secure entry (\$230k)
- **Other Items** – Pavilion, parking & sidewalk upgrades, HVAC, fencing, district fleet purchases

COMMITTEE FEEDBACK

Building Committee

•Questions

- 1. Do you support the CTE as an Addition, Renovation, or Combined?**
- 2. Do you support moving ball fields to the District Site?**
- 3. What other options should we consider?**
- 4. Would you support increasing taxes?**
- 5. What does the community need to know to support an increase?**

QUESTIONS?



SCHEDULE

