



Brevard Public Schools



### Capital Outlay Committee Meeting

April 10, 2023  
1:30 pm  
ESF-School Board Room

1

1



## 2 Pledge of Allegiance

2

2

# Capital Outlay Committee

---

3



Introductions

4



April 10, 2023

## Capital Outlay Committee Meeting

*Brevard County Interlocal Agreement for Public School Facility Planning and School Concurrence*

Time: April 10, 2023, beginning at 1:30 P.M.  
Location: Brevard Public Schools Educational Services Facility  
2700 Judge Fran Jamieson Way, Viera, FL  
School Board Room

### *Proposed Agenda*

Approval of Agenda

5



Approval of January 9, 2023,  
COC Meeting Minutes



3

3

6

## Standing Agenda Items

---

- Capital Outlay Committee Appointment Updates
- School Board Local Planning Agency Representatives



4

4

7

## Community Collaboration for Traffic Safety

Dr. Melinda Maier



Photo:  
Ralph Williams Elementary  
before improvements



5

5

8

## Florida Legislature: House Bill 1 Passed

Florida offers scholarship programs that allow eligible students to attend private schools that may better serve a student's needs or provide options for students with disabilities.

- Expands eligibility for Florida Tax Credit (FTC) and the Family Empowerment Scholarships (FES)
  - Any student who is a resident of Florida and eligible for K-12 grade.
  - Priority income for those students whose household income does not exceed 185% (currently \$55,500 for a family of 4) of the federal poverty level (FPL).
  - Creates a second priority for households with incomes not exceeding 400% (currently \$120,000 for a family of 4) of the FPL.
- Increases the number of students with disabilities served under FES by increasing scholarship growth rates from 1% to 3% of Florida's exceptional education students, annually.



6

6

9

# Capital Projects Update

David Lindemann



7



## Mims Cafetorium



8



# South Lake Elementary Classroom Addition



9

9



# Viera High School Classroom Addition



Viera High School Addition



03-22-23



Viera High School Addition



03-22-23

10

10



## New Middle School



Photo Credit: Wharton-Smith

11

11



## Classroom Additions Coming Soon...



12

12

## New Central Area Transportation and Maintenance Facility

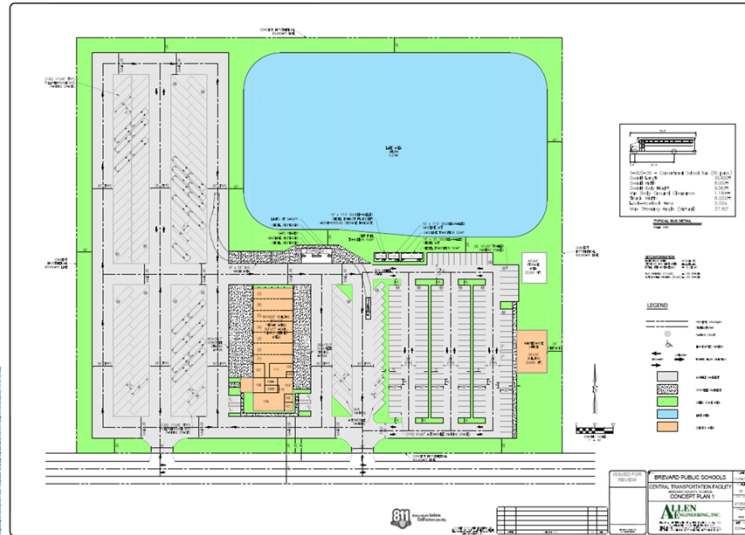

13

13

10

## Development Review Coordination

David Lindemann

- Utility Connections
- Fire Safety Review
- Zoning Review



14

14

11



# BPS Facilities Planning Report

Karen Black

15

## New Middle School Attendance Boundary Process Update

Area 1 – south boundary – Suntree Elementary boundary

Areas 2 and 3 – north boundary – Viera High School boundary

*Red polygon is proposed base attendance boundary. Areas 1, 2 and 3 are areas that can be added to the base boundary.*

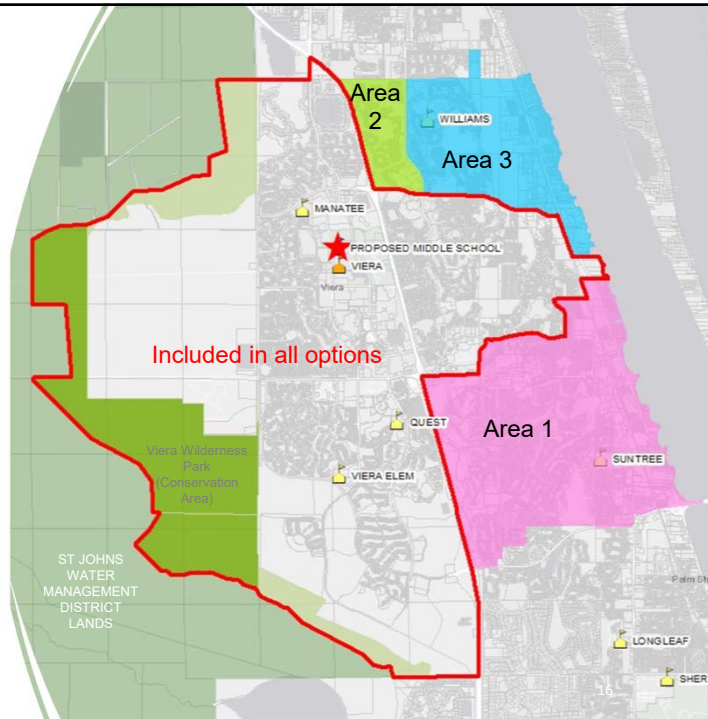

16



# Middle School Boundaries

**New Boundary Process:**

- 01-24-23: School Board Workshop
- Feb-March: Community Engagement
  - Website
  - Community Survey
- 03-09-23: East Viera Community Meeting
- 03-28-23: School Board Workshop
  - School Board guidance to include Base plus areas 1, 2 and 3.
  - Suntree Area 1 Specific Survey
- 04-03-23: Suntree Community Meeting

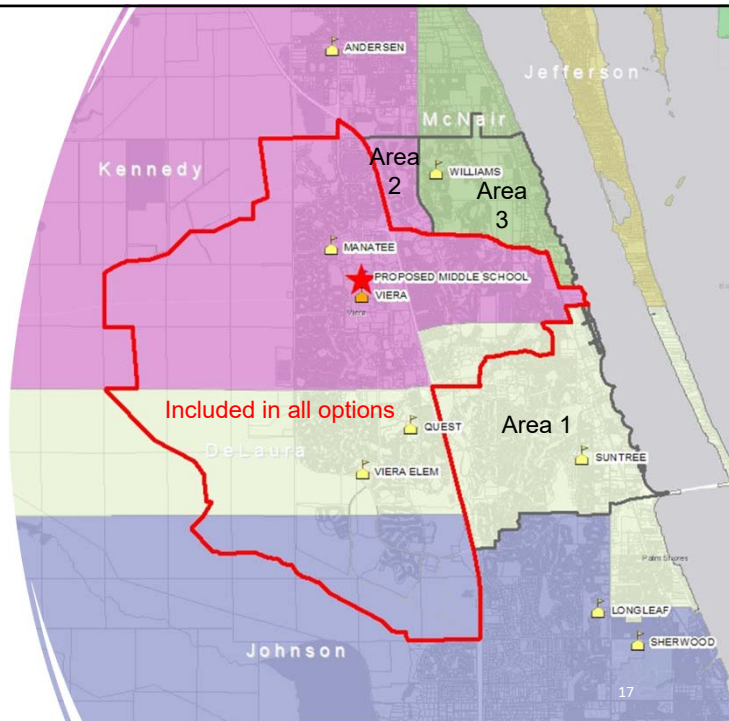

17

## Enrollment Data 10.14.2022

Area	Existing BPS middle school students in area*	Existing BPS 5th and 6th grade students in area	Projected Student Growth** 1-5 years	Projected Long Term Student Growth** 5-10 years	Existing 5th and 6th grade Charter Students in Area
Base	423	549	359	256	273
Area 1	176	200			26
Area 2	16	22			7
Area 3	38	55			20

Existing BPS 5th grade students in area	Existing BPS 6th grade students in area
284	265
107	93
14	8
28	27

\*Does not include students currently enrolled in West Shore and Edgewood (118)

\*\*Based on The Viera Company's August 2022 projected number of units

18

18

## Projected Capacity Utilization – Including Areas 1, 2 and 3

Projected Student Membership (includes Cumulative Impact of Boundary Change & Proposed Development)

School	SY2022-23 Student Membership	Existing Capacity	Projected Membership 2024-25	2024-25 Capacity Utilization	1-5 years	1-5 years Capacity Utilization	5-10 years	5-10 Years Capacity Utilization
DeLaura	842	960	481	50.1%	405	42.2%	327	34.1%
Kennedy	671	869	372	42.8%	381	43.8%	299	34.4%
McNair	365	616	291	47.2%	292	47.4%	362	58.8%
Johnson	610	1,064	669	62.9%	844	79.3%	844	79.3%
New Middle School		900	826	91.8%	1,185	131.7%	1,441	160.1%

19



### Bottom Line

- Community is very supportive of new middle school and would like to be included in the boundary
- Numerous variables make enrollment hard to predict including current and expanding choice options
- Enrollment changes at DeLaura, McNair and Kennedy hard to predict
- Smaller boundary
  - Leaves room for future growth
  - Contrary to community input
  - Other choices available to parents
- Larger boundary
  - Including areas 1, 2 and 3 will not accommodate future growth
  - Responsive to community input
  - May require boundary changes later
  - School opens over capacity if more areas are included

20

20



# New Middle School Boundary Process Next Steps

- April 11, 2023 – School Board Information Item
- April 25, 2023 – School Board Action to advertise Public Hearing
- May 30, 2023 – Public Hearing to approve boundary

21

21

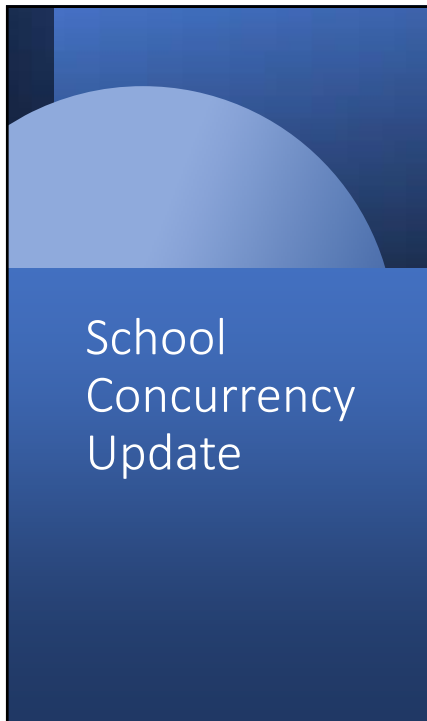

2023 School Concurrency Tabulations			
	School Capacity Determination Reservations (SCADL) N		
	Cocoa	Palm Bay	Totals
SFR		176	176
MFR	30	308	338
CON		60	60
MOB			0
<b>Totals</b>	<b>30</b>	<b>544</b>	<b>574</b>

2023 School Concurrency Tabulations						
	Concurrency Determinations: Preliminary Residential Units					
	Brevard	Melbourne	Palm Bay	Titusville	West Mel	Totals
SFR	190	71	5828	25	24	6138
MFR			3447	571	282	4300
CON						0
MOB						0
<b>Totals</b>	<b>190</b>	<b>71</b>	<b>9275</b>	<b>596</b>	<b>306</b>	<b>10438</b>

22

22



23

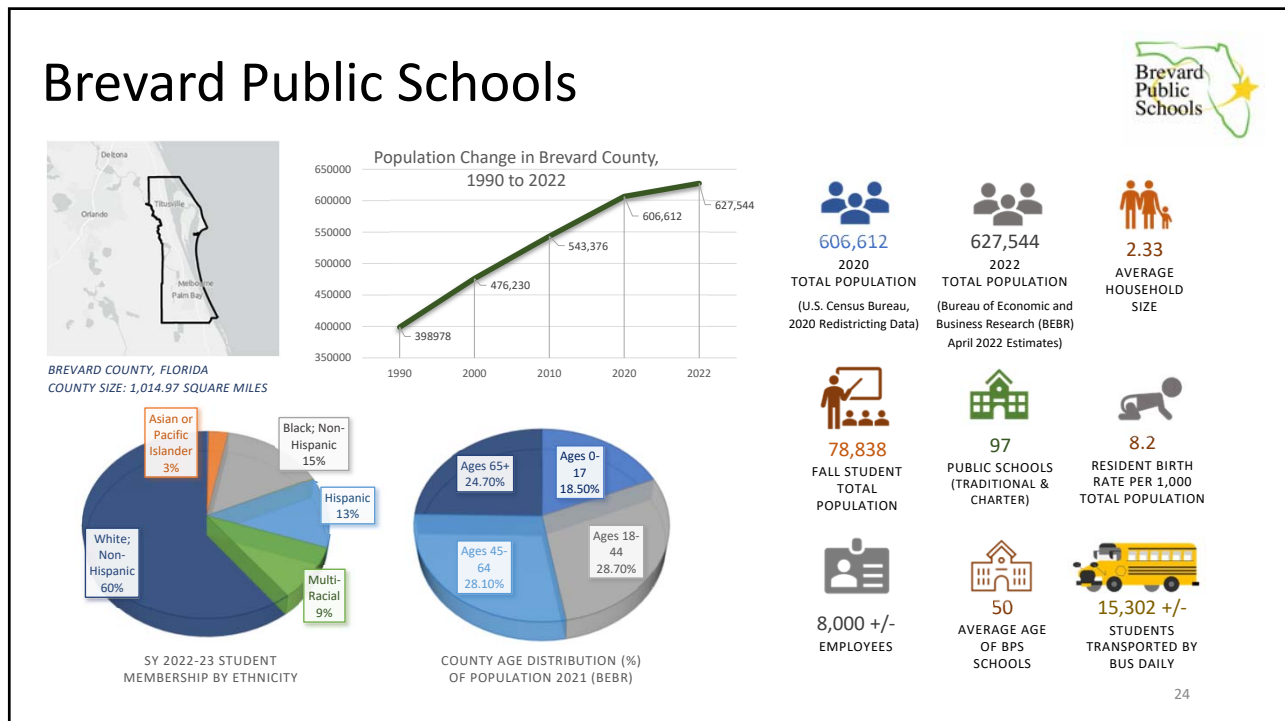

24

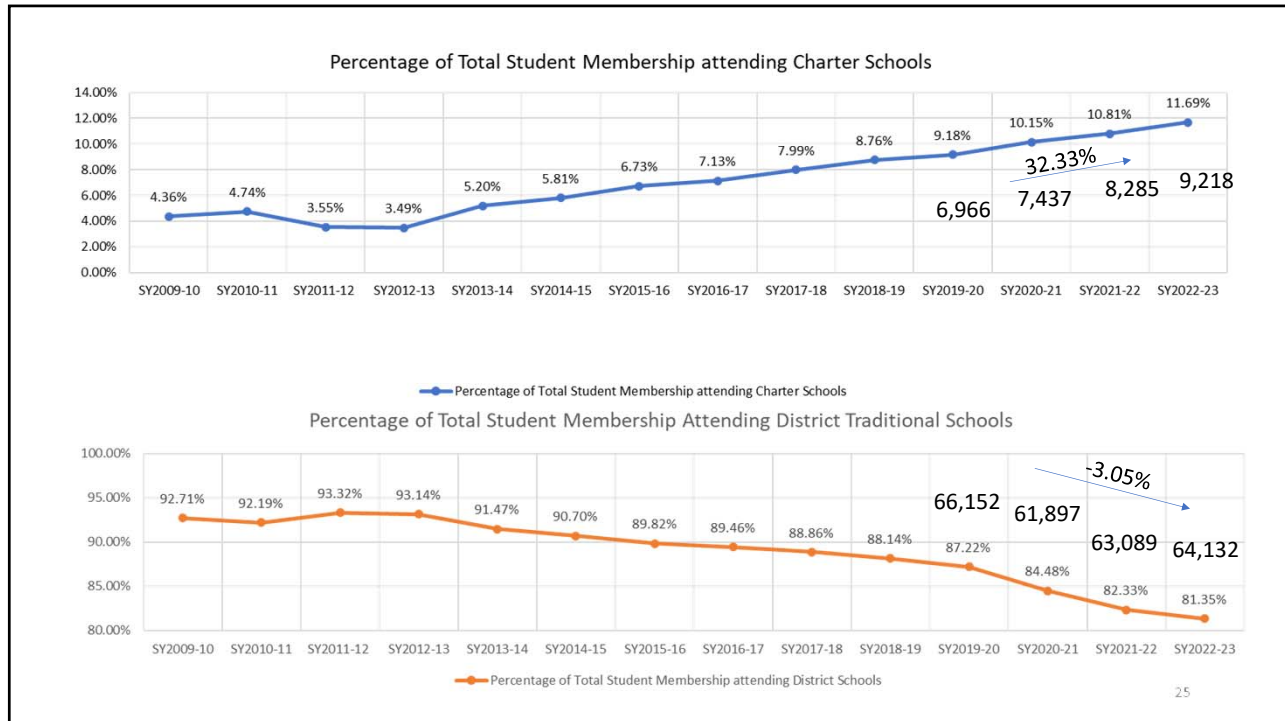

25

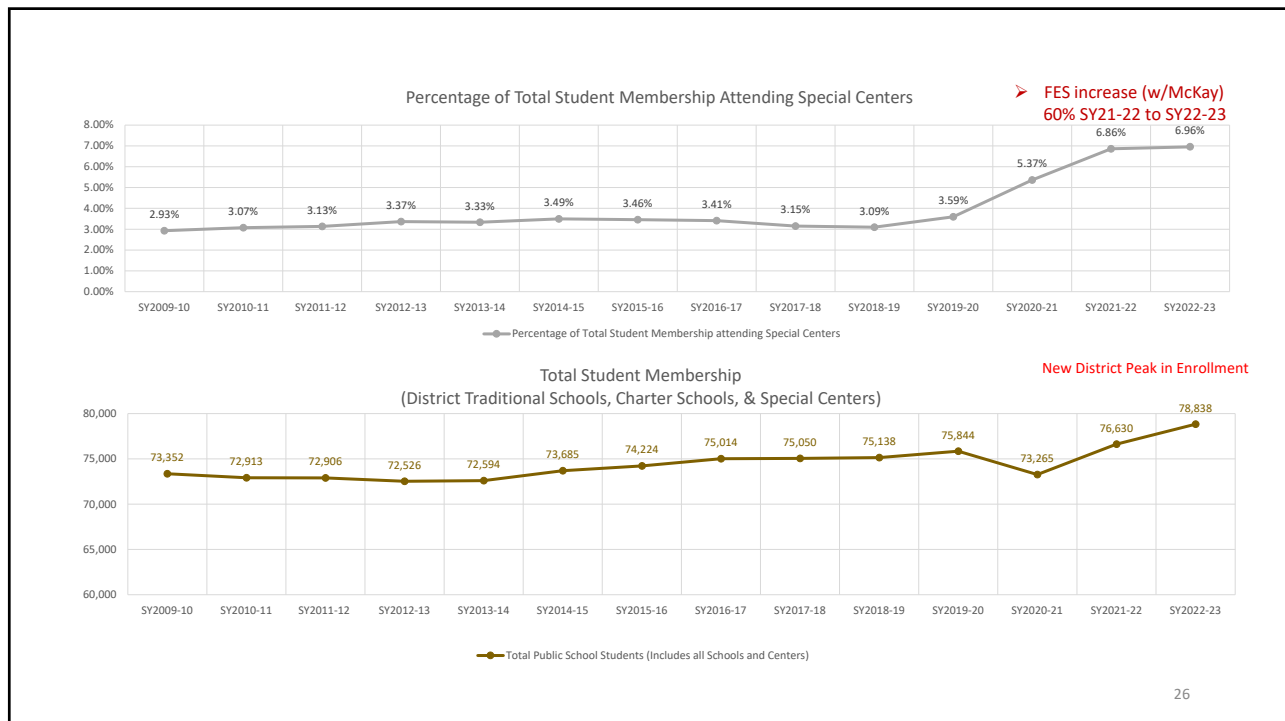

26

## Students have a choice... Percentage of Total Public-School Students Attending Non-Traditional Schools by Grade

- Charter School

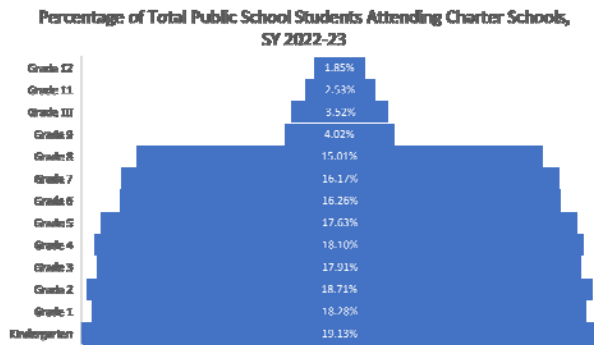

- Family Empowerment Scholarships

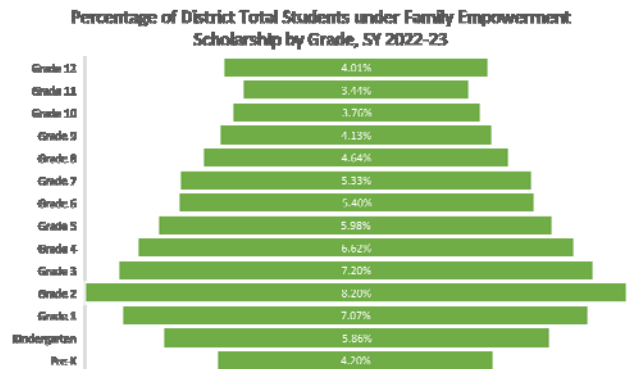

27

27

## Non-Public School Students Residing in Brevard County

- Home Education

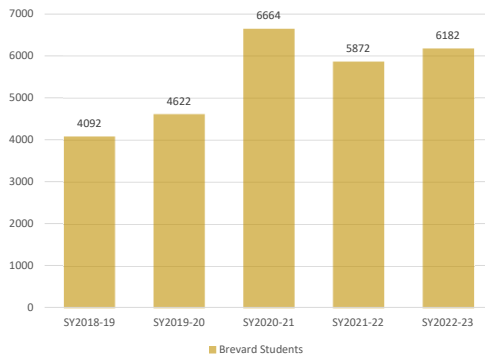

- Private Schools

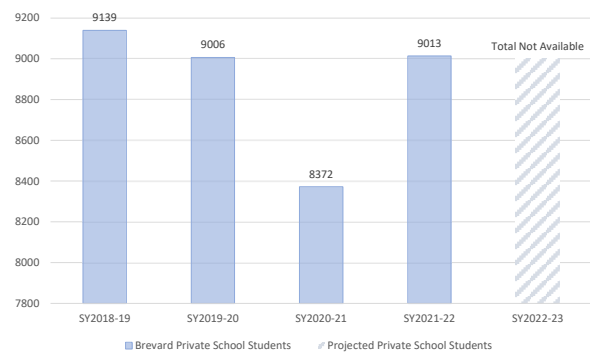

28

28

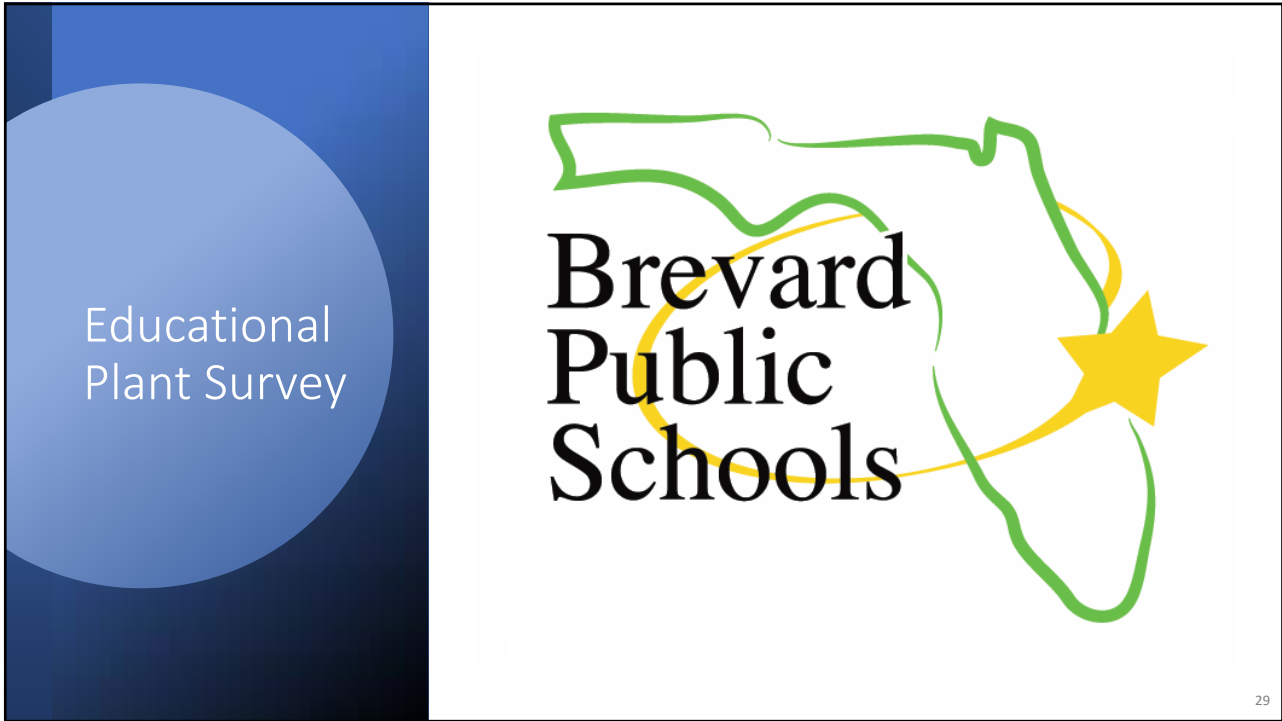

29



30

13

## Additional Discussion

---



31

31



### Thank you for attending

Questions?

Karen Black,  
Manager-Facilities Planning &  
Intergovernmental Coordination  
321-633-1000, Ext. 11418  
[Black.Karen@BrevardSchools.org](mailto:Black.Karen@BrevardSchools.org)

32

32