

Districtwide Lead in Drinking Water Sampling and Remediation Plan

2023-2025

Lawrence UFSD

October 2024

Enviroscience Project #25724



2150 Smithtown Ave., Suite 3, Ronkonkoma, NY 11779

T: 631.580.3191 • F: 631.580.3195 • W: envirohealth.org

DISTRICTWIDE LEAD IN DRINKING WATER SAMPLING AND REMEDIATION PLAN

2023-2025

October 2024

ENVIROSCIENCE PROJECT #25724

Prepared for: Lawrence UFSD
195 Broadway
Lawrence, NY 11559

Prepared by: ENVIROSCIENCE CONSULTANTS, LLC
2150 Smithtown Avenue
Ronkonkoma, New York 11779
(631) 580-3191

Project Manager: *Pam Chadderton*

TABLE OF CONTENTS

<u>Section</u>	<u>Title</u>
1.0	Executive Summary
2.0	Sampling Methodology
3.0	Initial Results

Appendices

Appendix A	Lawrence School #2
Appendix B	Lawrence School #4
Appendix C	Lawrence Middle School
Appendix D	Lawrence High School

1.0 EXECUTIVE SUMMARY

The Lawrence UFSD has developed their 2023-2025 Lead in Drinking Water Sampling and Remediation Plan, as required by the New York State Department of Health (Public Health Law Sections 1370-a and 1110, Subpart 67-4 Lead Testing in School Drinking Water).

In accordance with the regulation, this Lead Remediation Plan is prepared to identify locations deemed as Applicable Drinking Water Sources and report first draw sample results, to mitigate locations where sample results exceed 5 parts per billion, to identify locations deemed as Non-Applicable Water Sources, communicate this designation to building occupants, and to develop strategies for monitoring locations deemed Non-Applicable Water Sources to insure building occupants do not consume water from these locations.

The following locations within the Lawrence UFSD buildings have been deemed Applicable Drinking Water Sources by the administration:

- 1) Water fountains and bottle filling stations;
- 2) Kitchen water faucets and pot fillers used in food preparation;
- 3) Ice machines
- 4) Home Economics classroom sinks
- 5) Student Bathroom sinks
- 6) Nurse's Office and Faculty Room sinks

First draw samples were collected from each of these locations within the District, and analyzed by a New York State Department of Health ELAP certified laboratory. The chains of custody are available upon request. For results at or below 5 ppb, no further action is required until 2025. For locations above 5 ppb, options include: second and third draw sample collection to determine source of lead, designation of the location as Non-applicable Water Source, or permanent removal of the fixture from the location. In either case, the result was communicated by Enviroscience Consultants, and the fixture was shut off by the District immediately upon receipt of results.

The following locations within the Lawrence UFSD buildings were deemed Non-Applicable Water Sources by the administration:

- 1) Science Laboratory sinks
- 2) Art Room sinks
- 3) Technical Classroom sinks
- 4) Other Classroom sinks
- 5) Other Bathroom sinks
- 6) Outside spigots
- 7) Custodial Closet sinks
- 8) Mixed Valve sinks (or hot only)

In these cases, the Lawrence UFSD staff have placed signs adjacent to the fixture to notify occupants that the water is not intended for consumption. To further support this protocol, the following management of the locations is required:

- 1) Science Laboratory sinks - communicate in writing with students that these locations are for science experiments and hand washing only, not for consumption. This is most easily accomplished by including this language in the laboratory safety paperwork distributed to students at the beginning of the school year. This program should be monitored by the respective science teachers, and any deficiencies reported for assessment and revision, if necessary, by the Facilities Department.
- 2) Art Room sinks - communicate in writing to students that these locations are for cleaning of art supplies and hand washing only, not for consumption. This is most easily accomplished by including this language in the course paperwork distributed to students at the beginning of the school year. This program should be monitored by the respective art teachers, and any deficiencies reported for assessment and revision, if necessary, by the Facilities Department.
- 3) Technical Classroom sinks - classrooms in this category often include wood shop or auto mechanics classrooms, where students are to hand wash after bathroom usage or activities as part of a regular hygiene program. This program should be monitored by teachers and staff to ensure consumption is not taking place, and any deficiencies reported for assessment and revision, if necessary, by the Facilities Department.
- 4) Other classroom sinks - classrooms in this category often include elementary classrooms, where students are to hand wash after bathroom usage or activities as part

of a regular hygiene program. This program should be monitored by teachers and staff to ensure consumption is not taking place, and any deficiencies reported for assessment and revision, if necessary, by the Facilities Department.

- 5) Bathroom sinks - in intermediate buildings, signage should be sufficient for communicating the concept of hand washing only. In elementary schools, personal hygiene should be integrated into curriculum to ensure students understand bathroom sinks are for hand washing only, and not consumption. Further, show what the signage looks like in bathrooms, so they learn to recognize its meaning. This program should be monitored by teachers and staff to ensure consumption is not taking place, and any deficiencies reported for assessment and revision, if necessary, by the Facilities Department.
- 6) Outside spigots - all-weather signage will be installed at each location. Further, spigots will have a special key maintained by the custodial staff to ensure that non-authorized persons do not fill sports coolers or use hoses for consumption. This program should be monitored by custodial staff to ensure consumption is not taking place, and any deficiencies reported for assessment and revision, if necessary, by the Facilities Department.
- 7) Custodial Closet sinks - these locations should be accessed by custodial personnel only and locked when not in use. Access to others should be restricted. This program should be monitored by custodial staff to ensure consumption is not taking place, and any deficiencies reported for assessment and revision, if necessary, by the Facilities Department.
- 8) Mixed Valve sinks (or hot only) – per Public Health Law Sections 1370-a and 1110, Subpart 67-4 Lead Testing in School Drinking Water mixed valve or hot water only sources are not required to be sampled. Signage is required for these sources. Signage should be sufficient for communicating the concept of hand washing only. In elementary schools, personal hygiene should be integrated into curriculum to ensure students understand bathroom sinks are for hand washing only, and not consumption. Further, show what the signage looks like so they learn to recognize its meaning. This program should be monitored by teachers and staff to ensure consumption is not taking place, and any deficiencies reported for assessment and revision, if necessary, by the Facilities Department.

All locations deemed non-applicable, but do not have signs, should be taken offline until signs have been posted. Signs are suggested to have pictures that instruct for handwashing only, do not drink.



2.0 SAMPLING METHODOLOGY

In accordance with the regulation, Enviroscience Consultants, LLC performed initial water sampling at the Lawrence UFSD buildings on October 22 and 23, 2024. Samples were collected in wide-mouth 250 milliliter containers and were collected in the morning hours before the

facilities opened. The water sources were not used for at least 8 hours and not more than 18 hours prior to sampling. Unique source numbers and designations were assigned to each source location. Unique sample identification numbers were assigned to each sample taken. The key to fixture type codes, source designations, and the sampling location schematics are shown below.

Code Key for Lead in Water			
Fixture Type Codes			
BF	Bottle Filler	SK	Sink
HB	Hose Bib	SL	Supply Line
IM	Ice Machine	SP	Spigot
OS	Other Source	SPY	Spray
PF	Pot Filler	SS	Slop Sink
		V	Valve
		WC	Water Cooler
		WF	Water Fountain
Source Designations			
App	Applicable	N/A	Non-applicable

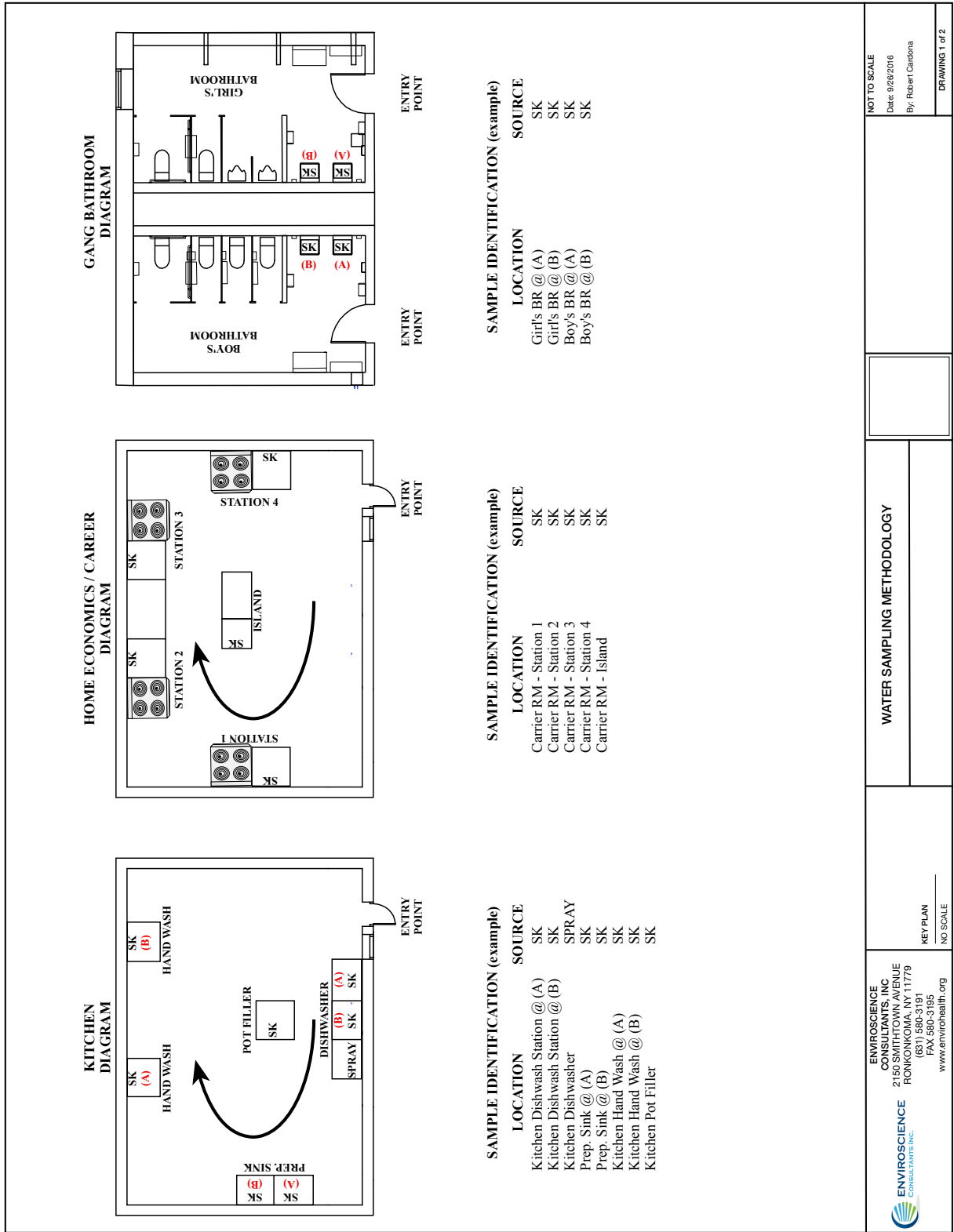

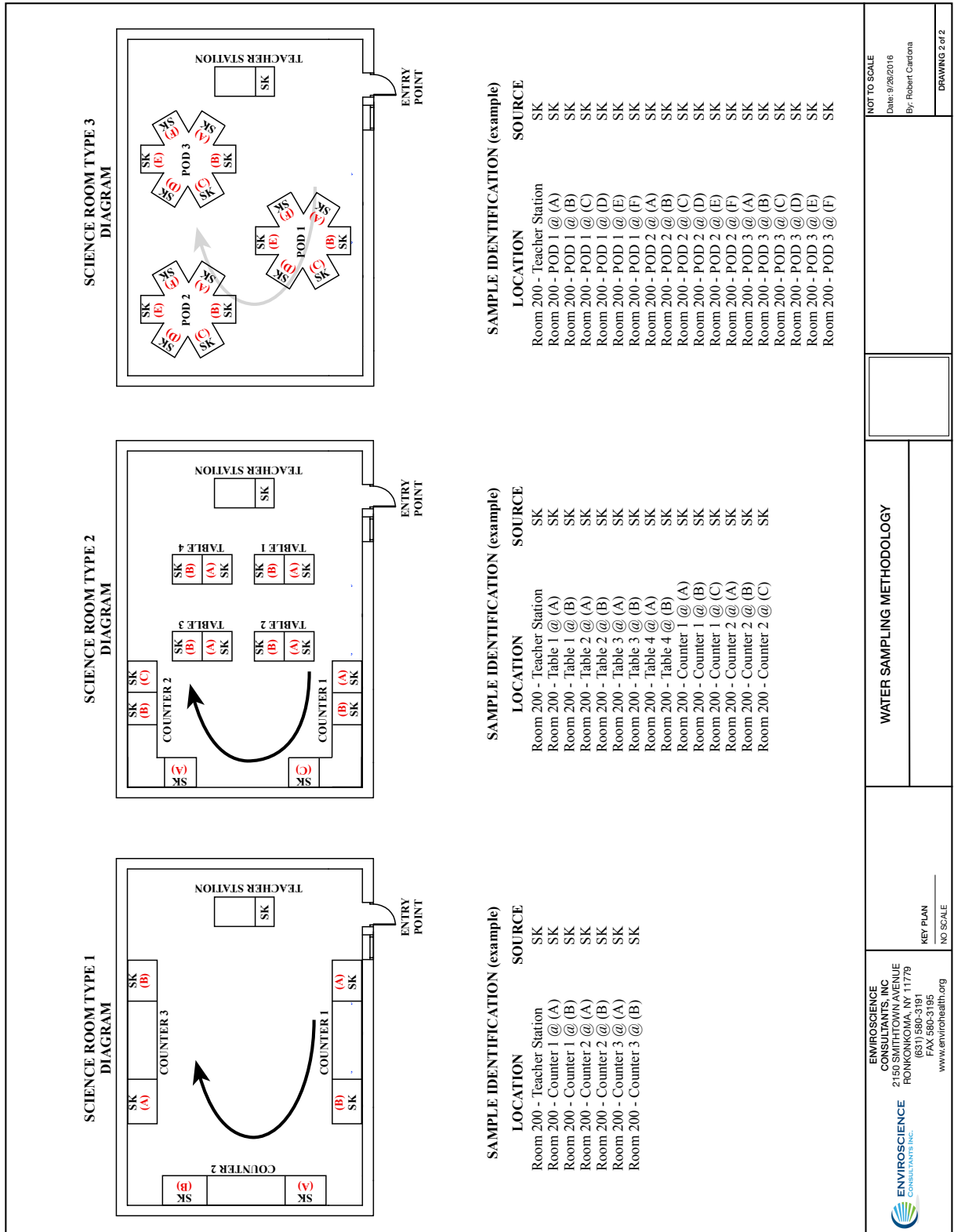

WATER SAMPLING METHODOLOGY	NOT TO SCALE Date: 9/26/2016 By: Robert Castano	DRAWING 2 of 2
 ENVIROSCIENCE CONSULTANTS, INC 2150 SMITHTOWN AVENUE RONKONKOMA, NY 11779 (631) 580-3191 FAX 580-3195 www.envirohealth.org	KEY PLAN NO SCALE	

3.0 Initial Results

All water source locations in each of the school buildings were assessed. Water source locations identified as drinking water sources were considered Applicable, and first draw samples were collected. Water source locations identified as non-drinking water sources were considered non-applicable and these locations were documented.

The results of the initial sampling and the use of signs warning against water use at non-applicable sources is documented in the School Water Outlet Inventory for each building.

All elevated locations should be taken off line until the remediation is completed. Any other drinking water sources in these buildings that were not functional at the time of initial sampling and have not been tested should be tested before returning to service. All locations deemed non-applicable, but do not have signs, should be taken offline until signs have been posted. Signs are suggested to have pictures that instruct for handwashing only, do not drink.

The following is a summary of results in parts per billion (ppb) of locations in the Lawrence UFSD where sample results were found above 5 ppb:

Lawrence School #2			
SAMPLE LOCATION	RESULT	SAMPLE DATE	REMARKS
Cafeteria B - Serving Area-sink	7.0	10/22/2024	Removed from Service Pending Remdiation
Room 3-sink	14.0	10/22/2024	Removed from Service Pending Remdiation
Boy's Bathroom by Room 12-sink	14.0	10/22/2024	Removed from Service Pending Remdiation
Hall by Room 12-water fountain	11.0	10/22/2024	Removed from Service Pending Remdiation
Room 30 Bathroom – Left-sink	36.0	10/22/2024	Removed from Service Pending Remdiation
Room 30 Bathroom – Middle-sink	27.0	10/22/2024	Removed from Service Pending Remdiation
Room 30 Bathroom – Right-sink	98.0	10/22/2024	Removed from Service Pending Remdiation
Hall by Gym Breezeway-bottle filler	62.0	10/22/2024	Removed from Service Pending Remdiation

Lawrence School #2			
SAMPLE LOCATION	RESULT	SAMPLE DATE	REMARKS
Music Room Bathroom-sink	15.0	10/22/2024	Removed from Service Pending Remdiation
Women's Bathroom by Gym Lobby – Right-sink	6.0	10/22/2024	Removed from Service Pending Remdiation
Girl's Bathroom by Room 102 – Left-sink	9.0	10/22/2024	Removed from Service Pending Remdiation
Girl's Bathroom by Room 102 – Right-sink	12.0	10/22/2024	Removed from Service Pending Remdiation
Room 22B-sink	14.0	10/22/2024	Removed from Service Pending Remdiation
Girl's Bathroom by Room 26-sink	10.0	10/22/2024	Removed from Service Pending Remdiation

Lawrence School #4			
SAMPLE LOCATION	RESULT	SAMPLE DATE	REMARKS
Room 13 Bathroom-sink	7.0	10/23/2024	Removed from Service Pending Remdiation
Room 11-water fountain	130.0	10/23/2024	Removed from Service Pending Remdiation
Room 1 Storage Closet-sink	6.0	10/23/2024	Removed from Service Pending Remdiation
Room 24 Bathroom-sink	7.0	10/23/2024	Removed from Service Pending Remdiation
Room 21B Bathroom-sink	10.0	10/23/2024	Removed from Service Pending Remdiation

Lawrence Middle School			
SAMPLE LOCATION	RESULT	SAMPLE DATE	REMARKS
Room 332A Prep Room-sink	8.0	10/23/2024	Removed from Service Pending Remdiation

Lawrence High School

SAMPLE LOCATION	RESULT	SAMPLE DATE	REMARKS
Art Suite Vestibule-water fountain	8.0	10/22/2024	Removed from Service Pending Remdiation
Hall by Room 127-water fountain	16.0	10/22/2024	Removed from Service Pending Remdiation
Hall by Gym Room 223-water fountain	6.0	10/22/2024	Removed from Service Pending Remdiation
Room 220 Station 1-sink	82.0	10/22/2024	Removed from Service Pending Remdiation
Room 220 Station 2-sink	145.0	10/22/2024	Removed from Service Pending Remdiation
Room 220 Station 3-sink	332.0	10/22/2024	Removed from Service Pending Remdiation
Room 220 Station 4-sink	70.0	10/22/2024	Removed from Service Pending Remdiation
2nd Football Locker Room-water fountain	217.0	10/22/2024	Removed from Service Pending Remdiation

Appendix A
Lawrence School #2

Fixture #	Sample Location	Fixture Type	App or N/A	Initial 1 st Draw Results (ppb)	Initial 1st Draw Sampling Date	Resampling 1 st Draw Results (ppb)	15 Second Draw Results (ppb)	60 Second Draw Results (ppb)	Resampling Date	Remarks
0001-1	Cafeteria A - Serving Area	SK	App	3.0						-
0002-1	Basement Girl's Bathroom - Left	SK	App	5.0						-
0002-2	Basement Girl's Bathroom - Right	SK	App	6.0						-
0003-1	Basement Boy's Bathroom - Left	SK	App	2.0						-
0003-2	Basement Boy's Bathroom - Right	SK	App	2.0						-
0004-1	Custodial Closet by Cafeteria B	SS	N/A							Sign
0005-1	Hall by Cafeteria B	WF	App	<1.0						-
0006-1	Non-functional	SK	App	7.0						Removed from Service Pending Remediation
0007-1	Room B9 - Left	SK	App	1.0						-
0007-2	Room B9 - Right	SK	App	<1.0						-
0008-1	Hall by Basement Faculty Bathroom	WF	App	4.0						-
0009-1	Basement Faculty Bathroom	SK	App	<1.0						-
1001-1	Boy's Bathroom by Room 3	SK	App	<1.0						-
1002-1	Hall by Room 1	WF	App	<1.0						-
1003-1	Girl's Bathroom by Room 1	SK	App	3.0						-
1004-1	Room 3	WF	N/A							Non-functional
1004-2	Room 3	SK	App	14.0						Removed from Service Pending Remediation
1005-1	Principal's Office Bathroom	SK	App	<1.0						-
1006-1	Women's Faculty Bathroom by Room 7 - Left	SK	App	2.0						-
1006-2	Women's Faculty Bathroom by Room 7 - Right	SK	App	2.0						-

Fixture #	Sample Location	Fixture Type	App or N/A	Initial 1 st Draw Results (ppb)	Initial 1st Draw Sampling Date	Resampling 1 st Draw Results (ppb)	15 Second Draw Results (ppb)	60 Second Draw Results (ppb)	Resampling Date	Remarks
1007-1	Nurse's Office	SK	App	<1.0						-
1008-1	Isolation Room Bathroom	SK	App	5.0						-
1009-1	Hall by Room 8 - Left	WF	N/A							Non-functional
1009-2	Hall by Room 8 - Right	WF	N/A							Non-functional
1010-1	Custodial Closet by Room 8	SS	N/A							Sign
1011-1	Boy's Bathroom by Room 12	SK	App	14.0						Removed from Service Pending Remediation
1012-1	Hall by Room 12	WF	App	11.0						Removed from Service Pending Remediation
1013-1	Girl's Bathroom by Room 12	SK	N/A							Sign
1014-1	Room 30 Bathroom - Left	SK	N/A	36.0						Removed from Service Pending Remediation
1014-2	Room 30 Bathroom - Middle	SK	N/A	27.0						Removed from Service Pending Remediation
1014-3	Room 30 Bathroom - Right	SK	N/A	98.0						Removed from Service Pending Remediation
1015-1	PE Office Bathroom by Room 30	SK	App	2.0						-
1016-1	Hall by Gym Breezeway	WF	App	<1.0						-
1016-2	Hall by Gym Breezeway	BF	App	62.0						Removed from Service Pending Remediation
1017-1	Custodial Closet by Music Room	SS	N/A							Sign
1018-1	Music Room Bathroom	SK	App	15.0						Removed from Service Pending Remediation
1019-1	PE Office Bathroom by Music Room	SK	App	3.0						-
1020-1	Men's Bathroom by Gym Lobby - Left	SK	App	4.0						-
1020-2	Men's Bathroom by Gym Lobby - Right	SK	App	2.0						-
1021-1	Hall by Gym Lobby	WF	N/A							Non-functional

Fixture #	Sample Location	Fixture Type	App or N/A	Initial 1 st Draw Results (ppb)	Initial 1st Draw Sampling Date	Resampling 1 st Draw Results (ppb)	15 Second Draw Results (ppb)	60 Second Draw Results (ppb)	Resampling Date	Remarks
1022-1	Women's Bathroom by Gym Lobby - Left	SK	App	1.0						-
1022-2	Women's Bathroom by Gym Lobby - Right	SK	App	6.0						Removed from Service Pending Remediation
1023-1	Custodial Closet by Gym Lobby	SS	N/A							Sign
1024-1	Boy's Bathroom by Room 101 - Left	SK	App	2.0						-
1024-2	Boy's Bathroom by Room 101 - Middle	SK	App	2.0						-
1024-3	Boy's Bathroom by Room 101 - Right	SK	App	1.0						-
1025-1	Girl's Bathroom by Room 102 - Left	SK	App	9.0						Removed from Service Pending Remediation
1025-2	Girl's Bathroom by Room 102 - Middle	SK	App	2.0						
1025-3	Girl's Bathroom by Room 102 - Right	SK	App	12.0						Removed from Service Pending Remediation
1026-1	Faculty Bathroom by Room 102	SK	App	1.0						
1027-1	Custodial Closet by Copy Room	SS	N/A							Sign
1028-1	Copy Room	SK	N/A							Sign
1029-1	Room 105	SK	N/A							Sign
1030-1	Room 104	SK	N/A							Sign
1031-1	Room 103	SK	N/A							Sign
1032-1	Hall by Room 103	WF	App							-
1033-1	Room 102	SK	N/A							Sign
1034-1	Room 101	SK	N/A							Sign
2001-1	Boy's Bathroom by Room 17	SK	N/A							Mixed Valve; Sign
2002-1	Hall by Room 15	WF	App	4.0						-

Fixture #	Sample Location	Fixture Type	App or N/A	Initial 1 st Draw Results (ppb)	Initial 1st Draw Sampling Date	Resampling 1 st Draw Results (ppb)	15 Second Draw Results (ppb)	60 Second Draw Results (ppb)	Resampling Date	Remarks
2003-1	Girl's Bathroom by Room 15	SK	App	2.0						-
2004-1	Room 17	SK	App	2.0						-
2005-1	Hall by Room 21	WF	N/A							Non-functional
2006-1	Psychology Office Bathroom	SK	App	5.0						-
2007-1	Room 22B	SK	App	14.0						Removed from Service Pending Remediation
2007-2	Room 22B	SPY	N/A							Non-functional
2007-3	Room 22B Bathroom	SK	App	5.0						-
2008-1	Hall by Room 22B - Left	WF	N/A							Non-functional
2008-2	Hall by Room 22B - Right	WF	N/A							Non-functional
2009-1	Custodial Closet by Room 22	SS	N/A							Sign
2010-1	Boy's Bathroom by Room 26	SK	App	3.0						-
2011-1	Hall by Room 26	WF	N/A							Non-functional
2012-1	Girl's Bathroom by Room 26	SK	App	10.0						Removed from Service Pending Remediation

Laboratory Report (Revised)

NYE Report #: 2406443-31507R

October 29, 2024

Project Manager
Enviroscience Consultants, Inc.
2150 Smithtown Avenue
Ronkonkoma, NY 11779

Project: Lawrence UFSD; Lawrence Primary School (School #2)

Dear Project Manager,

Enclosed is the Laboratory Analytical Report for potable water sample(s) received on October 22, 2024. New York Environmental analyzed the samples on October 23, 2024 for Lead (Pb) by EPA Method 200.9 Rev. 2.2.

If there are any questions regarding the analyses, please feel free to contact us at your convenience. New York Environmental is a NELAP accredited laboratory. Attached reported results meet the requirements of the NELAP standards unless otherwise noted.

Samples' analytical results relate only to the samples tested, in the condition received by the laboratory. This report shall not be reproduced except in its entirety without written approval of the laboratory.

We sincerely thank you for your business, and look forward to being of service for your future environmental testing needs.

Sincerely,

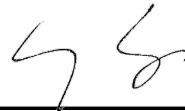

Li Tsang, Laboratory Director

Date Collected:	22 Oct 2024
Date Received:	22 Oct 2024
Date Analyzed:	23 Oct 2024

Analytical Method:	EPA 200.9 Rev. 2.2
Analyte, Matrix:	Lead, Potable Water

Lab ID	CID	Sample Location/Description	LOQ	Result	Units	Flag
241022Q045	1	Cafeteria A - Serving Area-SK, Initial	0.001	0.003	mg/L	
241022Q046	2	Basement Girl's Bathroom - Left-SK, Initial	0.001	0.005	mg/L	
241022Q047	3	Basement Girl's Bathroom - Right-SK, Initial	0.001	0.006	mg/L	H
241022Q048	4	Basement Boy's Bathroom - Left-SK, Initial	0.001	0.002	mg/L	
241022Q049	5	Basement Boy's Bathroom - Right-SK, Initial	0.001	0.002	mg/L	
241022Q050	6	Hall by Cafeteria B-WF, Initial	0.001	<0.001	mg/L	
241022Q051	7	Cafeteria B - Serving Area-SK, Initial	0.001	0.007	mg/L	H
241022Q052	8	Room B9 - Left-SK, Initial	0.001	0.001	mg/L	
241022Q053	9	Room B9 - Right-SK, Initial	0.001	<0.001	mg/L	
241022Q054	10	Hall by Basement Faculty Bathroom-WF, Initial	0.001	0.004	mg/L	
241022Q055	11	Basement Faculty Bathroom-SK, Initial	0.001	<0.001	mg/L	
241022Q056	12	Boy's Bathroom by Room 3-SK, Initial	0.001	<0.001	mg/L	
241022Q057	13	Hall by Room 1-WF, Initial	0.001	<0.001	mg/L	
241022Q058	14	Girl's Bathroom by Room 1-SK, Initial	0.001	0.003	mg/L	
241022Q059	15	Room 3-SK, Initial	0.001	0.014	mg/L	H
241022Q060	16	Principal's Office Bathroom-SK, Initial	0.001	<0.001	mg/L	
241022Q061	17	Women's Faculty Bathroom by Room 7 - Left-SK, Initial	0.001	0.002	mg/L	
241022Q062	18	Women's Faculty Bathroom by Room 7 - Right-SK, Initial	0.001	0.002	mg/L	
241022Q063	19	Nurse's Office-SK, Initial	0.001	<0.001	mg/L	
241022Q064	20	Isolation Room Bathroom-SK, Initial	0.001	0.005	mg/L	
241022Q065	21	Boy's Bathroom by Room 12-SK, Initial	0.001	0.014	mg/L	H
241022Q066	22	Hall by Room 12-WF, Initial	0.001	0.011	mg/L	H
241022Q068	24	Hall by Room 15-WF, Initial	0.001	0.004	mg/L	
241022Q069	25	Girl's Bathroom by Room 15-SK, Initial	0.001	0.002	mg/L	
241022Q070	26	Room 17-SK, Initial	0.001	0.002	mg/L	
241022Q071	27	Psychology Office Bathroom-SK, Initial	0.001	0.005	mg/L	
241022Q072	28	Room 22B-SK, Initial	0.001	0.014	mg/L	H



Date Collected:	22 Oct 2024
Date Received:	22 Oct 2024
Date Analyzed:	23 Oct 2024

Analytical Method:	EPA 200.9 Rev. 2.2
Analyte, Matrix:	Lead, Potable Water

Lab ID	CID	Sample Location/Description	LOQ	Result	Units	Flag
241022Q073	29	Room 22B Bathroom-SK, Initial	0.001	0.005	mg/L	
241022Q074	30	Boy's Bathroom by Room 26-SK, Initial	0.001	0.003	mg/L	
241022Q075	31	Girl's Bathroom by Room 26-SK, Initial	0.001	0.010	mg/L	H
241022Q076	32	Room 30 Bathroom - Left-SK, Initial	0.001	0.036	mg/L	H
241022Q077	33	Room 30 Bathroom - Middle-SK, Initial	0.001	0.027	mg/L	H
241022Q078	34	Room 30 Bathroom - Right-SK, Initial	0.001	0.098	mg/L	E,H
241022Q079	35	PE Office Bathroom by Room 30-SK, Initial	0.001	0.002	mg/L	
241022Q080	36	Hall by Gym Breezeway-WF, Initial	0.001	<0.001	mg/L	
241022Q081	37	Hall by Gym Breezeway-BF, Initial	0.001	0.062	mg/L	E,H
241022Q082	38	Music Room Bathroom-SK, Initial	0.001	0.015	mg/L	H
241022Q083	39	PE Office Bathroom by Music Room-SK, Initial	0.001	0.003	mg/L	
241022Q084	40	Men's Bathroom by Gym Lobby - Left-SK, Initial	0.001	0.004	mg/L	
241022Q085	41	Men's Bathroom by Gym Lobby - Right-SK, Initial	0.001	0.002	mg/L	
241022Q086	42	Women's Bathroom by Gym Lobby - Left-SK, Initial	0.001	0.001	mg/L	
241022Q087	43	Women's Bathroom by Gym Lobby - Right-SK, Initial	0.001	0.006	mg/L	H
241022Q088	44	Boy's Bathroom by Room 101 - Left-SK, Initial	0.001	0.002	mg/L	
241022Q089	45	Boy's Bathroom by Room 101 - Middle-SK, Initial	0.001	0.002	mg/L	
241022Q090	46	Boy's Bathroom by Room 101 - Right-SK, Initial	0.001	0.001	mg/L	
241022Q091	47	Girl's Bathroom by Room 102 - Left-SK, Initial	0.001	0.009	mg/L	H
241022Q092	48	Girl's Bathroom by Room 102 - Middle-SK, Initial	0.001	0.002	mg/L	
241022Q093	49	Girl's Bathroom by Room 102 - Right-SK, Initial	0.001	0.012	mg/L	H
241022Q094	50	Faculty Bathroom by Room 102-SK, Initial	0.001	0.001	mg/L	
241022Q095	51	Copy Room-SK, Initial	0.001	0.001	mg/L	
241022Q096	52	Room 105-SK, Initial	0.001	0.003	mg/L	
241022Q097	53	Room 104-SK, Initial	0.001	0.002	mg/L	
241022Q098	54	Room 103-SK, Initial	0.001	<0.001	mg/L	
241022Q099	55	Hall by Room 103-WF, Initial	0.001	0.002	mg/L	
241022Q100	56	Room 102-SK, Initial	0.001	<0.001	mg/L	



Date Collected:	22 Oct 2024
Date Received:	22 Oct 2024
Date Analyzed:	23 Oct 2024

Analytical Method:	EPA 200.9 Rev. 2.2
Analyte, Matrix:	Lead, Potable Water

<u>Lab ID</u>	<u>CID</u>	<u>Sample Location/Description</u>	<u>LOQ</u>	<u>Result</u>	<u>Units</u>	<u>Flag</u>
241022Q101	57	Room 101-SK, Initial	0.001		mg/L	

Comment:

CID: Client ID LOQ: Limit of Quantitation

E: Sample result exceeds instrument calibration, value is estimated.

H: Sample result exceeds applicable regulatory limit.

Revision History:

Report revised on 10/29/2024, replaces report generated on 10/25/2024.

- Sample Descriptions revised

Appendix B
Lawrence School #4

Fixture #	Sample Location	Fixture Type	App or N/A	Initial 1 st Draw Results (ppb)	Initial 1 st Draw Sampling Date	Resampling 1 st Draw Results (ppb)	15 Second Draw Results (ppb)	60 Second Draw Results (ppb)	Resampling Date	Remarks
0001-1	Room B13	SK	N/A							Sign
0002-1	Cafeteria - B14/B16	SK	App	5.0	10/23/2024					-
0003-1	Boy's Bathroom by Cafeteria	SK	App	<1.0	10/23/2024					-
0003-2	Boy's Bathroom by Cafeteria	SS	N/A							Sign
0004-1	Girl's Bathroom by Cafeteria - Left	SK	App	<1.0	10/23/2024					
0004-2	Girl's Bathroom by Cafeteria - Right	SK	App	<1.0	10/23/2024					-
0005-1	Pre-K Lunch Room	SK	N/A							Sign
0005-2	Hallway by Pre-K Lunch Room - Left	WF	App							Non-functional
0005-3	Hallway by Pre-K Lunch Room - Right	WF	App							Non-functional
0006-1	Hallway by Gymnasium	WF	App	<1.0	10/23/2024					-
0006-2	Hallway by Gymnasium	BF	App	<1.0	10/23/2024					-
0007-1	Unisex Bathroom by Pre-K Lunch Room - Left	SK	App	1.0	10/23/2024					-
0007-2	Unisex Bathroom by Pre-K Lunch Room - Right	SK	App	3.0	10/23/2024					-
0008-1	Room B9 - Left	SK	N/A							Sign
0008-2	Room B9 - Right	SK	N/A							Sign
0009-1	Custodial Office	SS	N/A							Sign
0009-2	Custodial Office Bathroom	SK	App	<1.0	10/23/2024					-
0010-1	Room B3	SK	N/A							Sign
0012-1	Hallway by Room B3	WF	App	2.0	10/23/2024					-
0012-1	Unisex Bathroom by Room B3 - Left	SK	App	5.0	10/23/2024					-
0012-2	Unisex Bathroom by Room B3 - Right	SK	App	<1.0	10/23/2024					-

Fixture #	Sample Location	Fixture Type	App or N/A	Initial 1 st Draw Results (ppb)	Initial 1 st Draw Sampling Date	Resampling 1 st Draw Results (ppb)	15 Second Draw Results (ppb)	60 Second Draw Results (ppb)	Resampling Date	Remarks
1001-1	Room 13	WF	N/A							Removed from Service
1001-2	Room 13 Bathroom	SK	App	7.0	10/23/2024					Removed from Service Pending Remediation
1002-1	Room 14	WF	N/A							Removed from Service
1002-2	Room 14 Bathroom	SK	App	2.0	10/23/2024					-
1003-1	Unisex Bathroom	SS	N/A							Sign
1004-1	Unisex Bathroom	SK	N/A							Sign
1004-1	Hallway by Room 14 - Left	WF	N/A							Removed from Service
1004-2	Hallway by Room 14 - Right	WF	N/A							Removed from Service
1005-1	Faculty Bathroom by Room 12	SK	App	<1.0	10/23/2024					-
1006-1	Room 12	SK	App	4.0	10/23/2024					-
1006-2	Room 12	WF	N/A							Removed from Service
1007-1	Room 11	WF	App	130.0	10/23/2024					Removed from Service Pending Remediation
1007-2	Room 11 Bathroom	SK	App	<1.0	10/23/2024					-
1008-2	Room 10	WF	N/A							Sign
1008-2	Room 10 Bathroom	SK	App	5.0	10/23/2024					-
1009-1	Room 9	WF	N/A							Sign
1009-2	Room 9 Bathroom	SK	App	1.0	10/23/2024					-
1010-1	Supervisor's Office Bathroom	SK	App	<1.0	10/23/2024					-
1011-1	Nurse's Office	SK	App	2.0	10/23/2024					-
1011-2	Nurse's Office Bathroom	SK	App	1.0	10/23/2024					-
1012-1	Room 7 Bathroom	SK	App	2.0	10/23/2024					-

Fixture #	Sample Location	Fixture Type	App or N/A	Initial 1 st Draw Results (ppb)	Initial 1 st Draw Sampling Date	Resampling 1 st Draw Results (ppb)	15 Second Draw Results (ppb)	60 Second Draw Results (ppb)	Resampling Date	Remarks
1013-2	Room 6	WF	N/A							Removed from Service
1013-2	Room 6 Bathroom	SK	App	1.0	10/23/2024					-
1014-1	Room 5	WF	N/A							Removed from Service
1014-2	Room 5 Bathroom	SK	App	2.0	10/23/2024					-
1015-1	Room 4	SK	N/A							Sign
1015-2	Room 4 Bathroom	SK	App	2.0	10/23/2024					-
1016-1	Room 3	WF	N/A							Removed from Service
1016-2	Room 3 Bathroom	SK	App	<1.0	10/23/2024					-
1018-1	Faculty Bathroom by Room 3	SK	App	<1.0	10/23/2024					-
1018-1	Hallway by Room 1 - Left	WF	App	<1.0	10/23/2024					-
1018-2	Hallway by Room 1 - Right @A	WF	N/A							Removed from Service
1018-3	Hallway by Room 1 - Right @B	WF	N/A							Removed from Service
1019-1	Room 2 Bathroom	SK	App	<1.0	10/23/2024					-
1020-1	Room 1 Bathroom	SK	App	<1.0	10/23/2024					-
1020-2	Room 1 Storage Closet	SK	App	6.0	10/23/2024					Removed from Service Pending Remediation
1021-1	Unisex Bathroom by Room 1	SS	N/A							Sign
2001-1	Unisex Bathroom by Room 2	SK	N/A							Sign
2001-1	Room 23 Bathroom	SK	App	2.0	10/23/2024					-
2002-1	Room 24 Bathroom	SK	App	7.0	10/23/2024					Removed from Service Pending Remediation
2003-1	Room 25 Bathroom	SK	App	<1.0	10/23/2024					-
2004-1	Room 26	SK	App	<1.0	10/23/2024					-

Fixture #	Sample Location	Fixture Type	App or N/A	Initial 1 st Draw Results (ppb)	Initial 1 st Draw Sampling Date	Resampling 1 st Draw Results (ppb)	15 Second Draw Results (ppb)	60 Second Draw Results (ppb)	Resampling Date	Remarks
2004-2	Room 26	WF	N/A							Removed from Service
2005-1	Faculty Bathroom by Room 26	SK	N/A							Sign
2006-1	Hallway by Room 28 - Left @A	WF	N/A							Removed from Service
2006-3	Hallway by Room 28 - Left @B	WF	N/A							Removed from Service
2006-3	Hallway by Room 28 - Right	WF	App	<1.0	10/23/2024					-
2007-1	Unisex Bathroom	SS	N/A							Sign
2007-2	Unisex Bathroom	SK	App	4.0	10/23/2024					-
2008-1	Room 27 Bathroom	SK	App	<1.0	10/23/2024					-
2009-1	Room 28	WF	N/A							Removed from Service
2009-2	Room 28 Bathroom	SK	App	2.0	10/23/2024					-
2020-1	Faculty Bathroom Across from Room 26	SK	App	<1.0	10/23/2024					
2010-1	Room 22 Bathroom	SK	App	<1.0	10/23/2024					-
2011-2	Room 21B	SK	N/A							Sign
2011-2	Room 21B Bathroom	SK	App	10.0	10/23/2024					Removed from Service Pending Remediation
2012-1	Room 21 Bathroom	SK	App	3.0	10/23/2024					-
2013-1	Room 20 Bathroom	SK	App	<1.0	10/23/2024					-
2014-1	Room 19	SK	App	4.0	10/23/2024					-
2014-2	Room 19 Bathroom	SK	App	4.0	10/23/2024					-
2015-1	Room 18 Bathroom	SK	App	<1.0	10/23/2024					-
2016-1	Room 17 Bathroom	SK	App	<1.0	10/23/2024					-
2018-1	Faculty Bathroom by Room 17	SK	App	<1.0	10/23/2024					-

Fixture #	Sample Location	Fixture Type	App or N/A	Initial 1 st Draw Results (ppb)	Initial 1st Draw Sampling Date	Resampling 1 st Draw Results (ppb)	15 Second Draw Results (ppb)	60 Second Draw Results (ppb)	Resampling Date	Remarks
2018-1	Hallway by Library - Left @A	WF	N/A							Removed from Service
2018-2	Hallway by Library - Left @B	WF	N/A							Removed from Service
2018-3	Hallway by Library - Right	WF	App	<1.0	10/23/2024					-
2019-1	Library Bathroom	SK	App	<1.0	10/23/2024					-

Laboratory Report

NYE Report #: 2406487-31533

October 28, 2024

Project Manager
Enviroscience Consultants, Inc.
2150 Smithtown Avenue
Ronkonkoma, NY 11779

Project: Lawrence Early Childhood (#4 School)

Dear Project Manager,

Enclosed is the Laboratory Analytical Report for potable water sample(s) received on October 24, 2024. New York Environmental analyzed the samples on October 25, 2024 for Lead (Pb) by EPA Method 200.9 Rev. 2.2.

If there are any questions regarding the analyses, please feel free to contact us at your convenience. New York Environmental is a NELAP accredited laboratory. Attached reported results meet the requirements of the NELAP standards unless otherwise noted.

Samples' analytical results relate only to the samples tested, in the condition received by the laboratory. This report shall not be reproduced except in its entirety without written approval of the laboratory.

We sincerely thank you for your business, and look forward to being of service for your future environmental testing needs.

Sincerely,

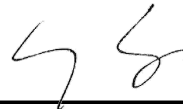

Li Tsang, Laboratory Director

Date Collected:	23 Oct 2024
Date Received:	24 Oct 2024
Date Analyzed:	25 Oct 2024

Analytical Method:	EPA 200.9 Rev. 2.2
Analyte, Matrix:	Lead, Potable Water

Lab ID	CID	Sample Location/Description	LOQ	Result	Units	Flag
241024P038	1	Cafeteria - B14/B16-SK, Initial	0.001	0.005	mg/L	
241024P039	2	Boy's Bathroom by Cafeteria-SK, Initial	0.001	<0.001	mg/L	
241024P040	3	Girl's Bathroom by Cafeteria - Left-SK, Initial	0.001	<0.001	mg/L	
241024P041	4	Girl's Bathroom by Cafeteria - Right-SK, Initial	0.001	<0.001	mg/L	
241024P042	5	Hallway by Gymnasium-WF, Initial	0.001	<0.001	mg/L	
241024P043	6	Hallway by Gymnasium-BF, Initial	0.001	<0.001	mg/L	
241024P044	7	Unisex Bathroom by Pre-K Lunch Room - Left-SK, Initial	0.001	0.001	mg/L	
241024P045	8	Unisex Bathroom by Pre-K Lunch Room - Right-SK, Initial	0.001	0.003	mg/L	
241024P046	9	Custodial Office Bathroom-SK, Initial	0.001	<0.001	mg/L	
241024P047	10	Unisex Bathroom by Room B3 - Left-SK, Initial	0.001	0.002	mg/L	
241024P048	11	Unisex Bathroom by Room B3 - Right-SK, Initial	0.001	0.005	mg/L	
241024P049	12	Hallway by Room B3-WF, Initial	0.001	<0.001	mg/L	
241024P050	13	Room 13 Bathroom-SK, Initial	0.001	0.007	mg/L	H
241024P051	14	Room 14 Bathroom-SK, Initial	0.001	0.002	mg/L	
241024P052	15	Faculty Bathroom by Room 12-SK, Initial	0.001	<0.001	mg/L	
241024P053	16	Room 12-SK, Initial	0.001	0.004	mg/L	
241024P054	17	Room 11 Bathroom-SK, Initial	0.001	<0.001	mg/L	
241024P055	18	Room 11-WF, Initial	0.001	0.130	mg/L	E,H
241024P056	19	Room 10 Bathroom-SK, Initial	0.001	0.005	mg/L	
241024P057	20	Room 9 Bathroom-SK, Initial	0.001	0.001	mg/L	
241024P058	21	Supervisor's Office Bathroom-SK, Initial	0.001	<0.001	mg/L	
241024P059	22	Nurse's Office Bathroom-SK, Initial	0.001	0.001	mg/L	
241024P060	23	Nurse's Office-SK, Initial	0.001	0.002	mg/L	
241024P061	24	Room 7 Bathroom-SK, Initial	0.001	0.002	mg/L	
241024P062	25	Room 6 Bathroom-SK, Initial	0.001	0.001	mg/L	
241024P063	26	Room 5 Bathroom-SK, Initial	0.001	0.002	mg/L	



Date Collected:	23 Oct 2024
Date Received:	24 Oct 2024
Date Analyzed:	25 Oct 2024

Analytical Method:	EPA 200.9 Rev. 2.2
Analyte, Matrix:	Lead, Potable Water

Lab ID	CID	Sample Location/Description	LOQ	Result	Units	Flag
241024P064	27	Room 4 Bathroom-SK, Initial	0.001	0.002	mg/L	
241024P065	28	Room 3 Bathroom-SK, Initial	0.001	<0.001	mg/L	
241024P066	29	Faculty Bathroom by Room 3-SK, Initial	0.001	<0.001	mg/L	
241024P067	30	Hallway by Room 1 - Left-WF, Initial	0.001	<0.001	mg/L	
241024P068	31	Room 2 Bathroom-SK, Initial	0.001	<0.001	mg/L	
241024P069	32	Room 1 Bathroom-SK, Initial	0.001	<0.001	mg/L	
241024P070	33	Room 1 Storage Closet-SK, Initial	0.001	0.006	mg/L	H
241024P071	34	Room 23 Bathroom-SK, Initial	0.001	0.002	mg/L	
241024P072	35	Room 24 Bathroom-SK, Initial	0.001	0.007	mg/L	H
241024P073	36	Room 25 Bathroom-SK, Initial	0.001	<0.001	mg/L	
241024P074	37	Room 26-SK, Initial	0.001	<0.001	mg/L	
241024P075	38	Hallway by Room 28 - Right-WF, Initial	0.001	<0.001	mg/L	
241024P076	39	Unisex Bathroom-SK, Initial	0.001	0.004	mg/L	
241024P077	40	Room 27 Bathroom-SK, Initial	0.001	<0.001	mg/L	
241024P078	41	Room 28 Bathroom-SK, Initial	0.001	0.002	mg/L	
241024P079	42	Faculty Bathroom Across from Room 26-SK, Initial	0.001	<0.001	mg/L	
241024P080	43	Room 22 Bathroom-SK, Initial	0.001	<0.001	mg/L	
241024P081	44	Room 21B Bathroom-SK, Initial	0.001	0.010	mg/L	H
241024P082	45	Room 21 Bathroom-SK, Initial	0.001	0.003	mg/L	
241024P083	46	Room 20 Bathroom-SK, Initial	0.001	<0.001	mg/L	
241024P084	47	Room 19-SK, Initial	0.001	0.004	mg/L	
241024P085	48	Room 19 Bathroom-SK, Initial	0.001	0.004	mg/L	
241024P086	49	Room 18 Bathroom-SK, Initial	0.001	<0.001	mg/L	
241024P087	50	Room 17 Bathroom-SK, Initial	0.001	<0.001	mg/L	
241024P088	51	Faculty Bathroom by Room 17-SK, Initial	0.001	<0.001	mg/L	
241024P089	52	Hallway by Library - Right-WF, Initial	0.001	<0.001	mg/L	
241024P090	53	Library Bathroom-SK, Initial	0.001	<0.001	mg/L	



Date Collected:	23 Oct 2024
Date Received:	24 Oct 2024
Date Analyzed:	25 Oct 2024

Analytical Method:	EPA 200.9 Rev. 2.2
Analyte, Matrix:	Lead, Potable Water

Lab ID **CID** **Sample Location/Description** **LOQ** **Result** **Units** **Flag**

Comment:

CID: Client ID LOQ: Limit of Quantitation

E: Sample result exceeds instrument calibration, value is estimated.

H: Sample result exceeds applicable regulatory limit.



Appendix C
Lawrence Middle School

Fixture #	Sample Location	Fixture Type	App or N/A	Initial 1 st Draw Results (ppb)	Initial 1 st Draw Sampling Date	Resampling 1 st Draw Results (ppb)	15 Second Draw Results (ppb)	60 Second Draw Results (ppb)	Resampling Date	Remarks
1001-1	Kitchen Dishwash Station - 3 Bay	SK	N/A		10/23/2024					
1001-2	Kitchen Dishwash Station - 3 Bay	SPY	N/A		10/23/2024					
1001-4	Kitchen Food Prep Left	SK	App	<1.0	10/23/2024					
1001-5	Kitchen Food Prep Left	SPY	App	<1.0	10/23/2024					
1001-6	Kitchen Food Prep Right	SK	App	<1.0	10/23/2024					
1001-7	Kitchen Food Prep Right	SPY	App	<1.0	10/23/2024					
1001-8	Serving Area Ice Machine	IM	App	<1.0	10/23/2024					
1002-1	New Café	BF	App	<1.0	10/23/2024					
1002-2	New Café	WF	App	<1.0	10/23/2024					
1004-1	Boy's Bathroom by Cafeteria A @A	SK	N/A		10/23/2024					Sign
1004-2	Boy's Bathroom by Cafeteria A @B	SK	N/A		10/23/2024					Sign
1004-3	Boy's Bathroom by Cafeteria A @C	SK	N/A		10/23/2024					Sign
1004-4	Boy's Bathroom by Cafeteria A @D	SK	N/A		10/23/2024					Sign
1004-5	Boy's Bathroom by Cafeteria A @E	SK	N/A		10/23/2024					Sign
1005-1	Custodial Closet by Cafeteria A	SS	N/A		10/23/2024					Sign
1006-1	Hallway by Room 128 & Dining Area A	BF	App	5.0	10/23/2024					
1006-2	Hallway by Room 128 & Dining Area A	WF	App	<1.0	10/23/2024					
1007-1	Hallway by Room 112A	BF	App	<1.0	10/23/2024					
1008-1	Nurse's Office-Exam Room	SK	N/A		10/23/2024					Removed from Service
1008-2	Nurse's Office Bathroom	SK	App	<1.0	10/23/2024					
1008-3	Nurse's Office	SK	App	<1.0	10/23/2024					

Fixture #	Sample Location	Fixture Type	App or N/A	Initial 1 st Draw Results (ppb)	Initial 1 st Draw Sampling Date	Resampling 1 st Draw Results (ppb)	15 Second Draw Results (ppb)	60 Second Draw Results (ppb)	Resampling Date	Remarks
1009-1	Room 134/135-Counter-Left	SK	N/A		10/23/2024					Sign
1009-2	Room 134/135-Counter-Right	SK	N/A		10/23/2024					Sign
1010-1	Room 136	WF	N/A		10/23/2024					Removed from Service; area under renovation
1011-1	Hallway by Room 136	WF	N/A		10/23/2024					Removed from Service; area under renovation
1012-1	Room 138-Counter @A	SK	N/A		10/23/2024					Removed from Service; area under renovation
1012-2	Room 138-Counter @B	SK	N/A		10/23/2024					Removed from Service; area under renovation
1012-3	Room 138-Counter @C	SK	N/A		10/23/2024					Removed from Service; area under renovation
1012-4	Room 138-Counter @C	SPY	N/A		10/23/2024					Removed from Service; area under renovation
1012-5	Room 138-Counter @D	SK	N/A		10/23/2024					Removed from Service; area under renovation
1013-1	Hallway by Room 138	WF	N/A		10/23/2024					Removed from Service; area under renovation
1014-1	Room 139A-Counter @A	SK	App	<1.0	10/23/2024					Removed from Service; area under renovation
1014-2	Room 139A-Counter @B	SK	App	<1.0	10/23/2024					Removed from Service; area under renovation
1014-3	Room 139A-Counter @C	SK	App	<1.0	10/23/2024					Removed from Service; area under renovation
1014-4	Room 139A-Counter @D	SK	App	<1.0	10/23/2024					Removed from Service; area under renovation
1015-1	Hallway by Room 141	WF	App		10/23/2024					Non-functional
1016-1	Women's Bathroom by Room 139	SK	N/A		10/23/2024					Sign
1017-1	Room 103	SK	N/A		10/23/2024					Sign
1018-1	Men's Bathroom by Room 105	SK	N/A		10/23/2024					Sign
1018-2	Men's Bathroom Custodial Closet	SS	N/A		10/23/2024					Sign
1019-1	Boiler Room Bathroom	SK	N/A		10/23/2024					Sign
1019-2	Boiler Room Work Shop	SS	N/A		10/23/2024					Removed from Service; area under renovation

Fixture #	Sample Location	Fixture Type	App or N/A	Initial 1 st Draw Results (ppb)	Initial 1 st Draw Sampling Date	Resampling 1 st Draw Results (ppb)	15 Second Draw Results (ppb)	60 Second Draw Results (ppb)	Resampling Date	Remarks
1019-3	Boiler Room Electrical Shop	SS	N/A		10/23/2024					Removed from Service; area under renovation
1020-1	Room 117A	SK	N/A		10/23/2024					Removed from Service; area under renovation
1020-2	Room 117A Bathroom	SK	N/A		10/23/2024					Removed from Service; area under renovation
1021-1	Hallway by Room 107	WF	N/A		10/23/2024					Removed from Service; area under renovation
1021-2	Hallway by Room 107	BF	N/A		10/23/2024					Removed from Service; area under renovation
1022-1	Custodial Office	SK	N/A		10/23/2024					Removed from Service; area under renovation
1023-1	Hallway by Room 112	BF	N/A		10/23/2024					Removed from Service; area under renovation
1024-1	Hallway by Room 114	WF	N/A		10/23/2024					Removed from Service; area under renovation
1027-1	Girl's Locker Room by New Gym Bathroom @A	SK	N/A		10/23/2024					Sign
1027-2	Girl's Locker Room by New Gym Bathroom @B	SK	N/A		10/23/2024					Sign
1027-3	Girl's Locker Room by New Gym Bathroom @C	SK	N/A		10/23/2024					Sign
1027-4	Girl's Locker Room Custodial Closet	SS	N/A		10/23/2024					Sign
1027-5	Girl's Locker Room Vestibule	BF	App	<1.0	10/23/2024					
1027-6	Girl's Locker Room Vestibule	WF	App	<1.0	10/23/2024					
1028-1	Boy's Locker Room by New Gym Bathroom @A	SK	N/A		10/23/2024					Sign
1028-2	Boy's Locker Room by New Gym Bathroom @B	SK	N/A		10/23/2024					Sign
1028-3	Boy's Locker Room by New Gym Bathroom @C	SK	N/A		10/23/2024					Sign
1028-4	Boy's Locker Room Coach's Office Bathroom	SK	N/A		10/23/2024					Sign
1028-5	Boy's Locker Room Vestibule	BF	App	<1.0	10/23/2024					
1028-6	Boy's Locker Room Vestibule	WF	App	<1.0	10/23/2024					
2001-1	Hallway by Room 223	WF	App	<1.0	10/23/2024					

Fixture #	Sample Location	Fixture Type	App or N/A	Initial 1 st Draw Results (ppb)	Initial 1 st Draw Sampling Date	Resampling 1 st Draw Results (ppb)	15 Second Draw Results (ppb)	60 Second Draw Results (ppb)	Resampling Date	Remarks
2002-1	Girl's Bathroom by Room 228 @A	SK	N/A		10/23/2024					Sign
2002-2	Girl's Bathroom by Room 228 @B	SK	N/A		10/23/2024					
2002-3	Girl's Bathroom by Room 228 @C	SK	N/A		10/23/2024					Sign
2002-4	Girl's Bathroom by Room 228 @D	SK	N/A		10/23/2024					Sign
2002-5	Women's Bathroom by Room 228 @E	SK	N/A		10/23/2024					Sign
2003-1	Custodial Closet by Room 228	SS	N/A		10/23/2024					Sign
2004-1	Men's Bathroom by Room 257	SK	N/A		10/23/2024					Sign
2005-1	Hallway by Room 220	BF	App	<1.0	10/23/2024					
2006-1	Boy's Bathroom by Room 216-Left	SK	N/A		10/23/2024					Sign
2006-2	Boy's Bathroom by Room 216-Right	SK	N/A		10/23/2024					Sign
2006-3	Boy's Bathroom Custodial Closet	SS	N/A		10/23/2024					Sign
2007-1	Hallway by Room 216	WF	App	<1.0	10/23/2024					Non-functional
2008-1	Main Office Middle School Kitchenette	SK	N/A		10/23/2024					Removed from Service
2009-1	Men's Bathroom by Main Office @A	SK	N/A		10/23/2024					Sign
2009-2	Men's Bathroom by Main Office @B	SK	N/A		10/23/2024					Sign
2010-1	Security Office Bathroom	SK	N/A		10/23/2024					Sign
2011-1	Superintendent's Bathroom	SK	N/A		10/23/2024					Sign
2012-1	Women's Bathroom by Superintendent's Office @A	SK	N/A		10/23/2024					Sign
2012-2	Women's Bathroom by Superintendent's Office @B	SK	N/A		10/23/2024					Sign
2013-1	Room 259 Bathroom @A	SK	N/A		10/23/2024					Sign
2013-2	Room 259 Bathroom @B	SK	N/A		10/23/2024					Sign

Fixture #	Sample Location	Fixture Type	App or N/A	Initial 1 st Draw Results (ppb)	Initial 1 st Draw Sampling Date	Resampling 1 st Draw Results (ppb)	15 Second Draw Results (ppb)	60 Second Draw Results (ppb)	Resampling Date	Remarks
2014-1	Hallway by Room 246	BF	App	<1.0	10/23/2024					
2014-2	Hallway by Room 246	WF	App	<1.0	10/23/2024					
2018-1	Hallway by Room 214B	BF	App	<1.0	10/23/2024					
2018-2	Hallway by Room 214B	WF	App	<1.0	10/23/2024					
2019-1	Guidance by Room 204 Kitchenette	SK	App	4.0	10/23/2024					
2015-1	Girl's Bathroom by Room 246-Left	SK	N/A		10/23/2024					Sign
2015-2	Girl's Bathroom by Room 246-Right	SK	N/A		10/23/2024					Sign
2016-1	Hallway by Room 231	BF	App	<1.0	10/23/2024					
2016-2	Hallway by Room 231	WF	App	<1.0	10/23/2024					
2017-1	Custodial Closet Room 238A	SS	N/A		10/23/2024					Sign
3001-1	Hallway by Room 321	WF	App	<1.0	10/23/2024					
3002-1	Room 323-Teacher's Station	SK	N/A		10/23/2024					Sign
3002-2	Room 323-Counter @A	SK	N/A		10/23/2024					Sign
3002-3	Room 323-Counter @B	SK	N/A		10/23/2024					Sign
3002-4	Room 323-Counter @C	SK	N/A		10/23/2024					Sign
3002-5	Room 323-Counter @D	SK	N/A		10/23/2024					Sign
3002-6	Room 323-Counter @E	SK	N/A		10/23/2024					Sign
3002-7	Room 323-Counter @F	SK	N/A		10/23/2024					Sign
3002-8	Room 322A-Prep Room	SK	App	8.0	10/23/2024					Removed from Service Pending Remediation
3003-1	Room 322-Teacher's Station	SK	N/A		10/23/2024					Sign
3003-2	Room 322-Counter @A	SK	N/A		10/23/2024					Sign

Fixture #	Sample Location	Fixture Type	App or N/A	Initial 1 st Draw Results (ppb)	Initial 1 st Draw Sampling Date	Resampling 1 st Draw Results (ppb)	15 Second Draw Results (ppb)	60 Second Draw Results (ppb)	Resampling Date	Remarks
3003-3	Room 322-Counter @B	SK	N/A		10/23/2024					Sign
3003-4	Room 322-Counter @C	SK	N/A		10/23/2024					Sign
3003-5	Room 322-Counter @D	SK	N/A		10/23/2024					Sign
3003-6	Room 322-Counter @E	SK	N/A		10/23/2024					Sign
3003-7	Room 322-Counter @F	SK	N/A		10/23/2024					Sign
3004-1	Girl's Bathroom Room 328B @A	SK	N/A		10/23/2024					Sign
3004-2	Girl's Bathroom Room 328 @B	SK	N/A		10/23/2024					Sign
3004-3	Girl's Bathroom Room 328 @C	SK	N/A		10/23/2024					Sign
3004-4	Girl's Bathroom Room 328 @D	SK	N/A		10/23/2024					Sign
3004-5	Girl's Bathroom Room 328 @E	SK	N/A		10/23/2024					Sign
3005-1	Custodial Closet by Room 339	SS	N/A		10/23/2024					Sign
3006-1	Hallway by Room 332	WF	App	<1.0	10/23/2024					
3006-2	Hallway by Room 332	BF	App	<1.0	10/23/2024					
3007-1	Boy's Bathroom by Room 332B @A	SK	N/A		10/23/2024					Sign
3008-1	Custodial Closet by Room 332	SS	N/A		10/23/2024					
3009-1	Hallway by Room 321	WF	App		10/23/2024					
3010-1	Room 319-Teacher's Station	SK	N/A		10/23/2024					Removed from Service; area under renovation
3010-2	Room 319-Counter @A	SK	N/A		10/23/2024					Removed from Service; area under renovation
3010-3	Room 319-Counter @B	SK	N/A		10/23/2024					Removed from Service; area under renovation
3010-4	Room 319-Counter @C	SK	N/A		10/23/2024					Removed from Service; area under renovation
3010-5	Room 319-Counter @D	SK	N/A		10/23/2024					Removed from Service; area under renovation

Fixture #	Sample Location	Fixture Type	App or N/A	Initial 1 st Draw Results (ppb)	Initial 1 st Draw Sampling Date	Resampling 1 st Draw Results (ppb)	15 Second Draw Results (ppb)	60 Second Draw Results (ppb)	Resampling Date	Remarks
3010-6	Room 319-Counter @E	SK	N/A		10/23/2024					Removed from Service; area under renovation
3010-7	Room 319-Counter @F	SK	N/A		10/23/2024					Removed from Service; area under renovation
3010-8	Room 319-Prep Room	SK	N/A		10/23/2024					Removed from Service; area under renovation
3011-1	Boy's Bathroom by Room 317-Left	SK	N/A		10/23/2024					Removed from Service; area under renovation
3011-2	Boy's Bathroom by Room 317-Right	SK	N/A		10/23/2024					Removed from Service; area under renovation
3011-3	Boy's Bathroom Custodial Closet	SS	N/A		10/23/2024					Removed from Service; area under renovation
3012-1	Hallway by Room 317	WF	App		10/23/2024					Removed from Service; area under renovation
3013-1	Room 307-Teacher's Station	SK	N/A		10/23/2024					Sign
3013-2	Room 307-Counter @A	SK	N/A		10/23/2024					Sign
3013-3	Room 307-Counter @B	SK	N/A		10/23/2024					Sign
3013-4	Room 307-Counter @C	SK	N/A		10/23/2024					Sign
3013-5	Room 307-Counter @D	SK	N/A		10/23/2024					Sign
3013-6	Room 307-Counter @E	SK	N/A		10/23/2024					Sign
3013-7	Room 307-Counter @F	SK	N/A		10/23/2024					Sign
3013-8	Room 307-Prep Room	SK	N/A		10/23/2024					Sign
3014-1	Room 302-Teacher's Station	SK	N/A		10/23/2024					Sign
3014-2	Room 302-Pod 1 @A	SK	N/A		10/23/2024					Sign
3014-3	Room 302-Pod 2 @A	SK	N/A		10/23/2024					Sign
3014-4	Room 302-Pod 3 @A	SK	N/A		10/23/2024					Sign
3014-5	Room 302-Pod 4 @A	SK	N/A		10/23/2024					Sign
3014-6	Room 302-Counter @A	SK	N/A		10/23/2024					Sign

Fixture #	Sample Location	Fixture Type	App or N/A	Initial 1 st Draw Results (ppb)	Initial 1 st Draw Sampling Date	Resampling 1 st Draw Results (ppb)	15 Second Draw Results (ppb)	60 Second Draw Results (ppb)	Resampling Date	Remarks
3014-7	Room 302-Counter @B	SK	N/A		10/23/2024					Sign
3014-8	Room 302-Prep Room-Left	SK	N/A		10/23/2024					Sign
3014-9	Room 302-Prep Room-Right	SK	N/A		10/23/2024					Sign
3015-1	Special Education Bathroom by Room 351	SK	N/A		10/23/2024					Removed from Service; area under renovation
3016-1	Special Education Room 351	SK	N/A		10/23/2024					Removed from Service; area under renovation
3017-1	Hallway by Room 351	WF	N/A		10/23/2024					Removed from Service; area under renovation
3018-1	Room 353-Teacher's Station	SK	N/A		10/23/2024					Sign
3018-2	Room 353-Counter @A	SK	N/A		10/23/2024					Sign
3018-3	Room 353-Counter @B	SK	N/A		10/23/2024					Sign
3018-4	Room 353-Counter @C	SK	N/A		10/23/2024					Sign
3018-5	Room 353-Counter @D	SK	N/A		10/23/2024					Sign
3018-6	Room 353-Counter @E	SK	N/A		10/23/2024					Sign
3018-7	Room 353-Counter @F	SK	N/A		10/23/2024					Sign
3019-1	Hallway by Room 340	WF	N/A		10/23/2024					Removed from Service; area under renovation
3019-2	Hallway by Room 340	BF	N/A		10/23/2024					Removed from Service; area under renovation
3020-1	Girl's Bathroom by Room 340-Left	SK	N/A		10/23/2024					Removed from Service; area under renovation
3020-2	Girl's Bathroom by Room 340-Right	SK	N/A		10/23/2024					Removed from Service; area under renovation
3021-1	Room 341-Trough-Left	SK	N/A		10/23/2024					Removed from Service; area under renovation
3021-2	Room 341-Trough-Right	SK	N/A		10/23/2024					Removed from Service; area under renovation
3022-1	Room 316 Bathroom	SK	N/A		10/23/2024					Removed from Service; area under renovation

Laboratory Report

NYE Report #: 2406486-31532

October 28, 2024

Project Manager
Enviroscience Consultants, Inc.
2150 Smithtown Avenue
Ronkonkoma, NY 11779

Project: Lawrence Middle School

Dear Project Manager,

Enclosed is the Laboratory Analytical Report for potable water sample(s) received on October 24, 2024. New York Environmental analyzed the samples on October 25, 2024 for Lead (Pb) by EPA Method 200.9 Rev. 2.2.

If there are any questions regarding the analyses, please feel free to contact us at your convenience. New York Environmental is a NELAP accredited laboratory. Attached reported results meet the requirements of the NELAP standards unless otherwise noted.

Samples' analytical results relate only to the samples tested, in the condition received by the laboratory. This report shall not be reproduced except in its entirety without written approval of the laboratory.

We sincerely thank you for your business, and look forward to being of service for your future environmental testing needs.

Sincerely,

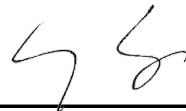

Li Tsang, Laboratory Director

Date Collected:	23 Oct 2024
Date Received:	24 Oct 2024
Date Analyzed:	25 Oct 2024

Analytical Method:	EPA 200.9 Rev. 2.2
Analyte, Matrix:	Lead, Potable Water

Lab ID	CID	Sample Location/Description	LOQ	Result	Units	Flag
241024P006	1	Kitchen Food Prep Left-SK, Initial	0.001	<0.001	mg/L	
241024P007	2	Kitchen Food Prep Left-SPY, Initial	0.001	<0.001	mg/L	
241024P008	3	Kitchen Food Prep Right-SK, Initial	0.001	<0.001	mg/L	
241024P009	4	Kitchen Food Prep Right-SPY, Initial	0.001	<0.001	mg/L	
241024P010	5	Serving Area - Ice Machine-IM, Initial	0.001	<0.001	mg/L	
241024P011	6	New Café-BF, Initial	0.001	<0.001	mg/L	
241024P012	7	New Café-WF, Initial	0.001	<0.001	mg/L	
241024P013	8	Hallway by Room 128 & Dining Area A-BF, Initial	0.001	0.005	mg/L	
241024P014	9	Hallway by Room 128 & Dining Area A-WF, Initial	0.001	<0.001	mg/L	
241024P015	10	Hallway by Room 112A-BF, Initial	0.001	<0.001	mg/L	
241024P016	11	Room 139A-Counter @A-SK, Initial	0.001	<0.001	mg/L	
241024P017	12	Room 139A-Counter @B-SK, Initial	0.001	<0.001	mg/L	
241024P018	13	Room 139A-Counter @C-SK, Initial	0.001	<0.001	mg/L	
241024P019	14	Room 139A-Counter @D-SK, Initial	0.001	<0.001	mg/L	
241024P020	15	Nurse's Office-SK, Initial	0.001	<0.001	mg/L	
241024P021	16	Nurse's Office Bathroom-SK, Initial	0.001	<0.001	mg/L	
241024P022	17	Boy's Locker Room Vestibule-BF, Initial	0.001	<0.001	mg/L	
241024P023	18	Boy's Locker Room Vestibule-WF, Initial	0.001	<0.001	mg/L	
241024P024	19	Girl's Locker Room Vestibule-BF, Initial	0.001	<0.001	mg/L	
241024P025	20	Girl's Locker Room Vestibule-WF, Initial	0.001	<0.001	mg/L	
241024P026	21	Hallway by Room 220-BF, Initial	0.001	<0.001	mg/L	
241024P027	22	Hallway by Room 231-BF, Initial	0.001	<0.001	mg/L	
241024P028	23	Hallway by Room 231-WF, Initial	0.001	<0.001	mg/L	
241024P029	24	Hallway by Room 246-BF, Initial	0.001	<0.001	mg/L	
241024P030	25	Hallway by Room 246-WF, Initial	0.001	<0.001	mg/L	
241024P031	26	Hallway by Room 214B-BF, Initial	0.001	<0.001	mg/L	



Date Collected:	23 Oct 2024
Date Received:	24 Oct 2024
Date Analyzed:	25 Oct 2024

Analytical Method:	EPA 200.9 Rev. 2.2
Analyte, Matrix:	Lead, Potable Water

<u>Lab ID</u>	<u>CID</u>	<u>Sample Location/Description</u>	<u>LOQ</u>	<u>Result</u>	<u>Units</u>	<u>Flag</u>
241024P032	27	Hallway by Room 214B-WF, Initial	0.001	<0.001	mg/L	
241024P033	28	Guidance by Room 204 Kitchenette-SK, Initial	0.001	0.004	mg/L	
241024P034	29	Hallway by Room 321-WF, Initial	0.001	<0.001	mg/L	
241024P035	30	Room 322A-Prep Room-SK, Initial	0.001	0.008	mg/L	H
241024P036	31	Hallway by Room 332-BF, Initial	0.001	<0.001	mg/L	
241024P037	32	Hallway by Room 332-WF, Initial	0.001	<0.001	mg/L	

Comment:

CID: Client ID LOQ: Limit of Quantitation

H: Sample result exceeds applicable regulatory limit.

Appendix D
Lawrence High School

Fixture #	Sample Location	Fixture Type	App or N/A	Initial 1 st Draw Results (ppb)	Latest 1st Draw Sampling Date	Resampling 1 st Draw Results (ppb)	15 Second Draw Results (ppb)	60 Second Draw Results (ppb)	Resampling Date	Remarks
1001-01	Kitchen Handwash @ A	SK	N/A		10/22/24					Sign
1001-02	Kitchen Sanitizer @ A	SK	N/A		10/22/24					Sign
1001-03	Kitchen Sanitizer @ B	SK	N/A		10/22/24					Sign
1001-04	Kitchen Hoshizaki	IM	N/A		10/22/24					Removed from Service
1001-05	Kitchen Ice-O-Matic	IM	App		10/22/24					Empty and non-functional at time of sampling
1001-06	Kitchen 2-Bay @ A	SK	App	<1.0	10/22/24					
1001-07	Kitchen 2-Bay @ B	SK	App	<1.0	10/22/24					
1001-08	Kitchen Handwash @ B	SK	N/A		10/22/24					Sign
1001-09	Kitchen Island	SK	App	<1.0	10/22/24					
1001-10	Kitchen Bathroom	SK	N/A		10/22/24					
1001-11	Kitchen Custodial Closet	SS	N/A		10/22/24					Sign
1001-12	Kitchen Locker Room Bathroom	SK	N/A		10/22/24					Sign
1001-13	Kitchen Storage	SK	N/A		10/22/24					Sign
1002-01	Men's Bathroom by Gym @ A	SK	N/A		10/22/24					Sign
1002-02	Men's Bathroom by Gym @ B	SK	N/A		10/22/24					Sign
1003-01	Unisex Bathroom by Gym	SK	N/A		10/22/24					Sign
1004-01	Girl's Locker Room Coach's Office Bathroom	SK	N/A		10/22/24					Sign
1004-02	Girl's Locker Room	WF	App		10/22/24					Non-functional
1004-03	Girl's Locker Room Bathroom @ A	SK	N/A		10/22/24					
1004-04	Girl's Locker Room Bathroom @ B	SK	N/A		10/22/24					

Fixture #	Sample Location	Fixture Type	App or N/A	Initial 1 st Draw Results (ppb)	Latest 1st Draw Sampling Date	Resampling 1 st Draw Results (ppb)	15 Second Draw Results (ppb)	60 Second Draw Results (ppb)	Resampling Date	Remarks
1004-05	Girl's Locker Room Bathroom @ C	SK	N/A		10/22/24					
1005-01	Hall by Cafeteria	BF	App	<1.0	10/22/24					
1005-02	Hall by Cafeteria	WF	App	<1.0	10/22/24					
1006-01	Hall by Boy's Locker Room	BF	App	<1.0	10/22/24					
1006-02	Hall by Boy's Locker Room	WF	App	<1.0	10/22/24					
1007-01	Boy's Locker Room Custodial Closet	SS	N/A		10/22/24					Sign
1007-02	Boy's Locker Room Coach's Office Bathroom	SK	N/A		10/22/24					Sign
1007-03	Boy's Locker Room	WF	App		10/22/24					Non-functional
1007-04	Boy's Locker Room Bathroom @ A	SK	N/A		10/22/24					Sign
1007-05	Boy's Locker Room Bathroom @ B	SK	N/A		10/22/24					Sign
1008-01	Old Custodial Office	SK	N/A		10/22/24					Sign
1008-02	Old Custodial Office Bathroom	SK	N/A		10/22/24					Sign
1009-01	Athletic Office	SK	N/A		10/22/24					Sign
1010-02	Room 136 Dance Studio - Right	SK	N/A		10/22/24					Sign
1010-01	Room 136 Dance Studio - Left	SK	N/A		10/22/24					Sign
1011-01	Art Suite Vestibule	WF	App	8.0	10/22/24					Removed from Service Pending Remediation
1011-02	Art Suite Room 134 Unit @ A	SK	N/A		10/22/24					Sign
1011-03	Art Suite Room 134 Unit @ B	SK	N/A		10/22/24					Sign
1011-04	Art Suite Room 134 Unit @ C	SK	N/A		10/22/24					Sign
1012-01	Room 132	SK	N/A		10/22/24					#N/A

Fixture #	Sample Location	Fixture Type	App or N/A	Initial 1 st Draw Results (ppb)	Latest 1st Draw Sampling Date	Resampling 1 st Draw Results (ppb)	15 Second Draw Results (ppb)	60 Second Draw Results (ppb)	Resampling Date	Remarks
1012-1	Hall by Room 134	WF	App	4.0	10/22/24					
1013-01	Nurse's Office	SK	App	<1.0	10/22/24					
1013-02	Nurse's Office by Filing Cabinet	SK	N/A		10/22/24					Removed from Service
1013-03	Nurse's Office Bathroom	SK	App	<1.0	10/22/24					
1014-01	Room 128 Unit @ A	SK	N/A		10/22/24					Sign
1014-02	Room 128 Unit @ B	SK	N/A		10/22/24					Sign
1014-03	Room 128 Unit @ C	SK	N/A		10/22/24					Sign
1014-04	Room 128A Unit @ A	SK	N/A		10/22/24					Sign
1014-05	Room 128A Unit @ B	SK	N/A		10/22/24					Sign
1014-06	Room 128A Unit @ C	SK	N/A		10/22/24					Sign
1014-07	Room 128A Unit @ D	SK	N/A		10/22/24					Sign
1015-01	Room 127	SK	App	<1.0	10/22/24					
1015-02	Room 127	WF	App		10/22/24					Non-functional
1015-03	Room 127C Life Skills	SK	App	1.0	10/22/24					
1016-01	Hall by Room 127	WF	App	16.0	10/22/24					Removed from Service Pending Remediation
1017-01	Room 125 Bathroom	SK	N/A		10/22/24					Sign
1017-02	Room 125	WF	App		10/22/24					Non-functional
1018-01	Custodial Office Bathroom	SK	N/A		10/22/24					Sign
1018-02	Custodial Office @ A	SK	N/A		10/22/24					Sign
1018-03	Custodial Office @ B	SK	N/A		10/22/24					Sign

Fixture #	Sample Location	Fixture Type	App or N/A	Initial 1 st Draw Results (ppb)	Latest 1st Draw Sampling Date	Resampling 1 st Draw Results (ppb)	15 Second Draw Results (ppb)	60 Second Draw Results (ppb)	Resampling Date	Remarks
1018-04	Custodial Office Kitchen	SK	App	<1.0	10/22/24					#N/A
1019-01	Room 122 Science Prep	SK	N/A		10/22/24					Sign
1020-01	Room 121 Teacher's Station	SK	N/A		10/22/24					Sign
1020-02	Room 121 Counter	SK	N/A		10/22/24					Sign
1021-01	Room 120A Science Prep	SK	N/A		10/22/24					Sign
1022-01	Hall by Room 120	WF	App	3.0	10/22/24					
1023-01	Room 120 Teacher's Station	SK	N/A		10/22/24					Sign
1023-02	Room 120 @ A	SK	N/A		10/22/24					Sign
1023-03	Room 120 @ B	SK	N/A		10/22/24					Sign
1023-04	Room 120 @ C	SK	N/A		10/22/24					Sign
1023-05	Room 120 @ D	SK	N/A		10/22/24					Sign
1023-06	Room 120 @ E	SK	N/A		10/22/24					Sign
1023-07	Room 120 @ F	SK	N/A		10/22/24					Sign
1024-01	Room 119 Teacher's Station	SK	N/A		10/22/24					Sign
1024-02	Room 119 @ A	SK	N/A		10/22/24					Sign
1024-03	Room 119 @ B	SK	N/A		10/22/24					Sign
1024-04	Room 119 @ C	SK	N/A		10/22/24					Sign
1024-05	Room 119 @ D	SK	N/A		10/22/24					Sign
1024-06	Room 119 @ E	SK	N/A		10/22/24					Sign
1024-07	Room 119 @ F	SK	N/A		10/22/24					Sign

Fixture #	Sample Location	Fixture Type	App or N/A	Initial 1 st Draw Results (ppb)	Latest 1st Draw Sampling Date	Resampling 1 st Draw Results (ppb)	15 Second Draw Results (ppb)	60 Second Draw Results (ppb)	Resampling Date	Remarks
1024-08	Room 119 @ G	SK	N/A		10/22/24					Sign
1024-09	Room 119 Fume Hood	SK	N/A		10/22/24					Sign
1025-01	Room 118 Teacher's Station	SK	N/A		10/22/24					Sign
1025-02	Room 118 @ A	SK	N/A		10/22/24					Sign
1025-03	Room 118 @ B	SK	N/A		10/22/24					Sign
1025-04	Room 118 @ C	SK	N/A		10/22/24					Sign
1025-05	Room 118 @ D	SK	N/A		10/22/24					Sign
1025-06	Room 118 @ E	SK	N/A		10/22/24					Sign
1025-07	Room 118 @ F	SK	N/A		10/22/24					Sign
1026-01	Room 118A Science Prep	SK	N/A		10/22/24					Sign
1027-01	Room 117 Teacher's Station	SK	N/A		10/22/24					Sign
1027-02	Room 117 @ A	SK	N/A		10/22/24					Sign
1027-03	Room 117 @ B	SK	N/A		10/22/24					Sign
1027-04	Room 117 @ C	SK	N/A		10/22/24					Sign
1027-05	Room 117 @ D	SK	N/A		10/22/24					Sign
1027-06	Room 117 @ E	SK	N/A		10/22/24					Sign
1027-07	Room 117 @ F	SK	N/A		10/22/24					Sign
1028-01	Room 116 Teacher's Station	SK	N/A		10/22/24					Sign
1028-02	Room 116 @ A	SK	N/A		10/22/24					Sign
1028-03	Room 116 @ B	SK	N/A		10/22/24					Sign

Fixture #	Sample Location	Fixture Type	App or N/A	Initial 1 st Draw Results (ppb)	Latest 1st Draw Sampling Date	Resampling 1 st Draw Results (ppb)	15 Second Draw Results (ppb)	60 Second Draw Results (ppb)	Resampling Date	Remarks
1028-04	Room 116 @ C	SK	N/A		10/22/24					Sign
1028-05	Room 116 @ D	SK	N/A		10/22/24					Sign
1028-06	Room 116 @ E	SK	N/A		10/22/24					Sign
1028-07	Room 116 @ F	SK	N/A		10/22/24					Sign
1029-01	Hall by Room 117	WF	App		10/22/24					Non-functional
1030-01	Room 113 Teacher's Station	SK	N/A		10/22/24					Sign
1030-02	Room 113 @ A	SK	N/A		10/22/24					Sign
1030-03	Room 113 @ B	SK	N/A		10/22/24					Sign
1030-04	Room 113 @ C	SK	N/A		10/22/24					Sign
1030-05	Room 113 @ D	SK	N/A		10/22/24					Sign
1030-06	Room 113 @ E	SK	N/A		10/22/24					Sign
1030-07	Room 113 @ F	SK	N/A		10/22/24					Sign
1031-01	Room 112 Teacher's Station	SK	N/A		10/22/24					Sign
1032-01	Boy's Bathroom by Room 108 @ A	SK	N/A		10/22/24					Sign
1032-02	Boy's Bathroom by Room 108 @ B	SK	N/A		10/22/24					Sign
1032-03	Boy's Bathroom by Room 108 @ C	SK	N/A		10/22/24					Sign
1032-04	Boy's Bathroom by Room 108 @ D	SK	N/A		10/22/24					Sign
1033-01	Custodial Closet by Room 108	SS	N/A		10/22/24					Sign
1034-01	Room 107 Teacher's Station	SK	N/A		10/22/24					Sign
1035-01	Room 105 Teacher's Station	SK	N/A		10/22/24					Sign

Fixture #	Sample Location	Fixture Type	App or N/A	Initial 1 st Draw Results (ppb)	Latest 1st Draw Sampling Date	Resampling 1 st Draw Results (ppb)	15 Second Draw Results (ppb)	60 Second Draw Results (ppb)	Resampling Date	Remarks
1036-01	Room 103 Teacher's Station	SK	N/A		10/22/24					Sign
1037-01	Room 101 Teacher's Station	SK	N/A		10/22/24					Sign
1038-01	Hall by Room 101	BF	App	<1.0	10/22/24					
1038-2	Hall by room 101	WF	App	<1.0	10/22/24					
1039-01	Unisex Bathroom by Main Office	SK	N/A		10/22/24					Sign
1040-01	Mens Faculty Bathroom by District Office Uni	SK	N/A		10/22/24					Sign
1040-02	Mens Faculty Bathroom by District Office Uni	SK	N/A		10/22/24					Sign
1041-01	Custodial Closet by District Office	SS	N/A		10/22/24					Sign
1042-01	District Office Faculty Room	SK	App	<1.0	10/22/24					
1042-02	District Office Faculty Room	SPY	App	<1.0	10/22/24					
1042-03	District Office Bathroom	SK	N/A		10/22/24					
1043-01	Womens Faculty Bathroom by Auditorium @	SK	N/A		10/22/24					Sign
1044-01	Room 153 Band Office	SK	N/A		10/22/24					Sign
1045-01	Room 155A Office	SK	App		10/22/24					Sign
1046-01	Stage Crew Storage	SS	N/A		10/22/24					Sign
1047-01	Unisex Bathroom by Room 123 @ A	SK	N/A		10/22/24					Sign
1047-02	Unisex Bathroom by Room 123 @ B	SK	N/A		10/22/24					Sign
1048-01	Room 147 Teacher's Station	SK	N/A		10/22/24					Sign
1048-02	Room 147 @ A	SK	N/A		10/22/24					Sign
1048-03	Room 147 @ B	SK	N/A		10/22/24					Sign

Fixture #	Sample Location	Fixture Type	App or N/A	Initial 1 st Draw Results (ppb)	Latest 1st Draw Sampling Date	Resampling 1 st Draw Results (ppb)	15 Second Draw Results (ppb)	60 Second Draw Results (ppb)	Resampling Date	Remarks
1048-04	Room 147 @ C	SK	N/A		10/22/24					Sign
1048-05	Room 147 @ D	SK	N/A		10/22/24					Sign
1048-06	Room 147 @ E	SK	N/A		10/22/24					Sign
1048-07	Room 147 Fume Hood	SK	N/A		10/22/24					Sign
1049-01	Girl's Bathroom by Room 147 @ A	SK	N/A		10/22/24					Sign
1049-02	Girl's Bathroom by Room 147 @ B	SK	N/A		10/22/24					Sign
1049-03	Girl's Bathroom by Room 147 @ C	SK	N/A		10/22/24					Sign
1049-04	Girl's Bathroom by Room 147 @ D	SK	N/A		10/22/24					Sign
1049-05	Girl's Bathroom by Room 147 @ E	SK	N/A		10/22/24					Sign
1049-06	Girl's Bathroom by Room 147 @ F	SK	N/A		10/22/24					Sign
1050-01	Custodial Closet by Room 147	SS	N/A		10/22/24					Sign
2001-01	Unisex Bathroom Room 228	SK	App		10/22/24					Sign
2002-01	Hall by Room 223	WF	App	6.0	10/22/24					Removed from Service Pending Remediation
2003-01	Room 220 by Laundry	SK	N/A		10/22/24					Sign
2003-02	Room 220 Station 1	SK	App	82.0	10/22/24					Removed from Service Pending Remediation
2003-03	Room 220 Station 2	SK	App	145.0	10/22/24					Removed from Service Pending Remediation
2003-04	Room 220 Station 3	SK	App	332.0	10/22/24					Removed from Service Pending Remediation
2003-05	Room 220 Station 4	SK	App	70.0	10/22/24					Removed from Service Pending Remediation
2003-06	Room 220 Station 5	SK	App		10/22/24					Non-functional
2004-01	Room 218	SK	App	5.0	10/22/24					

Fixture #	Sample Location	Fixture Type	App or N/A	Initial 1 st Draw Results (ppb)	Latest 1st Draw Sampling Date	Resampling 1 st Draw Results (ppb)	15 Second Draw Results (ppb)	60 Second Draw Results (ppb)	Resampling Date	Remarks
2004-02	Room 218	SPY	App	1.0	10/22/24					
2005-01	Faculty Room 217 Women's Bathroom - Left	SK	N/A		10/22/24					Sign
2005-02	Faculty Room 217 Women's Bathroom - Right	SK	N/A		10/22/24					Sign
2006-01	Men's Faculty Bathroom by Room 216	SK	N/A		10/22/24					Sign
2007-01	Hall by Room 212	WF	App	3.0	10/22/24					
2008-01	Boy's Bathroom by Room 210 @ A	SK	N/A		10/22/24					Sign
2008-02	Boy's Bathroom by Room 210 @ B	SK	N/A		10/22/24					Sign
2009-01	Custodial Closet by Room 210	SS	N/A		10/22/24					Sign
2010-01	Room 204 - Library Office	SK	App	4.0	10/22/24					
2011-01	Hall by Room 201	WF	App		10/22/24					Non-functional
2012-01	Hall by Room 242	WF	App		10/22/24					Non-functional
2013-01	Girl's Bathroom by Room 242 @ A	SK	N/A		10/22/24					Sign
2013-02	Girl's Bathroom by Room 242 @ B	SK	N/A		10/22/24					Sign
2014-01	Custodial Closet by Room 242	SS	N/A		10/22/24					Sign
2015-01	Custodial Closet by Football Locker Room	SS	N/A		10/22/24					Sign
2016-01	1st Football Locker Room	WF	App		10/22/24					Non-functional
2016-02	1st Football Locker Room Bathroom - Left	SK	N/A		10/22/24					Sign
2016-03	1st Football Locker Room Bathroom - Right	SK	N/A		10/22/24					Sign
2017-01	Football Locker Room Coach's Office Bathroom	SK	N/A		10/22/24					Sign
2017-02	Football Locker Room Coach's Office	IM	App	<1.0	10/22/24					

Fixture #	Sample Location	Fixture Type	App or N/A	Initial 1 st Draw Results (ppb)	Latest 1st Draw Sampling Date	Resampling 1 st Draw Results (ppb)	15 Second Draw Results (ppb)	60 Second Draw Results (ppb)	Resampling Date	Remarks
2018-01	2nd Football Locker Room	WF	App	217.0	10/22/24					Removed from Service Pending Remediation
2018-02	2nd Football Locker Room Bathroom - Left	SK	N/A		10/22/24					Sign
2018-03	2nd Football Locker Room Bathroom - Right	SK	N/A		10/22/24					Sign
2019-01	Custodial Closet by Wrestling Room	SS	N/A		10/22/24					Sign
2020-01	Wrestling Room Bathroom	SK	N/A		10/22/24					Sign
3001-01	Hall by Room 339	WF	App		10/22/24					Non-functional
3002-01	Girl's Bathroom by Room 336 @ A	SK	N/A		10/22/24					Sign
3002-02	Girl's Bathroom by Room 336 @ B	SK	N/A		10/22/24					Sign
3003-01	Custodial Closet by Room 336	SS	N/A		10/22/24					Sign
3004-01	Hall by Room 329	WF	App		10/22/24					Non-functional
3005-01	Faculty Room 321 Men's Bathroom	SK	N/A		10/22/24					Sign
3006-01	Women's Faculty Bathroom by Room 319	SK	N/A		10/22/24					Sign
3007-01	Hall by Room 318	WF	App	<1.0	10/22/24					
3008-01	Hall by Room 315	WF	App	3.0	10/22/24					
3008-02	Boy's Bathroom by Room 313 @ A	SK	N/A		10/22/24					Sign
3008-03	Boy's Bathroom by Room 313 @ B	SK	N/A		10/22/24					Sign
3008-04	Custodial Closet by Room 313	SS	N/A		10/22/24					Sign
3008-05	Hall by Room 301	WF	App		10/22/24					Non-functional

Laboratory Report

NYE Report #: 2406442-31506

October 25, 2024

Project Manager
Enviroscience Consultants, Inc.
2150 Smithtown Avenue
Ronkonkoma, NY 11779

Project: Lawrence UFSD; Lawrence High School

Dear Project Manager,

Enclosed is the Laboratory Analytical Report for potable water sample(s) received on October 22, 2024. New York Environmental analyzed the samples on October 23, 2024 for Lead (Pb) by EPA Method 200.9 Rev. 2.2.

If there are any questions regarding the analyses, please feel free to contact us at your convenience. New York Environmental is a NELAP accredited laboratory. Attached reported results meet the requirements of the NELAP standards unless otherwise noted.

Samples' analytical results relate only to the samples tested, in the condition received by the laboratory. This report shall not be reproduced except in its entirety without written approval of the laboratory.

We sincerely thank you for your business, and look forward to being of service for your future environmental testing needs.

Sincerely,

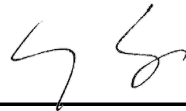

Li Tsang, Laboratory Director

Date Collected:	22 Oct 2024
Date Received:	22 Oct 2024
Date Analyzed:	23 Oct 2024

Analytical Method:	EPA 200.9 Rev. 2.2
Analyte, Matrix:	Lead, Potable Water

Lab ID	CID	Sample Location/Description	LOQ	Result	Units	Flag
241022Q010	1	Kitchen 2-Bay @ A-SK, Initial	0.001	<0.001	mg/L	
241022Q011	2	Kitchen 2-Bay @ B-SK, Initial	0.001	<0.001	mg/L	
241022Q012	3	Kitchen Island-SK, Initial	0.001	<0.001	mg/L	
241022Q013	4	Hall by Cafeteria-WF, Initial	0.001	<0.001	mg/L	
241022Q014	5	Hall by Cafeteria-BF, Initial	0.001	<0.001	mg/L	
241022Q015	6	Hall by Boy's Locker Room-BF, Initial	0.001	<0.001	mg/L	
241022Q016	7	Hall by Boy's Locker Room-WF, Initial	0.001	<0.001	mg/L	
241022Q017	8	Art Suite Vestibule-WF, Initial	0.001	0.008	mg/L	H
241022Q018	9	Hall by Room 134-WF, Initial	0.001	0.004	mg/L	
241022Q019	10	Nurse's Office-SK, Initial	0.001	<0.001	mg/L	
241022Q020	11	Nurse's Office Bathroom-SK, Initial	0.001	<0.001	mg/L	
241022Q021	12	Room 127-SK, Initial	0.001	<0.001	mg/L	
241022Q022	13	Room 127C Life Skills-SK, Initial	0.001	0.001	mg/L	
241022Q023	14	Hall by Room 127-WF, Initial	0.001	0.016	mg/L	H
241022Q024	15	Custodial Office Kitchen-SK, Initial	0.001	<0.001	mg/L	
241022Q025	16	Hall by Room 120-WF, Initial	0.001	0.003	mg/L	
241022Q026	17	Hall by 113-WF, Initial	0.001	0.002	mg/L	
241022Q027	18	Hall by Room 101-BF, Initial	0.001	<0.001	mg/L	
241022Q028	19	Hall by Room 101-WF, Initial	0.001	<0.001	mg/L	
241022Q029	20	Principals Office Bathroom-SK, Initial	0.001	<0.001	mg/L	
241022Q030	21	District Office Faculty Room-SK, Initial	0.001	<0.001	mg/L	
241022Q031	22	District Office Faculty Room-SPY, Initial	0.001	<0.001	mg/L	
241022Q032	23	Hall by Room 223-WF, Initial	0.001	0.006	mg/L	H
241022Q033	24	Room 220 Station 1-SK, Initial	0.001	0.082	mg/L	E,H
241022Q034	25	Room 220 Station 2-SK, Initial	0.001	0.145	mg/L	E,H
241022Q035	26	Room 220 Station 3-SK, Initial	0.001	0.332	mg/L	E,H



Date Collected:	22 Oct 2024
Date Received:	22 Oct 2024
Date Analyzed:	23 Oct 2024

Analytical Method:	EPA 200.9 Rev. 2.2
Analyte, Matrix:	Lead, Potable Water

Lab ID	CID	Sample Location/Description	LOQ	Result	Units	Flag
241022Q036	27	Room 220 Station 4-SK, Initial	0.001	0.070	mg/L	E,H
241022Q037	28	Room 218-SK, Initial	0.001	0.005	mg/L	
241022Q038	29	Room 218-SPY, Initial	0.001	0.001	mg/L	
241022Q039	30	Hall by Room 212-WF, Initial	0.001	0.003	mg/L	
241022Q040	31	Room 204 - Library Office-SK, Initial	0.001	0.004	mg/L	
241022Q041	32	Hall by Room 318-WF, Initial	0.001	<0.001	mg/L	
241022Q042	33	Hall by Room 315-WF, Initial	0.001	0.003	mg/L	
241022Q043	34	Football Locker Room Coach's Office-IM, Initial	0.001	<0.001	mg/L	
241022Q044	35	2nd Football Locker Room-WF, Initial	0.001	0.217	mg/L	E,H

Comment:

CID: Client ID LOQ: Limit of Quantitation

E: Sample result exceeds instrument calibration, value is estimated.

H: Sample result exceeds applicable regulatory limit.